

THIS DRAWING IS TO BE READ IN CONJUNCTION WITH ALL THE RELEVANT CONSULTANTS AND/OR SPECIALIST DRAWINGS OR DOCUMENTS AND ANY DISCREPANCIES OR VARIATIONS ARE TO BE NOTIFIED TO FRANK AMANKAWAH BEFORE THE AFFECTED WORK COMMENCES.

DO NOT SCALE FROM THIS DRAWING  
ALL DIMENSIONS ARE TO BE CHECKED ON SITE  
FRANK AMANKAWAH RETAINS THE COPYRIGHT OF ALL INFORMATION WITHIN THIS DRAWING

NOTES

KEY

- A. MAIN HOUSE
- B. DRIVEWAY
- C. FRONT LAWN
- D. SIDE EDGE LAWN

1. ER01.000 EXISTING SIDE GATE
2. ER01.000 BRICK STEPS TO FRONT ENTRANCE RETAINED
3. ER01.000 NEW RESIN AND GRAVEL DRIVEWAY
4. ER01.000 NEW BRICKWORK BOARDER
5. ER01.000 PLANTING TO BE RETAINED
6. ER01.000 NEW BRICKWORK BOARDER
7. ER01.000 NEW BRICK RETAINING PLANTER
8. ER01.000 PLANTER BEDDING RETAINED
9. ER01.000 EXISTING BEACH TREE
10. ER01.000 EXTERNAL PAVING
11. ER01.000 NEW BRICK WALL WITH BRICKWORK PIERS AND RALLINGS BETWEEN
12. ER01.000 NEW BRICK PIER WITH STONE COPING
13. ER01.000 NEW ELECTRIC GATE
14. ER01.000 EXISTING PLANTING TO BE RETAINED
15. ER01.000 SIDE LAWN BOARDER EXTENDED
16. ER01.000 RAIN WATER GUTTER TO BE REPLACED
17. ER01.000 EXISTING SIDE GATE
18. ER01.000 BRICKWORK TO BEDDING TO BE REPLACED

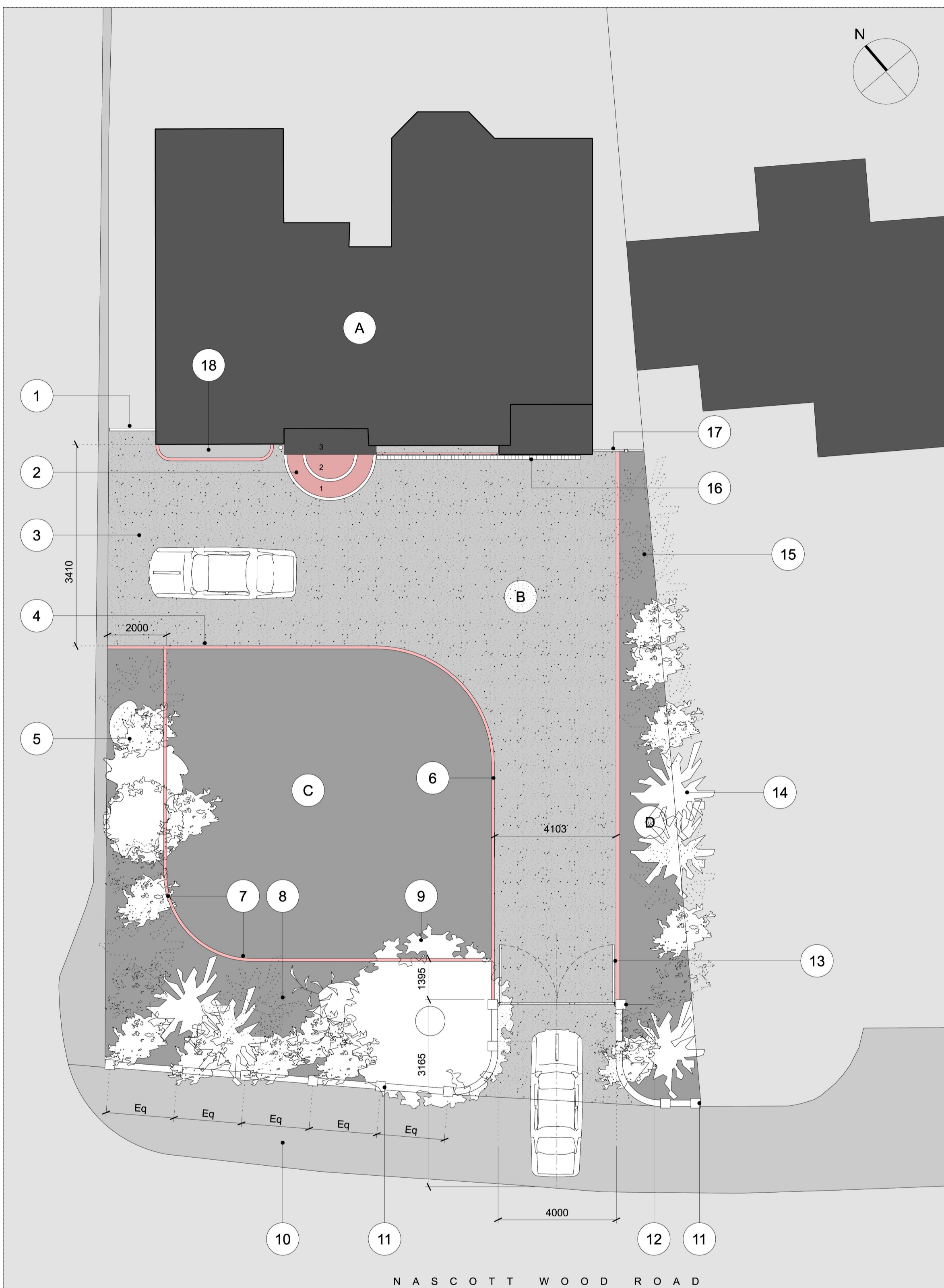

01 PROPOSED GROUND FLOOR PLAN  
1:100 @ A2/ 1:100 @ A4



C1	FOR CONSTRUCTION	APR 22
Rev	Description	Date

**NOVATE | ACS**  
ARCHITECTURE & CONSTRUCTION SERVICES

6B PARKWAY | ST ALBANS | PORTERS BAR | HERTS | AL3 6PA

DRAWING STATUS

**FOR PLANNING**

Issued for purpose indicated. This drawing is to be read in conjunction with all consultants information.  
All dimensions to be checked on site.  
Do not scale drawing.  
This drawing is copyright.

JOB NUMBER: 203 FILE: 02-203

CLIENT: MR AND MRS JEFFERIES

JOB: 55 NASCOT WOOD ROAD | WATFORD | WD17 4SJ

DRAWING TITLE: PROPOSED GROUND FLOOR PLAN

SCALE: 1:50 @ A2/ 1:70 @ A3

DATE: APRIL 2022

DRAWING NO: 203\_PP-110-3

REV: C1