

**BASEMENT LAYOUT**  
1:100@A3

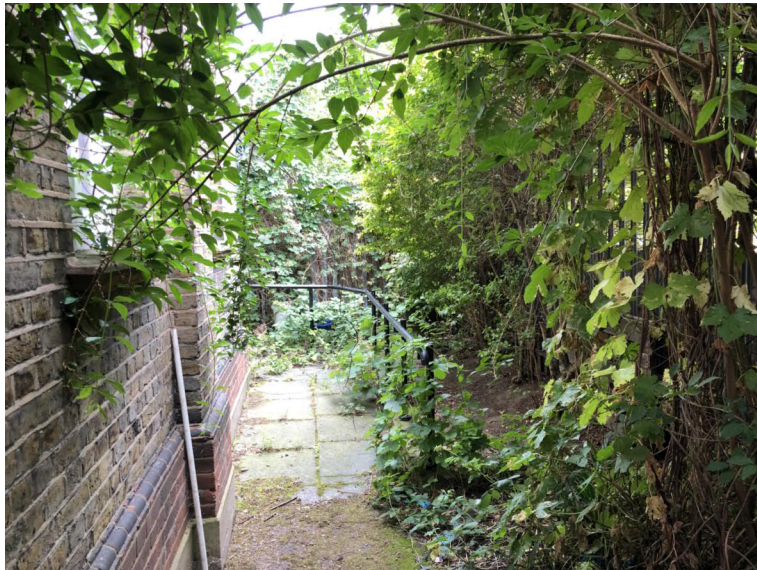

LOCATION A  
(VIEW FROM GROUND LEVEL, REAR EXIT)



LOCATION B  
(VIEW FROM GROUND LEVEL, SIDE GATE)

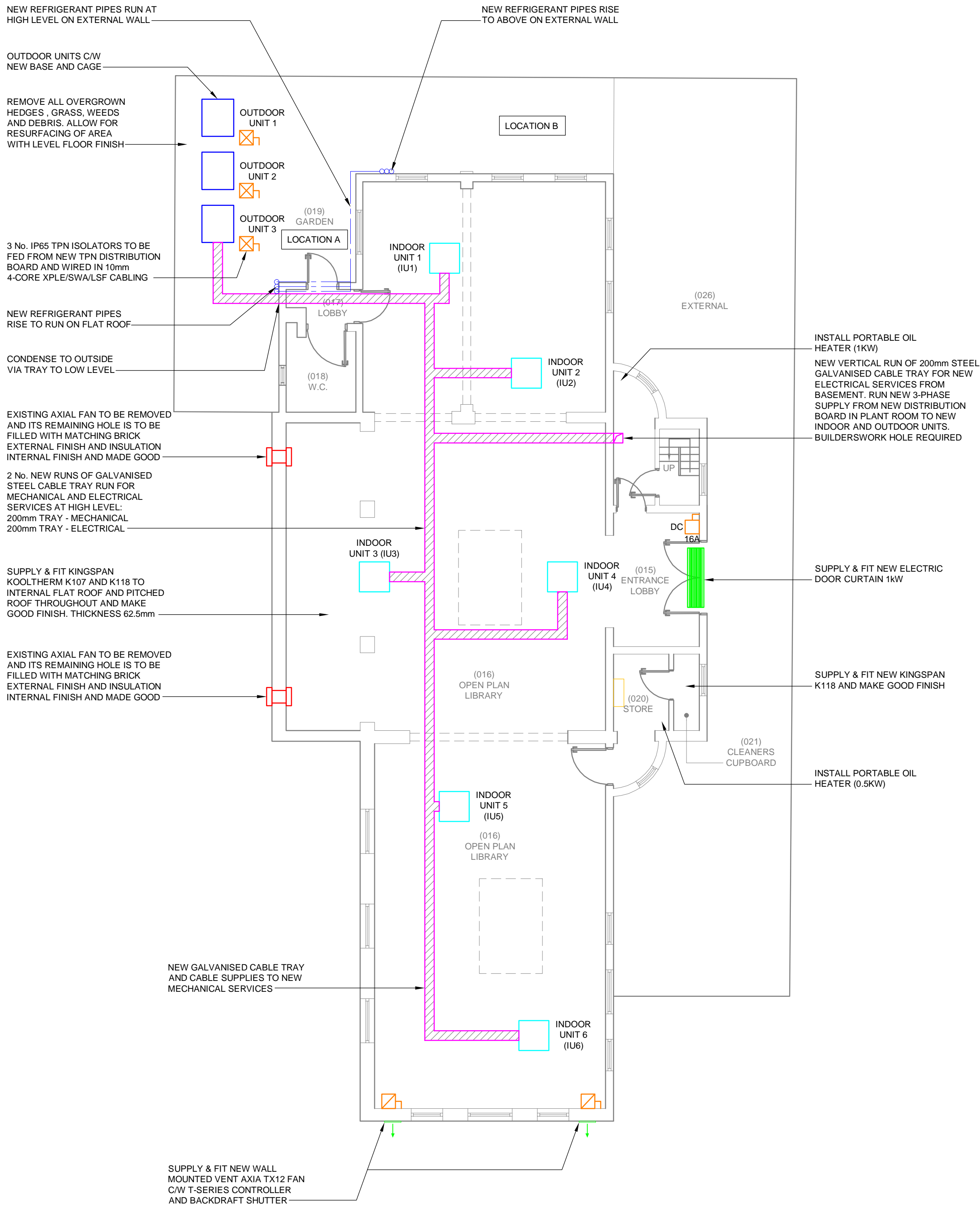

**GROUND FLOOR LAYOUT**  
1:100@A3

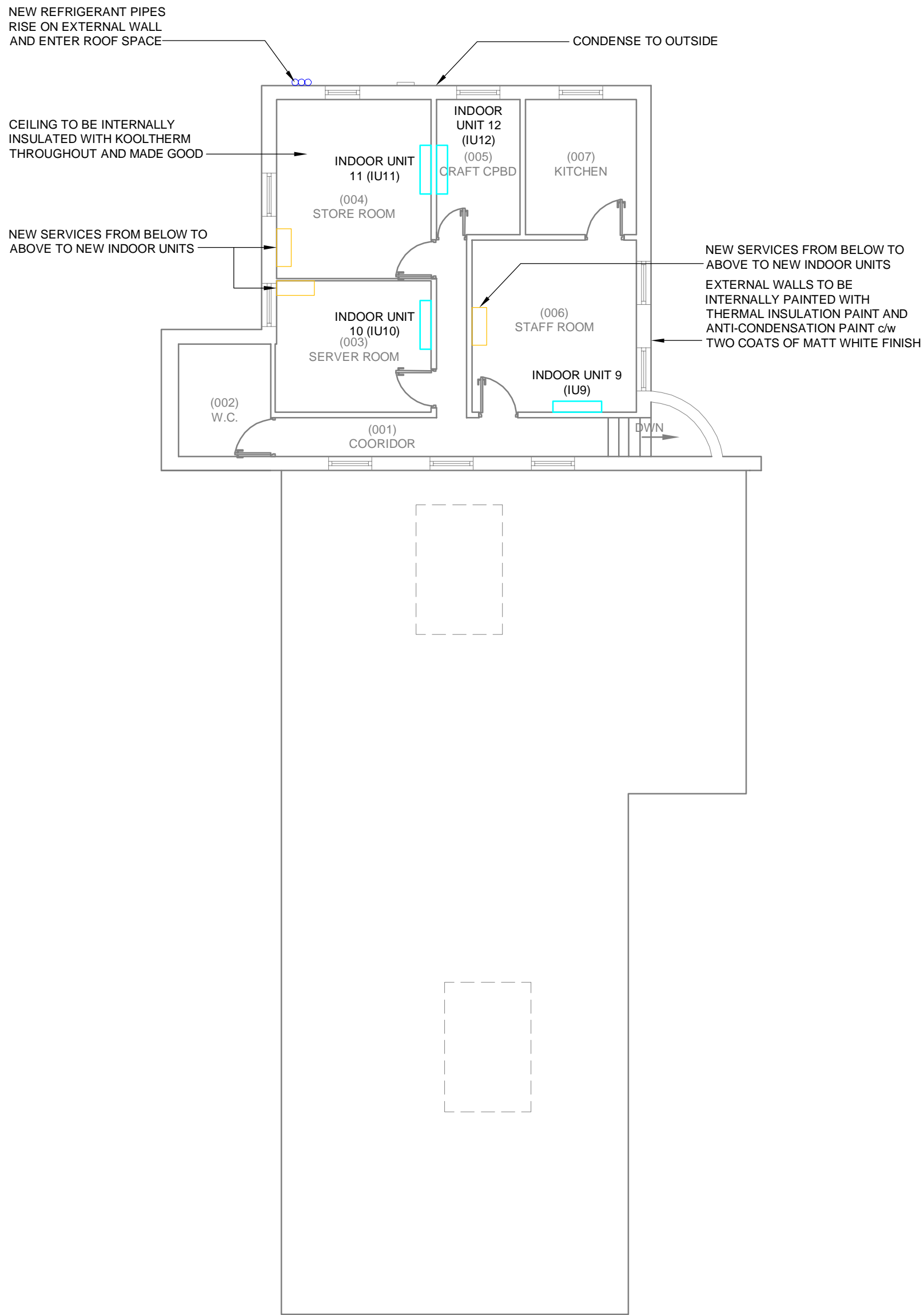

**SECOND FLOOR LAYOUT**  
1:100@A1

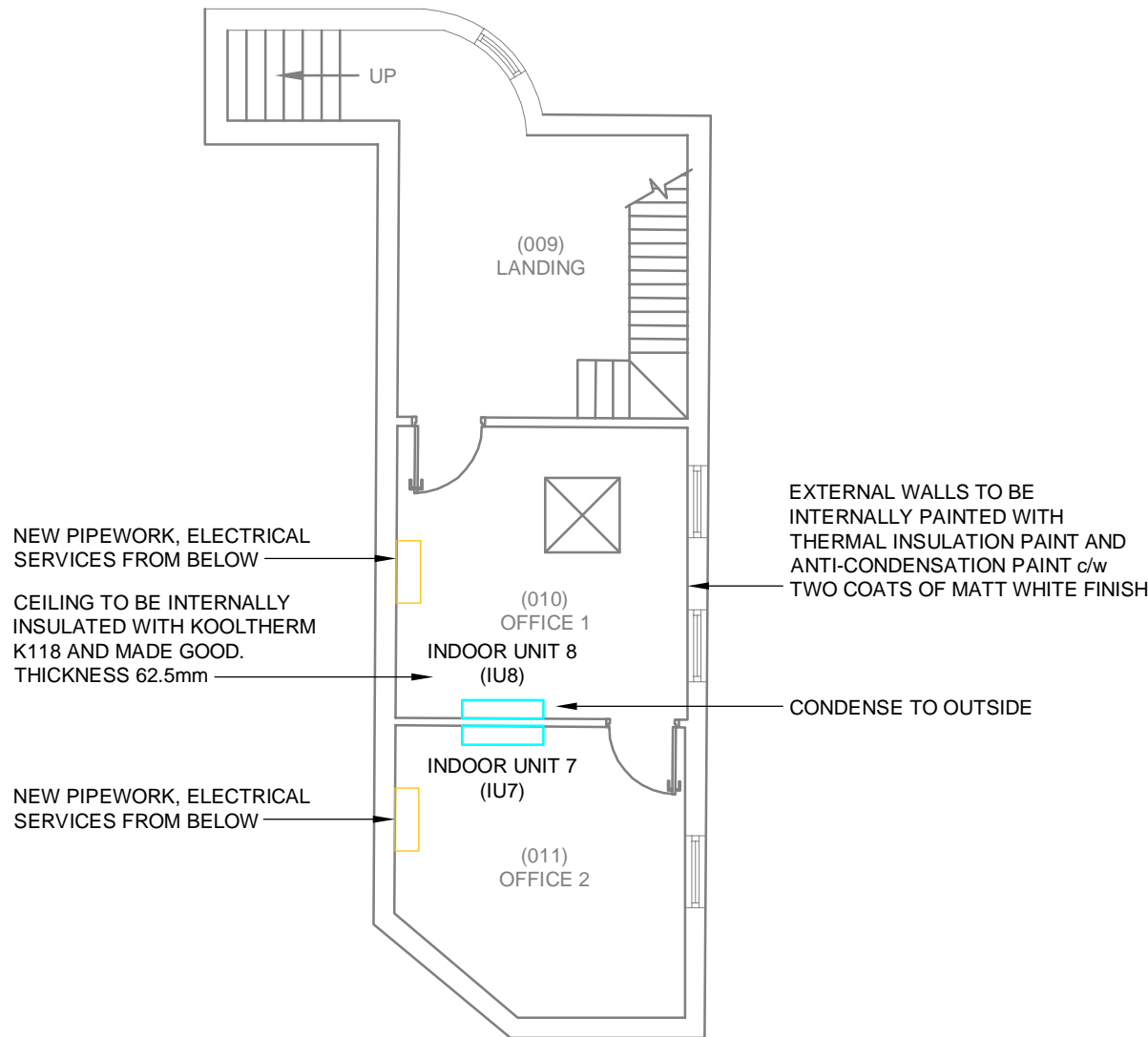

**FIRST FLOOR LAYOUT**  
1:100@A1

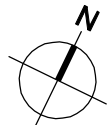

DMP File No.  
Z:\CAD\DMP\DWGS\7277\MECH

**BUILDERSWORK NOTES:**

- ALL INTERNAL FINISHES TO BE CLEANED AND REMOVED OF DEBRIS PRIOR TO INSTALLATION OF INSULATION.
- INSULATION TO BE ADHESIVELY FIXED WHERE POSSIBLE.
- FIRST AND SECOND FLOOR WALLS TO BE PAINTED THROUGHOUT. GROUND FLOOR LOBBY, OFFICES AND STAIRWELL TO BE PAINTED.

**ELECTRICAL NOTES:**

- THE CONTRACTOR IS TO ENSURE THE ELECTRICAL INSTALLATION IS FULLY COMPLIANT WITH BS 7671: 18TH EDITION AND ALL OTHER RELEVANT STANDARDS.

**ELECTRICAL LEGEND:**

- SPN ISOLATOR
- TPN ISOLATOR
- TPN MCB DISTRIBUTION BOARD

**ABBREVIATIONS**

DC DOOR CURTAIN

T1	15.09.21	ISSUED FOR TENDER
T	23.09.20	ISSUED FOR TENDER
REV	DATE	DESCRIPTION



8 Holgate Court, Western Road,  
Romford, Essex, RM1 3JS

Tel: 01708 729070 www.davidmiles.co.uk

project  
**NUNHEAD LIBRARY**

title  
**BASEMENT, GRD, FIRST & SECOND FLOORS  
PROPOSED MECHANICAL, BUILDERSWORK  
& ASSOCIATED ELECTRICAL LAYOUTS**

scale	1:100@A1	date	JULY 2020
drawn	SGK	checked	CW
		rev	T1

drawing no.  
**7277-M-001**

**TENDER**

**DO NOT SCALE FROM THIS DRAWING**  
This drawing is copyright and is the property of David Miles & Partners Ltd.  
It is to be used between the client and the client.  
Any reproduction without the written permission of David Miles & Partners Ltd is strictly prohibited.