

Reproduced by permission of Ordnance Survey on behalf of the Controller of Her Majesty's Stationery Office All rights reserved. © Crown Copyright licence no. 100022432

SITE AREA PLAN

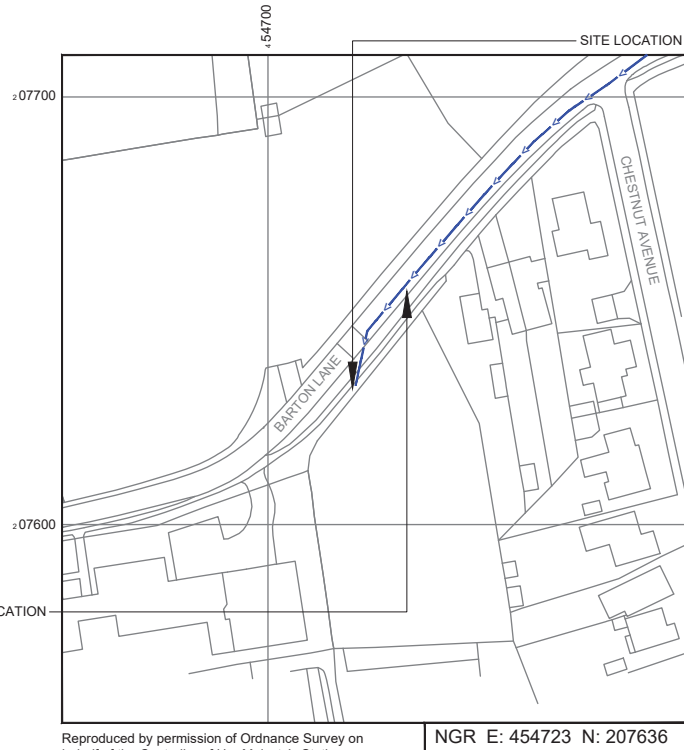

SITE PHOTOGRAPH



Reproduced by permission of Ordnance Survey on behalf of the Controller of Her Majesty's Stationery Office All rights reserved. © Crown Copyright licence no. 100022432

NGR E: 454723 N: 207636

SITE LOCATION PLAN



GOOGLE MAPS QR CODE

GOOGLE MAPS - <https://tinyurl.com/3chdw7kx>

STREETVIEW - <https://tinyurl.com/ntvam774>

NOTES:

1. ALL DIMENSIONS IN MM UNLESS OTHERWISE NOTED.

Access Route To Site:

Directions To Site: -  
 Continue on London Rd/A40  
 Slight left towards Headington Roundabout  
 Use the right lane to turn left onto Headington Roundabout  
 Continue straight onto London Rd/A420  
 Follow Barton Rd and Barton Ln to Chestnut Ave  
 Turn right onto Barton Rd  
 Barton Rd turns left and becomes Barton Ln  
 Turn left onto Chestnut Ave

Arrive at - Barton Ln, Headington, Oxford

REV	MODIFICATION	BY	CH	DATE
A	Issued for Planning	GG	RWB	28.10.21

**CK Hutchison Networks (UK) Limited**

Great Brighams Mead,  
 Vastern Road, Reading,  
 Berkshire, England,  
 RG1 8DJ

Design Consultant & Principal Contractor:



Great British Communications  
 Lapping House, Block 3 Forward Point,  
 Ton House Lane, Widnes, Cheshire, WAB 0SL  
 t. 44 (0)151 420 4128  
[www.gbcservices.co.uk](http://www.gbcservices.co.uk)

Site Name: **BARTON LANE**

BUK Cell ID: **OXD20183**

Address: **BARTON LANE  
 HEADINGTON  
 OXFORD  
 OXFORDSHIRE  
 OX3 9JW**

Title: **002 SITE LOCATION PLAN**

Project: **UNILATERAL SW**

Purpose of Issue: **PLANNING**

MBNL/TMH3G Cell ID:  
**TBC/TBC/OX0645**

Drawing No: **OXD20183\_TBC\_TBC\_OX0645\_REV\_A** Issue: **A**

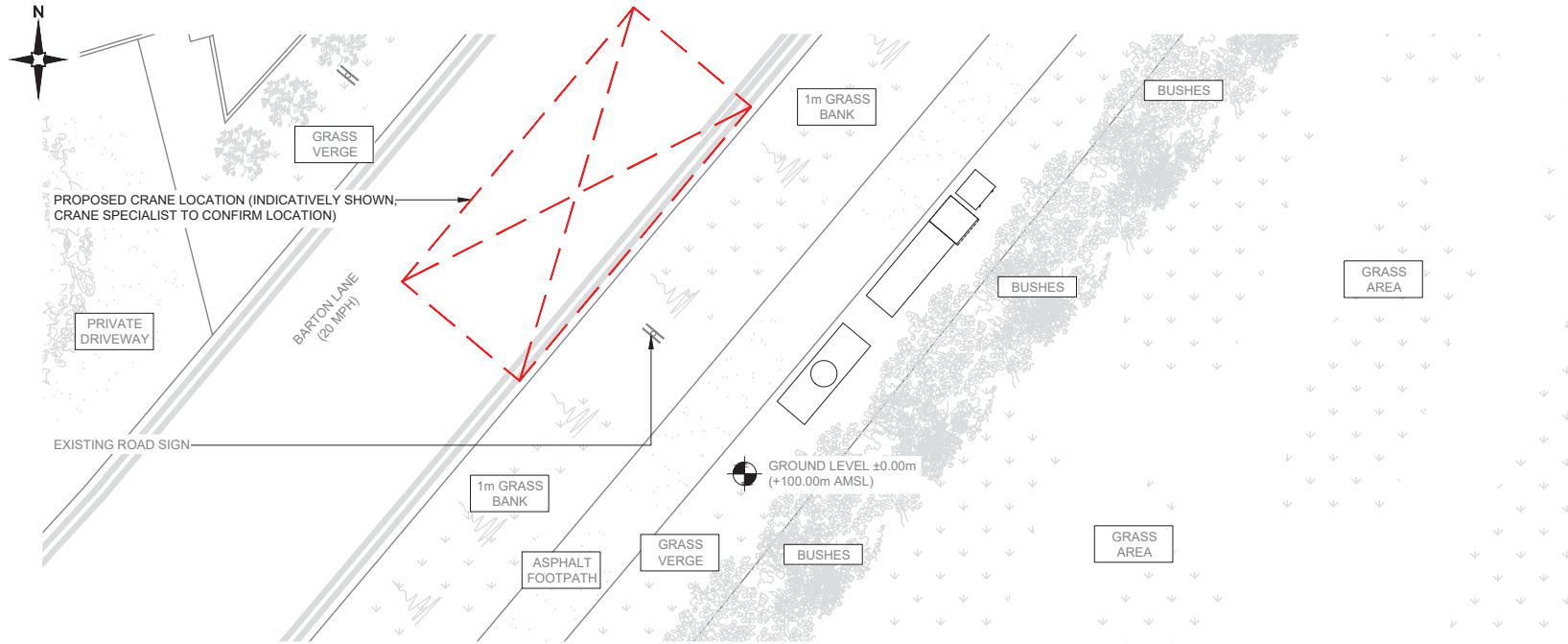

CRANE LOCATION

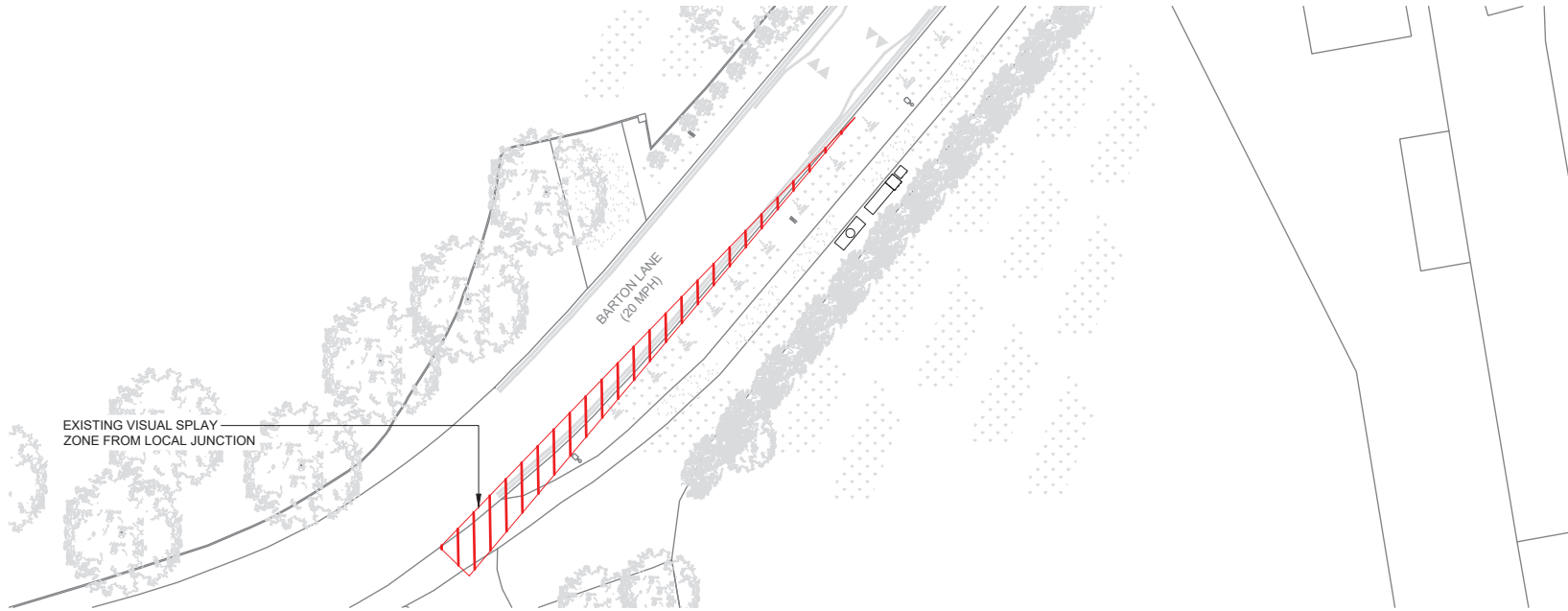
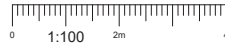

VISUAL SPLAY PLAN

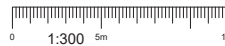

NOTES:  
CRANE LOCATION INDICATIVELY SHOWN. CRANE SPECIALIST TO CONFIRM LOCATION.

 VISUAL SPLAY ZONE.

REV	MODIFICATION	BY	CH	DATE
A	Issued for Planning	GG	RWB	28.10.21

**CK Hutchison Networks (UK) Limited**  
Great Brighams Mead,  
Vastern Road, Reading,  
Berkshire, England,  
RG1 8DJ

Design Consultant & Principal Contractor:  
  
Great British Communications  
Lapwing House, Block 3 Forward Point,  
Ton House Lane, Widnes, Cheshire, W48 0SL  
t. 44 (0)151 420 4128  
www.gbcservices.co.uk

Site Name: **BARTON LANE**

BUK Cell ID: **OXD20183**

Address: **BARTON LANE  
HEADINGTON  
OXFORD  
OXFORDSHIRE  
OX3 9JW**

Title: **005 CRANE LOCATION &  
VISUAL SPLAY PLAN**

Project: **UNILATERAL SW**

Purpose of Issue: **PLANNING**

MBNL/TM/H3G Cell ID:  
**TBC/TBC/OX0645**

Drawing No: **OXD20183\_TBC\_TBC\_OX0645\_REV\_A** Issue: **A**

100mm  
150mm  
10mm

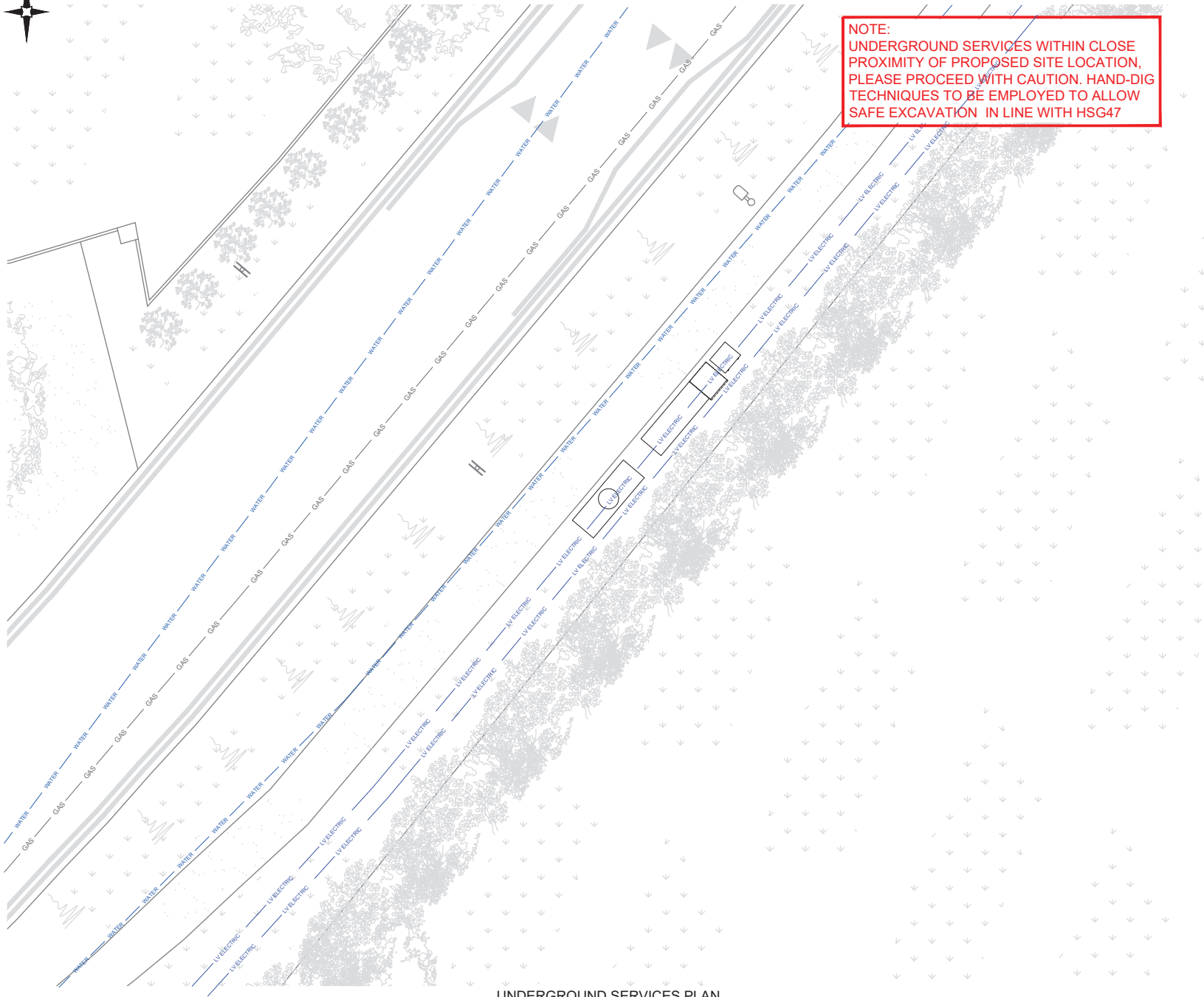

**NOTE:**  
 UNDERGROUND SERVICES WITHIN CLOSE  
 PROXIMITY OF PROPOSED SITE LOCATION,  
 PLEASE PROCEED WITH CAUTION. HAND-DIG  
 TECHNIQUES TO BE EMPLOYED TO ALLOW  
 SAFE EXCAVATION IN LINE WITH HSG47

NOTES:  
 1. ALL DIMENSIONS IN MM UNLESS OTHERWISE NOTED.

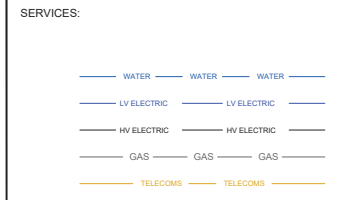

REV	MODIFICATION	BY	CH	DATE
A	Issued for Planning	QG	RWB	28.10.21

**CK Hutchison  
 Networks (UK)  
 Limited**  
 Great Brighams Mead,  
 Vastern Road, Reading,  
 Berkshire, England,  
 RG1 8DJ

Design Consultant & Principal Contractor:

Great British Communications  
 Lapping House, Block 3 Forward Point,  
 Ton House Lane, Widnes, Cheshire, W48 0SL  
 t. 44 (0)151 420 4128  
[www.gbcservices.co.uk](http://www.gbcservices.co.uk)

Site Name: **BARTON LANE**

BUK Cell ID: **OXD20183**

Address: **BARTON LANE  
 HEADINGTON  
 OXFORD  
 OXFORDSHIRE  
 OX3 9JW**

Title: **006 UNDERGROUND SERVICES PLAN**

Project: **UNILATERAL SW**

Purpose of Issue: **PLANNING**

MBNL/TM/H3G Cell ID:  
**TBC/TBC/OX0645**

Drawing No: **OXD20183\_TBC\_TBC\_OX0645\_REV\_A** Issue: **A**

**UNDERGROUND SERVICES PLAN**

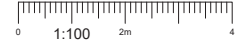

100mm  
 150mm  
 100mm

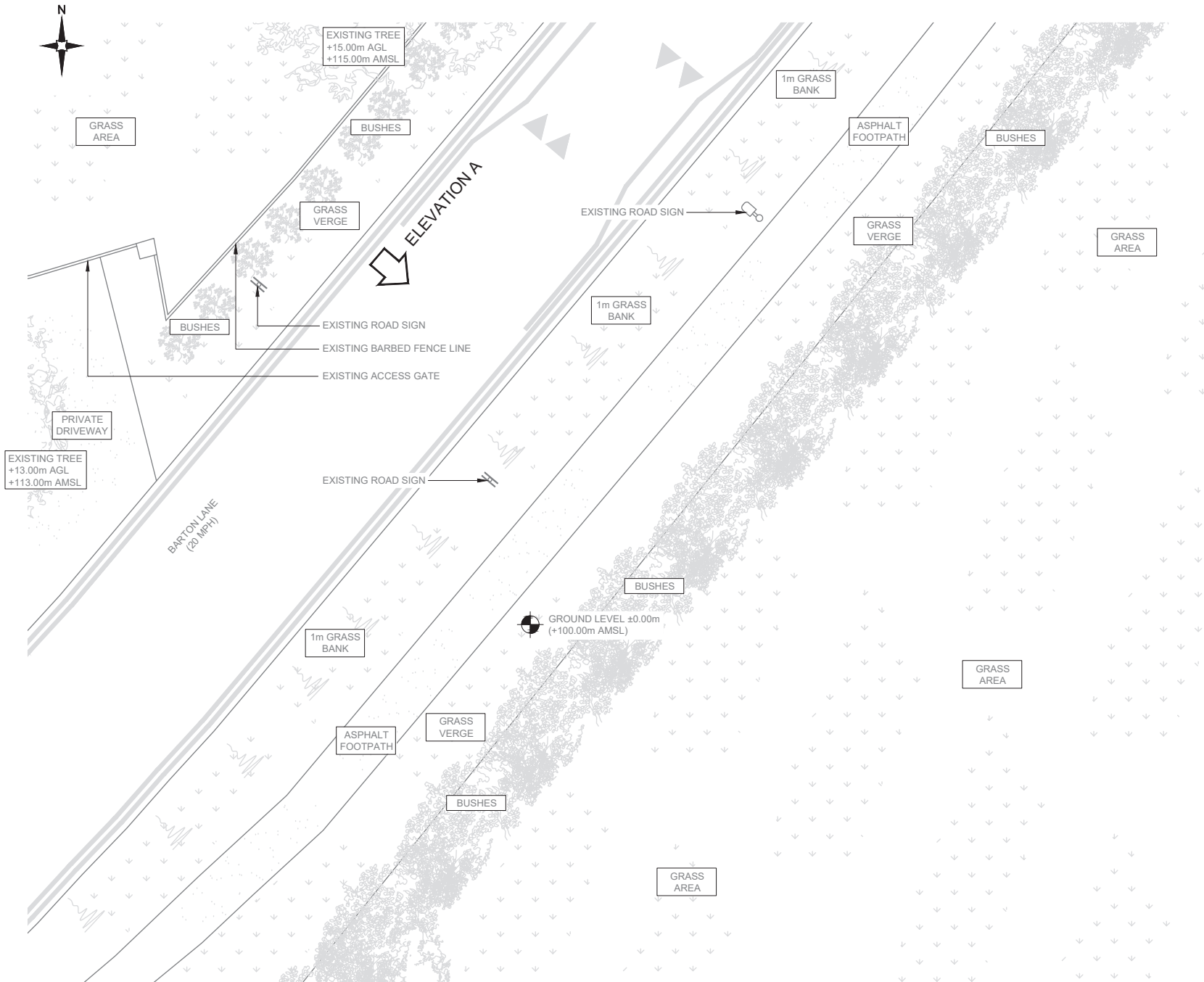

NOTES:

1. ALL DIMENSIONS IN MM UNLESS OTHERWISE NOTED.

REV	MODIFICATION	BY	CH	DATE
A	Issued for Planning	OG	RWB	28.10.21

**CK Hutchison Networks (UK) Limited**

Great Brighams Mead,  
Vastern Road, Reading,  
Berkshire, England,  
RG1 8DJ

Design Consultant & Principal Contractor:



Great British Communications  
Lapwing House, Block 3 Forward Point,  
Ton House Lane, Widnes, Cheshire, W48 0SL  
t. 44 (0)151 420 4128  
www.gbcservices.co.uk

Site Name: **BARTON LANE**

BUK Cell ID: **OXD20183**

Address: **BARTON LANE  
HEADINGTON  
OXFORD  
OXFORDSHIRE  
OX3 9JW**

Title: **100 EXISTING SITE PLAN**

Project: **UNILATERAL SW**

Purpose of Issue: **PLANNING**

MBNL/TM/H3G Cell ID:  
**TBC/TBC/OX0645**

Drawing No: **OXD20183\_TBC\_TBC\_OX0645\_REV\_A** Issue: **A**

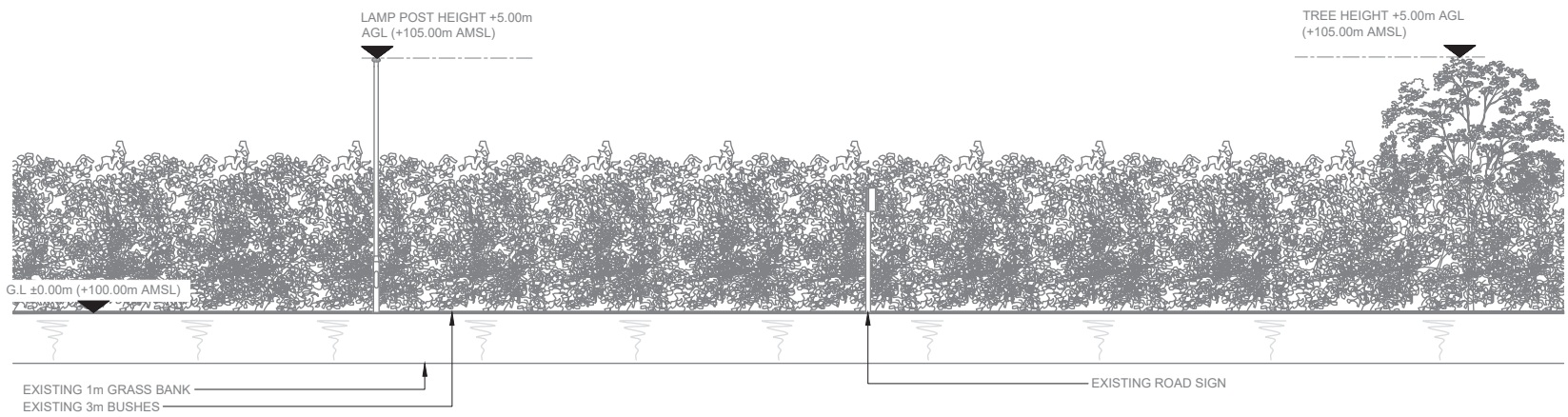

NOTES:  
1. ALL DIMENSIONS IN MM UNLESS OTHERWISE NOTED.

REV	MODIFICATION	BY	CH	DATE
A	Issued for Planning	OG	RWB	28.10.21

**CK Hutchison Networks (UK) Limited**  
 Great Brighams Mead,  
 Vastern Road, Reading,  
 Berkshire, England,  
 RG1 8DJ

Design Consultant & Principal Contractor:

**Great British Communications**  
 Lapwing House, Block 3 Forward Point,  
 Tan House Lane, Widnes, Cheshire, W48 0SL  
 t. 44 (0)151 420 4128  
 www.gbcservices.co.uk

Site Name: **BARTON LANE**

BUK Cell ID: **OXD20183**

Address: **BARTON LANE  
 HEADINGTON  
 OXFORD  
 OXFORDSHIRE  
 OX3 9JW**

Title: **150 EXISTING SITE ELEVATION**

Project: **UNILATERAL SW**

Purpose of Issue: **PLANNING**

MBNL/TM/H3G Cell ID:  
**TBC/TBC/OX0645**

Drawing No: **OXD20183\_TBC\_TBC\_OX0645\_REV\_A** Issue: **A**

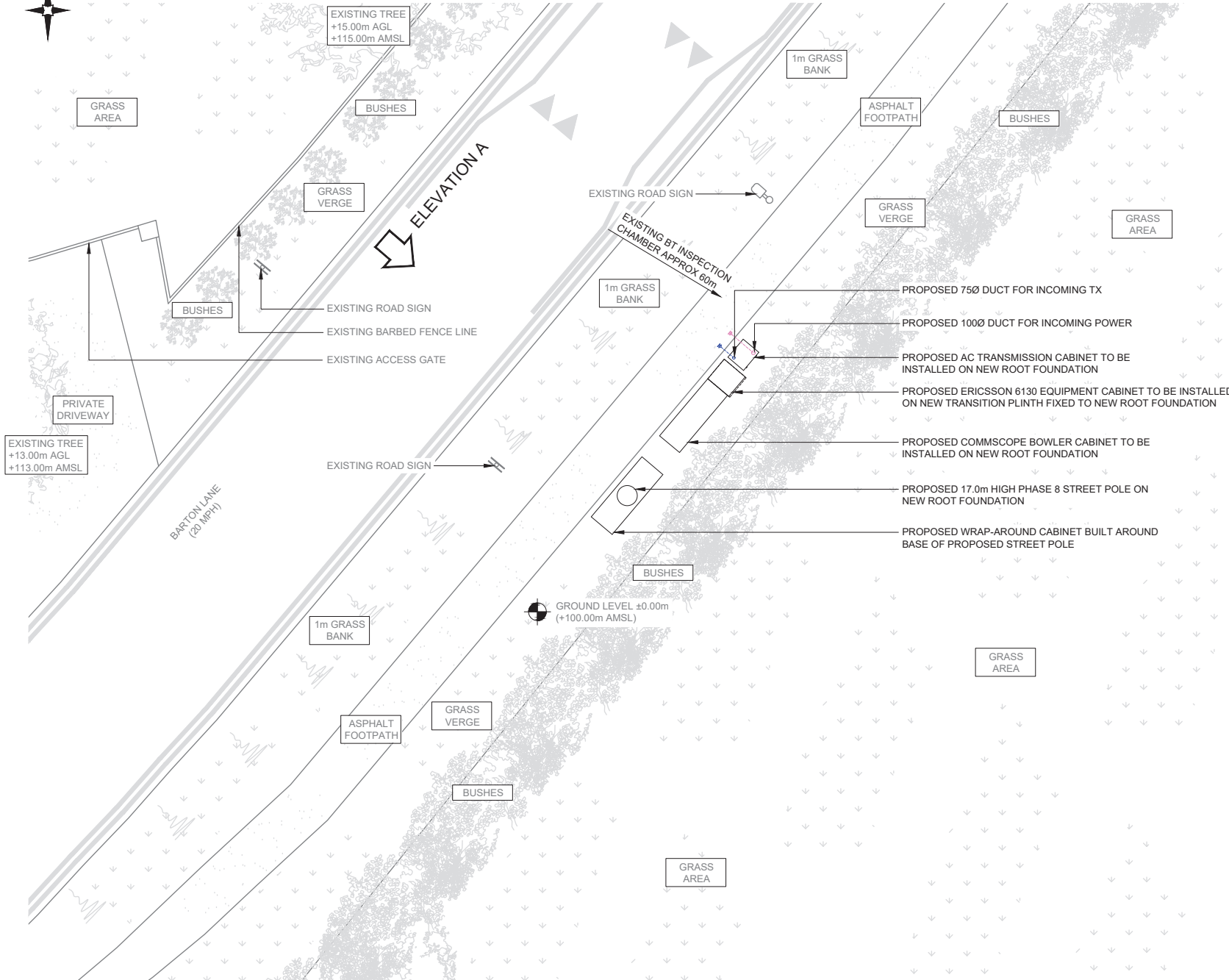

PROPOSED SITE PLAN

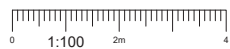

NOTES:

- ALL DIMENSIONS IN MM UNLESS OTHERWISE NOTED.

REV	MODIFICATION	BY	CH	DATE
A	Issued for Planning	OG	RWB	28.10.21

**CK Hutchison Networks (UK) Limited**

Great Brighams Mead,  
Vastern Road, Reading,  
Berkshire, England,  
RG1 8DJ

Design Consultant & Principal Contractor:



Great British Communications  
Lapwing House, Block 3 Forward Point,  
Ton House Lane, Widnes, Cheshire, W48 0SL  
t. 44 (0)151 420 4128  
www.gbcservices.co.uk

Site Name: **BARTON LANE**

BUK Cell ID: **OXD20183**

Address: **BARTON LANE  
HEADINGTON  
OXFORD  
OXFORDSHIRE  
OX3 9JW**

Title: **215 PROPOSED SITE PLAN**

Project: **UNILATERAL SW**

Purpose of issue: **PLANNING**

MBNL/TM/H3G Cell ID:  
**TBC/TBC/OX0645**

Drawing No: **OXD20183\_TBC\_TBC\_OX0645\_REV\_A** Issue: **A**

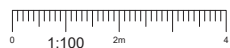
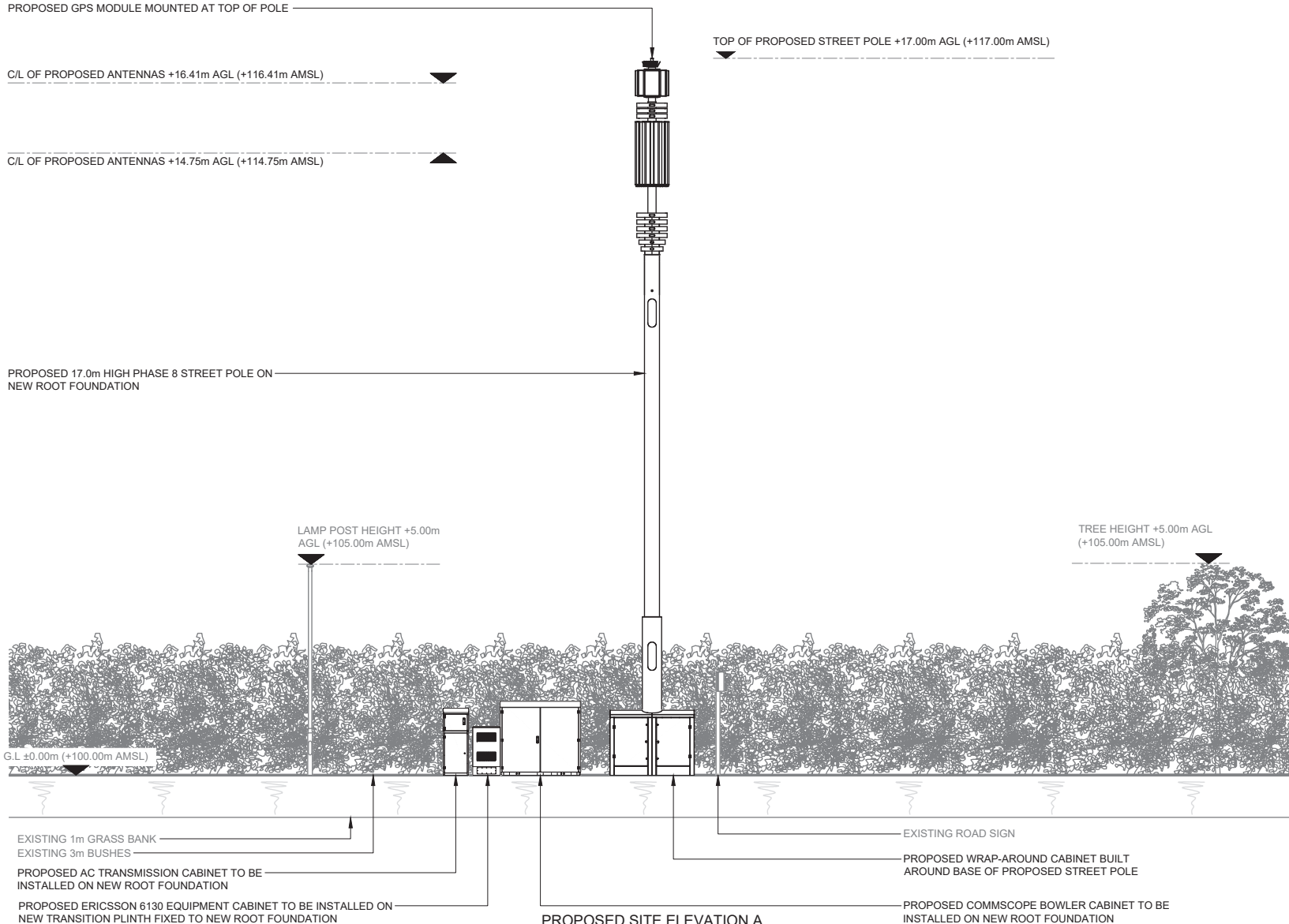

NOTES:

- ALL DIMENSIONS IN MM UNLESS OTHERWISE NOTED.

REV	MODIFICATION	BY	CH	DATE
A	Issued for Planning	OG	RWB	28.10.21

**CK Hutchison Networks (UK) Limited**  
 Great Brighams Mead,  
 Vastern Road, Reading,  
 Berkshire, England,  
 RG1 8DJ

Design Consultant & Principal Contractor:

**GBC**  
 Great British Communications  
 Lapwing House, Block 3 Forward Point,  
 Tan House Lane, Widnes, Cheshire, W48 0SL  
 t. 44 (0)151 420 4128  
 www.gbcservices.co.uk

Site Name: **BARTON LANE**

BUK Cell ID: **OXD20183**

Address: **BARTON LANE  
 HEADINGTON  
 OXFORD  
 OXFORDSHIRE  
 OX3 9JW**

Title: **265 PROPOSED SITE ELEVATION**

Project: **UNILATERAL SW**

Purpose of Issue: **PLANNING**

MBNL/TM/H3G Cell ID:  
**TBC/TBC/OX0645**

Drawing No: **OXD20183\_TBC\_TBC\_OX0645\_REV\_A** Issue: **A**

PROPOSED ANTENNA & RF EQUIPMENT SCHEDULE

EXISTING/PROPOSED	ANTENNA REFERENCE	FUNCTION	FEEDER/FIBRE							BIAS T's/RRU's		ANTENNAS									
			LENGTH(m) & DIAMETER (SEE GUIDANCE NOTES BELOW)			TYPE (COAX OR FIBRE)	FEEDERS QTY	FIBRE QTY	FIBRE LENGTH	FILTER	DIPLEXER	BIAS T	RRU QTY (HL= HIGH LEVEL, E= ENCLOSURE)	ANT. REF.	ANTENNA MANUFACTURERS PART No.	BRG°	HEIGHT TO TOP (m)	HEIGHT TO C/L (m)	HEIGHT TO U/S (m)	LOCATION (POLE MOUNTED, HEADFRAME, WITHIN SHRPOUD ETC)	
			MF1	MF(J1)	TOTAL																
SECTOR 1 PROPOSED	A1	5G	-	-	-	DC FIBRE	-	3	21m	-	-	-	-	A1a	AIR 3278	50°	16.72	16.41	16.10	UPPER HEADFRAME	
	A2	800	1/2"=14	1/2"=7m <sup>2</sup>	21m	DC FIBRE+COAX	4	-	-	-	-	-	E	A2a A2b A2c A2d A2e A2f A2g	HUAWEI AHP4517R12v06	50°	15.50	14.75	14.00	LOWER HEADFRAME	
		1400	1/2"=14	1/2"=7m <sup>2</sup>	21m	DC FIBRE+COAX	4	-	-	1	-	-	E								
		1800 /2100	1/2"=14	1/2"=7m <sup>2</sup>	21m	DC FIBRE+COAX	4	-	-	-	-	1	-								E
		-	-	-	-	-	-	-	-	-	-	-	-								-
		-	-	-	-	-	-	-	-	-	-	-	-								-
		-	-	-	-	-	-	-	-	-	-	-	-								-
-	-	-	-	-	-	-	-	-	-	-	-	-									
SECTOR 2 PROPOSED	B1	5G	-	-	-	DC FIBRE	-	3	21m	-	-	-	-	B1a	AIR 3278	240°	16.72	16.41	16.10	UPPER HEADFRAME	
	B2	800	1/2"=14	1/2"=7m <sup>2</sup>	21m	DC FIBRE+COAX	4	-	-	-	-	-	E	B2a B2b B2c B2d B2e B2f B2g	HUAWEI AHP4517R12v06	240°	15.50	14.75	14.00	LOWER HEADFRAME	
		1400	1/2"=14	1/2"=7m <sup>2</sup>	21m	DC FIBRE+COAX	4	-	-	1	-	-	E								
		1800 /2100	1/2"=14	1/2"=7m <sup>2</sup>	21m	DC FIBRE+COAX	4	-	-	-	-	1	-								E
		-	-	-	-	-	-	-	-	-	-	-	-								-
		-	-	-	-	-	-	-	-	-	-	-	-								-
		-	-	-	-	-	-	-	-	-	-	-	-								-
-	-	-	-	-	-	-	-	-	-	-	-	-									

GPS LINE KEY

SECTOR ID	NODE TYPE	NODE C/L (m) AGL	GPS NODE CABLE LENGTH (m)
1	GPS	17.00m	35m

REV	MODIFICATION	BY	CH	DATE
A	Issued for Planning	OG	RWB	28.10.21

CK Hutchison Networks (UK) Limited

Great Brighams Mead,  
Vastern Road, Reading,  
Berkshire, England,  
RG1 8DJ

Design Consultant & Principal Contractor:



Great British Communications  
Lapwing House, Block 3 Forward Point,  
Tan House Lane, Widnes, Cheshire, W48 0SL  
t. 44 (0)151 420 4128  
www.gbcservices.co.uk

Site Name:	BARTON LANE
BUK Cell ID:	OXD20183
Address:	BARTON LANE HEADINGTON OXFORD OXFORDSHIRE OX3 9JW
Title:	304 PROPOSED CONFIGURATION ANTENNA SCHEDULE
Project:	UNILATERAL SW
Purpose of Issue:	PLANNING
MBNL/TM/H3G Cell ID:	TBC/TBC/OX0645
Drawing No:	OXD20183_TBC_TBC_OX0645_REV_A
Issue:	A

100mm  
150mm  
10mm



Support Structure Schedule

Structure ID	Status	Equipment Description / Type	Structure Manufacturer	Height AGL (m)	Colour (RAL Colour)	Headframe Details	Foundation / Support Grillage / Host Structure Details	Support Bolt Details	MBNL Ref:	Comments
ST1	PROPOSED	PHASE 8 POLE	HEL / VALMONT	17.00m	GREEN-6021	-	ROOT	-	N/A	WITH WRAPAROUND CABINET

Equipment Schedule

Equipment ID	Quantity	Status	Equipment Description / Type	Equipment Manufacturer	Dimensions (W x D x H)	Weight (kg)	Colour (RAL Colour)	Material	Location	Power	Power cable length (m)	MBNL Ref:	Comments
CAB1	1	PROPOSED	AC TRANSMISSION	COMMScope	600x500x1585	110	GREEN-6021	STEEL	OUTDOOR	-	-	-	FIBRE ONLY - TX SUPPLIER TBC
CAB2	1	PROPOSED	6130	ERICSSON	650x700x950	130	GREEN-6021	STEEL	OUTDOOR	-	-	-	COMPLETE WITH TRANSITION PLINTH
CAB3	1	PROPOSED	BOWLER	COMMScope	1900x600x1752	220	GREEN-6021	STEEL	OUTDOOR	-	-	-	

DEPENDENCY	STATUS
RF Compliance	Sector A - Step 1.0 SW Sector B - Step 1.0 SW
Building Regulations Approval	N/A
Asbestos	N/A
Planning Conditions	TBC by Local Authority
Geotech Report	N/A
Structural Calculations	N/A
Intrusive Building Survey	N/A
Global Design Check	N/A
Rigging Survey	N/A
FIXITS	Fixit Required - Passing distance 1300mm.
Power	Proposed 1 phase 100A supply - DNO Quote Approval Required
Transmission Solution	Fibre only
Cooling Solution	Manufacturers Cooling
Line of Site Survey	N/A
Services Search	Completed - 11/10/21
Trial Hole Report	Pending
Other	-

REV	MODIFICATION	BY	CH	DATE
A	Issued for Planning	OG	RWB	28.10.21

**CK Hutchison Networks (UK) Limited**

Great Brighams Mead,  
Vastern Road, Reading,  
Berkshire, England,  
RG1 8DJ

Design Consultant & Principal Contractor:



Great British Communications  
Lapwing House, Block 3 Forward Point,  
Tan House Lane, Widnes, Cheshire, W48 0SL  
t. 44 (0)151 420 4128  
www.gbcservices.co.uk

Site Name: **BARTON LANE**

BUK Cell ID: **OXD20183**

Address: **BARTON LANE  
HEADINGTON  
OXFORD  
OXFORDSHIRE  
OX3 9JW**

Title: **307 EQUIPMENT SCHEDULES & DEPENDENCIES**

Project: **UNILATERAL SW**

Purpose of Issue: **PLANNING**

MBNL/TMH3G Cell ID:  
**TBC/TBC/OX0645**

Drawing No: **OXD20183\_TBC\_TBC\_OX0645\_REV\_A** Issue: **A**

100mm  
150mm  
100mm