

PARTIAL PROPOSED LAYOUT PLANS

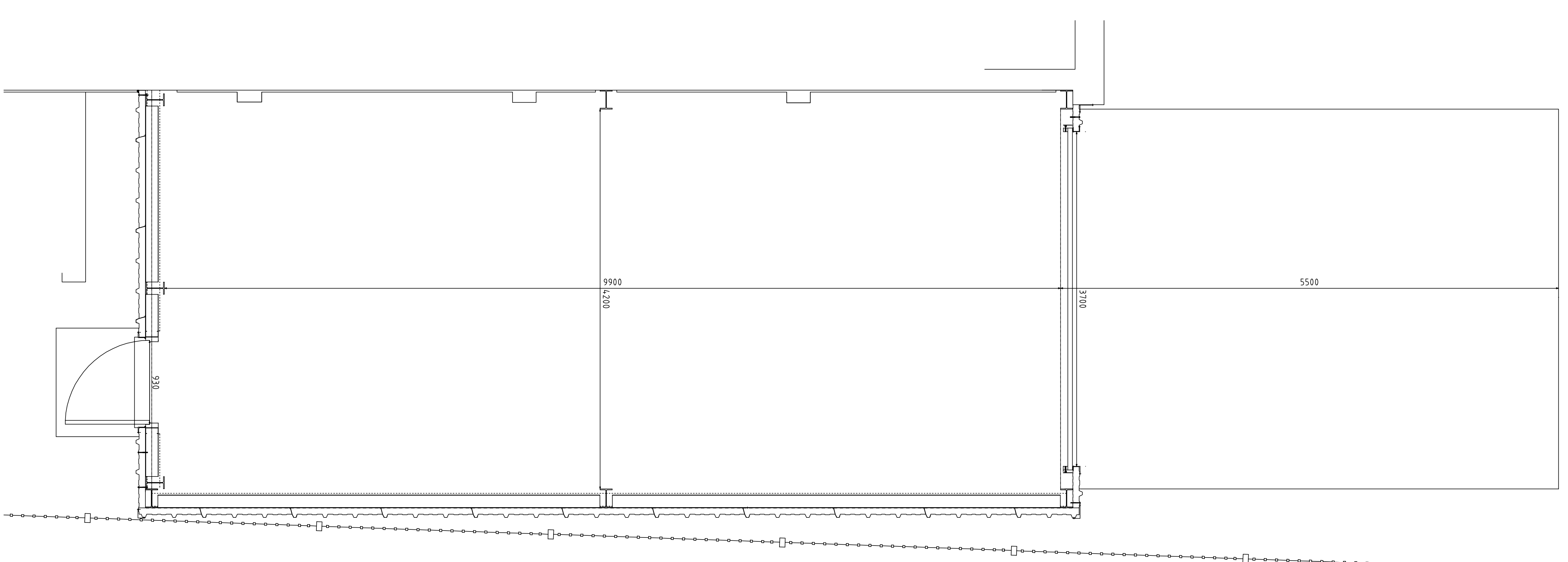

PARTIAL PROPOSED LAYOUT PLANS

Approved
GAR-M-TYRE
 712 EDINBURGH ROAD
 GLASGOW
 G33 3PU

Project
 PROPOSED EXTENSION TO EXISTING GARAGE TO FORM
 M.O.T. STATION AT 712 EDINBURGH ROAD GLASGOW G33
 3PU

Drawn by
 Scale
 1:50 & 1:25

The
 PARTIAL PROPOSED GARAGE FLOOR PLANS AND PROPOSED
 PLANS OF M.O.T. STATION
 Plan Number
 MH712E020202 BUILD PLAN A Date
 March 2022