

Existing Floor Plans

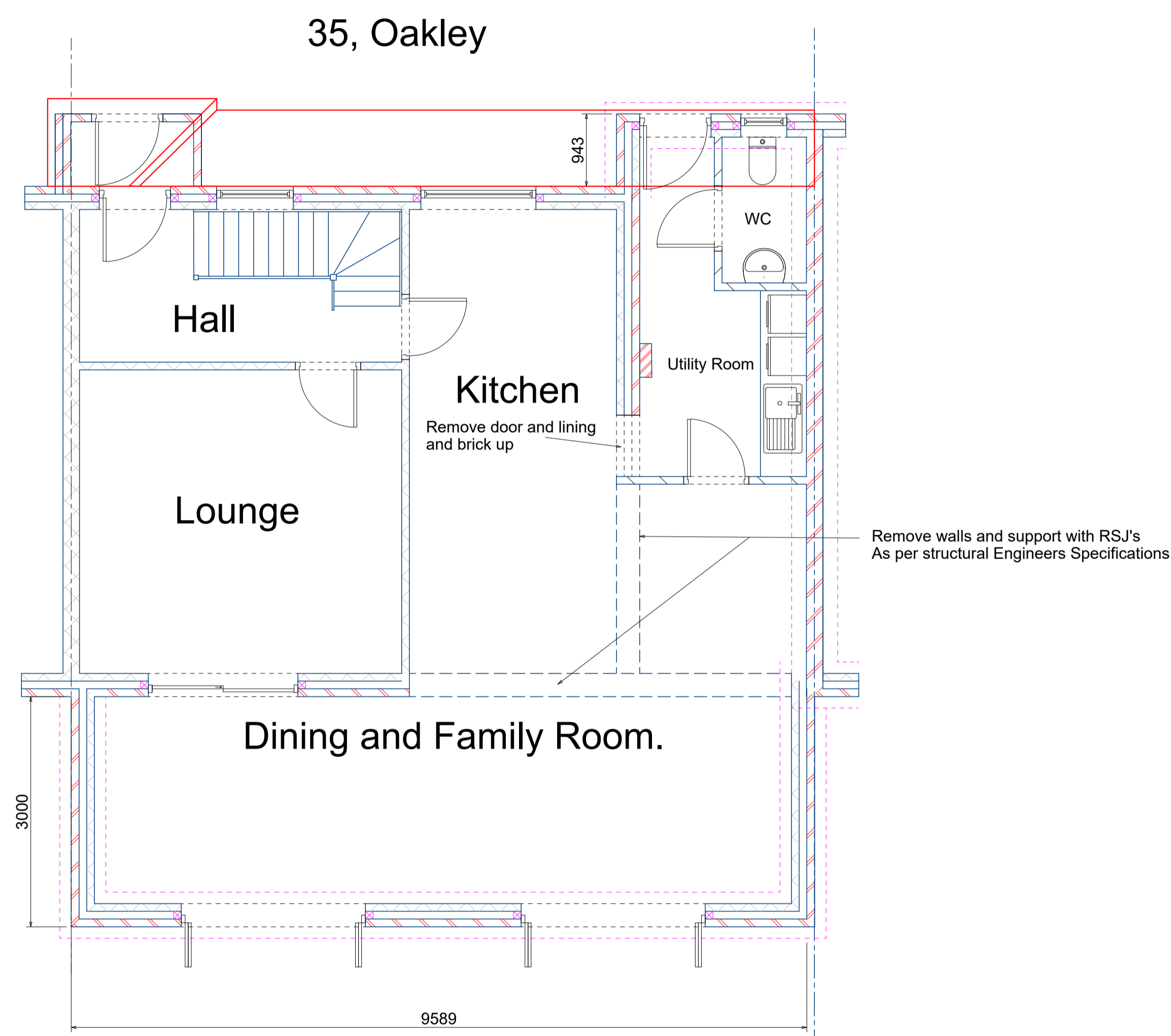

Proposed Floor Plans



Wards Construction Design

Project: Home Extension

Client  
Geoffrey & Madeline Fielder  
35, Oakley  
Fen End  
CV8 1QE

Drawing Title  
Planning / Existing and Proposed Floor Plans

Drawing No. 1.

Date  
February 2022

Drawn by  
Stephen Ward

Scale  
1:50

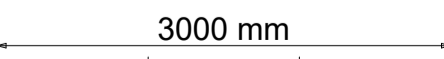
Page Size - A1 

46, Conway Ave, Coventry CV4 9HZ  
Mob: 07973756505  
E mail: info@wardsconstruction.co.uk