

GENERAL NOTES

Do NOT scale from this drawing. Use dimensions illustrated only. All dimensions and levels are in millimeters. All dimensions and levels shall be verified on site before proceeding with works. The Architect must be notified of any discrepancy.

This drawing is the property of Stem Architects Ltd. Copyright is reserved by them and the drawing issued on the condition that it is not copied, reproduced, retained or disclosed to any unauthorised person, either wholly or in part without the consent in writing of Stem Architects Ltd

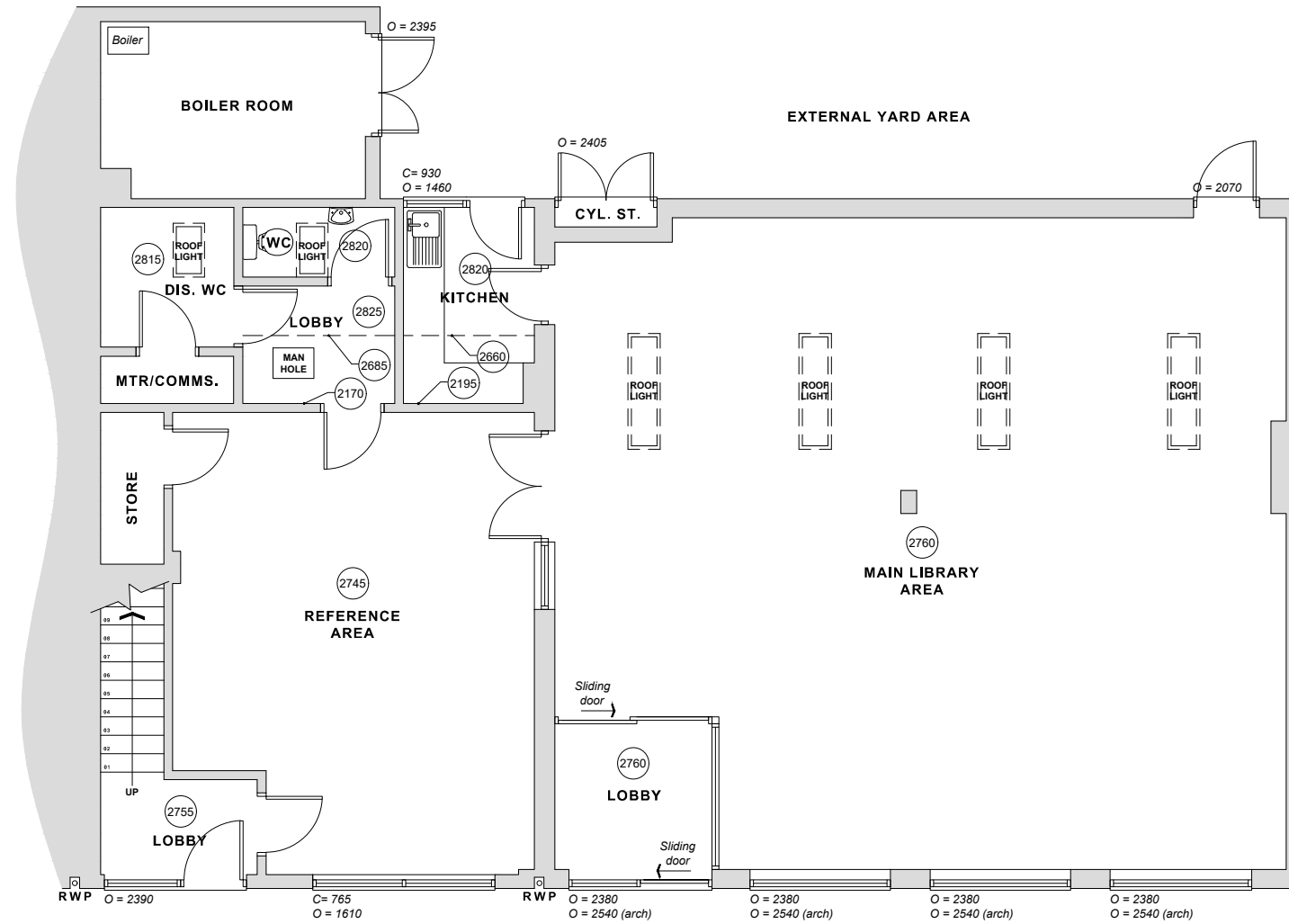

EXISTING GROUND FLOOR PLAN
1:100 @ A3

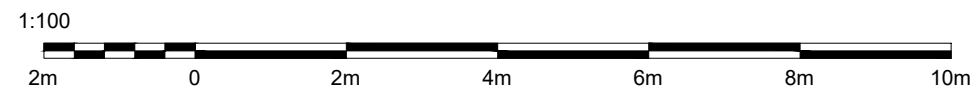

Description	Date	Drwn
CLIENT	Alford Library and Focal Point	
ADDRESS	6 South Market Place	
	Alford	
	Lincolnshire LN13 9AF	

stem Architects Ltd

22 Brayford Wharf North
Lincoln
LN1 1BN

E info@stemarchitects.co.uk
T +44 (0)1522 515900

stemarchitects.co.uk

Lincoln Hull

PROJECT.	Alford Library and Focal Point	
No.	COM_576	
DWG TITLE.	Existing Ground Floor Plan	
DWG No.	0003	REV *
DRWN BY.	BSC	CHECKED BY. NS
SCALE.	A3@ 1:100	DATE 20.12.2021
STATUS.	PRELIMINARY	