

NOTE THE PROPERTY OF THIS DRAWING AND DESIGN IS VESTED IN KEY TRANSPORT CONSULTANTS LIMITED AND MUST NOT BE COPIED OR REPRODUCED IN ANY WAY WITHOUT THEIR WRITTEN CONSENT

CAD FILE NAME : F:\DATA\Jobs\1166 Abbotts Way, Almondsbury\AutoCAD\1166-001\_1166-002.dwg

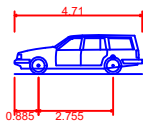
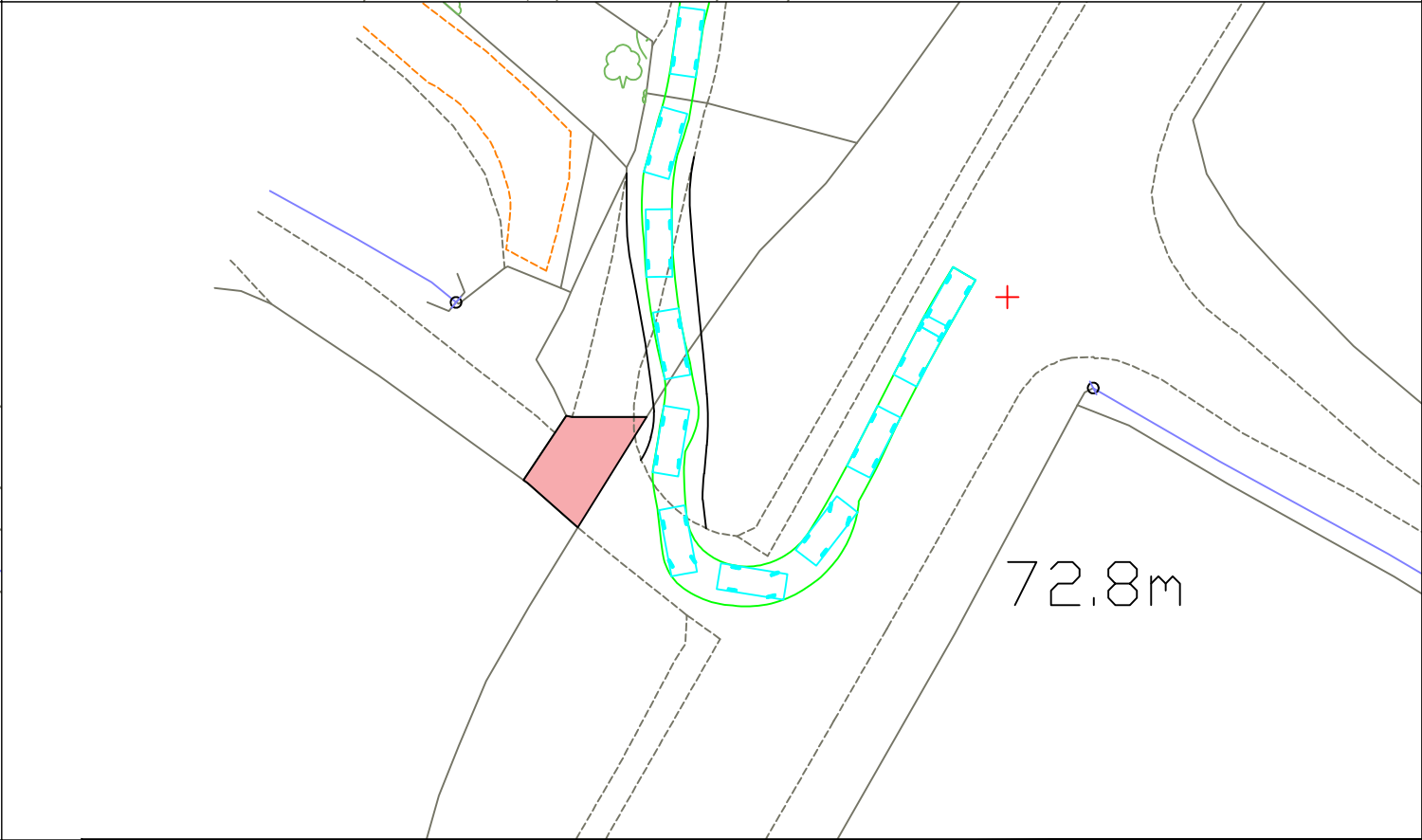
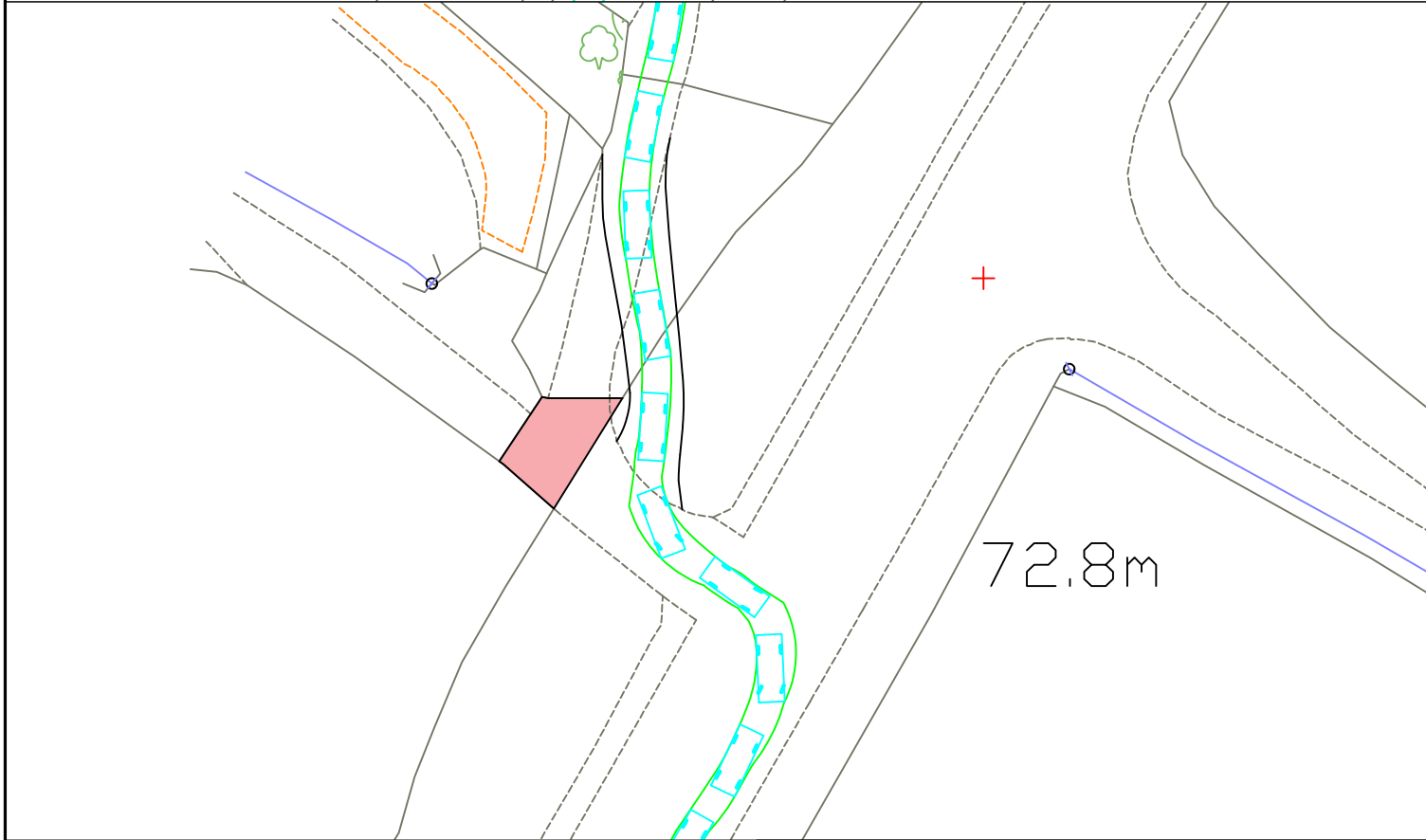
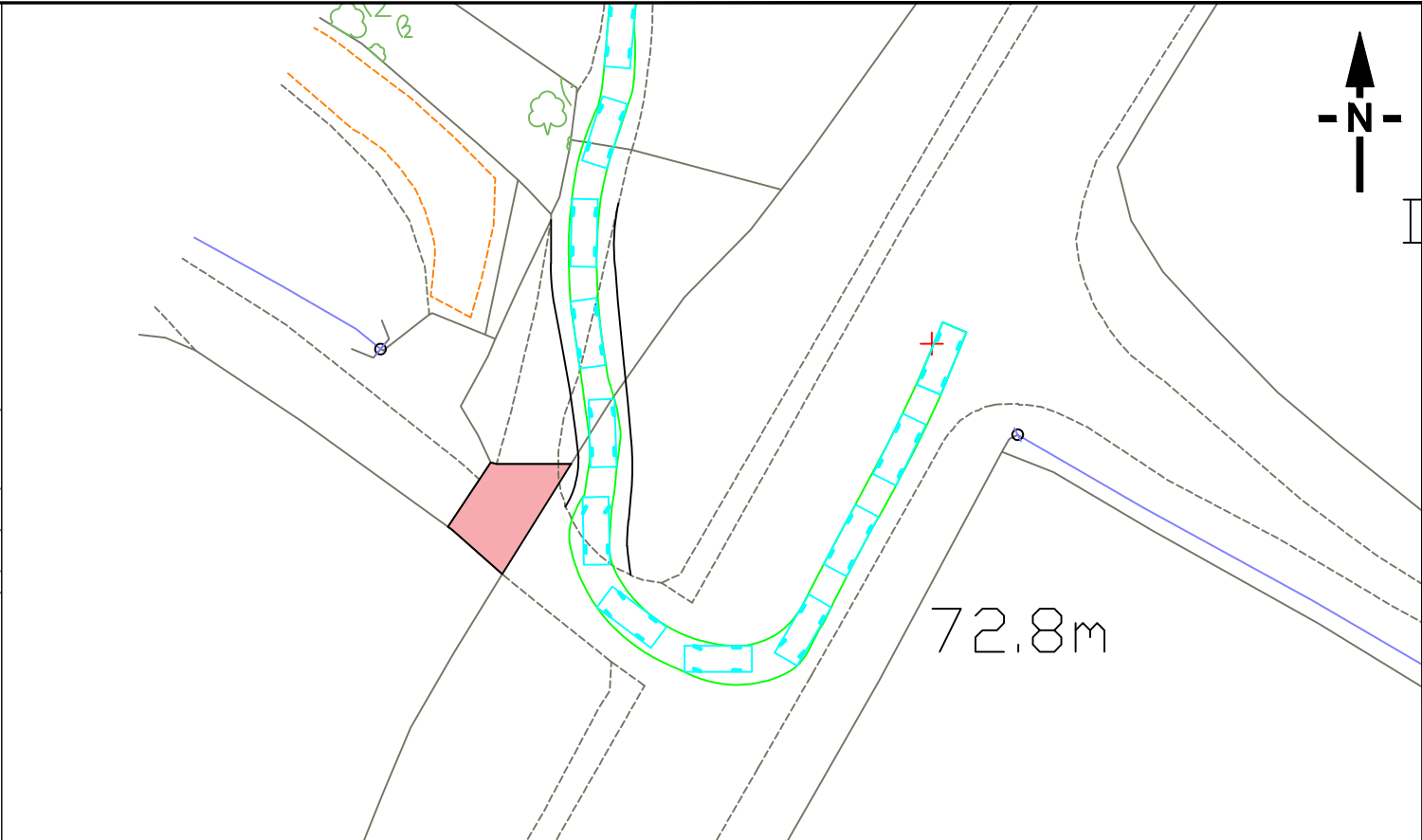
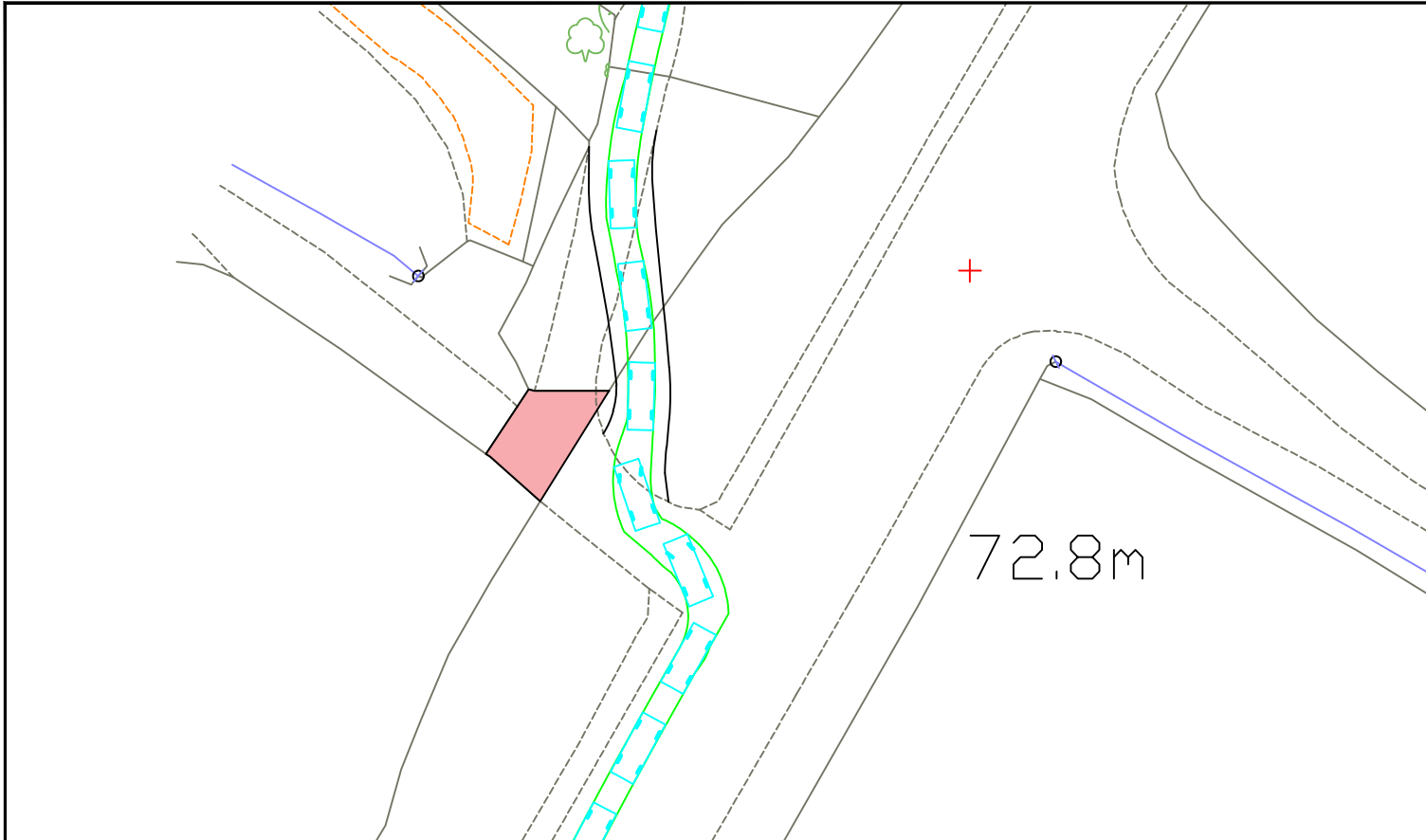

Estate Car (2006)  
Overall Length 4.710m  
Overall Width 1.804m  
Overall Body Height 1.442m  
Min Body Ground Clearance 0.207m  
Max Track Width 1.756m  
Lock to lock time 4.00s  
Kerb to Kerb Turning Radius 5.950m

ABBOTTS WAY, ALMONDSBURY

ESTATE CAR VEHICLE TRACKING FOR THE  
PROPOSED DRIVEWAY

DRAWN BY	CHECKED BY	PASSED BY	DATE	SCALES @ A3 SIZE	ISSUE STATUS
VB	SM	SM	JAN 22	1:500@A3	PRELIMINARY

NEAL DAVIES



KEY TRANSPORT CONSULTANTS LTD  
26 BERKELEY SQUARE  
BRISTOL  
BS8 1HP  
Tel : 0117 920 9430  
E-mail : info@key-transport.com

DRAWING NUMBER	REV.
1166-002	

REV	DR	CH	PA	DATE