

KEY	
	New doors
	New external works
	New handrails/balustrade
	Site boundary
	Parking bays
	Vehicle access
	Building access

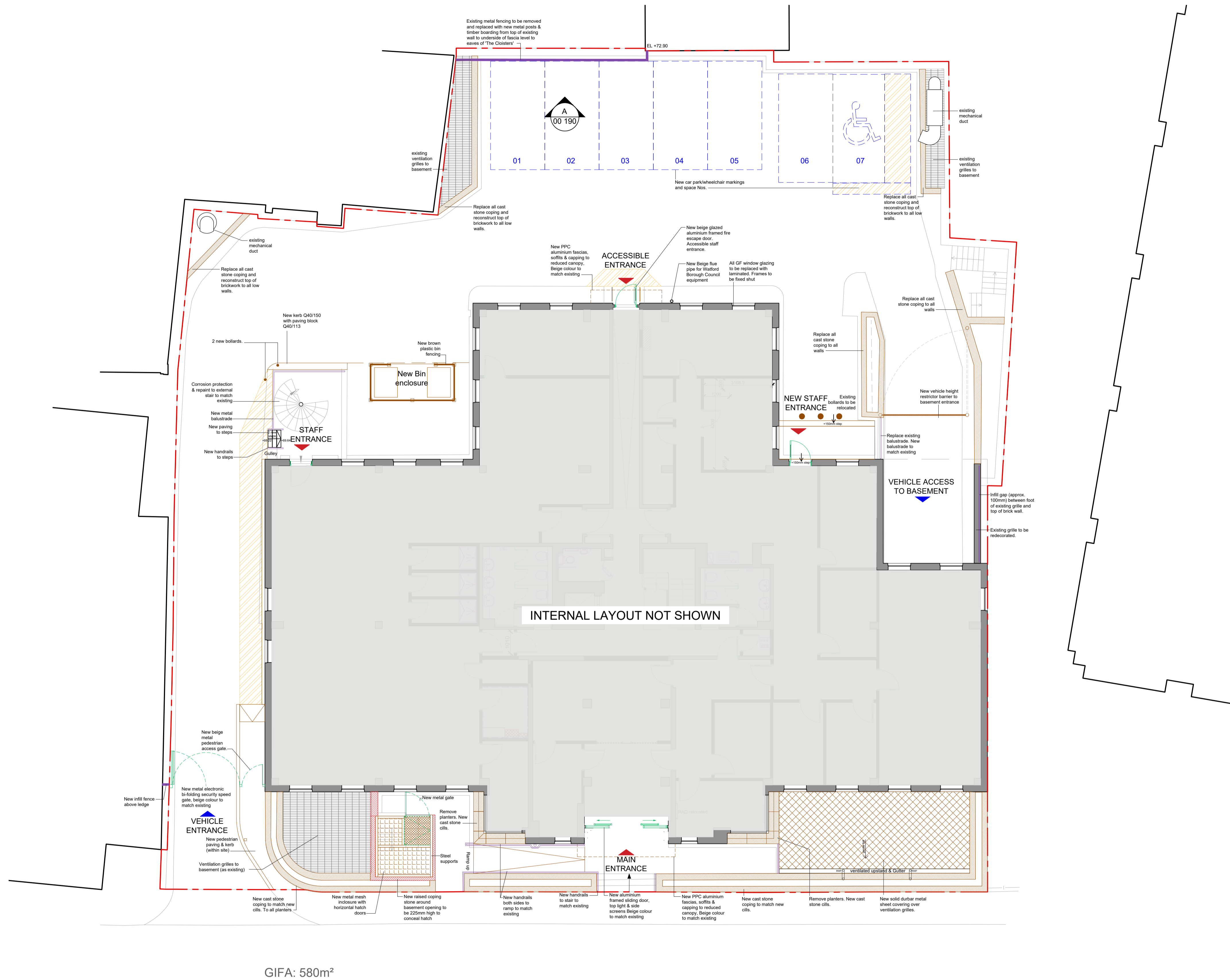

GIFA: 580m²

REV	DESCRIPTION	DATE	BY
A	PLANNING ISSUE	29.04.22	JP

WATFORD POLICE STATION
3 GEORGE STREET
WATFORD WD18 0BX

Proposed External
Ground Floor Plan

VGA PROJECT NUMBER		L&L
7664		
DRAWING NO		REV
WPS-VGA-GS-00-DR-AR-00 160		A
DRAWN / DATE	CHECKED / DATE	SCALE
JP / APR 22	AR / APR 22	1:100 at A1

PLANNING

Written dimensions to be taken. Do not scale off the drawings. Any discrepancies written or scaled should be brought to the attention of the architect immediately. All drawings should be read together and in conjunction with relevant related specifications, room data sheets and all other consultant's information.

T: +44 (0) 1438 316 331
 architects@vincent-gorbing.co.uk
vincent-gorbing.co.uk

Vincent and Gorbing Limited, Sterling Court
 Norton Road, Stevenage, Hertfordshire SG1 2JY
 © Copyright Vincent and Gorbing Limited 2020

