

*LIFT TO BE CONFIRMED BY SPECIALIST

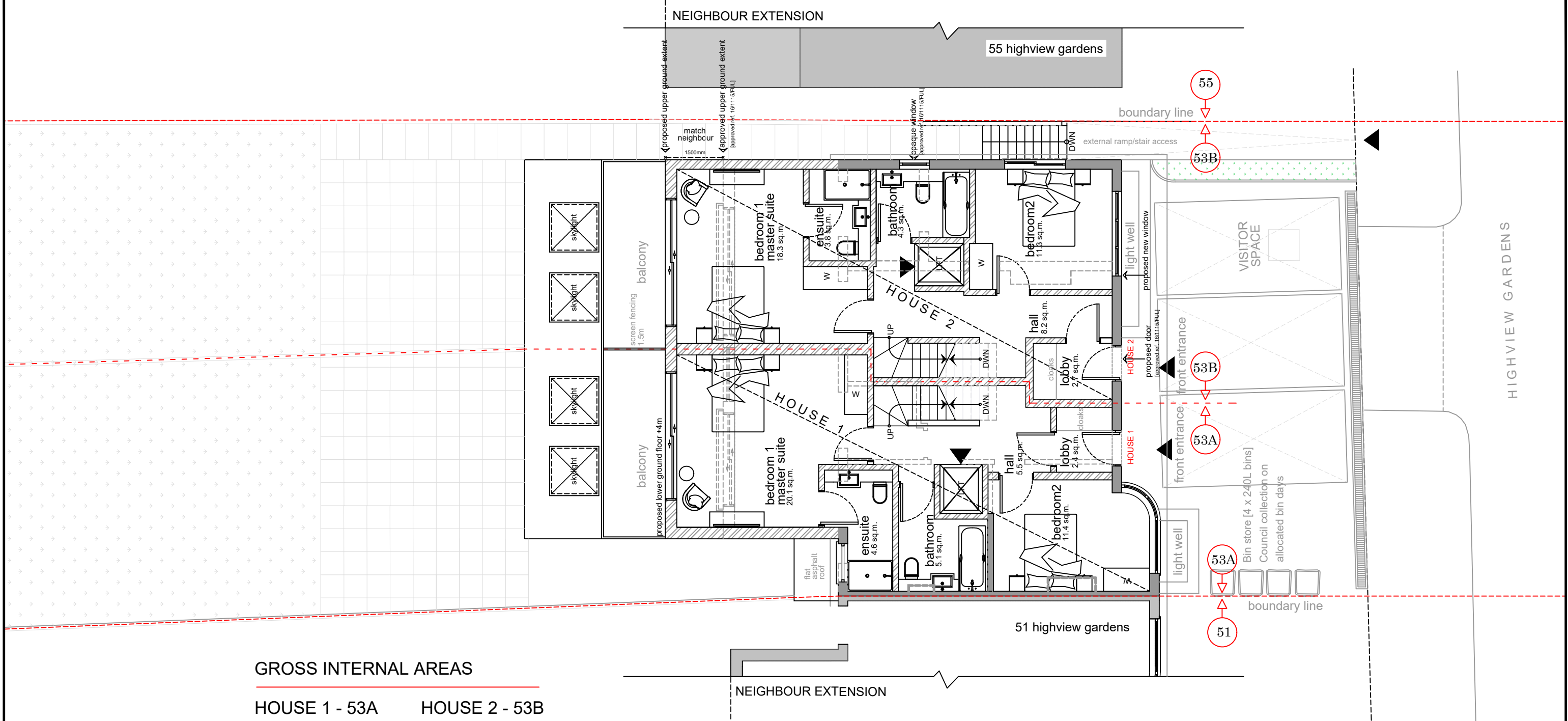

SCALE 1:100



GROSS INTERNAL AREAS

HOUSE 1 - 53A HOUSE 2 - 53B

58.1 sq.m.

57.9 sq.m.

NET saleable floor area = 116.0 sq.m.

| REV | DESCRIPTION | BY | DATE |
|-----|-------------------|----|----------|
| C | CLIENT AMENDMENTS | MN | 09.02.22 |
| B | SECOND ISSUE | MN | 28.01.22 |
| A | FIRST ISSUE | MN | 25.01.22 |

HOWARD & SEDDON A.R.I.B.A. CHARTERED ARCHITECTS
 64 WASHWAY ROAD
 SALE, CHESHIRE, M33 7RE
 TEL No. 0161 - 973 8296
 FAX No. 0161 - 962 3485
 E-MAIL : ADMIN@HOWARDANDEDSDON.CO.UK

PROJECT
 PROPOSED ALTERATIONS AND CONVERSION OF
 EXISTING BUNGALOW TO 2 NO. HOUSES 53
 HIGHVIEW GARDENS EDGEWARE HA8 9UD

CLIENT
 BROOMSTANLEY INVESTMENTS LTD

TITLE
 PROPOSED UPPER GROUND FLOOR
 PLAN

| DRAWN | DRG No. |
|--------------|-----------|
| MN | 15,122 |
| DATE | 09 |
| 09.02.22 | |
| SCALE | AMENDMENT |
| 1:100 X [A3] | C |

