

This Plan includes the following Licensed Data: OS MasterMap Black and White PDF Location Plan by the Ordnance Survey National Geographic Database and incorporating surveyed revision available at the date of production. Reproduction in whole or in part is prohibited without the prior permission of Ordnance Survey. The representation of a road, track or path is no evidence of a right of way. The representation of features, as lines is no evidence of a property boundary. © Crown copyright and database rights, 2022. Ordnance Survey 0100031673

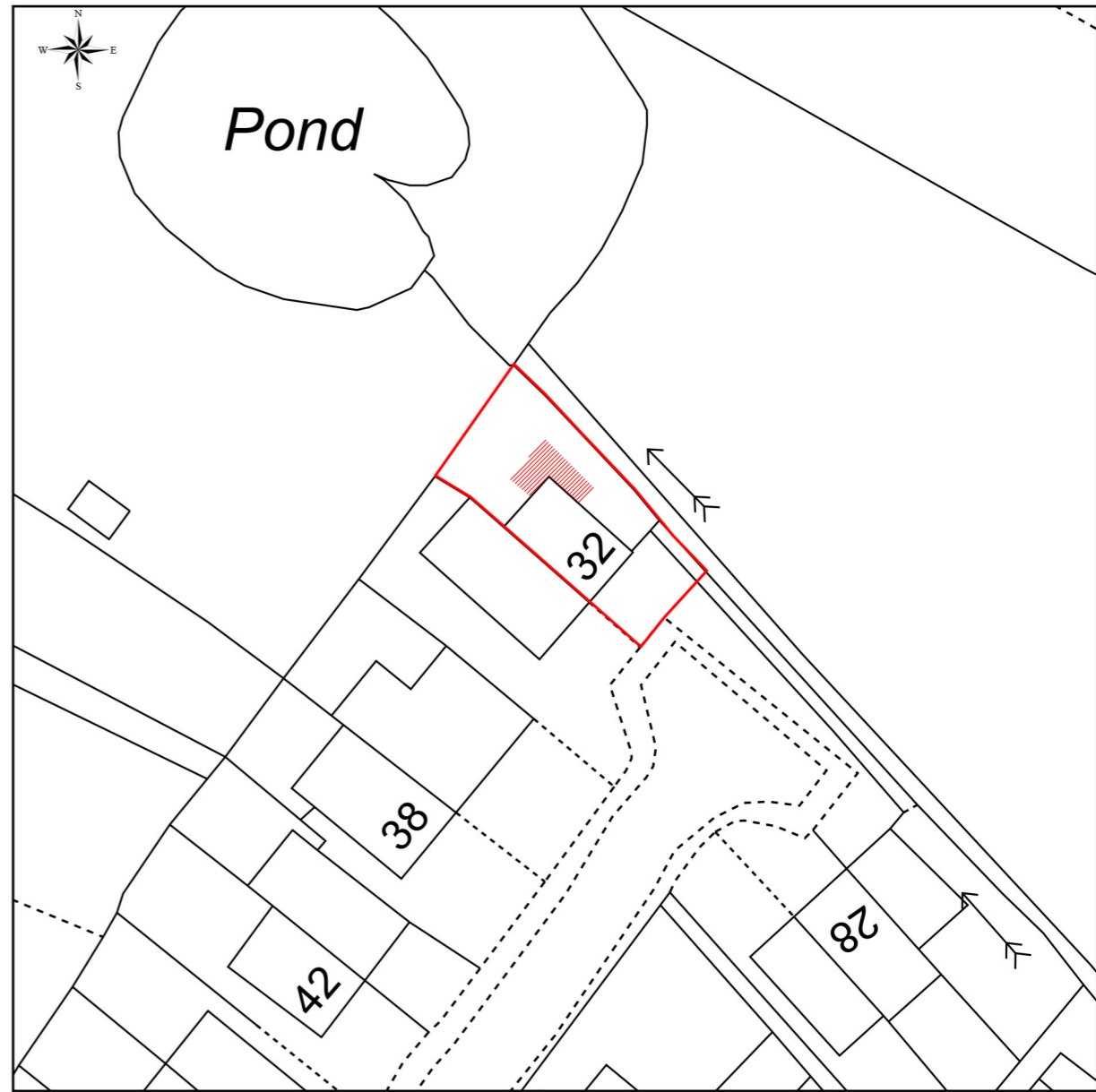

Scale: 1:1250, paper size: A4



This Plan includes the following Licensed Data: OS MasterMap, Black and White Site Plan/Block Plan by the Ordnance Survey National Geographic Database and incorporating surveyed revision available at the date of production. Reproduction in whole or in part is prohibited without the prior permission of Ordnance Survey. The representation of a road, track or path is no evidence of a right of way. The representation of features, as lines is no evidence of a property boundary. © Crown copyright and database rights, 2022. Ordnance Survey 0100031673

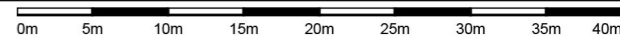

Scale: 1:500, paper size: A4

<p>Drawn By: AS</p>	<p>Notes:</p>	<p>Copyright © Hart Of The Home © Terms & Conditions No copies without approval. copyright remains the property of Hart Of The Home Ltd. Drawings must not be used for quotations until the relevant approvals have been granted and checked on site by client and principle contractor. Any discrepancies to sizes or relevant details which may affect quotations and/or building costs/procedures must be reported to Hart Of The Homes Design and the drawings must be amended prior to any commencement of said quotations and building works. Starting work before approval of plans by Building Control is at the customers own risk. It is the responsibility of the contractor/builder to check all sizes on site prior too and during the build. It is the responsibility of the Client and principle contractor/builder to conform to both Building regulations and CDM 2015 regulations. When existing trees are to be retained they should be subject to a full Arboricultural Survey/Inspection for safety. All trees are to be planted to ensure they are a minimum of 5m from buildings and 3m from drainage and services. A suitable method of foundation is to be provided to accommodate the proposed tree planting. Any Alterations to these drawings should be checked for compliance with Planning and Building Control. It is the responsibility of the client to check that the plans do not contravene or affect covenants or encroach boundaries, and matters relating to land Title. Also that issues relating to the party wall act are implemented at the relevant stages.</p>	<p>Client : HH-22-068 Palmer RG20</p>	<p>Site Plan</p>	
<p>Reviewed By: MB</p>		<p>Description: Single Storey Wrap around extension</p> <p>Address: 32 Fawconer Rd Kingsclere, Newbury RG20 5RN</p>	<p>HH/22/068/001/Site Plan</p>		