

- Notes :
- Dimensions are to be checked on site before
  - Reinforcement and construction
  - Structural measurements are to be taken from the structural engineers drawings
  - Do not scale
  - Copyright reserved by LAB 4D

REVISION :

Description	Date
A -XXXXXX	01.01.21
B -XXXXXX	01.01.21
C -XXXXXX	01.01.21

SMOKE DETECTION  
 LI DETECTION AND ALARM SYSTEM IS RECOMMENDED THROUGHOUT THE BUILDING.  
 IN ACCORDANCE WITH THE RECOMMENDATIONS OF BS 5839-1, THE FIRE ALARM SYSTEM TO BE INSTALLED SHOULD BE OF THE 'L1' TYPE.  
 THE SYSTEM SHOULD BE INSTALLED IN ACCORDANCE WITH THE RECOMMENDATIONS OF THE INSTALLATION ON SITE.

Christopher Melvin  
 ARCHITECTURE & DESIGN

Drawing Issue status  
**PLANNING**

Client  
**BOBBY SINGH**

Project  
**3 FALCONS HOTEL**

3 Falcons Hotel  
 100, Orchardson Street,  
 London,  
 NW6 8NG

Drawing  
**SITE PLAN EXISTING GA**

Scale	Date	Drawn	Checked
1:100@A1	19.09.21	CM	CM
1:200@A3			

Project	Client	Drawing No
3F	BS	3F GA000 REV -

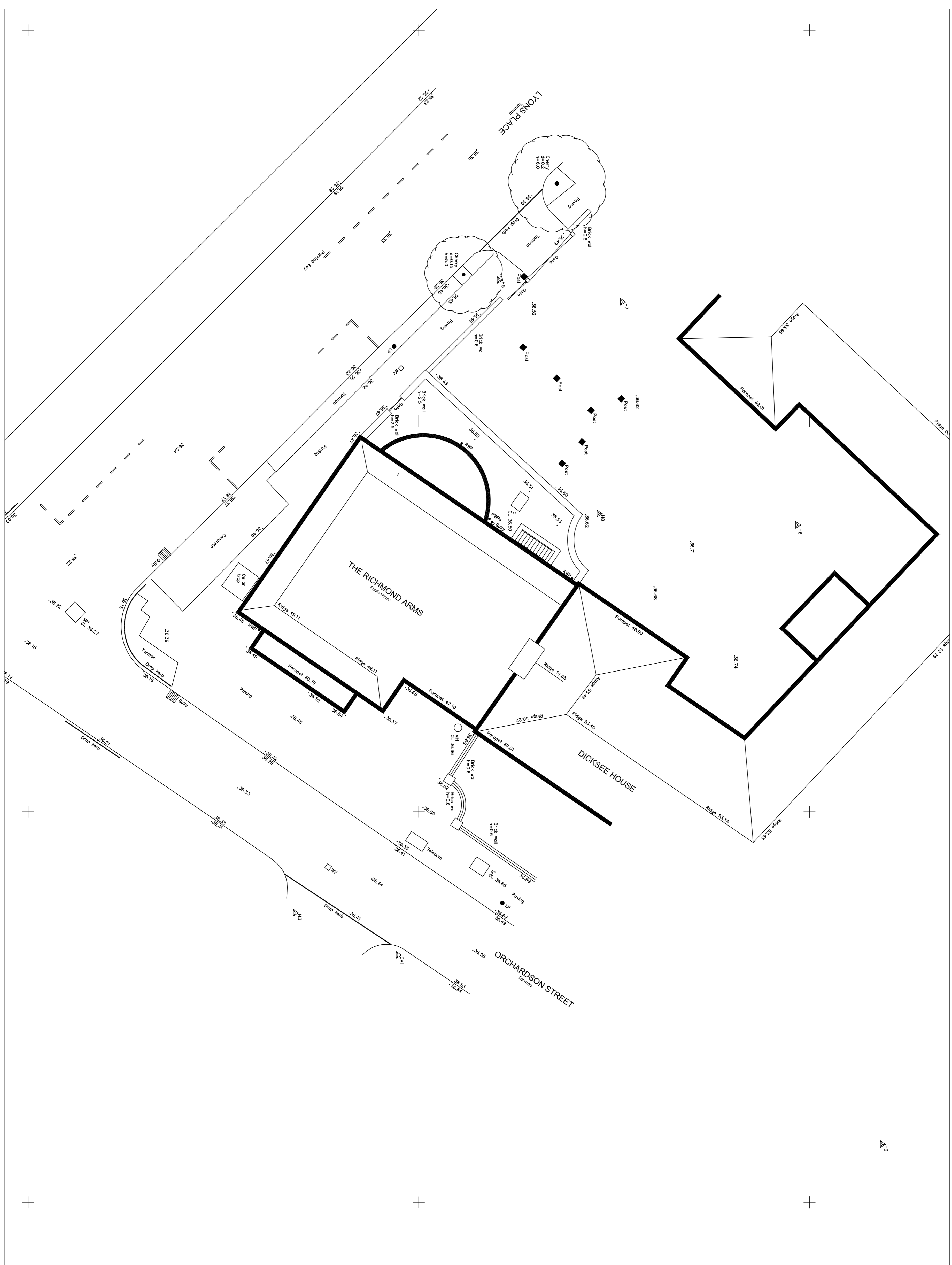

1 SITE PLAN EXISTING GA  
 SITE PLAN EXISTING GA