

5m 10m 15m

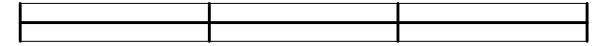

KATE STOREY client		
PROPOSED CONVERSION STABLES / STORE BUILDING THE SAW MILLS MAIN ROAD HAWKSWORTH NOTTS		
job title		
proposed site plan		
drwg title		
scale 1 : 200 A2	2316 / 5	F
date may 2022	drwg no	rev

trevor muir architect

104 LAMBLEY LANE BURTON JOYCE NOTTINGHAM NG14 5BL  
TEL NO : 0115 931 2602 : FAX NO : 0115 931 3597  
tm@trevormuir.co.uk www.trevormuir.co.uk

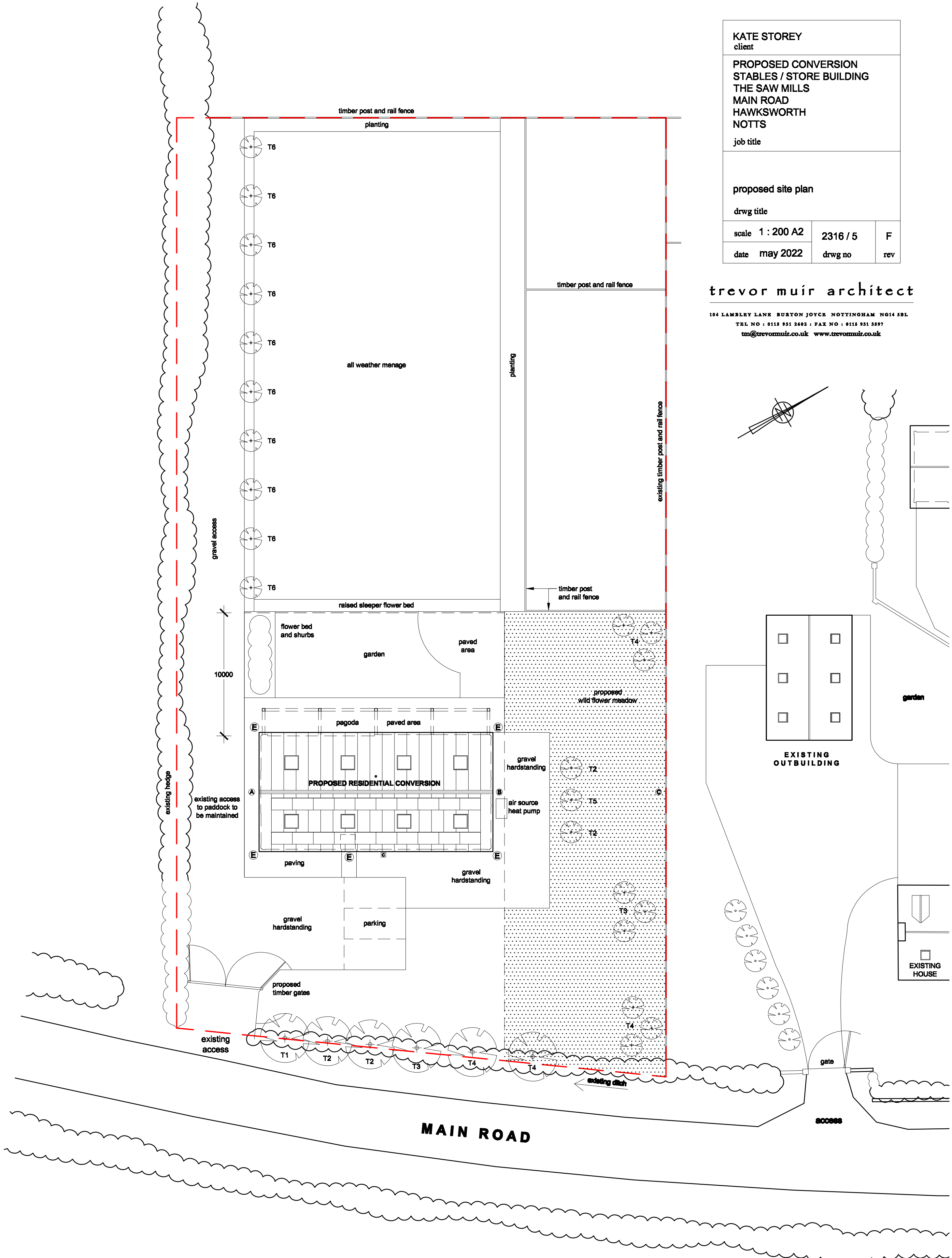
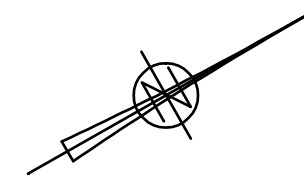

- A owl box
- B 2no bat boxes
- C 3no bird boxes
- E car charging point (EVCP)
- E external light

- KEY TO TREES**
- T1 Acer Campestre
  - T2 Malus Sylvestrus
  - T3 Corylus Avellum
  - T4 Betula Pendula (silver birch)
  - T5 Rosa Canina
  - T6 Amelanchier Robin Hill

- proposed timber gates to be 1.4m / 1.7m high with arched tops and timber posts
- external paving to be riven faced grey stone paving at random sizes
- gravel hardstanding areas to be edged with blue / red concrete cobble edgings