

ELEVATION

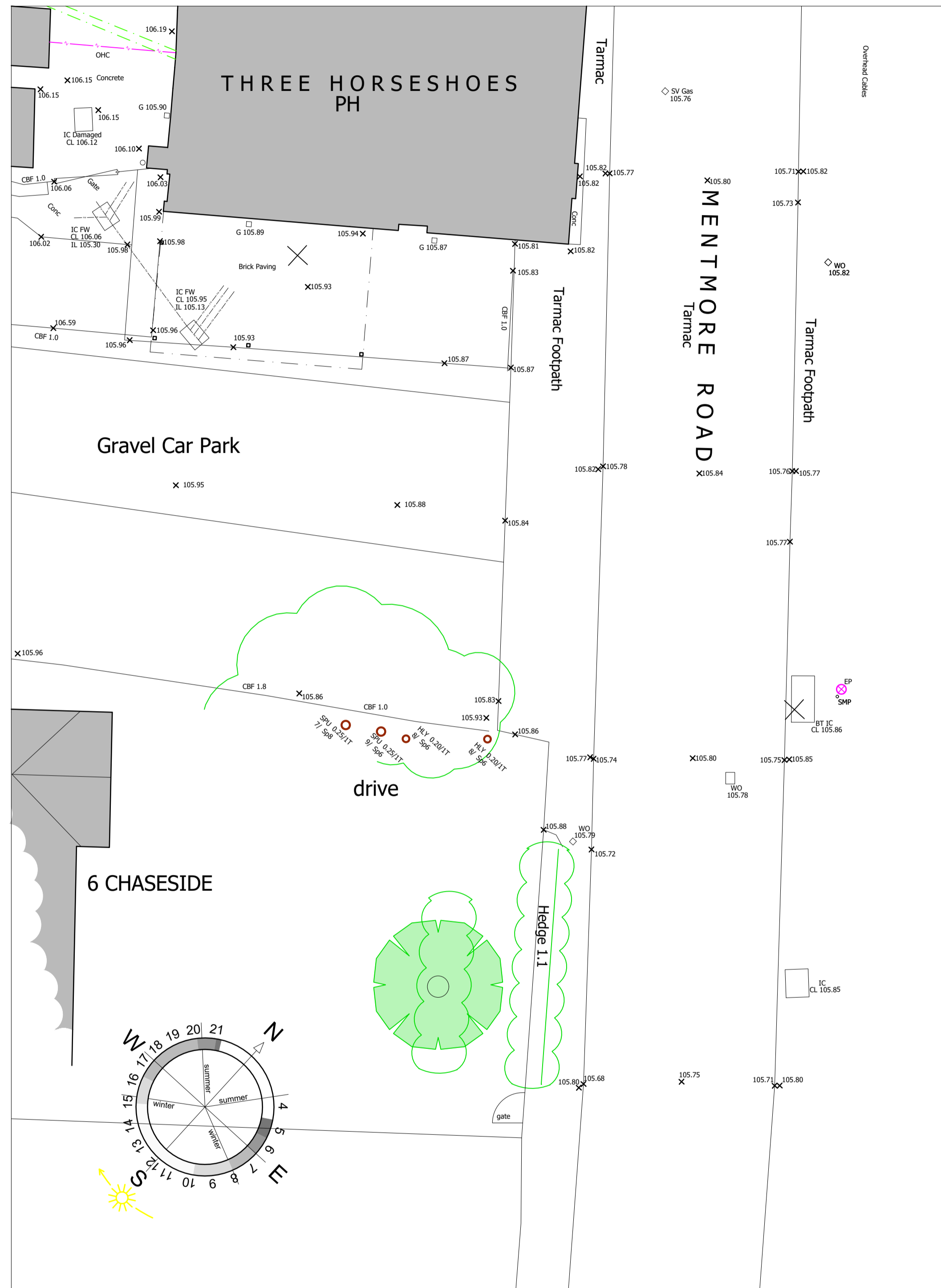

ELEVATION

new brick wall; bricks to match those used on new houses



PLAN

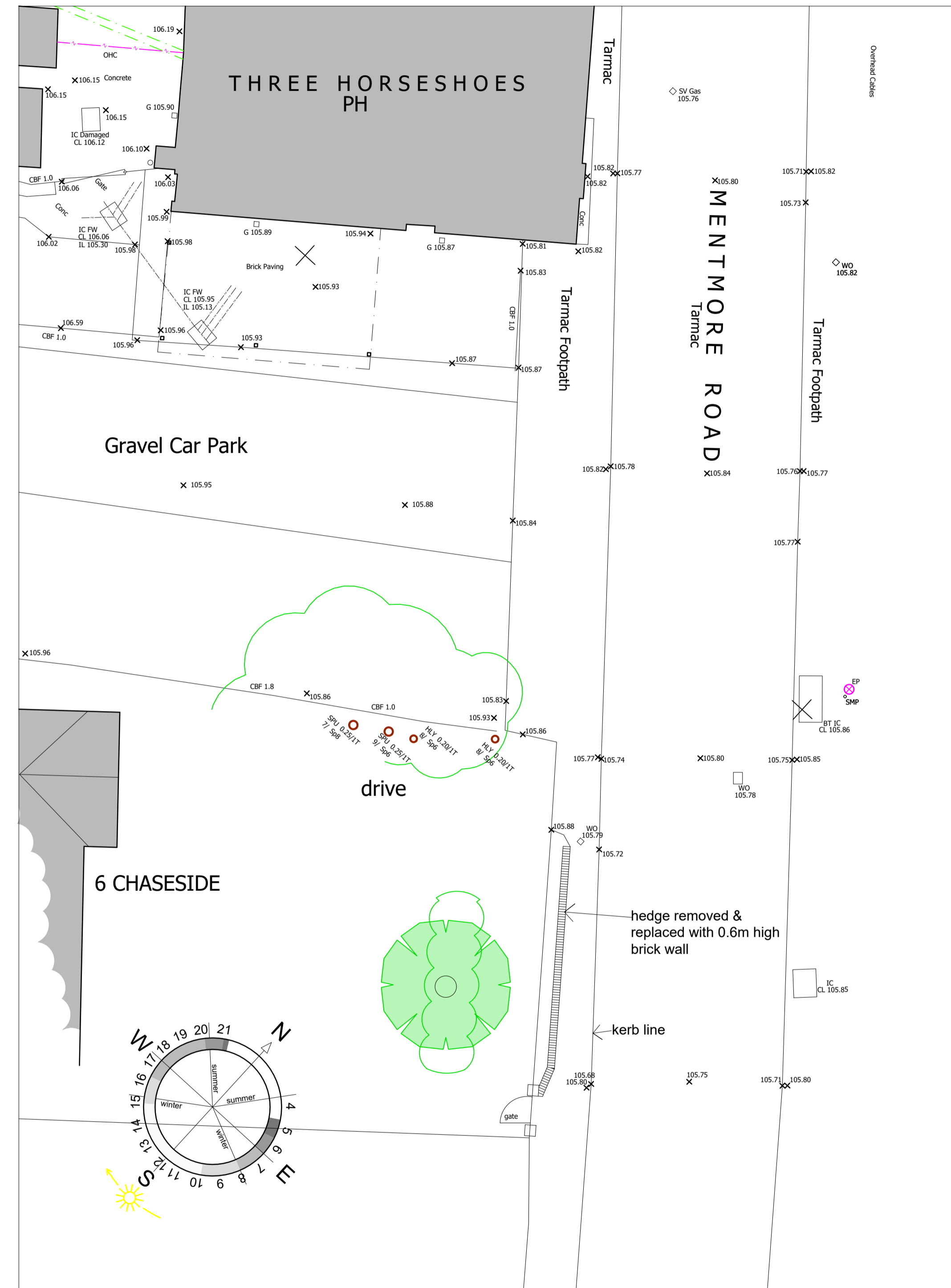

PLAN

AS
AS
P
R
O
P
O
S
E
D

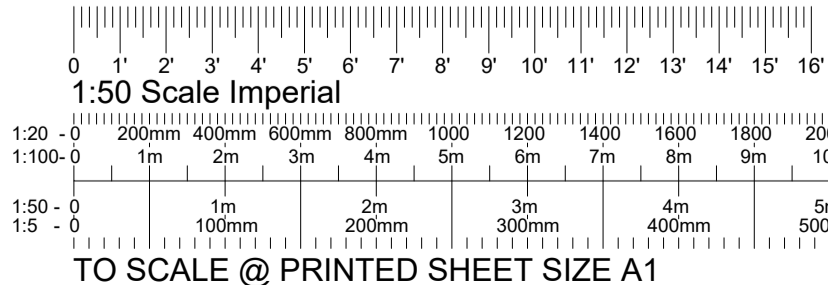

IMPORTANT NOTE :: CAREFULLY SCALE OFF THIS DRAWING, try to use figured dimensions only. All dimensions to be checked on site by builder before works commences. Should any discrepancies be found, notify JLM immediately for any necessary amendments. All work to be carried out in accordance with current Building Regulations, relevant Codes of Practice, British Standards & Health & Safety Regulations. Where structural alterations take place, great care must be taken by builder to afford restraint to all affected areas during and after building work. If during excavation any basements, cellars, wells, voids, etc. are found JLM must be contacted for design amendments prior to work continuing. Where applicable this drawing is to be read in conjunction with structural calculations provided. If drawings conflict with calculations then notify JLM (01582 766880) or Structural Engineer for clarification. All design & construction is to be in accordance with the Construction (Design & Management) Regulations 2007.

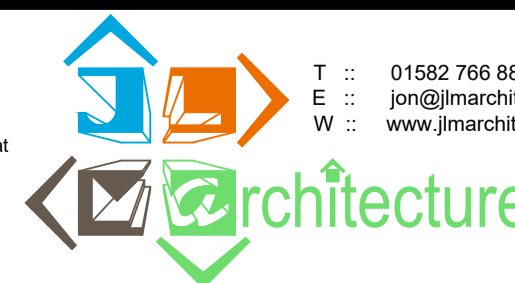

T :: 01582 766 880
E :: jon@jlmarchitecture.co.uk
W :: www.jlmarchitecture.co.uk

| REVISIONS :: |
|--------------|
| |
| |
| |

| | | |
|--|----------------------------|---------------------------|
| PROJECT / ADDRESS :: Development @ land rear of Three Horseshoes, Mentmore Road, Cheddington LU7 0SD | STATUS :: PLANNING | DATE :: April 2022 |
| DRAWING TITLE :: Site Plans & Elevations as Existing & Proposed for Highway Works | SCALE :: A1 SHEET 1:100 | DRAWING No. :: 2151-H1 |