

Hedge Planting

Summer 2022 weed kill 1m wide area along hedge line and cultivate.

Landscaping to be planted between the months of November and March 2022/2023 plants to be kept weed free for the first two growing seasons and maintained for the first five growing seasons Replant any dead or vandalised plants, to be planted between the months of November - March 2023/2024. The hedge line should be maintained weed free for at least 3 years.

Tree Planting

Trees to be excavated to 500mm in diameter by 400mm depth. Pit sides to be scarified. Trees to be single staked, using a round softwood stake, with rubber spacer and tie. Trees to be staked to approximately 300mm height, removing any side shoots if necessary. Plant to original nursery mark, the pit to be backfilled using 75% excavated soil and 25% planting compost. Ensuring backfilled soil is carefully firmed in. Fit suitable rabbit guards or tubes.

Water in immediately after planting to ensure soil is saturated.
Size 1.5-1.8m, FTH, 10L pot

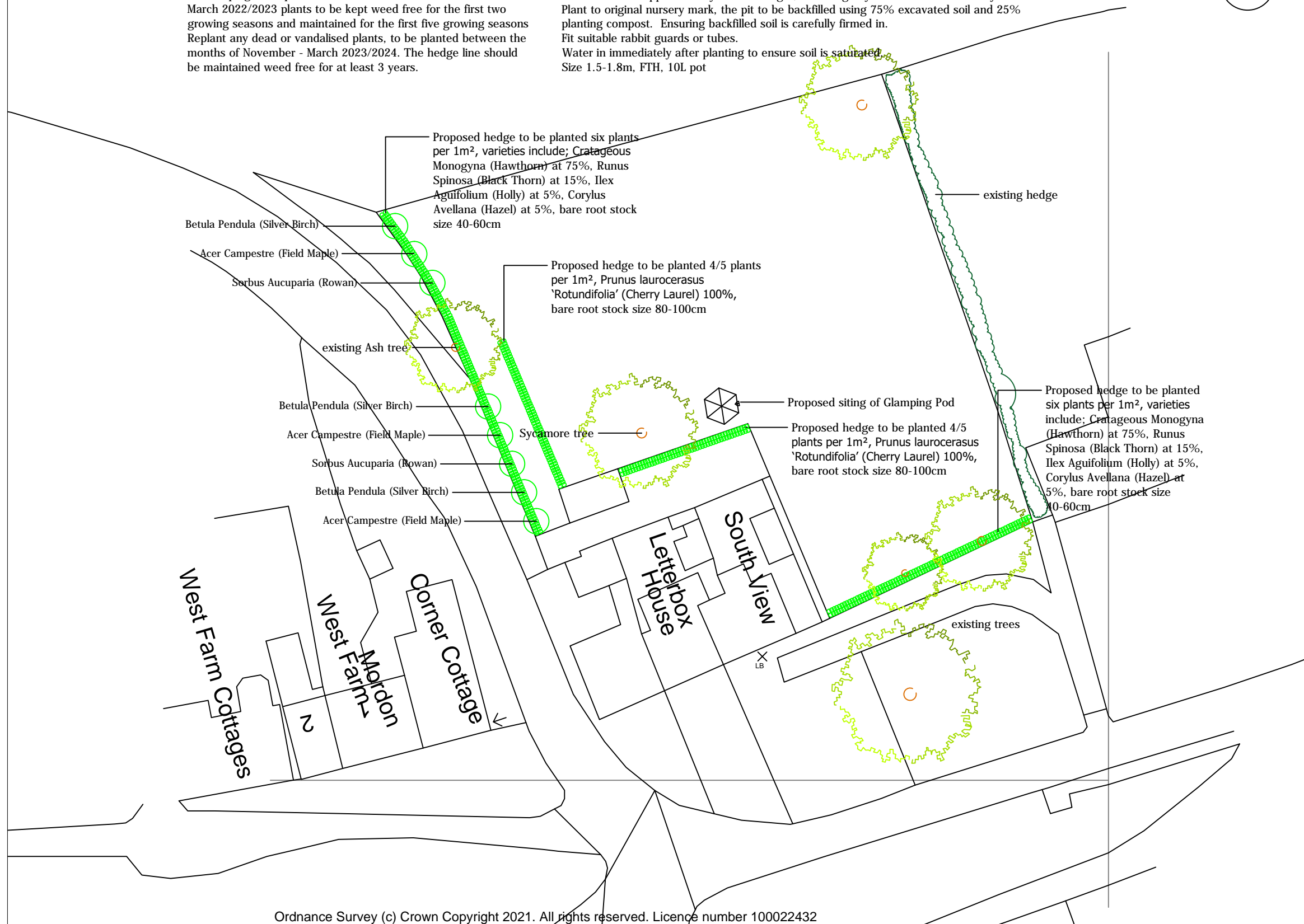
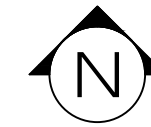

Stovell & Millwater Limited

chartered
planning &
architectural
consultants

5 Brentnall Centre
Brentnall Street
Middlesbrough
TS1 5AP

Phone: 01 642 232397
Fax: 01 642 220688
Web: davidstovellandmillwater.co.uk

Project:
CHANGE OF USE OF LAND FOR THE SITING
OF A GLAMPING POD TO THE REAR OF
LETTERBOX HOUSE MORDON TS21 2EY

Drawing:
PROPOSED LANDSCAPING PLAN

Client:
MR & MRS ALEXANDER

Drawing No:
DM/21/003/004

Revisions:

Scale:
1:500 @ A3

Date:
MARCH 2022

Drawn By: