

Biodiversity Enhancement Plan

Land South Of Victoria Street,
Cloughfold,
Rossendale,
BB4 7PT

Land at south end of Victoria Street and west of Hope Street, Rawtenstall Lancashire BB4 7PT

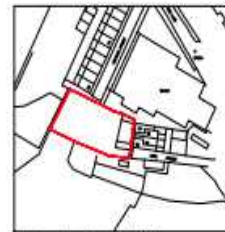
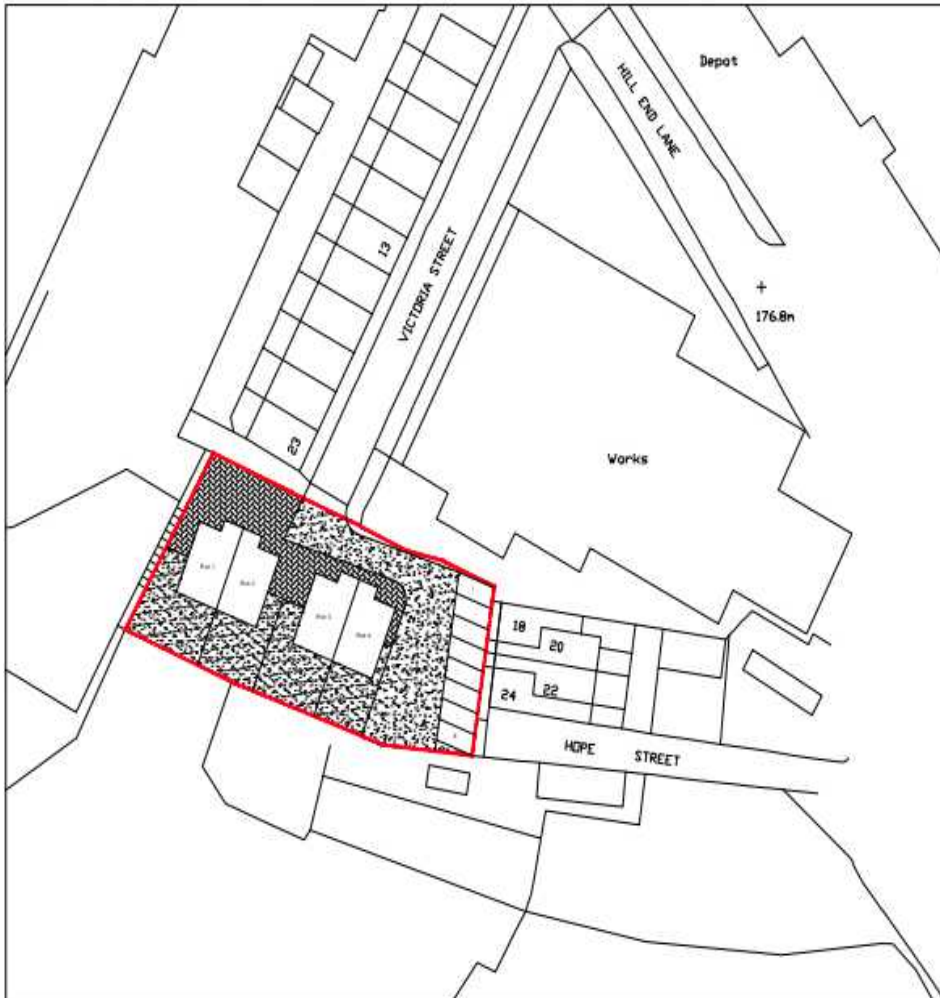

Site Location Plan - 11250

Land at south end of Victoria Street Rawtenstall Lancashire BB4 7PT			
Proposed site plan			
Scale	1:1000	1:1000	1:1000
Date	10/10/18	10/10/18	10/10/18
Author	000/YDR/PL		

Report prepared by:
Dave Anderson
Batworker.com
Dave@Batworker.com
07894 338290

Summary.

In August 2020 Batworker Consultancy issued a report to support a residential development at land South Of Victoria Street, Cloughfold, Rossendale, BB4 7PT

Planning permission for an outline application (with all matters reserved) for the erection of 4 no. dwellings (maximum) (Application Number: 2020/0339) was granted with the following conditions:

15. As part of the first reserved matters application or prior to commencement of development, a reasonable avoidance measures method statement for amphibians (in the form of a report compiled by a qualified ecologist) shall be supplied to and agreed in writing by the Local Planning Authority.

Reason: In the interests of protecting biodiversity

16. As part of the first reserved matters application or prior to commencement of development, a landscape plan including ecological mitigation for loss of trees and bird nesting habitats shall be supplied to and agreed in writing by the Local Planning Authority.

Reason: In the interests of protecting biodiversity

This document has been drawn up to meet those conditions.

The overall biodiversity enhancement strategy for the site is to provide compensatory nesting opportunities for urban/woodland birds and roosting potential for bats.

Location.

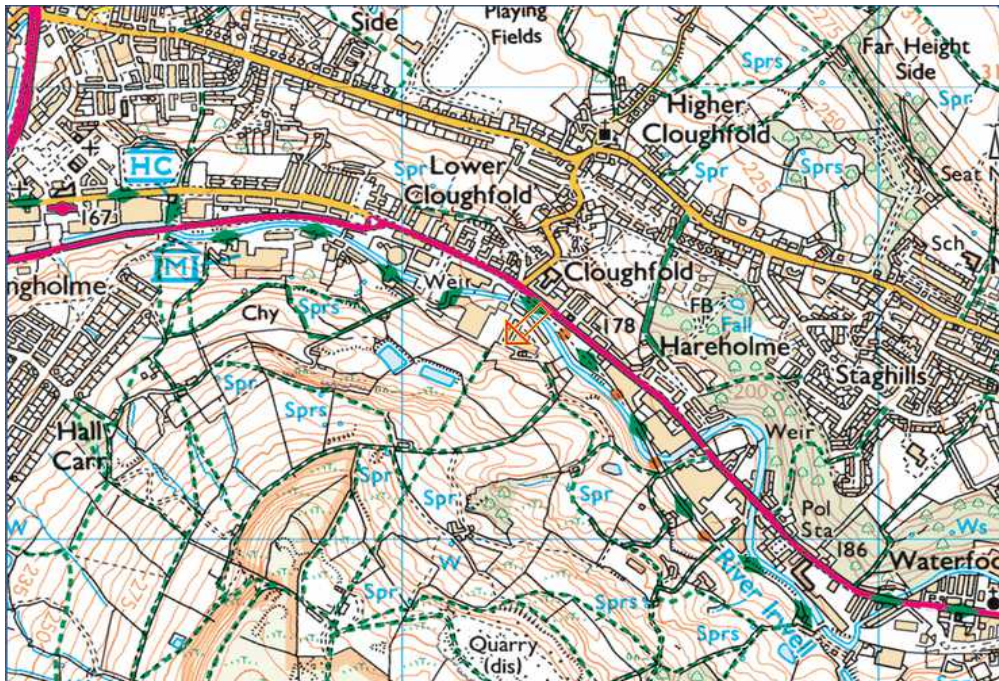

A central grid reference for the site is SD8223022422

Proposed Development

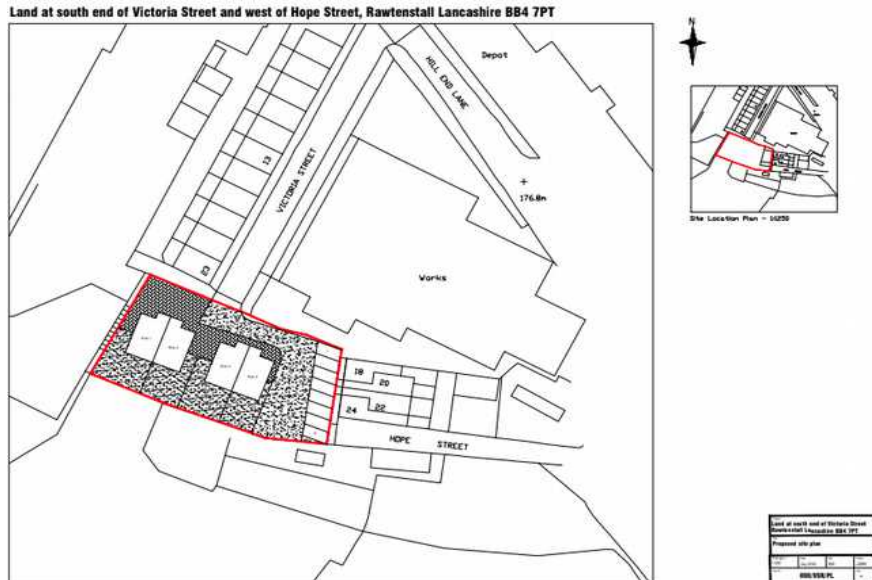

The development consists of a four residential dwellings with associated access and landscaping.

Reasonable Avoidance Measures for Amphibians and Small Mammals.

Hand searches within piles of logs, stones and rank vegetation will take into account common amphibians, hedgehog and other small mammals.

Any hedgehogs or small mammals caught will be allowed to disperse, or if caught will be released into the adjacent habitat on the north western boundary of the site, away from the development site.

Any toads or common amphibians that are caught during hand searching will be released into adjacent terrestrial habitat, away from the development site.

Once the hand searches have taken place for both amphibians and small mammals the areas of vegetation will be strimmed to 100mm to remove amphibian foraging habitat from site and discourage amphibians, hedgehogs and other small mammals from using the site.

Biodiversity Enhancement Strategy.

The biodiversity enhancement strategy aims to provide nesting opportunities for typical urban and woodland birds and roosting opportunities for typical bat species expected along urban edge habitats.

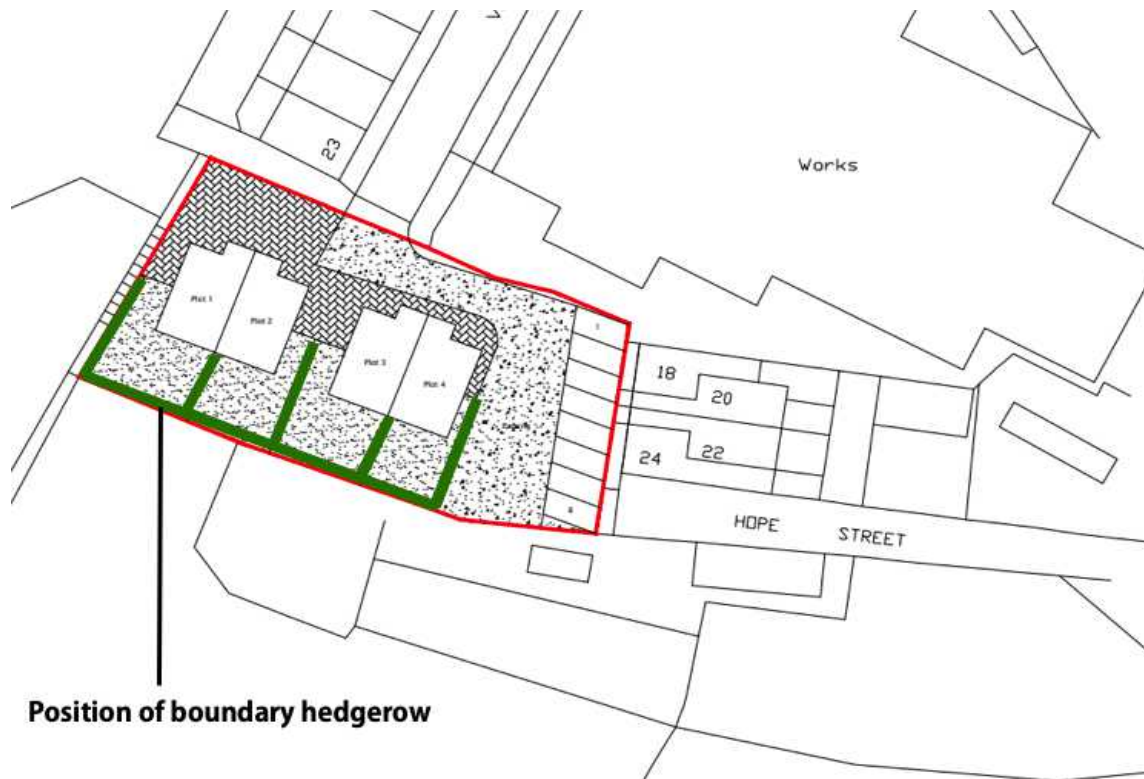

Boundary Hedgerow.

Compensatory hedgerow will be planted along the boundaries of domestic gardens.

Species mix to provide foraging potential for insects and birds will follow the following recommendations.

Hawthorn	<i>Crataegus monogyna</i>	50%
Blackthorn	<i>Prunus spinosa</i>	20%
Holly	<i>Ilex aquifolium</i>	20%
Elder	<i>Sambucus nigra</i>	10%

Position of Greenwoods Bat Boxes

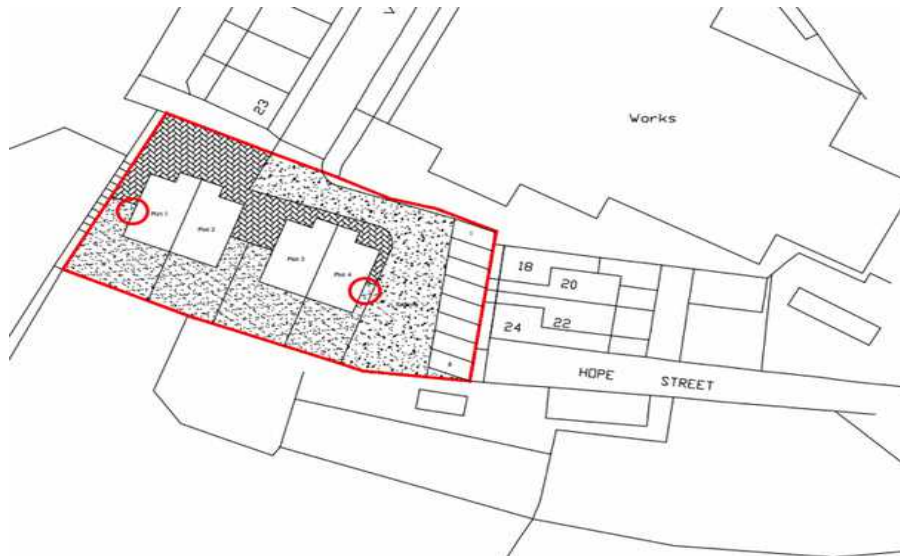

Two Greenwoods Ecohabitats two crevice (or similar) bat boxes will be mounted to external east and west facing walls of new properties. Boxes will be mounted below the eaves.

House Sparrow



Two Schwegler House Sparrow Terrace boxes will be installed on south facing walls of the proposed new properties with clear flight lines to the wider landscape. Boxes are to be installed below eaves. The installation of a series of boxes will allow communal nesting.

