

Oakwrights planning

© This drawing, its contents, and all information contained therein is protected by copyright. It may be used once only for its intended purpose under a contract with T J Crump Oakwrights Ltd, but specifically not for any other use or purpose. This drawing is for Planning purposes and does not constitute a construction issue drawing. All setting out dimensions and levels are indicative and are subject to detailed site survey and site conditions. The Client and their agent are responsible for ensuring that Building Control and construction drawings are carried out. All dimensions are to be checked on site.

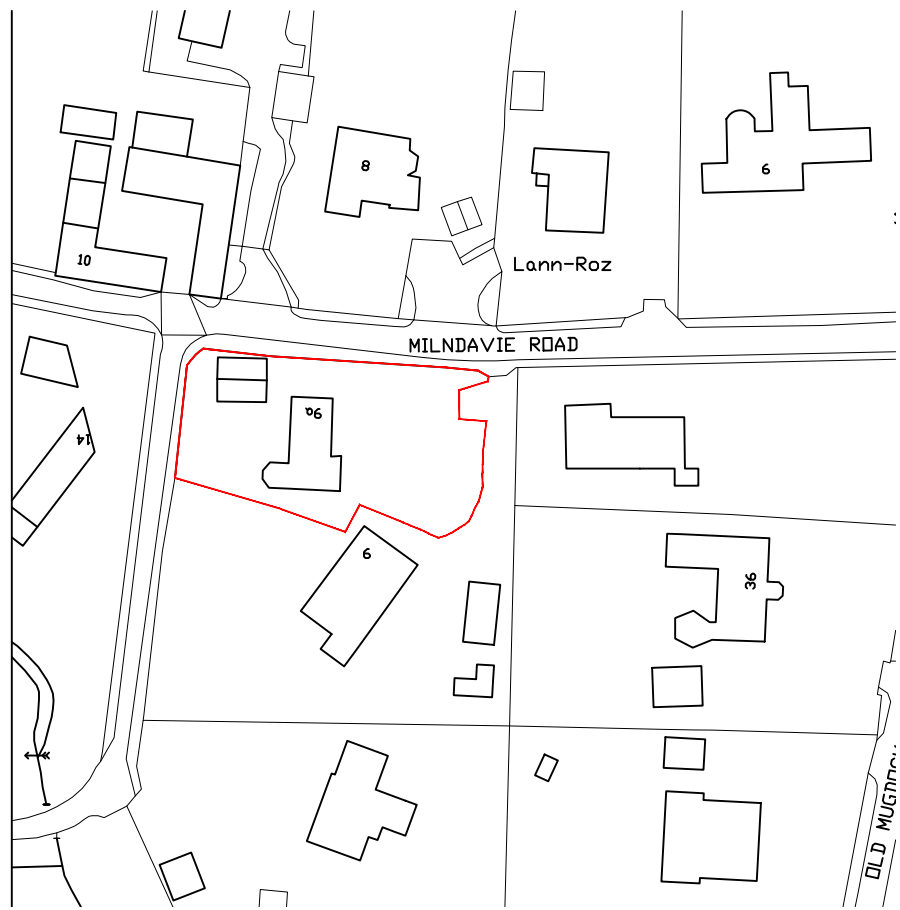

LOCATION PLAN
SCALE 1/1250

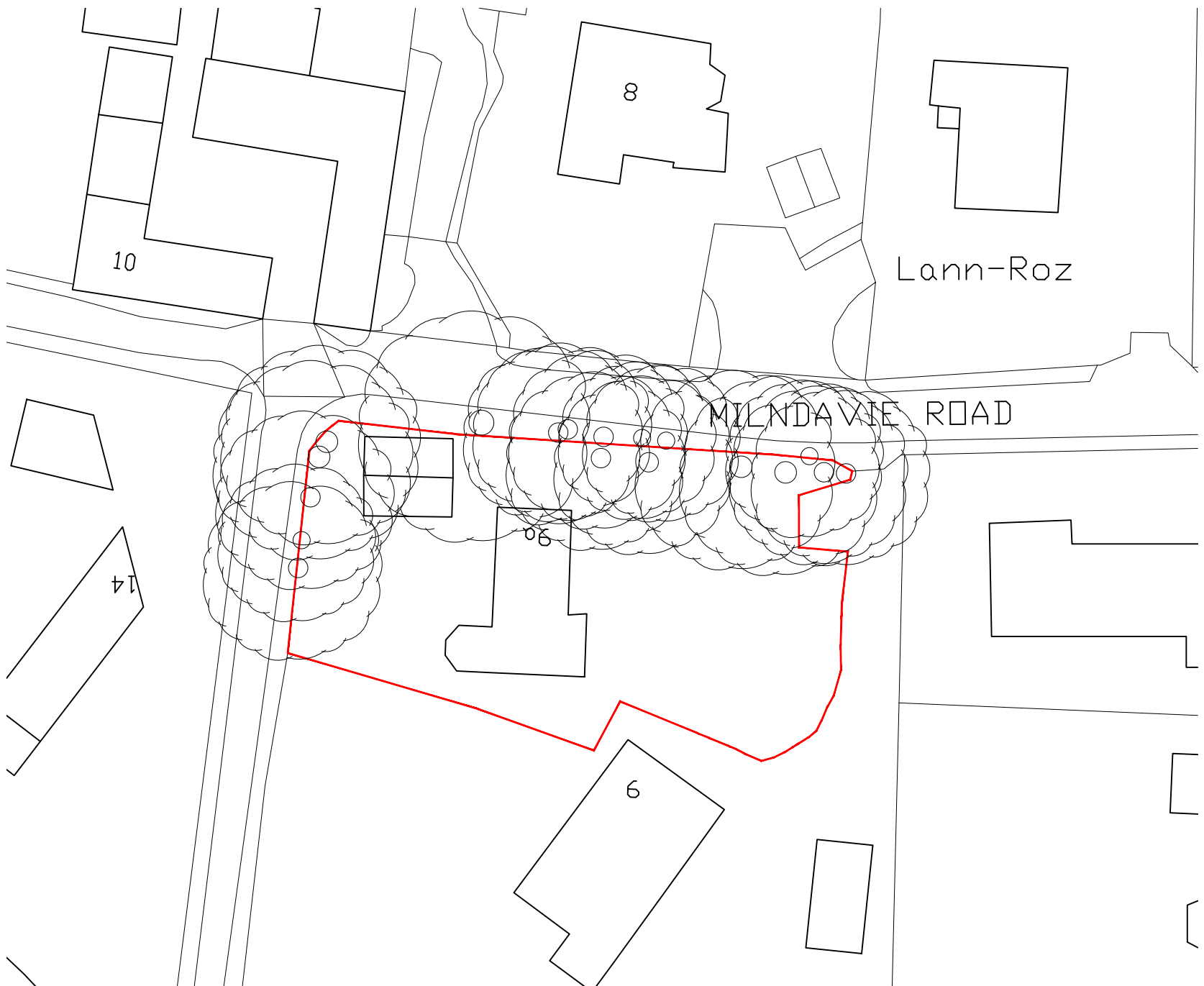

SITE PLAN AS EXISTING
SCALE 1/500



Serial number: 235970

© Crown copyright and database right 2022
Ordnance Survey licence 100048957
Reproduction in whole or in part is prohibited
without the prior permission of Ordnance Survey



T. J. CRUMP OAKWRIGHTS LTD
THE LAKES, SWAINSHILL,
HEREFORD, HR4 7PU
(01432) 353 353 | enquiries@oakwrights.co.uk



EMAIL:
post@thomsonhunter.co.uk
PHONE:
(01563) 524 171
WEBSITE:
www.thomsonhunter.co.uk

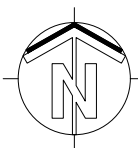

CLIENT/PROJECT
Mr and Mrs Fairfull
Proposed partial demolition &
formation of new extensions

SITE ADDRESS
Banchory
9A Milndavie Road
Strathblane, G63 9EW

DATE 28/03/22
DRAWN VW
CHECKED CT

SCALE 1:500 & 1:1250 @ A3
DRG. NO. 22.114.01
REV. -