

**Phase 2,
Land Northwest of Redhouse Farm,
Oakley Road, Wix**

Transport Statement

Phase 2,
Land Northwest of Redhouse
Farm, Oakley Road, Wix

Transport Statement

27th April 2022
SJT/21314-05a Transport Statement Phase 2

Prepared by:

David Tucker Associates

Forester House, Doctors Lane
Henley-in-Arden
Warwickshire
B95 5AW

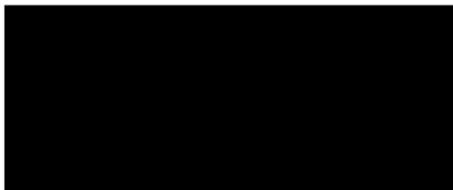

Prepared For:

A H Brown Farms

© **David Tucker Associates**

No part of this publication may be reproduced by any means without the prior permission of David Tucker Associates

TABLE OF CONTENTS

	Page
1.0 INTRODUCTION	1
2.0 EXISTING CONDITIONS	3
2.1 Site Description	3
2.2 Surrounding Road Network.....	3
2.3 Existing Traffic Flows	3
2.4 Existing Vehicle Speeds.....	4
2.5 Personal Injury Collision Data	4
3.0 DEVELOPMENT PROPOSALS	5
3.1 Overview.....	5
3.2 Site Access.....	5
4.0 TRAFFIC GENERATION	6
4.1 Existing Development.....	6
4.2 Proposed Development.....	6
4.3 HGV Routing	8
5.0 TRAFFIC IMPACT	10
5.1 Highway Impact	10
6.0 CONCLUSIONS.....	11

Appendices

- Appendix A** Site Layout Plan
- Appendix B** Approved Routing Plan
- Appendix C** ATC Survey
- Appendix D** Approved Access Plans
- Appendix E** HGV Tracking Plans



1.0 INTRODUCTION

- 1.1 David Tucker Associates (DTA) have been commissioned on behalf of A H Brown Farms to review the transport implications for Phase 2 of Treestacks Farm proposed poultry unit expansion on land northwest of Redhouse Farm, Oakley Road, Wix, Manningtree, Essex. The site location and plans of the proposals are attached at **Appendix A**.
- 1.2 Planning permission was granted for a Poultry unit on the site under planning Consent 20/00194/FUL. Conditions 5, 6 and 7 of the consent required a new access from Oakley Road, visibility splays and internal manoeuvring areas to be completed in accordance with approved details. Internally works have been completed and the access is currently being constructed to details approved by ECC.
- 1.3 Condition 11 of the consent required the submission of a Traffic Management Plan. This was submitted and has been formally agreed under Application 20/01551. The approved documents are attached at **Appendix B** and will also be applicable to the new application.
- 1.4 This report has been prepared in accordance with the NPPF and the Guidance on Transport Assessments (GTA) issued by DfT. Although the GTA document has been withdrawn, the methodology and guidance it contains is still relevant. The NPPF document states that all developments that generate significant amounts of movements should be supported by a Transport Statement or Transport Assessment.
- 1.5 The Government's sustainability objectives are embodied in the National Planning Policy Framework (July 2021) and in terms of developments in rural locations, NPPF advises that:

"Planning policies and decisions should enable:

- *the sustainable growth and expansion of all types of business in rural areas, both through conversion of existing buildings and well-designed new buildings;*



- *the development and diversification of agricultural and other land-based rural businesses;*
- *sustainable rural tourism and leisure developments which respect the character of the countryside; and*
- *the retention and development of accessible local services and community facilities, such as local shops, meeting places, sports venues, open space, cultural buildings, public houses and places of worship.”*

1.6 The TS considers the potential transport and highways impact of the proposals including the impact of the development generated traffic on the capacity and safety of the surrounding road network. The report concludes that the proposals will have no adverse impact on the safety or capacity operation of the surrounding road network.



2.0 EXISTING CONDITIONS

2.1 Site Description

2.1.1 The site is located to the north of Oakley Road. Great Oakley is located approximately 1.4km to the south east of the site and Wix approximately 1.8km to the west. The location of the site is shown at **Appendix A**.

2.2 Surrounding Road Network

2.2.1 Oakley Road ranges from 4.5 – 5.5m within the vicinity of the site and routes east to west. The road is classified as a Priority 2 (PR2) road which means it is a main rural feeder for HGV's to use. To the north it connects users the village of Wix and the A120 and to the south with Great Oakley.

2.3 Existing Traffic Flows

2.3.1 To understand existing traffic movements along Oakley Road, a 7-day automated traffic count (ATC) was undertaken between 11/03/2022 and 17/03/2022, and a summary of the five-day weekday average flows is provided in **Table 1**. A copy of the data including location is attached at **Appendix C**.

Table 1 – Existing 24-hour Traffic Flows for the Oakley Road (Average Weekday)

	Total Vehicles	HGVs	%HGV
Eastbound	528	22	4.2%
Westbound	536	15	2.8%
Two-way	1064	37	3.5%

2.3.2 It can be seen in **Table 1** that HGV movements constitute 3.5% of the total vehicle movements. The overall level of traffic has reduced slightly since the original application (which was based on surveys in 2018) but remain broadly consistent.

2.3.3 On the week of the survey the existing Phase 1 site was operational but at the end of the cycle, so generated movements of wash and bedding lorries (Tuesday – Thursday) and an egg delivery (one vehicle) on the Saturday.



2.4 Existing Vehicle Speeds

2.4.1 The average and 85th percentile speeds along the A417 based on the ATC data identified in **Section 2.3** are summarised in **Table 2**.

Table 2 - Summary of Average and 85th Percentile Speeds

	Average Speed (mph)	85 th Percentile Speed (mph)
Eastbound	45.5	53.6
Westbound	45.0	53.8

2.5 Personal Injury Collision Data

2.5.1 Personal Injury Collision (PIC) data has been obtained from Essex County Council and the latest 5-year period has been assessed from 01/01/2017 to 31/12/2021. There were no collisions recorded along Oakley Road.

2.5.2 This is an improvement on the situation in 2019 for the previous application when there had been 2 accidents in the preceding five years.



3.0 DEVELOPMENT PROPOSALS

3.1 Overview

3.1.1 The proposals are for Phase 2 of the poultry unit expansion and the site plans include:

- 3 No. Poultry Buildings;
- Feed Bins; and
- Attenuation Pond.

3.1.2 Each unit will be of standard construction of steel-framed, fully-insulated buildings. The building will be clad externally with profiled sheeting coloured.

3.1.3 The existing site houses 88,268 birds per flock. The proposals will increase the bird capacity to 220,670 birds.

3.2 Site Access

3.2.1 The poultry unit will be accessed via the bell mouth approved for Phase 1 which has been agreed with the Local Highway Authority and constructed with a width of 8m and 15m radii. Visibility splays of 4.5m x 160m to the east and 2.4m x 160m to the west can be achieved.

3.2.2 The detailed design of the access as approved by consent 20/00194/FUL, is agreed with ECC and the works about to commence. Plans of the approved scheme are attached at **Appendix D.**



4.0 TRAFFIC GENERATION

4.1 Existing Development

4.1.1 The existing generation associated with the operation of the site can be seen in **Table 4**.

4.2 Proposed Development

4.2.1 Fertile eggs will be delivered to the site on Day 1 and will be reared on the site for approximately 40 days, following which they will be removed live to the processors. Following the removal of the birds, the site will be empty for around 10 days for cleaning and preparation for the next flock of birds. The site will operate with approximately 7.2 flocks of birds per annum.

4.2.2 Following manure removal, the building will be washed out with high pressure power washers and prepared for the incoming flock. The inside of the building is drained to a sealed concrete dirty water tank which will be emptied following each cleanout of the building by tanker.

4.2.3 A summary of the total number of movements generated for the existing and proposed poultry unit is summarised in **Table 4** below.



Table 4 – Existing and Proposed Commercial Traffic Generation

Day	Activity	Vehicle Size	Existing Frequency	Proposed Frequency
1	Fertile Egg Delivery	16.5m HGV	1	2
2				
3				
4				
5				
6				
7				
8	Feed Delivery	16.5m HGV	0	1
9				
10	Carcass Collection	Box Van	1	1
	Feed Delivery	16.5m HGV	1	1
11				
12	Feed Delivery	16.5m HGV	0	1
13				
14	Feed Delivery	16.5m HGV	1	1
15				
16	Feed Delivery	16.5m HGV	0	1
17	Carcass Collection	Box Van	1	1
18	Feed Delivery	16.5m HGV	1	1
19				
20	Feed Delivery	16.5m HGV	0	1
21				
22	Feed Delivery	16.5m HGV	1	1
23				
24	Feed Delivery	16.5m HGV	0	1
	Carcass Collection	Box Van	1	1
25	Feed Delivery	16.5m HGV	0	1
26	Feed Delivery	16.5m HGV	1	1
27	Feed Delivery	16.5m HGV	0	1
28	Feed Delivery	16.5m HGV	0	1
29	Feed Delivery	16.5m HGV	0	1
30	Feed Delivery	16.5m HGV	1	1
31	Feed Delivery	16.5m HGV	0	1
	Carcass Collection	Box Van	1	1
32	Feed Delivery	16.5m HGV	0	1
33	Catching Gang	Mini Bus	1	1
	Bird Removal	16.5m HGV	4	10
	(Thinning)			
34	Feed Delivery	16.5m HGV	1	1
35	Feed Delivery	16.5m HGV	0	1
36	Feed Delivery	16.5m HGV	1	1
37	Feed Delivery	16.5m HGV	0	1
38	Carcass Collection	Box Van	1	1
	Feed Delivery	16.5m HGV	1	1
39	Feed Delivery	16.5m HGV	0	1
40	Catching Gang	Mini Bus	0	1
	Bird Removal	16.5m HGV	0	10
	Final Clearance			



Day	Activity	Vehicle Size	Existing Frequency	Proposed Frequency
41	Catching Gang Bird Removal Final Clearance	Mini Bus 16.5m HGV	1 9	1 10
42	Carcass Collection	Box Van	1	1
43	Manure Removal	Articulated HGV	4	9
44	Washing Gang	Mini Bus	1	1
45				
46	Shavings Delivery	16.5m HGV	1	1
47	Dirty Water Removal	Tanker	2	4
48	Chick Crumb	16.5m HGV	1	2
49				
50				
51				
Total			41 vehicles (82 movements)	81 vehicles (162 movements)
Total per Annum (7.2 flocks)			295 vehicles (590 movements)	583 vehicles (1166 movements)

- 4.2.4 The proposed poultry unit expansion will generate an additional 80 two-way HGV movement a flock cycle (40 in, 40 out).
- 4.2.5 On the busiest days of the flock cycle; day 33, 40 and 41 the development will generate 20 two-way HGV movements (10 in, 10 out). The peak movements will only occur three times per flock cycle. The proposed poultry unit will operate with 7.2 flocks per annum.
- 4.2.6 In addition to the commercial traffic there will be 1 member of staff generating 2 two-way movements per day. There will also be 1 visit per quarter from vets, inspectors and field officers.

4.3 HGV Routing

Feed Delivery/ Bird Deliveries/ Removal

- 4.3.1 In terms of local routing, all traffic will route out of the site towards the A120 north west of the site. This follows the same traffic management as the existing operations, associated with Phase 1 (**Appendix B**). Tracking Assessments as previously approved / agreed with ECC are attached at **Appendix E**. This confirms no off-site widening is



required. For the reasons discussed below, the position remains unchanged with the proposed extension.

- 4.3.2 Feed will route from Edge Green via the A1066, A140, A14, A12, and the A120. The chicken factory is located at Eye in Suffolk so will route along the A140, A14, A12 and A120.
- 4.3.3 Manure will go to Fibro in Thetford so will route along the A120, A12, A14 and then the A134.



5.0 TRAFFIC IMPACT

5.1 Highway Impact

- 5.1.1 The maximum movements for the proposed poultry unit will be on day 33, 40 and 41 of each cycle during bird removal with up to 20 two-way movements (10 in, 10 out).
- 5.1.2 This is an increase of 5 – 6 loads (10 – 12 movements) per day on day 33 and one on day 41. Previously it was assumed that no movements would take place on day 40.
- 5.1.3 Overall the level of traffic generated in any one day is not going to change materially from that already found acceptable. The increase in one HGV per day over that the consented position can have no material or noticeable impact.
- 5.1.4 The number of days that this level of traffic will occur, will increase from one day per 45 flock cycle to three days. Again in the context of the local highway network and the controls already secured for the consent this is not material.
- 5.1.5 It is clear that the intensification of the site will not result in a detrimental impact on the operation or safety of the existing highway network.



6.0 CONCLUSIONS

- 6.1 DTA was commissioned on behalf of the applicant A H Brown Farms to review the transport implications for Phase 2 of the proposed poultry unit expansion on land northwest of Redhouse Farm, Oakley Road, Wix, Manningtree, Essex.
- 6.2 The proposals include 3 No. broiler sheds to increase the bird capacity to 220,670 birds.
- 6.3 A review of the personal injury collision data has confirmed that there were no recorded collisions in the latest five-year period.
- 6.4 On the busiest days of the flock cycle, days 33, 40, 41 the development will generate an additional 20 two-way HGV movements (10 in, 10 out). The peak movements are during bird removal at the end of each flock cycle.
- 6.5 All traffic associated with Phase 1 will follow the same management traffic plan as the existing operations.
- 6.6 The additional movements are modest and are well within daily variations of traffic flows.
- 6.7 It is considered that the intensification of the site will not result in a detrimental impact on the operation or safety of the existing highway network.
- 6.8 The Transport Statement has demonstrated that the development is fully in accordance with both national and local policy and in particular confirms that the impact of the development is not severe. On this basis, it is concluded that there are no grounds for refusal on highway grounds.

Appendix A
Site Layout Plan



3 No. Additional Poultry Houses



IAN PICK ASSOCIATES LTD
Specialist Agricultural & Rural Planning Consultants
Station Farm Offices
Wansford Road
Nafferton
Driffield
East Yorkshire
YO23 8NU



CLIENT
A H Brown Farms
Dairy House Farm
Great Holland
Frinton on Sea
CO13 0EX

JOB TITLE
Proposed Poultry Unit Expansion

DWG. TITLE
Site Plan A1

SCALE
1:500

DRW
IP

DWG. NUMBER
PIA/HB/02

DATE
Jan 22

REV
-

Appendix B
Approved Routing Plan



1.0 INTRODUCTION

1.1.1 This Traffic Management Plan has been produced to outline the management strategy for controlling the HGV movements associated with the proposed construction and ongoing operational use of 2 no. poultry units located on land north west of Red House Far, Wix. The planning application reference is 20/00194/FUL.

1.1.2 This Traffic Management Plan has been prepared to discharge Condition 11.

1.1.3 The site is located to the north of Oakley Road. Great Oakley is located approximately 1.4km to the south east of the site and Wix approximately 1.8km to the west.

2.0 HGV ROUTING

2.1.1 All HGV vehicles accessing or departing from the farm are to follow the routes set out below. The inbound and outbound routing will be as follows:

Inbound details:

1. From Horsley Cross roundabout follow the A120 East to the Ramsey Roundabout then U-turn to travel west along the A120 – see **Figure 1**.
2. Take the left at the A120/ Harwich Road junction into Wix.
3. Take first left at War Memorial onto Oakley Road.
4. Proceed for 0.6 mile to the farm on the left.

Figure 1 – Inbound Route

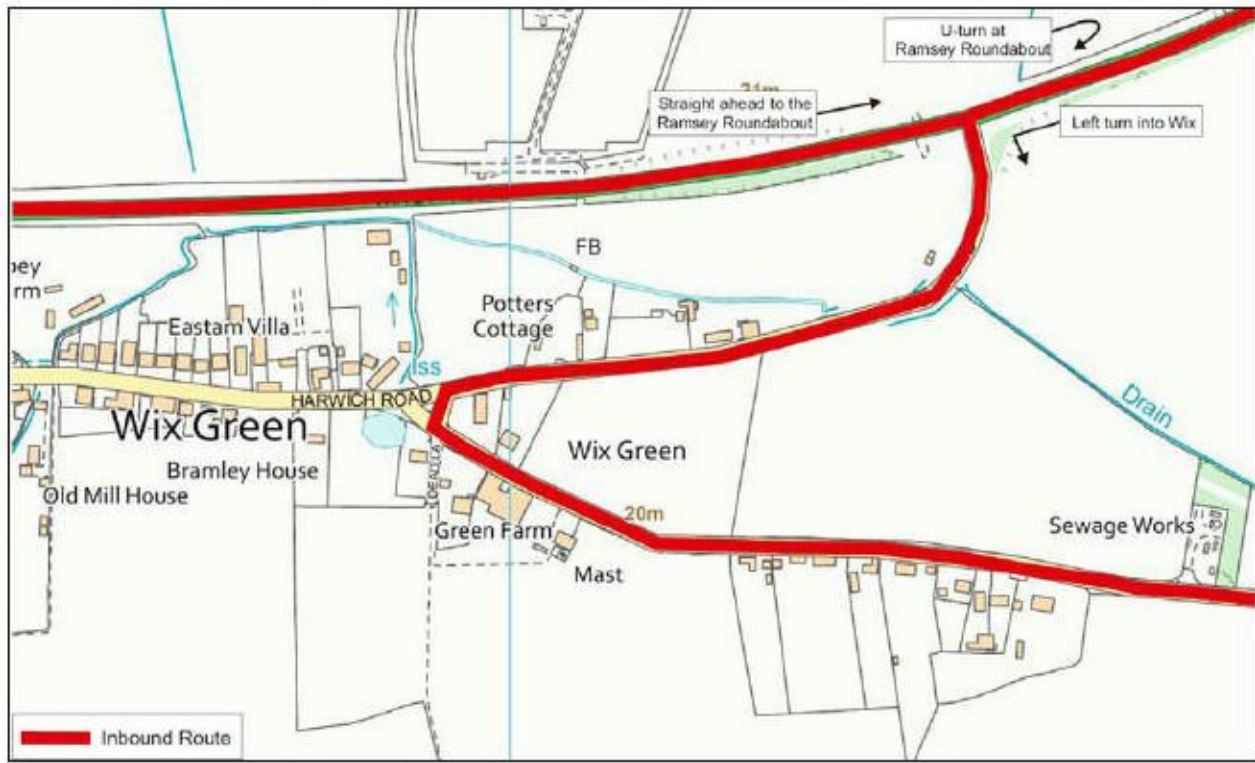

2.1.2 Outbound details:

1. Depart the farm by turning right onto Oakley Road.
2. At the junction onto Harwich Rd follow the route shown on **Figure 2** – all HGV's must pass to the left of the junction, before turning right onto Harwich Road.
3. Join the A120 westbound and proceed to Horsley Cross.

2.1.3 Representatives from Essex Highways have noted during their site visit that other HGV's of the size that will be travelling to and from the farm (but not associated with the farm) also undertook the same inbound and outbound manoeuvre proposed for deliveries as part of this application at this junction.

Figure 2 – Outbound Route



3.0 Site Management

3.1 Site management will implement the following initiatives to ensure that the operation of the site does not adversely impact the safety and operation of the adjacent highway network.

- All HGV movements to and from the site will be restricted to a designated access route. The Route Card is attached at **Appendix A**. The route information will be provided to all drivers, employees and contracted staff to ensure that the route is known. The routing agreement will be strictly adhered to by suppliers.
- Suppliers, as a condition of contract will have HGVs fitted with modern satellite tracking devices and hands-free cab telephones. The HGVs and the operators at the poultry unit will be in contact with one another to ensure vehicles do not meet one another along Oakley Road and at the site access.
- HGVs delivering to the site will be scheduled to allow a reasonable time window to avoid clashes. As part of the contract documentation all drivers of HGVs will be



informed of the procedure to contact the site 30 minutes prior to arrival to ensure that there will be a clear route.

- Any HGVs within the site about to depart when an HGV is due are to be kept within the site until the route is clear.
- Contact details for the Poultry Unit Site Management are to be provided to the Local Planning Authority with a review mechanism to annually appraise the operation of the site.

Appendix A

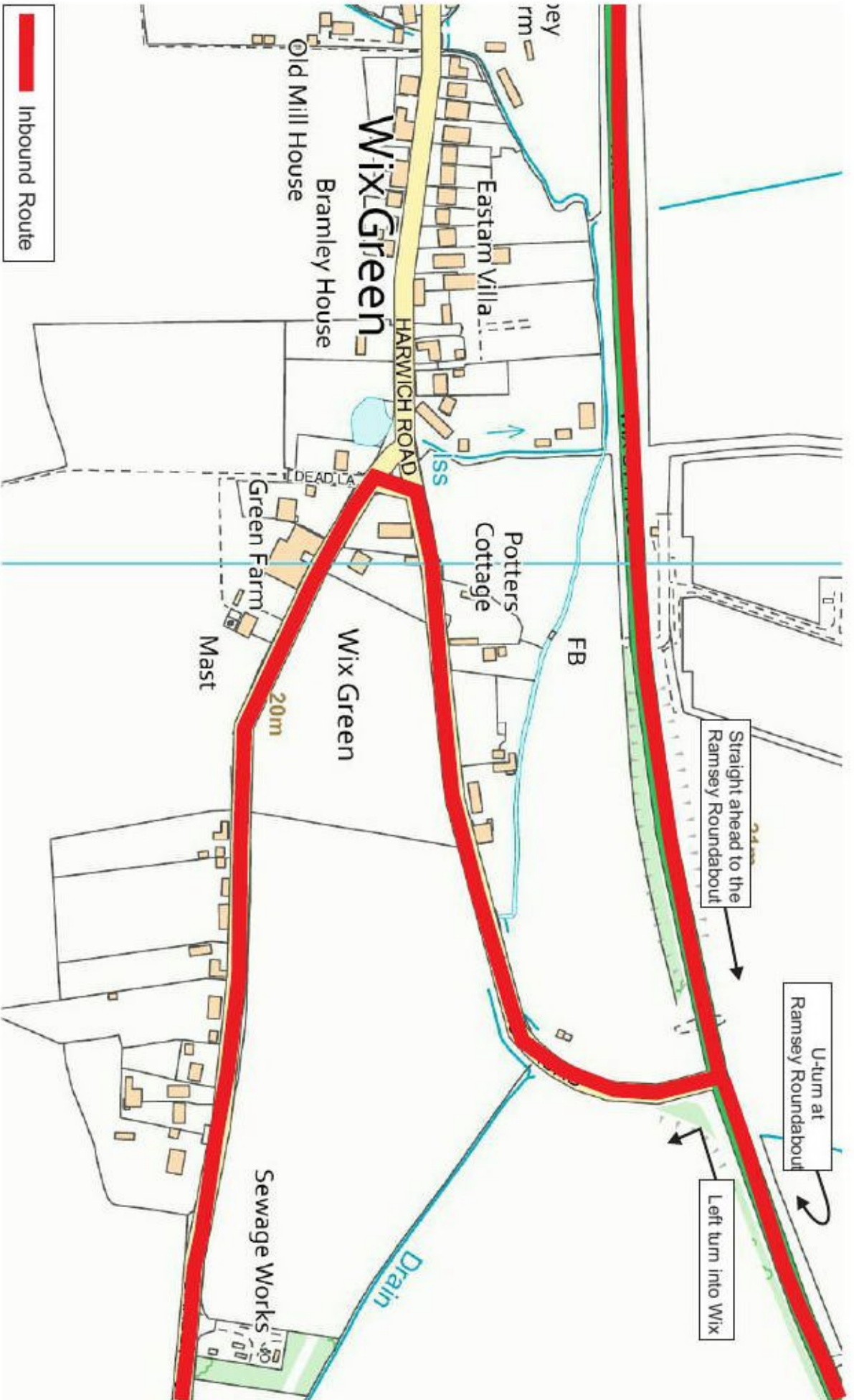

 Inbound Route



David Tucker Associates
 Transport Planning Consultancy
 Forester House, Doctors Lane, Henley-in-Arden

Notes:

Figure 1
 Drawing Title
 Job Title
 Client

Drawing No : 21314-01
 Route Plan
 Oakley Road, Wix
 A H Brown Farms

Scale : NTS



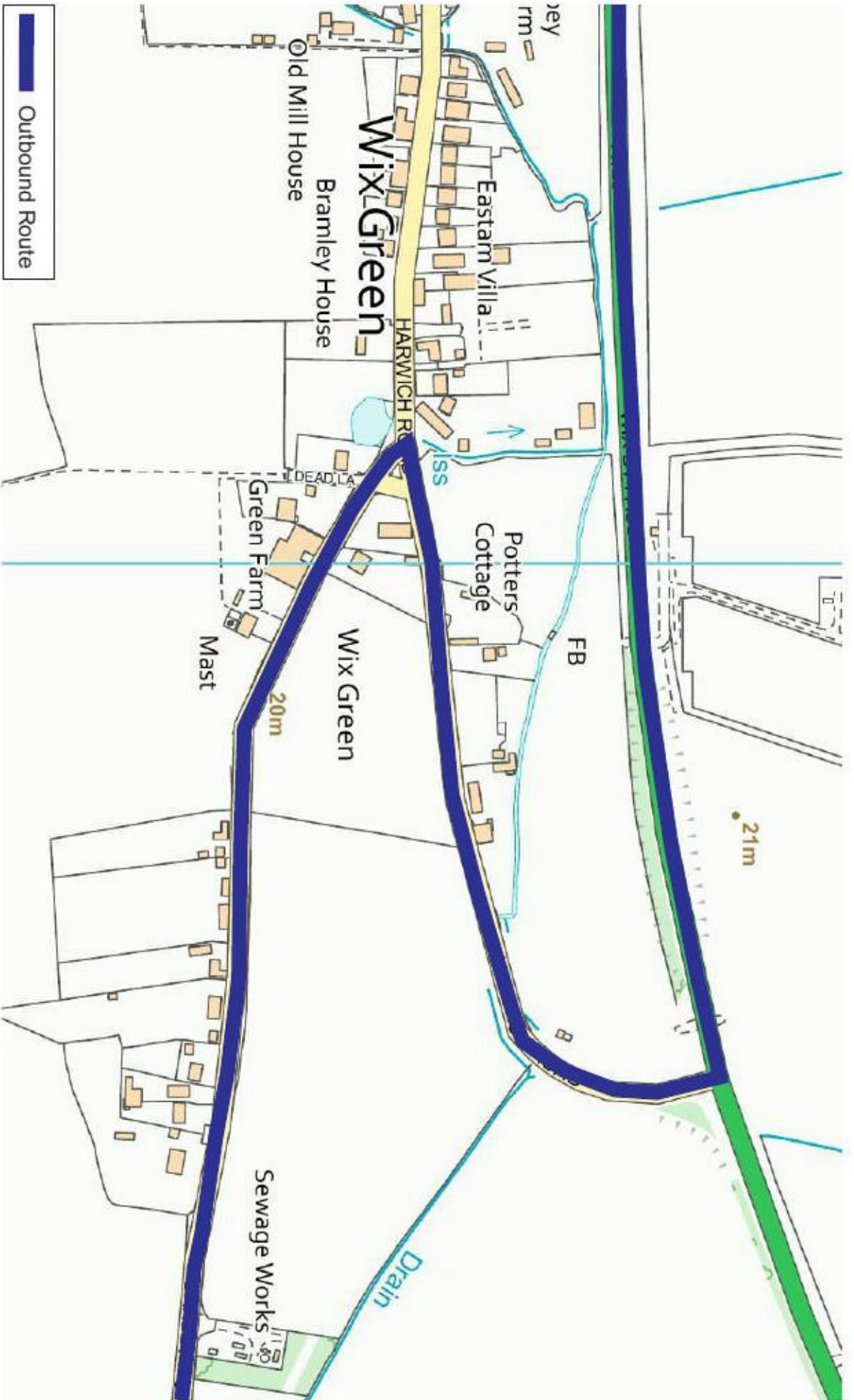

Outbound Route



David Tucker Associates
 Transport Planning Consultancy
 Forester House, Doctors Lane, Henley-in-Arden

Notes:

Figure 2
 Drawing Title
 Job Title
 Client

Drawing No : 21314-01
 Route Plan
 Oakley Road, Wix
 A H Brown Farms

Scale : NTS



Appendix C
ATC Survey

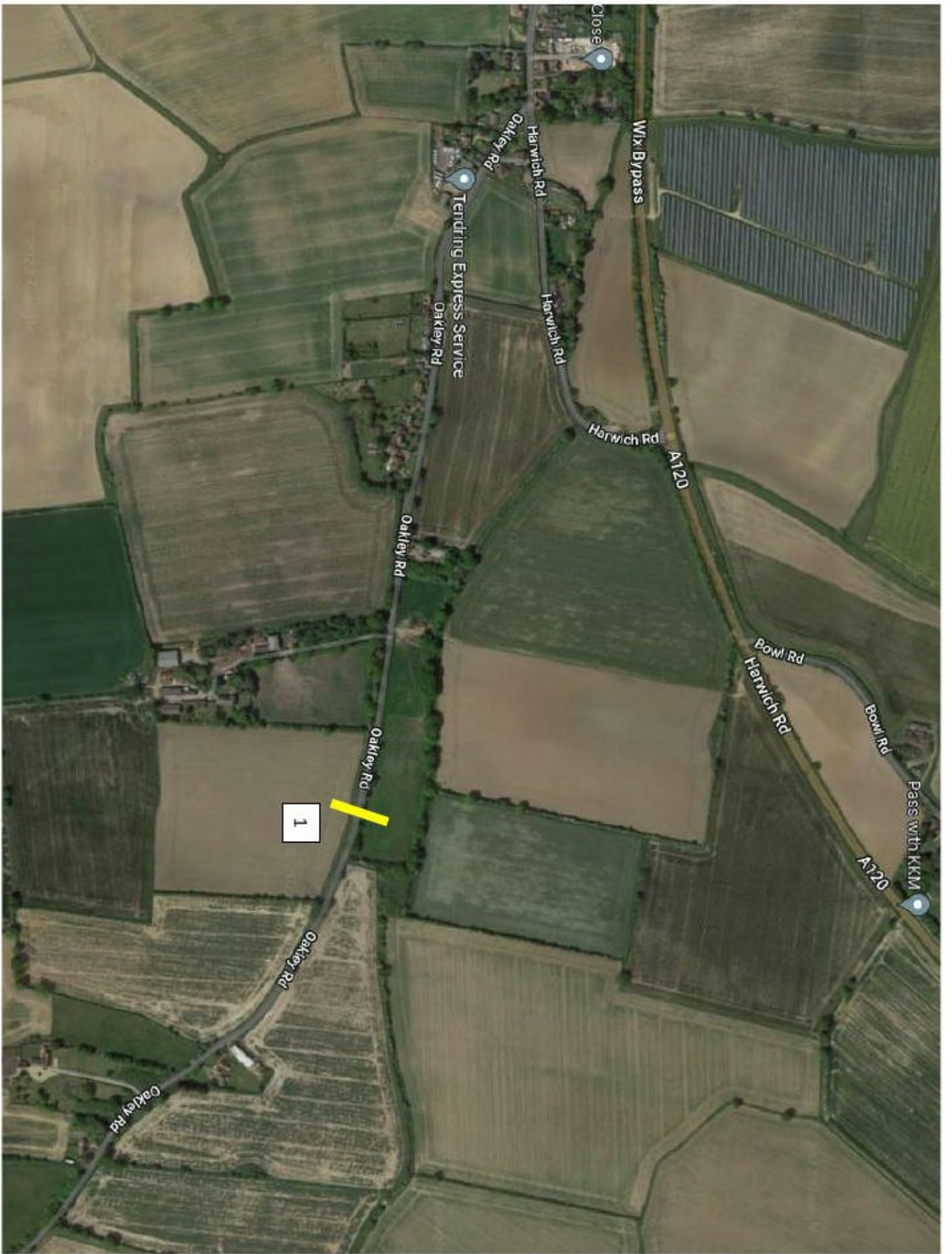

11174		W0X		MARCH 2022		Posted Speed Limit (PSL)	Total Vehicles	5 Day Ave.	7 Day Ave.	Average 85%ile Speed	Average Mean Speed
Site	Location	Direction	Start Date	End Date							
Site No: 11174001	Oakley Rd, Wix (adj to Throle) 51 910549, 1.165839	Channel: Eastbound	Fr 11-Mar-22	Thu 17-Mar-22	NSL	3346	528	478	53.6	45.5	
		Channel: Westbound	Fr 11-Mar-22	Thu 17-Mar-22		3426	536	499	53.8	45.0	

11174 WIX Site No: 11174001 Location Oakley Rd, Wix (att to T/Pole)
 Fri 11-Mar-22 to Thu 17-Mar-22 Channel: Eastbound

TIME PERIOD	TOTAL VEHICLES	MOTOR-CYCLES	CARS OR CAR-BASED LGV	LIGHT GOODS VEHICLES	BUSES	TWO AXLE, SIX TYRE, RIGID/BUSES	THREE AXLE RIGID	FOUR OR MORE AXLE RIGID	FOUR OR LESS AXLE ARTIC	FIVE AXLE ARTIC	SIX OR MORE AXLE ARTIC	FIVE OR LESS AXLE MULTI-TRAILER ARTIC	SIX AXLE MULTI-TRAILER ARTIC	SEVEN OR MORE AXLE ARTIC
Fri 11-Mar-22														
00:00	0	0	0	0	0	0	0	0	0	0	0	0	0	0
01:00	1	0	1	0	0	0	0	0	0	0	0	0	0	0
02:00	1	0	1	0	0	0	0	0	0	0	0	0	0	0
03:00	0	0	0	0	0	0	0	0	0	0	0	0	0	0
04:00	0	0	0	0	0	0	0	0	0	0	0	0	0	0
05:00	1	0	1	0	0	0	0	0	0	0	0	0	0	0
06:00	4	0	4	0	0	0	0	0	0	0	0	0	0	0
07:00	20	0	13	6	0	1	0	0	0	0	0	0	0	0
08:00	47	1	38	6	1	0	0	1	1	0	0	0	0	0
09:00	29	0	20	6	0	1	1	0	0	0	0	0	0	0
10:00	37	0	28	8	0	1	0	0	0	0	0	0	0	0
11:00	30	2	19	7	0	1	0	0	0	0	0	0	0	0
12:00	46	2	39	2	1	0	0	0	1	0	0	0	0	0
13:00	30	0	26	3	0	1	0	0	0	0	0	0	0	0
14:00	45	0	38	4	0	0	1	0	1	0	0	0	0	0
15:00	55	0	42	9	1	3	0	0	0	0	0	0	0	0
16:00	65	2	50	10	0	3	0	0	0	0	0	0	0	0
17:00	54	1	47	3	1	0	0	0	0	0	1	0	0	0
18:00	36	0	31	4	1	0	0	0	0	0	0	0	0	0
19:00	13	0	12	1	0	0	0	0	0	0	0	0	0	0
20:00	13	0	12	0	1	0	0	0	0	0	0	0	0	0
21:00	9	0	7	1	1	0	0	0	0	0	0	0	0	0
22:00	8	0	7	1	0	0	0	0	0	0	0	0	0	0
23:00	8	0	7	1	0	0	0	0	0	0	0	0	0	0
12H,7-19	494	8	391	68	5	11	2	0	3	1	0	5	0	0
16H,6-22	533	8	426	70	7	11	2	0	3	1	0	5	0	0
18H,6-24	549	8	440	72	7	11	2	0	3	1	0	5	0	0
24H,0-24	552	8	443	72	7	11	2	0	3	1	0	5	0	0
Sat 12-Mar-22														
00:00	5	0	4	1	0	0	0	0	0	0	0	0	0	0
01:00	0	0	0	0	0	0	0	0	0	0	0	0	0	0

TIME PERIOD	TOTAL VEHICLES	MOTOR-CYCLES	CARS OR CAR-BASED LGV	LIGHT GOODS VEHICLES	BUSES	TWO AXLE, SIX TYRE, RIGID/BUSES	THREE AXLE RIGID	FOUR OR MORE AXLE RIGID	FOUR OR LESS AXLE ARTIC	FIVE AXLE ARTIC	SIX OR MORE AXLE ARTIC	FIVE OR LESS AXLE MULTI-TRAILER ARTIC	SIX AXLE MULTI-TRAILER ARTIC	SEVEN OR MORE AXLE ARTIC
02:00	0	0	0	0	0	0	0	0	0	0	0	0	0	0
03:00	0	0	0	0	0	0	0	0	0	0	0	0	0	0
04:00	2	0	2	0	0	0	0	0	0	0	0	0	0	0
05:00	1	0	1	0	0	0	0	0	0	0	0	0	0	0
06:00	4	0	3	1	0	0	0	0	0	0	0	0	0	0
07:00	12	0	12	0	0	0	0	0	0	0	0	0	0	0
08:00	10	0	7	2	0	1	0	0	0	0	0	0	0	0
09:00	23	0	21	1	1	0	0	0	0	0	0	0	0	0
10:00	20	0	18	2	0	0	0	0	0	0	0	0	0	0
11:00	33	0	24	8	1	0	0	0	0	0	0	0	0	0
12:00	34	1	25	7	1	0	0	0	0	0	0	0	0	0
13:00	45	2	33	7	1	2	0	0	0	0	0	0	0	0
14:00	32	1	29	1	0	1	0	0	0	0	0	0	0	0
15:00	21	1	18	1	0	1	0	0	0	0	0	0	0	0
16:00	31	1	26	4	0	0	0	0	0	0	0	0	0	0
17:00	30	2	25	2	1	0	0	0	0	0	0	0	0	0
18:00	30	0	28	1	1	0	0	0	0	0	0	0	0	0
19:00	18	0	14	3	0	1	0	0	0	0	0	0	0	0
20:00	13	0	13	0	0	0	0	0	0	0	0	0	0	0
21:00	8	0	7	0	0	1	0	0	0	0	0	0	0	0
22:00	8	0	8	0	0	0	0	0	0	0	0	0	0	0
23:00	9	0	9	0	0	0	0	0	0	0	0	0	0	0
12H,7-19	321	8	266	36	6	5	0	0	0	0	0	0	0	0
16H,6-22	364	8	303	40	6	7	0	0	0	0	0	0	0	0
18H,6-24	381	8	320	40	6	7	0	0	0	0	0	0	0	0
24H,0-24	389	8	327	41	6	7	0	0	0	0	0	0	0	0
Sun 13-Mar-22														
00:00	3	0	2	0	1	0	0	0	0	0	0	0	0	0
01:00	3	0	2	1	0	0	0	0	0	0	0	0	0	0
02:00	1	0	1	0	0	0	0	0	0	0	0	0	0	0
03:00	0	0	0	0	0	0	0	0	0	0	0	0	0	0
04:00	0	0	0	0	0	0	0	0	0	0	0	0	0	0

TIME PERIOD	TOTAL VEHICLES	MOTOR-CYCLES	CARS OR CAR-BASED LGV	LIGHT GOODS VEHICLES	BUSES	TWO AXLE, SIX TYRE, RIGID/BUSES	THREE AXLE RIGID	FOUR OR MORE AXLE RIGID	FOUR OR LESS AXLE ARTIC	FIVE AXLE ARTIC	SIX OR MORE AXLE ARTIC	FIVE OR LESS AXLE MULTI-TRAILER ARTIC	SIX AXLE MULTI-TRAILER ARTIC	SEVEN OR MORE AXLE ARTIC
05:00	0	0	0	0	0	0	0	0	0	0	0	0	0	0
06:00	0	0	0	0	0	0	0	0	0	0	0	0	0	0
07:00	8	0	7	1	0	0	0	0	0	0	0	0	0	0
08:00	11	0	8	3	0	0	0	0	0	0	0	0	0	0
09:00	13	1	9	1	0	1	1	0	0	0	0	0	0	0
10:00	16	0	15	1	0	0	0	0	0	0	0	0	0	0
11:00	29	0	24	4	1	0	0	0	0	0	0	0	0	0
12:00	31	0	28	3	0	0	0	0	0	0	0	0	0	0
13:00	29	0	26	3	0	0	0	0	0	0	0	0	0	0
14:00	34	0	29	4	0	1	0	0	0	0	0	0	0	0
15:00	30	0	26	2	0	1	0	0	1	0	0	0	0	0
16:00	26	0	22	4	0	0	0	0	0	0	0	0	0	0
17:00	22	0	17	4	1	0	0	0	0	0	0	0	0	0
18:00	18	0	17	1	0	0	0	0	0	0	0	0	0	0
19:00	15	0	13	1	1	0	0	0	0	0	0	0	0	0
20:00	5	0	5	0	0	0	0	0	0	0	0	0	0	0
21:00	12	0	11	1	0	0	0	0	0	0	0	0	0	0
22:00	7	0	5	1	0	0	0	0	0	0	0	1	0	0
23:00	5	0	5	0	0	0	0	0	0	0	0	0	0	0
12H,7-19	267	1	228	31	2	3	1	0	1	0	0	0	0	0
16H,6-22	299	1	257	33	3	3	1	0	1	0	0	0	0	0
18H,6-24	311	1	267	34	3	3	1	0	1	0	0	1	0	0
24H,0-24	318	1	272	35	4	3	1	0	1	0	0	1	0	0
Mon 14-Mar-22	1	0	1	0	0	0	0	0	0	0	0	0	0	0
00:00	0	0	0	0	0	0	0	0	0	0	0	0	0	0
01:00	0	0	0	0	0	0	0	0	0	0	0	0	0	0
02:00	0	0	0	0	0	0	0	0	0	0	0	0	0	0
03:00	0	0	0	0	0	0	0	0	0	0	0	0	0	0
04:00	0	0	0	0	0	0	0	0	0	0	0	0	0	0
05:00	1	0	1	0	0	0	0	0	0	0	0	0	0	0
06:00	5	0	5	0	0	0	0	0	0	0	0	0	0	0
07:00	19	0	19	0	0	0	0	0	0	0	0	0	0	0

TIME PERIOD	TOTAL VEHICLES	MOTOR-CYCLES	CARS OR CAR-BASED LGV	LIGHT GOODS VEHICLES	BUSES	TWO AXLE, SIX TYRE, RIGID/BUSES	THREE AXLE RIGID	FOUR OR MORE AXLE RIGID	FOUR OR LESS AXLE ARTIC	FIVE AXLE ARTIC	SIX OR MORE AXLE ARTIC	FIVE OR LESS AXLE MULTI-TRAILER ARTIC	SIX AXLE MULTI-TRAILER ARTIC	SEVEN OR MORE AXLE ARTIC
08:00	39	0	32	6	1	0	0	0	0	0	0	0	0	0
09:00	27	0	22	4	1	0	0	0	0	0	0	0	0	0
10:00	30	2	21	6	1	0	0	0	0	0	0	0	0	0
11:00	28	0	22	5	1	0	0	0	0	0	0	0	0	0
12:00	31	1	24	4	2	0	0	0	0	0	0	0	0	0
13:00	30	0	24	3	1	0	1	0	0	0	0	1	0	0
14:00	35	2	24	7	1	0	0	0	1	0	0	0	0	0
15:00	61	1	47	7	0	5	0	0	1	0	0	0	0	0
16:00	44	3	36	4	1	0	0	0	0	0	0	0	0	0
17:00	63	0	52	10	1	0	0	0	0	0	0	0	0	0
18:00	37	1	31	4	0	1	0	0	0	0	0	0	0	0
19:00	22	0	19	2	0	0	0	0	0	0	1	0	0	0
20:00	17	0	13	3	1	0	0	0	0	0	0	0	0	0
21:00	8	0	6	0	1	0	0	0	0	0	0	1	0	0
22:00	7	0	7	0	0	0	0	0	0	0	0	0	0	0
23:00	3	0	2	1	0	0	0	0	0	0	0	0	0	0
12H,7-19	444	10	354	60	10	6	1	0	2	0	0	1	0	0
16H,6-22	496	10	397	65	12	6	1	0	2	0	1	2	0	0
18H,6-24	506	10	406	66	12	6	1	0	2	0	1	2	0	0
24H,0-24	508	10	408	66	12	6	1	0	2	0	1	2	0	0
Tue 15-Mar-22														
00:00	4	0	3	1	0	0	0	0	0	0	0	0	0	0
01:00	0	0	0	0	0	0	0	0	0	0	0	0	0	0
02:00	0	0	0	0	0	0	0	0	0	0	0	0	0	0
03:00	0	0	0	0	0	0	0	0	0	0	0	0	0	0
04:00	1	0	1	0	0	0	0	0	0	0	0	0	0	0
05:00	2	0	2	0	0	0	0	0	0	0	0	0	0	0
06:00	6	0	3	0	0	1	0	0	1	0	0	1	0	0
07:00	24	0	19	4	0	1	0	0	0	0	0	0	0	0
08:00	42	0	35	6	1	0	0	0	0	0	0	0	0	0
09:00	24	1	15	7	0	1	0	0	0	0	0	0	0	0
10:00	20	0	15	3	1	0	0	0	1	0	0	0	0	0

TIME PERIOD	TOTAL VEHICLES	MOTOR-CYCLES	CARS OR CAR-BASED LGV	LIGHT GOODS VEHICLES	BUSES	TWO AXLE, SIX TYRE, RIGID/BUSES	THREE AXLE RIGID	FOUR OR MORE AXLE RIGID	FOUR OR LESS AXLE ARTIC	FIVE AXLE ARTIC	SIX OR MORE AXLE ARTIC	FIVE OR LESS AXLE MULTI-TRAILER ARTIC	SIX AXLE MULTI-TRAILER ARTIC	SEVEN OR MORE AXLE ARTIC
11:00	28	1	16	7	2	0	0	0	0	0	1	0	0	0
12:00	31	2	23	4	1	0	0	0	0	0	1	0	0	0
13:00	25	3	18	3	1	0	0	0	0	0	0	0	0	0
14:00	30	2	23	3	1	0	0	0	1	0	0	0	0	0
15:00	62	0	47	9	2	3	0	0	0	0	0	1	0	0
16:00	58	0	51	6	0	1	0	0	0	0	0	0	0	0
17:00	60	1	52	6	1	0	0	0	0	0	0	0	0	0
18:00	38	0	31	5	1	0	1	0	0	0	0	0	0	0
19:00	24	0	24	0	0	0	0	0	0	0	0	0	0	0
20:00	15	0	13	1	1	0	0	0	0	0	0	0	0	0
21:00	12	0	7	3	0	1	0	0	0	0	0	1	0	0
22:00	10	0	10	0	0	0	0	0	0	0	0	0	0	0
23:00	3	0	2	1	0	0	0	0	0	0	0	0	0	0
12H,7-19	442	10	345	63	11	6	1	0	2	1	1	2	0	0
16H,6-22	499	10	392	67	12	8	1	0	3	1	1	4	0	0
18H,6-24	512	10	404	68	12	8	1	0	3	1	1	4	0	0
24H,0-24	519	10	410	69	12	8	1	0	3	1	1	4	0	0
Wed 16-Mar-22														
00:00	0	0	0	0	0	0	0	0	0	0	0	0	0	0
01:00	0	0	0	0	0	0	0	0	0	0	0	0	0	0
02:00	0	0	0	0	0	0	0	0	0	0	0	0	0	0
03:00	2	0	2	0	0	0	0	0	0	0	0	0	0	0
04:00	0	0	0	0	0	0	0	0	0	0	0	0	0	0
05:00	2	0	2	0	0	0	0	0	0	0	0	0	0	0
06:00	8	0	5	0	1	0	0	0	2	0	0	0	0	0
07:00	25	0	21	3	0	0	0	0	0	0	0	1	0	0
08:00	37	0	32	4	0	1	0	0	0	0	0	0	0	0
09:00	29	1	15	5	1	1	0	1	4	0	1	0	0	0
10:00	29	0	24	2	1	0	0	0	0	0	1	1	0	0
11:00	38	2	25	6	1	0	1	0	2	0	0	1	0	0
12:00	22	1	16	3	1	0	1	0	0	0	0	0	0	0
13:00	28	0	22	3	1	0	1	0	0	0	1	0	0	0

TIME PERIOD	TOTAL VEHICLES	MOTOR-CYCLES	CARS OR CAR-BASED LGV	LIGHT GOODS VEHICLES	BUSES	TWO AXLE, SIX TYRE, RIGID/BUSES	THREE AXLE RIGID	FOUR OR MORE AXLE RIGID	FOUR OR LESS AXLE ARTIC	FIVE AXLE ARTIC	SIX OR MORE AXLE ARTIC	FIVE OR LESS AXLE MULTI-TRAILER ARTIC	SIX AXLE MULTI-TRAILER ARTIC	SEVEN OR MORE AXLE ARTIC
14:00	24	0	21	1	1	1	0	0	0	0	0	0	0	0
15:00	58	0	41	9	1	4	0	0	2	0	0	1	0	0
16:00	57	1	50	5	0	1	0	0	0	0	0	0	0	0
17:00	56	0	47	8	1	0	0	0	0	0	0	0	0	0
18:00	37	0	33	3	0	1	0	0	0	0	0	0	0	0
19:00	33	0	30	3	0	0	0	0	0	0	0	0	0	0
20:00	11	0	7	3	1	0	0	0	0	0	0	0	0	0
21:00	13	0	11	0	0	1	0	0	0	0	0	1	0	0
22:00	5	0	4	1	0	0	0	0	0	0	0	0	0	0
23:00	2	0	1	1	0	0	0	0	0	0	0	0	0	0
12H,7-19	440	5	347	52	8	9	3	1	8	0	3	4	0	0
16H,6-22	505	5	400	58	10	10	3	1	10	0	3	5	0	0
18H,6-24	512	5	405	60	10	10	3	1	10	0	3	5	0	0
24H,0-24	516	5	409	60	10	10	3	1	10	0	3	5	0	0
Thu 17-Mar-22														
00:00	4	0	3	1	0	0	0	0	0	0	0	0	0	0
01:00	0	0	0	0	0	0	0	0	0	0	0	0	0	0
02:00	3	0	1	2	0	0	0	0	0	0	0	0	0	0
03:00	2	0	1	1	0	0	0	0	0	0	0	0	0	0
04:00	0	0	0	0	0	0	0	0	0	0	0	0	0	0
05:00	3	0	2	0	0	0	1	0	0	0	0	0	0	0
06:00	3	0	2	0	0	0	0	0	0	0	0	1	0	0
07:00	19	0	14	1	0	1	2	0	1	0	0	0	0	0
08:00	40	0	33	4	1	0	0	0	0	0	2	0	0	0
09:00	32	1	25	3	1	2	0	0	0	0	0	0	0	0
10:00	29	0	24	4	0	1	0	0	0	0	0	0	0	0
11:00	37	1	24	11	1	0	0	0	0	0	0	0	0	0
12:00	34	0	26	6	0	1	0	0	1	0	0	0	0	0
13:00	38	1	32	3	0	2	0	0	0	0	0	0	0	0
14:00	33	3	24	3	1	0	0	0	2	0	0	0	0	0
15:00	61	2	42	9	2	6	0	0	0	0	0	0	0	0
16:00	60	1	47	11	0	1	0	0	0	0	0	0	0	0

TIME PERIOD	TOTAL VEHICLES	MOTOR-CYCLES	CARS OR CAR-BASED LGV	LIGHT GOODS VEHICLES	BUSES	TWO AXLE, SIX TYRE, RIGID/BUSES	THREE AXLE RIGID	FOUR OR MORE AXLE RIGID	FOUR OR LESS AXLE ARTIC	FIVE AXLE ARTIC	SIX OR MORE AXLE ARTIC	FIVE OR LESS AXLE MULTI-TRAILER ARTIC	SIX AXLE MULTI-TRAILER ARTIC	SEVEN OR MORE AXLE ARTIC
17:00	46	0	37	8	1	0	0	0	0	0	0	0	0	0
18:00	44	1	40	2	1	0	0	0	0	0	0	0	0	0
19:00	26	1	24	1	0	0	0	0	0	0	0	0	0	0
20:00	15	0	13	0	0	1	0	0	0	0	0	1	0	0
21:00	8	0	6	1	1	0	0	0	0	0	0	0	0	0
22:00	7	0	7	0	0	0	0	0	0	0	0	0	0	0
23:00	2	0	1	1	0	0	0	0	0	0	0	0	0	0
12H,7-19	473	10	368	65	8	14	2	0	4	0	2	0	0	0
16H,6-22	525	11	413	67	9	15	2	0	4	0	2	2	0	0
18H,6-24	534	11	421	68	9	15	2	0	4	0	2	2	0	0
24H,0-24	546	11	428	72	9	15	3	0	4	0	2	2	0	0
Daily Totals														
Fri 11-Mar-22	552	8	443	72	7	11	2	0	3	1	0	5	0	0
Sat 12-Mar-22	389	8	327	41	6	7	0	0	0	0	0	0	0	0
Sun 13-Mar-22	318	1	272	35	4	3	1	0	1	0	0	1	0	0
Mon 14-Mar-22	508	10	408	66	12	6	1	0	2	0	1	2	0	0
Tue 15-Mar-22	519	10	410	69	12	8	1	0	3	1	1	4	0	0
Wed 16-Mar-22	516	5	409	60	10	10	3	1	10	0	3	5	0	0
Thu 17-Mar-22	546	11	428	72	9	15	3	0	4	0	2	2	0	0
Total Vehicles	3348	53	2697	415	60	60	11	1	23	2	7	19	0	0

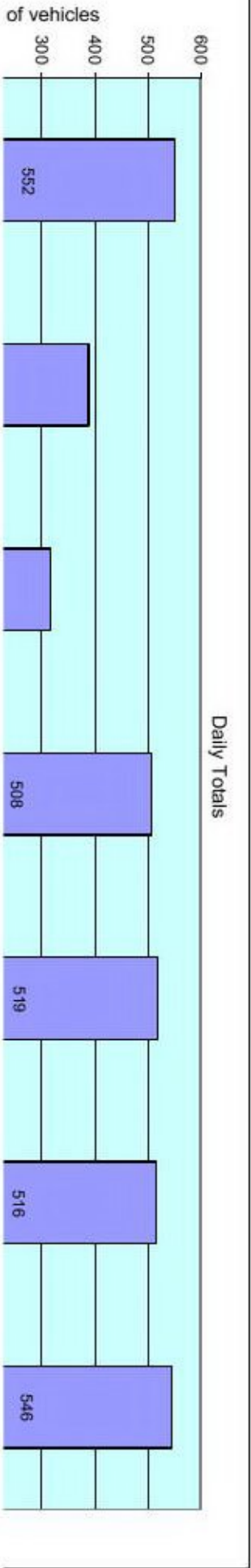

11174 WIX Site No: 11174001 Location Oakley Rd, Wix (att to T/Pole)
 Fri 11-Mar-22 to Thu 17-Mar-22 Channel: Eastbound

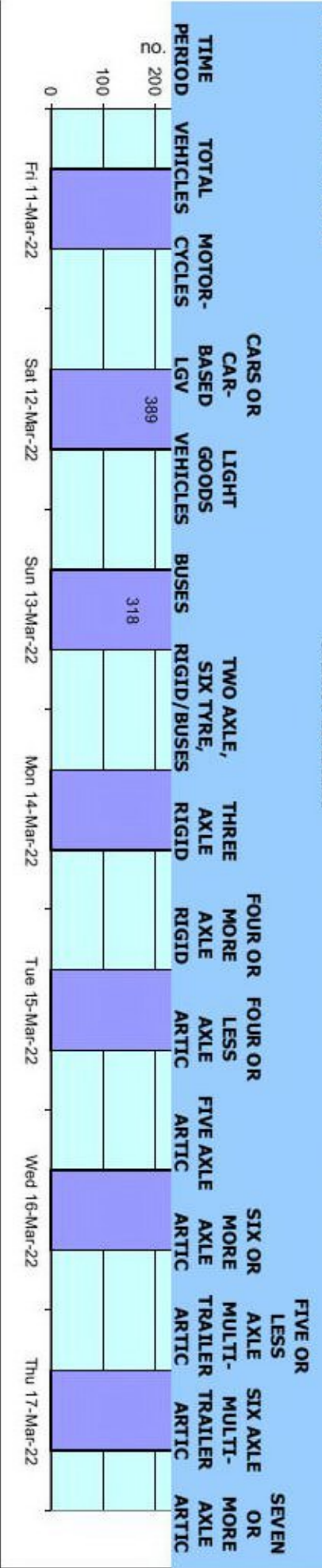

TIME PERIOD	TOTAL VEHICLES	MOTOR-CYCLES	MOTOR-CYCLES%	CARS	CARS %	LGV	LGV %	HGV	HGV %	BUS	BUS %
Fri 11-Mar-22											
00:00	0	0	-	0	-	0	-	0	-	0	-
01:00	1	0	0.0	1	100.0	0	0.0	0	0.0	0	0.0
02:00	1	0	0.0	1	100.0	0	0.0	0	0.0	0	0.0
03:00	0	0	-	0	-	0	-	0	-	0	-
04:00	0	0	-	0	-	0	-	0	-	0	-
05:00	1	0	0.0	1	100.0	0	0.0	0	0.0	0	0.0
06:00	4	0	0.0	4	100.0	0	0.0	0	0.0	0	0.0
07:00	20	0	0.0	13	65.0	6	30.0	1	5.0	0	0.0
08:00	47	1	2.1	38	80.9	6	12.8	1	2.1	1	2.1
09:00	29	0	0.0	20	69.0	6	20.7	3	10.3	0	0.0
10:00	37	0	0.0	28	75.7	8	21.6	1	2.7	0	0.0
11:00	30	2	6.7	19	63.3	7	23.3	2	6.7	0	0.0
12:00	46	2	4.4	39	84.8	2	4.4	2	4.4	1	2.2
13:00	30	0	0.0	26	86.7	3	10.0	1	3.3	0	0.0
14:00	45	0	0.0	38	84.4	4	8.9	3	6.7	0	0.0
15:00	55	0	0.0	42	76.4	9	16.4	3	5.5	1	1.8
16:00	65	2	3.1	50	76.9	10	15.4	3	4.6	0	0.0
17:00	54	1	1.9	47	87.0	3	5.6	2	3.7	1	1.9
18:00	36	0	0.0	31	86.1	4	11.1	0	0.0	1	2.8
19:00	13	0	0.0	12	92.3	1	7.7	0	0.0	0	0.0
20:00	13	0	0.0	12	92.3	0	0.0	0	0.0	1	7.7
21:00	9	0	0.0	7	77.8	1	11.1	0	0.0	1	11.1
22:00	8	0	0.0	7	87.5	1	12.5	0	0.0	0	0.0
23:00	8	0	0.0	7	87.5	1	12.5	0	0.0	0	0.0
12H 7-19	494	8	1.6	391	79.2	68	13.8	22	4.5	5	1.0
16H 6-22	533	8	1.5	426	79.9	70	13.1	22	4.1	7	1.3
18H 6-24	549	8	1.5	440	80.2	72	13.1	22	4.0	7	1.3
24H 0-24	552	8	1.5	443	80.3	72	13.0	22	4.0	7	1.3
Sat 12-Mar-22											
00:00	5	0	0.0	4	80.0	1	20.0	0	0.0	0	0.0
01:00	0	0	-	0	-	0	-	0	-	0	-

11174
Fri 11-Mar-22 to Thu 17-Mar-22

WIX
Site No: 11174001
Channel: Eastbound

Location
Oakley Rd, Wix (att to T/Pole)

TIME PERIOD	TOTAL VEHICLES	MOTOR-CYCLES	MOTOR-CYCLES%	CARS	CARS %	LGV	LGV %	HGV	HGV %	BUS	BUS %
02:00	0	0	-	0	-	0	-	0	-	0	-
03:00	0	0	-	0	-	0	-	0	-	0	-
04:00	2	0	0.0	2	100.0	0	0.0	0	0.0	0	0.0
05:00	1	0	0.0	1	100.0	0	0.0	0	0.0	0	0.0
06:00	4	0	0.0	3	75.0	1	25.0	0	0.0	0	0.0
07:00	12	0	0.0	12	100.0	0	0.0	0	0.0	0	0.0
08:00	10	0	0.0	7	70.0	2	20.0	1	10.0	0	0.0
09:00	23	0	0.0	21	91.3	1	4.4	0	0.0	1	4.4
10:00	20	0	0.0	18	90.0	2	10.0	0	0.0	0	0.0
11:00	33	0	0.0	24	72.7	8	24.2	0	0.0	1	3.0
12:00	34	1	2.9	25	73.5	7	20.6	0	0.0	1	2.9
13:00	45	2	4.4	33	73.3	7	15.6	2	4.4	1	2.2
14:00	32	1	3.1	29	90.6	1	3.1	1	3.1	0	0.0
15:00	21	1	4.8	18	85.7	1	4.8	1	4.8	0	0.0
16:00	31	1	3.2	26	83.9	4	12.9	0	0.0	0	0.0
17:00	30	2	6.7	25	83.3	2	6.7	0	0.0	1	3.3
18:00	30	0	0.0	28	93.3	1	3.3	0	0.0	1	3.3
19:00	18	0	0.0	14	77.8	3	16.7	1	5.6	0	0.0
20:00	13	0	0.0	13	100.0	0	0.0	0	0.0	0	0.0
21:00	8	0	0.0	7	87.5	0	0.0	1	12.5	0	0.0
22:00	8	0	0.0	8	100.0	0	0.0	0	0.0	0	0.0
23:00	9	0	0.0	9	100.0	0	0.0	0	0.0	0	0.0
12H 7-19	321	8	2.5	266	82.9	36	11.2	5	1.6	6	1.9
16H 6-22	364	8	2.2	303	83.2	40	11.0	7	1.9	6	1.7
18H 6-24	381	8	2.1	320	84.0	40	10.5	7	1.8	6	1.6
24H 0-24	389	8	2.1	327	84.1	41	10.5	7	1.8	6	1.5
Sun 13-Mar-22											
00:00	3	0	0.0	2	66.7	0	0.0	0	0.0	1	33.3
01:00	3	0	0.0	2	66.7	1	33.3	0	0.0	0	0.0
02:00	1	0	0.0	1	100.0	0	0.0	0	0.0	0	0.0
03:00	0	0	-	0	-	0	-	0	-	0	-
04:00	0	0	-	0	-	0	-	0	-	0	-

TIME PERIOD	TOTAL VEHICLES	MOTOR-CYCLES	MOTOR-CYCLES%	CARS	CARS %	LGV	LGV %	HGV	HGV %	BUS	BUS %
05:00	0	0	-	0	-	0	-	0	-	0	-
06:00	0	0	-	0	-	0	-	0	-	0	-
07:00	8	0	0.0	7	87.5	1	12.5	0	0.0	0	0.0
08:00	11	0	0.0	8	72.7	3	27.3	0	0.0	0	0.0
09:00	13	1	7.7	9	69.2	1	7.7	2	15.4	0	0.0
10:00	16	0	0.0	15	93.8	1	6.3	0	0.0	0	0.0
11:00	29	0	0.0	24	82.8	4	13.8	0	0.0	1	3.5
12:00	31	0	0.0	28	90.3	3	9.7	0	0.0	0	0.0
13:00	29	0	0.0	26	89.7	3	10.3	0	0.0	0	0.0
14:00	34	0	0.0	29	85.3	4	11.8	1	2.9	0	0.0
15:00	30	0	0.0	26	86.7	2	6.7	2	6.7	0	0.0
16:00	26	0	0.0	22	84.6	4	15.4	0	0.0	0	0.0
17:00	22	0	0.0	17	77.3	4	18.2	0	0.0	1	4.6
18:00	18	0	0.0	17	94.4	1	5.6	0	0.0	0	0.0
19:00	15	0	0.0	13	86.7	1	6.7	0	0.0	1	6.7
20:00	5	0	0.0	5	100.0	0	0.0	0	0.0	0	0.0
21:00	12	0	0.0	11	91.7	1	8.3	0	0.0	0	0.0
22:00	7	0	0.0	5	71.4	1	14.3	1	14.3	0	0.0
23:00	5	0	0.0	5	100.0	0	0.0	0	0.0	0	0.0
24H 7-19	267	1	0.4	228	85.4	31	11.6	5	1.9	2	0.8
16H 6-22	299	1	0.3	257	86.0	33	11.0	5	1.7	3	1.0
18H 6-24	311	1	0.3	267	85.9	34	10.9	6	1.9	3	1.0
24H 0-24	318	1	0.3	272	85.5	35	11.0	6	1.9	4	1.3
Mon 14-Mar-22											
00:00	1	0	0.0	1	100.0	0	0.0	0	0.0	0	0.0
01:00	0	0	-	0	-	0	-	0	-	0	-
02:00	0	0	-	0	-	0	-	0	-	0	-
03:00	0	0	-	0	-	0	-	0	-	0	-
04:00	0	0	-	0	-	0	-	0	-	0	-
05:00	1	0	0.0	1	100.0	0	0.0	0	0.0	0	0.0
06:00	5	0	0.0	5	100.0	0	0.0	0	0.0	0	0.0
07:00	19	0	0.0	19	100.0	0	0.0	0	0.0	0	0.0

TIME PERIOD	TOTAL VEHICLES	MOTOR-CYCLES	MOTOR-CYCLES%	CARS	CARS %	LGV	LGV %	HGV	HGV %	BUS	BUS %
08:00	39	0	0.0	32	82.1	6	15.4	0	0.0	1	2.6
09:00	27	0	0.0	22	81.5	4	14.8	0	0.0	1	3.7
10:00	30	2	6.7	21	70.0	6	20.0	0	0.0	1	3.3
11:00	28	0	0.0	22	78.6	5	17.9	0	0.0	1	3.6
12:00	31	1	3.2	24	77.4	4	12.9	0	0.0	2	6.5
13:00	30	0	0.0	24	80.0	3	10.0	2	6.7	1	3.3
14:00	35	2	5.7	24	68.6	7	20.0	1	2.9	1	2.9
15:00	61	1	1.6	47	77.1	7	11.5	6	9.8	0	0.0
16:00	44	3	6.8	36	81.8	4	9.1	0	0.0	1	2.3
17:00	63	0	0.0	52	82.5	10	15.9	0	0.0	1	1.6
18:00	37	1	2.7	31	83.8	4	10.8	1	2.7	0	0.0
19:00	22	0	0.0	19	86.4	2	9.1	1	4.6	0	0.0
20:00	17	0	0.0	13	76.5	3	17.7	0	0.0	1	5.9
21:00	8	0	0.0	6	75.0	0	0.0	1	12.5	1	12.5
22:00	7	0	0.0	7	100.0	0	0.0	0	0.0	0	0.0
23:00	3	0	0.0	2	66.7	1	33.3	0	0.0	0	0.0
12H 7-19	444	10	2.3	354	79.7	60	13.5	10	2.3	10	2.3
16H 6-22	496	10	2.0	397	80.0	65	13.1	12	2.4	12	2.4
18H 6-24	506	10	2.0	406	80.2	66	13.0	12	2.4	12	2.4
24H 0-24	508	10	2.0	408	80.3	66	13.0	12	2.4	12	2.4
Tue 15-Mar-22											
00:00	4	0	0.0	3	75.0	1	25.0	0	0.0	0	0.0
01:00	0	0	-	0	-	0	-	0	-	0	-
02:00	0	0	-	0	-	0	-	0	-	0	-
03:00	0	0	-	0	-	0	-	0	-	0	-
04:00	1	0	0.0	1	100.0	0	0.0	0	0.0	0	0.0
05:00	2	0	0.0	2	100.0	0	0.0	0	0.0	0	0.0
06:00	6	0	0.0	3	50.0	0	0.0	3	50.0	0	0.0
07:00	24	0	0.0	19	79.2	4	16.7	1	4.2	0	0.0
08:00	42	0	0.0	35	83.3	6	14.3	0	0.0	1	2.4
09:00	24	1	4.2	15	62.5	7	29.2	1	4.2	0	0.0
10:00	20	0	0.0	15	75.0	3	15.0	1	5.0	1	5.0

11174
Fri 11-Mar-22 to Thu 17-Mar-22

WIX
Site No: 11174001
Channel: Eastbound

Location
Oakley Rd, Wix (att to T/Pole)

TIME PERIOD	TOTAL VEHICLES	MOTOR-CYCLES	MOTOR-CYCLES%	CARS	CARS %	LGV	LGV %	HGV	HGV %	BUS	BUS %
11:00	28	1	3.6	16	57.1	7	25.0	2	7.1	2	7.1
12:00	31	2	6.5	23	74.2	4	12.9	1	3.2	1	3.2
13:00	25	3	12.0	18	72.0	3	12.0	0	0.0	1	4.0
14:00	30	2	6.7	23	76.7	3	10.0	1	3.3	1	3.3
15:00	62	0	0.0	47	75.8	9	14.5	4	6.5	2	3.2
16:00	58	0	0.0	51	87.9	6	10.3	1	1.7	0	0.0
17:00	60	1	1.7	52	86.7	6	10.0	0	0.0	1	1.7
18:00	38	0	0.0	31	81.6	5	13.2	1	2.6	1	2.6
19:00	24	0	0.0	24	100.0	0	0.0	0	0.0	0	0.0
20:00	15	0	0.0	13	86.7	1	6.7	0	0.0	1	6.7
21:00	12	0	0.0	7	58.3	3	25.0	2	16.7	0	0.0
22:00	10	0	0.0	10	100.0	0	0.0	0	0.0	0	0.0
23:00	3	0	0.0	2	66.7	1	33.3	0	0.0	0	0.0
12H:7-19	442	10	2.3	345	78.1	63	14.3	13	2.9	11	2.5
16H:6-22	499	10	2.0	392	78.6	67	13.4	18	3.6	12	2.4
18H:6-24	512	10	2.0	404	78.9	68	13.3	18	3.5	12	2.3
24H:0-24	519	10	1.9	410	79.0	69	13.3	18	3.5	12	2.3
Wed 16-Mar-22											
00:00	0	0	-	0	-	0	-	0	-	0	-
01:00	0	0	-	0	-	0	-	0	-	0	-
02:00	0	0	-	0	-	0	-	0	-	0	-
03:00	2	0	0.0	2	100.0	0	0.0	0	0.0	0	0.0
04:00	0	0	-	0	-	0	-	0	-	0	-
05:00	2	0	0.0	2	100.0	0	0.0	0	0.0	0	0.0
06:00	8	0	0.0	5	62.5	0	0.0	2	25.0	1	12.5
07:00	25	0	0.0	21	84.0	3	12.0	1	4.0	0	0.0
08:00	37	0	0.0	32	86.5	4	10.8	1	2.7	0	0.0
09:00	29	1	3.5	15	51.7	5	17.2	7	24.1	1	3.5
10:00	29	0	0.0	24	82.8	2	6.9	2	6.9	1	3.5
11:00	38	2	5.3	25	65.8	6	15.8	4	10.5	1	2.6
12:00	22	1	4.6	16	72.7	3	13.6	1	4.6	1	4.6
13:00	28	0	0.0	22	78.6	3	10.7	2	7.1	1	3.6

11174
Fri 11-Mar-22 to Thu 17-Mar-22

WIX

Site No: 11174001
Channel: Eastbound

Location

Oakley Rd, Wix (att to T/Pole)

TIME PERIOD	TOTAL VEHICLES	MOTOR-CYCLES	MOTOR-CYCLES%	CARS	CARS %	LGV	LGV %	HGV	HGV %	BUS	BUS %
14:00	24	0	0.0	21	87.5	1	4.2	1	4.2	1	4.2
15:00	58	0	0.0	41	70.7	9	15.5	7	12.1	1	1.7
16:00	57	1	1.8	50	87.7	5	8.8	1	1.8	0	0.0
17:00	56	0	0.0	47	83.9	8	14.3	0	0.0	1	1.8
18:00	37	0	0.0	33	89.2	3	8.1	1	2.7	0	0.0
19:00	33	0	0.0	30	90.9	3	9.1	0	0.0	0	0.0
20:00	11	0	0.0	7	63.6	3	27.3	0	0.0	1	9.1
21:00	13	0	0.0	11	84.6	0	0.0	2	15.4	0	0.0
22:00	5	0	0.0	4	80.0	1	20.0	0	0.0	0	0.0
23:00	2	0	0.0	1	50.0	1	50.0	0	0.0	0	0.0
12H,7-19	440	5	1.1	347	78.9	52	11.8	28	6.4	8	1.8
16H,6-22	505	5	1.0	400	79.2	58	11.5	32	6.3	10	2.0
18H,6-24	512	5	1.0	405	79.1	60	11.7	32	6.3	10	2.0
24H,0-24	516	5	1.0	409	79.3	60	11.6	32	6.2	10	1.9
Thu 17-Mar-22											
00:00	4	0	0.0	3	75.0	1	25.0	0	0.0	0	0.0
01:00	0	0	-	0	-	0	-	0	-	0	-
02:00	3	0	0.0	1	33.3	2	66.7	0	0.0	0	0.0
03:00	2	0	0.0	1	50.0	1	50.0	0	0.0	0	0.0
04:00	0	0	-	0	-	0	-	0	-	0	-
05:00	3	0	0.0	2	66.7	0	0.0	1	33.3	0	0.0
06:00	3	0	0.0	2	66.7	0	0.0	1	33.3	0	0.0
07:00	19	0	0.0	14	73.7	1	5.3	4	21.1	0	0.0
08:00	40	0	0.0	33	82.5	4	10.0	2	5.0	1	2.5
09:00	32	1	3.1	25	78.1	3	9.4	2	6.3	1	3.1
10:00	29	0	0.0	24	82.8	4	13.8	1	3.5	0	0.0
11:00	37	1	2.7	24	64.9	11	29.7	0	0.0	1	2.7
12:00	34	0	0.0	26	76.5	6	17.7	2	5.9	0	0.0
13:00	38	1	2.6	32	84.2	3	7.9	2	5.3	0	0.0
14:00	33	3	9.1	24	72.7	3	9.1	2	6.1	1	3.0
15:00	61	2	3.3	42	68.9	9	14.8	6	9.8	2	3.3
16:00	60	1	1.7	47	78.3	11	18.3	1	1.7	0	0.0

TIME PERIOD	TOTAL VEHICLES	MOTOR-CYCLES	MOTOR-CYCLES%	CARS	CARS %	LGV	LGV %	HGV	HGV %	BUS	BUS %
17:00	46	0	0.0	37	80.4	8	17.4	0	0.0	1	2.2
18:00	44	1	2.3	40	90.9	2	4.6	0	0.0	1	2.3
19:00	26	1	3.9	24	92.3	1	3.9	0	0.0	0	0.0
20:00	15	0	0.0	13	86.7	0	0.0	2	13.3	0	0.0
21:00	8	0	0.0	6	75.0	1	12.5	0	0.0	1	12.5
22:00	7	0	0.0	7	100.0	0	0.0	0	0.0	0	0.0
23:00	2	0	0.0	1	50.0	1	50.0	0	0.0	0	0.0
12H 7-19	473	10	2.1	368	77.8	65	13.7	22	4.7	8	1.7
16H 6-22	525	11	2.1	413	78.7	67	12.8	25	4.8	9	1.7
18H 6-24	534	11	2.1	421	78.8	68	12.7	25	4.7	9	1.7
24H 0-24	546	11	2.0	428	78.4	72	13.2	26	4.8	9	1.7
Daily Totals	552	8	1.5	443	80.3	72	13.0	22	4.0	7	1.3
Fri 11-Mar-22	389	8	2.1	327	84.1	41	10.5	7	1.8	6	1.5
Sat 12-Mar-22	318	1	0.3	272	85.5	35	11.0	6	1.9	4	1.3
Sun 13-Mar-22	508	10	2.0	408	80.3	66	13.0	12	2.4	12	2.4
Mon 14-Mar-22	519	10	1.9	410	79.0	69	13.3	18	3.5	12	2.3
Tue 15-Mar-22	516	5	1.0	409	79.3	60	11.6	32	6.2	10	1.9
Wed 16-Mar-22	546	11	2.0	428	78.4	72	13.2	26	4.8	9	1.7
Thu 17-Mar-22	546	11	2.0	428	78.4	72	13.2	26	4.8	9	1.7
Total Vehicles	3348	53	1.5	2697	81.0	415	12.2	123	3.5	60	1.8

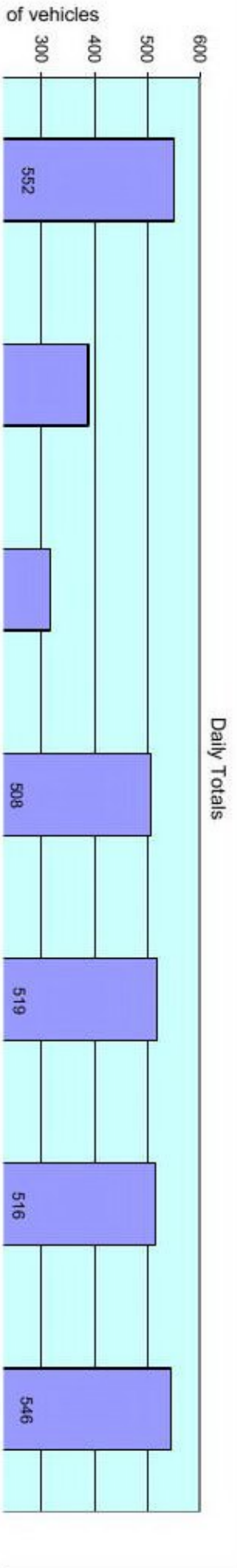

11174 WIX Site No: 11174001 Location Oakley Rd, Wix (att to T/Pole)
 Fri 11-Mar-22 to Thu 17-Mar-22 Channel: Eastbound

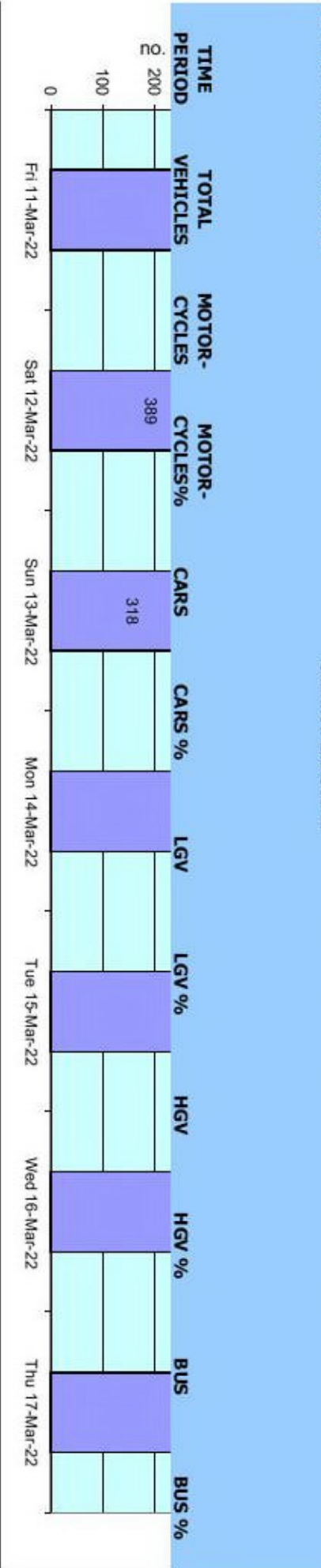

11174
Fri 11-Mar-22 to Thu 17-Mar-22

WIX

Site No: 11174001
Channel: Eastbound

Location Oakley Rd, Wix (att to T/Pole)

Time Period	Total Vehicles	85%ile Speed	Mean Speed	Stand Dev.	<11Mph	11-<21	21-<31	31-<41	41-<46	46-<51	51-<56	56-<61	61-<66	66-<71	71-<76	=>76
Fri 11-Mar-22																
00:00	0	-	-	-	0	0	0	0	0	0	0	0	0	0	0	0
01:00	1	-	36	-	0	0	0	1	0	0	0	0	0	0	0	0
02:00	1	-	43.5	-	0	0	0	0	1	0	0	0	0	0	0	0
03:00	0	-	-	-	0	0	0	0	0	0	0	0	0	0	0	0
04:00	0	-	-	-	0	0	0	0	0	0	0	0	0	0	0	0
05:00	1	-	48.5	-	0	0	0	0	0	1	0	0	0	0	0	0
06:00	4	-	47.3	4.9	0	0	0	0	2	1	1	0	0	0	0	0
07:00	20	53.5	46.4	8.1	0	0	0	5	4	6	3	1	1	0	0	0
08:00	47	51.6	45.2	8.3	0	1	0	11	9	18	4	4	0	0	0	0
09:00	29	56.2	46.4	7.8	0	0	0	6	9	7	2	5	0	0	0	0
10:00	37	50.9	46.1	8.4	0	0	0	9	8	14	3	1	1	0	1	0
11:00	30	51	42.2	10.1	0	1	2	9	8	5	2	3	0	0	0	0
12:00	46	51.5	43.1	9.2	0	2	1	10	17	8	6	2	2	0	0	0
13:00	30	51	44.9	9.5	0	0	3	4	7	11	3	1	0	1	0	0
14:00	45	55.8	45.1	9	0	0	1	14	11	7	5	6	1	0	0	0
15:00	55	52.8	44.2	7.5	0	0	0	19	15	9	9	3	0	0	0	0
16:00	65	55.8	48.2	7.4	0	0	0	7	19	21	8	7	2	1	0	0
17:00	54	55.3	45.4	10.3	0	1	4	6	18	13	4	6	0	2	0	0
18:00	36	49.6	43.2	7.4	0	0	1	11	11	10	2	1	1	0	0	0
19:00	13	52.4	46.4	7.4	0	0	0	3	2	5	2	1	0	0	0	0
20:00	13	49.2	42.2	10.4	0	0	2	3	3	4	0	0	1	0	0	0
21:00	9	-	41.3	8.7	0	0	1	3	2	2	1	0	0	0	0	0
22:00	8	-	50.1	8.6	0	0	0	1	1	3	1	1	1	0	0	0
23:00	8	-	46.6	8.5	0	0	0	2	2	1	2	1	0	0	0	0
12H,7-19	494	53.6	45.1	8.7	0	5	12	111	136	129	51	39	6	4	1	0
16H,6-22	533	53.4	45	8.7	0	5	15	120	145	141	55	40	7	4	1	0
18H,6-24	549	53.6	45.1	8.7	0	5	15	123	148	145	58	42	8	4	1	0
24H,0-24	552	53.6	45.1	8.7	0	5	15	124	149	146	58	42	8	4	1	0
Sat 12-Mar-22																
00:00	5	-	46	8.3	0	0	0	1	2	1	0	1	0	0	0	0
01:00	0	-	-	-	0	0	0	0	0	0	0	0	0	0	0	0
02:00	0	-	-	-	0	0	0	0	0	0	0	0	0	0	0	0

11174
Fri 11-Mar-22 to Thu 17-Mar-22

WIX

Site No: 11174001
Channel: Eastbound

Location Oakley Rd, Wix (att to T/Pole)

Time Period	Total Vehicles	85%ile Speed	Mean Speed	Stand Dev.	<11Mph	11-<21	21-<31	31-<41	41-<46	46-<51	51-<56	56-<61	61-<66	66-<71	71-<76	=>76
03:00	0	-	-	-	0	0	0	0	0	0	0	0	0	0	0	0
04:00	2	-	51	10.6	0	0	0	0	1	0	0	1	0	0	0	0
05:00	1	-	43.5	-	0	0	0	0	1	0	0	0	0	0	0	0
06:00	4	-	47.3	4.9	0	0	0	0	2	1	1	0	0	0	0	0
07:00	12	57.8	47.3	9.2	0	0	0	2	6	0	1	2	1	0	0	0
08:00	10	51	47.5	9.4	0	0	0	2	2	4	1	0	0	1	0	0
09:00	23	50.2	44.7	6.4	0	0	0	5	9	6	2	1	0	0	0	0
10:00	20	51.8	44.3	7.3	0	0	0	6	7	3	3	1	0	0	0	0
11:00	33	55.4	46.1	9.6	0	1	1	4	8	12	2	4	1	0	0	0
12:00	34	54.4	44.9	10.3	0	1	2	6	8	8	5	3	3	1	0	0
13:00	45	50.5	43.6	9	0	1	2	10	14	12	4	0	2	0	0	0
14:00	32	54.7	46.2	8.5	0	0	0	10	4	9	5	3	3	1	0	0
15:00	21	59.9	49.3	9.6	0	0	0	3	6	5	1	3	3	2	1	0
16:00	31	52.3	45.6	7.7	0	1	0	3	11	9	7	0	0	0	0	0
17:00	30	56	48.8	8.3	0	0	0	3	11	5	6	2	2	1	0	0
18:00	30	52.3	45.6	7.1	0	0	0	7	8	9	4	2	2	0	0	0
19:00	18	54.5	45.6	9.2	0	0	1	4	4	3	4	2	0	0	0	0
20:00	13	52.9	44.5	8	0	0	0	5	2	2	4	0	0	0	0	0
21:00	8	-	39.4	5.6	0	0	0	5	2	1	0	0	0	0	0	0
22:00	8	-	47.3	7.5	0	0	0	2	0	3	3	0	0	0	0	0
23:00	9	-	51.8	5.7	0	0	0	0	2	1	4	2	0	0	0	0
12H,7-19	321	54.2	45.9	8.7	0	4	5	61	94	82	41	21	10	3	0	0
16H,6-22	364	54.1	45.7	8.6	0	4	6	75	104	89	50	23	10	3	0	0
18H,6-24	381	54.3	45.8	8.6	0	4	6	77	106	93	57	25	10	3	0	0
24H,0-24	389	54.3	45.9	8.6	0	4	6	78	110	94	57	27	10	3	0	0
Sun 13-Mar-22																
00:00	3	-	42.7	6.3	0	0	0	1	1	1	0	0	0	0	0	0
01:00	3	-	46.8	3.1	0	0	0	0	1	2	0	0	0	0	0	0
02:00	1	-	48.5	-	0	0	0	0	0	1	0	0	0	0	0	0
03:00	0	-	-	-	0	0	0	0	0	0	0	0	0	0	0	0
04:00	0	-	-	-	0	0	0	0	0	0	0	0	0	0	0	0
05:00	0	-	-	-	0	0	0	0	0	0	0	0	0	0	0	0
06:00	0	-	-	-	0	0	0	0	0	0	0	0	0	0	0	0

11174
Fri 11-Mar-22 to Thu 17-Mar-22

WIX

Site No: 11174001
Channel: Eastbound

Location Oakley Rd, Wix (att to T/Pole)

Time Period	Total Vehicles	85%ile Speed	Mean Speed	Stand Dev.	<11Mph	11-<21	21-<31	31-<41	41-<46	46-<51	51-<56	56-<61	61-<66	66-<71	71-<76	=>76
07:00	8	-	43.5	5.5	0	0	0	2	3	3	0	0	0	0	0	0
08:00	11	50.6	44.4	7.5	0	0	0	4	1	4	2	0	0	0	0	0
09:00	13	49.9	41.6	9.7	0	1	0	3	6	1	2	0	0	0	0	0
10:00	16	53.8	45.7	7.9	0	0	0	4	5	3	2	2	0	0	0	0
11:00	29	54.5	47.1	6.9	0	0	0	4	10	6	6	3	0	0	0	0
12:00	31	53.9	47.8	6.1	0	0	0	3	9	8	10	1	0	0	0	0
13:00	29	53.7	46.8	9.2	0	0	0	6	9	7	4	2	0	0	0	1
14:00	34	48.7	42.8	5.7	0	0	0	11	12	10	1	0	0	0	0	0
15:00	30	53	45.3	8.4	0	0	1	7	7	8	5	1	1	0	0	0
16:00	26	51.8	42.4	10.6	0	1	3	5	5	7	4	1	1	0	0	0
17:00	22	55.2	48.7	7.6	0	0	0	2	7	5	5	1	2	0	0	0
18:00	18	54	46.7	9.7	0	0	0	5	4	4	3	0	1	1	0	0
19:00	15	49.8	44.5	9.9	0	0	1	3	6	3	0	0	0	0	0	0
20:00	5	-	46.5	11.5	0	0	0	2	0	2	0	0	1	0	0	0
21:00	12	62.2	51.4	10.4	0	0	0	2	2	2	1	2	3	0	0	0
22:00	7	-	46	5.7	0	0	0	1	2	3	1	0	0	0	0	0
23:00	5	-	47	8.3	0	0	0	1	1	2	0	1	0	0	0	0
12H,7-19	267	53.3	45.5	8.2	0	2	4	56	78	66	44	11	4	1	0	1
16H,6-22	299	53.7	45.7	8.5	0	2	5	63	86	73	45	13	10	1	0	1
18H,6-24	311	53.7	45.7	8.4	0	2	5	65	89	78	46	14	10	1	0	1
24H,0-24	318	53.6	45.7	8.3	0	2	5	66	91	82	46	14	10	1	0	1
Mon 14-Mar-22																
00:00	1	-	43.5	-	0	0	0	0	1	0	0	0	0	0	0	0
01:00	0	-	-	-	0	0	0	0	0	0	0	0	0	0	0	0
02:00	0	-	-	-	0	0	0	0	0	0	0	0	0	0	0	0
03:00	0	-	-	-	0	0	0	0	0	0	0	0	0	0	0	0
04:00	0	-	-	-	0	0	0	0	0	0	0	0	0	0	0	0
05:00	1	-	36	-	0	0	0	1	0	0	0	0	0	0	0	0
06:00	5	-	47.5	4.4	0	0	0	2	2	2	1	0	0	0	0	0
07:00	19	53.8	48	7	0	0	0	2	5	7	3	1	1	0	0	0
08:00	39	50.7	43.6	8.1	0	0	3	8	12	10	5	1	0	0	0	0
09:00	27	49.2	43.3	6	0	0	0	8	10	7	2	0	0	0	0	0
10:00	30	52.7	42.1	10.9	0	2	0	11	8	3	3	2	1	0	0	0

11174
Fri 11-Mar-22 to Thu 17-Mar-22

WIX

Site No: 11174001
Channel: Eastbound

Location Oakley Rd, Wix (att to T/Pole)

Time Period	Total Vehicles	85%ile Speed	Mean Speed	Stand Dev.	<11Mph	11-<21	21-<31	31-<41	41-<46	46-<51	51-<56	56-<61	61-<66	66-<71	71-<76	=>76
11:00	28	51.8	45.7	8	0	0	1	4	10	8	2	2	1	0	0	0
12:00	31	53.8	42.4	11.8	0	2	3	7	5	5	7	2	0	0	0	0
13:00	30	53.5	43	10.1	0	1	2	7	10	2	6	2	0	0	0	0
14:00	35	54	46.5	8.6	0	0	1	7	7	10	7	2	0	1	0	0
15:00	61	52.8	44.8	8	0	1	1	12	20	13	12	2	0	0	0	0
16:00	44	55.5	48.9	6.6	0	0	0	3	13	11	11	5	1	0	0	0
17:00	63	54.4	46.1	7.5	0	0	1	11	20	17	6	8	0	0	0	0
18:00	37	49.9	42.7	8.6	0	1	2	9	8	14	3	0	0	0	0	0
19:00	22	54.7	46.7	10.7	0	0	1	5	4	6	3	1	1	0	1	0
20:00	17	55.9	49.5	7.1	0	0	0	1	5	4	4	2	1	0	0	0
21:00	8	-	41	6.1	0	0	0	4	2	2	0	0	0	0	0	0
22:00	7	-	43.5	5.9	0	0	0	2	2	3	0	0	0	0	0	0
23:00	3	-	46.8	5.9	0	0	0	0	2	0	1	0	0	0	0	0
12H,7-19	444	53.4	44.9	8.6	0	7	14	89	128	107	67	27	4	1	0	0
16H,6-22	496	53.5	45.1	8.7	0	7	15	99	141	121	75	30	6	1	1	0
18H,6-24	506	53.5	45.1	8.6	0	7	15	101	145	124	76	30	6	1	1	0
24H,0-24	508	53.5	45	8.6	0	7	15	102	146	124	76	30	6	1	1	0
Tue 15-Mar-22																
00:00	4	-	42.3	8.5	0	0	0	2	1	0	1	0	0	0	0	0
01:00	0	-	-	-	0	0	0	0	0	0	0	0	0	0	0	0
02:00	0	-	-	-	0	0	0	0	0	0	0	0	0	0	0	0
03:00	0	-	-	-	0	0	0	0	0	0	0	0	0	0	0	0
04:00	1	-	58.5	-	0	0	0	0	0	0	0	1	0	0	0	0
05:00	2	-	39.8	5.3	0	0	0	1	1	0	0	0	0	0	0	0
06:00	6	-	39.3	6	0	0	0	4	1	1	0	0	0	0	0	0
07:00	24	55.9	44.8	9.2	0	0	1	7	6	4	2	4	0	0	0	0
08:00	42	53	45.8	7.8	0	0	1	9	9	13	8	1	1	0	0	0
09:00	24	50.3	44	9.5	0	1	0	6	6	8	1	1	1	0	0	0
10:00	20	57.3	46.3	10.4	0	0	1	5	4	4	2	2	2	0	0	0
11:00	28	50.6	43.1	10.4	0	1	1	9	5	8	2	1	0	0	0	0
12:00	31	50.4	44	6.9	0	0	1	7	10	9	4	0	0	0	0	0
13:00	25	52.3	45.6	11.8	0	2	0	3	4	11	3	1	0	0	0	0
14:00	30	56	46.5	9.3	0	0	1	7	7	4	4	4	1	0	0	0

11174
Fri 11-Mar-22 to Thu 17-Mar-22

WIX

Site No: 11174001
Channel: Eastbound

Location Oakley Rd, Wix (att to T/Pole)

Time Period	Total Vehicles	85%ile Speed	Mean Speed	Stand Dev.	<11Mph	11-<21	21-<31	31-<41	41-<46	46-<51	51-<56	56-<61	61-<66	66-<71	71-<76	=>76
15:00	62	53.8	47.3	6.8	0	0	0	8	18	20	11	3	2	0	0	0
16:00	58	56.4	48.5	7.3	0	0	1	4	16	18	9	9	1	0	0	0
17:00	60	56.3	47.5	8.2	0	0	1	11	11	17	10	9	1	0	0	0
18:00	38	55	47.3	10.3	0	0	3	4	9	11	5	1	4	1	0	0
19:00	24	54.3	45.7	10	0	1	0	6	2	7	6	2	0	0	0	0
20:00	15	54.8	47.2	12.8	0	0	2	2	1	5	3	0	1	0	1	0
21:00	12	55.3	47.7	8	0	0	0	2	4	1	3	2	0	0	0	0
22:00	10	53.5	46	7.3	0	0	0	2	4	0	4	0	0	0	0	0
23:00	3	-	48.5	1.7	0	0	0	0	0	3	0	0	0	0	0	0
12H,7-19	442	54.8	46.3	8.8	0	4	11	80	105	127	63	36	13	2	1	0
16H,6-22	499	54.8	46.3	8.9	0	5	13	94	113	141	75	40	14	2	2	0
18H,6-24	512	54.8	46.3	8.9	0	5	13	96	117	144	79	40	14	2	2	0
24H,0-24	519	54.8	46.2	8.9	0	5	13	99	119	144	80	41	14	2	2	0
Wed 16-Mar-22																
00:00	0	-	-	-	0	0	0	0	0	0	0	0	0	0	0	0
01:00	0	-	-	-	0	0	0	0	0	0	0	0	0	0	0	0
02:00	0	-	-	-	0	0	0	0	0	0	0	0	0	0	0	0
03:00	2	-	56	10.6	0	0	0	0	0	1	0	0	1	0	0	0
04:00	0	-	-	-	0	0	0	0	0	0	0	0	0	0	0	0
05:00	2	-	44.8	12.4	0	0	0	1	0	0	1	0	0	0	0	0
06:00	8	-	45.1	8.9	0	0	0	3	1	2	1	1	0	0	0	0
07:00	25	52.9	45.5	7.9	0	0	0	6	9	5	2	2	1	0	0	0
08:00	37	50.6	44.9	7.5	0	0	1	8	10	13	2	3	0	0	0	0
09:00	29	50.2	41.3	10.2	0	1	1	14	4	5	1	2	1	0	0	0
10:00	29	47.4	40.5	7.7	0	0	2	13	8	4	1	1	1	0	0	0
11:00	38	50.8	43.2	9.2	0	1	0	14	9	8	4	1	0	0	0	0
12:00	22	50.1	44.5	7	0	0	1	4	5	10	2	0	0	0	0	0
13:00	28	53.2	46.4	8.1	0	0	0	6	8	8	3	2	0	1	0	0
14:00	24	49.3	44.4	6.4	0	0	0	5	11	6	0	2	0	0	0	0
15:00	58	49.9	41.2	9.3	0	1	5	21	14	10	4	2	1	0	0	0
16:00	57	53	45.6	9.1	0	1	1	10	18	16	5	4	1	0	1	0
17:00	56	51.8	45.2	6.5	0	0	0	11	23	12	7	3	0	0	0	0
18:00	37	50.9	44.6	7.9	0	0	2	6	14	9	3	3	0	0	0	0

11174
Fri 11-Mar-22 to Thu 17-Mar-22

WIX

Site No: 11174001
Channel: Eastbound

Location Oakley Rd, Wix (att to T/Pole)

Time Period	Total Vehicles	85%ile Speed	Mean Speed	Stand Dev.	<11Mph	11-<21	21-<31	31-<41	41-<46	46-<51	51-<56	56-<61	61-<66	66-<71	71-<76	=>76
19:00	33	53.1	47	6.2	0	0	0	4	10	11	6	2	0	0	0	0
20:00	11	50.3	43.3	8.9	0	0	1	2	5	1	1	1	0	0	0	0
21:00	13	52.4	45.8	11.7	0	0	1	3	2	4	2	0	0	0	1	0
22:00	5	-	47	7.5	0	0	0	1	1	1	2	0	0	0	0	0
23:00	2	-	36	3.5	0	0	0	2	0	0	0	0	0	0	0	0
12H,7-19	440	50.9	43.9	8.4	0	4	13	118	133	106	34	25	4	2	1	0
16H,6-22	505	51.5	44.2	8.4	0	4	15	130	151	124	44	29	4	2	2	0
18H,6-24	512	51.6	44.2	8.4	0	4	15	133	152	125	46	29	4	2	2	0
24H,0-24	516	51.8	44.2	8.4	0	4	15	134	152	126	47	29	5	2	2	0
Thu 17-Mar-22																
00:00	4	-	45.4	7.5	0	0	0	1	1	1	1	0	0	0	0	0
01:00	0	-	-	-	0	0	0	0	0	0	0	0	0	0	0	0
02:00	3	-	46	11.5	0	0	0	1	1	0	0	1	0	0	0	0
03:00	2	-	43.5	1.8	0	0	0	0	2	0	0	0	0	0	0	0
04:00	0	-	-	-	0	0	0	0	0	0	0	0	0	0	0	0
05:00	3	-	47.7	10.2	0	0	0	1	0	0	2	0	0	0	0	0
06:00	3	-	50.2	3.1	0	0	0	0	0	2	1	0	0	0	0	0
07:00	19	57.6	46.7	10.6	0	0	1	5	2	5	2	2	2	0	0	0
08:00	40	52.6	45.9	6.6	0	0	0	8	11	12	8	1	0	0	0	0
09:00	32	52.7	46.4	6	0	0	0	3	15	7	5	2	0	0	0	0
10:00	29	52.5	44.6	8.3	0	0	3	2	11	6	7	0	0	0	0	0
11:00	37	53.4	46.5	8.6	0	0	0	9	8	12	4	1	2	1	0	0
12:00	34	52.8	44.1	8.6	0	0	1	11	9	6	4	2	1	0	0	0
13:00	38	50	45.1	6.2	0	0	1	5	13	16	2	1	0	0	0	0
14:00	33	51.9	42.3	11.6	0	2	2	10	5	8	3	1	2	0	0	0
15:00	61	53	44.8	8.5	0	0	3	16	10	18	11	2	1	0	0	0
16:00	60	55.5	49	9.7	0	1	1	5	12	18	14	5	1	1	2	0
17:00	46	55.6	49.1	7.6	0	0	0	5	11	11	12	5	1	1	0	0
18:00	44	52.6	45.5	6.6	0	0	0	9	15	10	9	1	0	0	0	0
19:00	26	51.6	45.6	5.9	0	0	0	4	10	7	5	0	0	0	0	0
20:00	15	50.5	46.3	7.4	0	0	0	3	3	7	1	0	1	0	0	0
21:00	8	-	49.1	12.4	0	0	0	2	1	3	0	1	0	0	1	0
22:00	7	-	47.4	6.2	0	0	0	1	1	3	2	0	0	0	0	0

11174
Fri 11-Mar-22 to Thu 17-Mar-22

WIX

Site No: 11174001
Channel: Eastbound

Location Oakley Rd, Wix (att to T/Pole)

Time Period	Total Vehicles	85%ile Speed	Mean Speed	Stand Dev.	<11Mph	11-<21	21-<31	31-<41	41-<46	46-<51	51-<56	56-<61	61-<66	66-<71	71-<76	=>76
23:00	2	-	44.8	12.4	0	0	0	1	0	0	1	0	0	0	0	0
12H,7-19	473	53.9	46	8.5	0	3	12	88	122	129	81	23	10	3	2	0
16H,6-22	525	53.8	46.1	8.4	0	3	12	97	136	148	88	24	11	3	3	0
18H,6-24	534	53.8	46.1	8.3	0	3	12	99	137	151	91	24	11	3	3	0
24H,0-24	546	53.9	46.1	8.3	0	3	12	102	141	152	94	25	11	3	3	0
Daily Totals																
Fri 11-Mar-22	552	53.6	45.1	8.7	0	5	15	124	149	146	58	42	8	4	1	0
Sat 12-Mar-22	389	54.3	45.9	8.6	0	4	6	78	110	94	57	27	10	3	0	0
Sun 13-Mar-22	318	53.6	45.7	8.3	0	2	5	66	91	82	46	14	10	1	0	1
Mon 14-Mar-22	508	53.5	45	8.6	0	7	15	102	146	124	76	30	6	1	1	0
Tue 15-Mar-22	519	54.8	46.2	8.9	0	5	13	99	119	144	80	41	14	2	2	0
Wed 16-Mar-22	516	51.8	44.2	8.4	0	4	15	134	152	126	47	29	5	2	2	0
Thu 17-Mar-22	546	53.9	46.1	8.3	0	3	12	102	141	152	94	25	11	3	3	0
Total Vehicles	3348	53.6	45.5	8.5	0	30	81	705	908	868	458	208	64	16	9	1

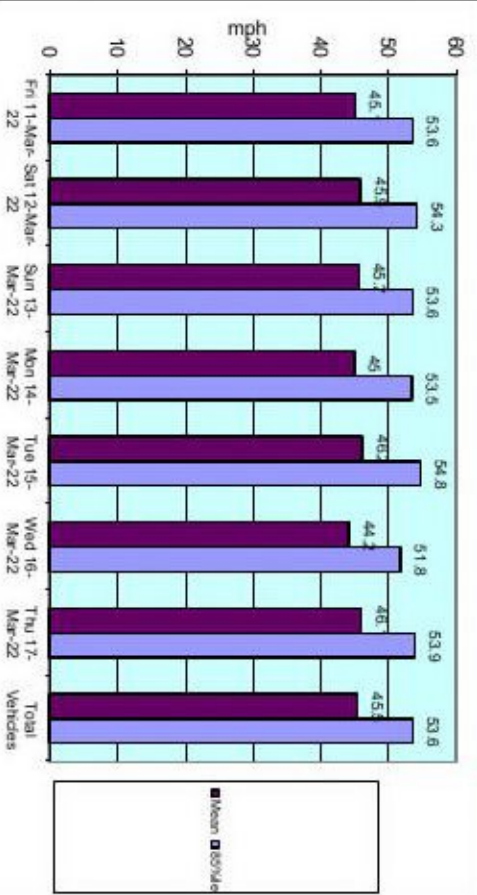
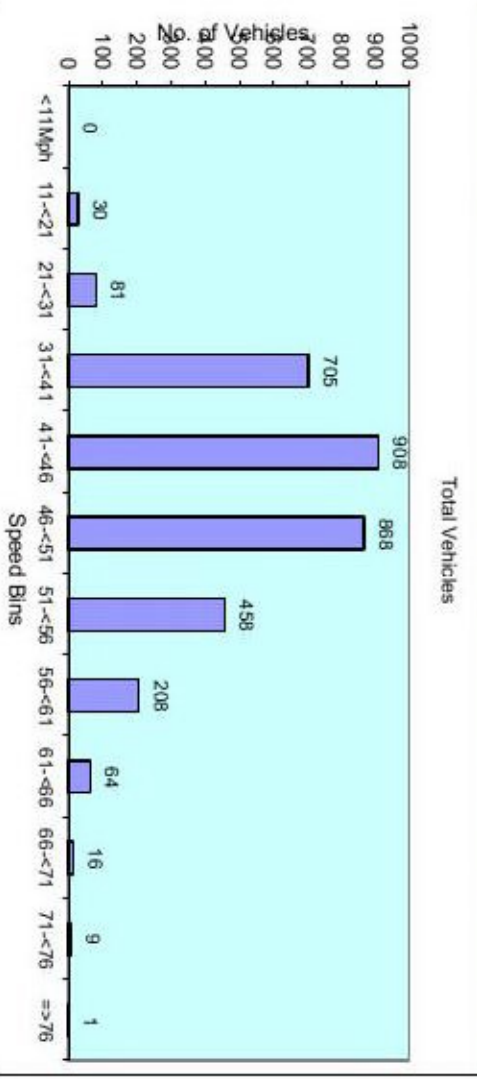

11174 WIX Site No: 11174001 Location Oakley Rd, Wix (att to T/Pole)
 Channel: Eastbound

Week Begin: 11-Mar-22

TIME PERIOD	11/03/2022	12/03/2022	13/03/2022	14/03/2022	15/03/2022	16/03/2022	17/03/2022	5-Day Av	7-Day Av
00:00	0	5	3	1	4	0	4	2	2
01:00	1	0	3	0	0	0	0	0	1
02:00	1	0	1	0	0	0	3	1	1
03:00	0	0	0	0	0	2	2	1	1
04:00	0	2	0	0	1	0	0	0	0
05:00	1	1	0	1	2	2	3	2	1
06:00	4	4	0	5	6	8	3	5	4
07:00	20	12	8	19	24	25	19	21	18
08:00	47	10	11	39	42	37	40	41	32
09:00	29	23	13	27	24	29	32	28	25
10:00	37	20	16	30	20	29	29	29	26
11:00	30	33	29	28	28	38	37	32	32
12:00	46	34	31	31	31	22	34	33	33
13:00	30	45	29	30	25	28	38	30	32
14:00	45	32	34	35	30	24	33	33	33
15:00	55	21	30	61	62	58	61	59	50
16:00	65	31	26	44	58	57	60	57	49
17:00	54	30	22	63	60	56	46	56	47
18:00	36	30	18	37	38	37	44	38	34
19:00	13	18	15	22	24	33	26	24	22
20:00	13	13	5	17	15	11	15	14	13
21:00	9	8	12	8	12	13	8	10	10
22:00	8	8	7	7	10	5	7	7	7
23:00	8	9	5	3	3	2	2	4	5
12H 7-19	494	321	267	444	442	440	473	459	412
16H 6-22	533	364	299	496	499	505	525	512	460
18H 6-24	549	381	311	506	512	512	534	523	472
24H 0-24	552	389	318	508	519	516	546	528	478
Am	08:00	11:00	11:00	08:00	08:00	11:00	08:00		
Peak	47	33	29	39	42	38	40		
Pm	16:00	13:00	14:00	17:00	15:00	15:00	15:00		
Peak	65	45	34	63	62	58	61		

11174

WIX

Site No: 11174001
Channel: Eastbound

Location

Oakley Rd, Wix (att to T/Pole)

TIME PERIOD	11/03/2022	12/03/2022	13/03/2022	14/03/2022	15/03/2022	16/03/2022	17/03/2022	5-Day Av	7-Day Av
	Fri	Sat	Sun	Mon	Tue	Wed	Thu		
	552	389	318	508	519	516	546	528	478
	Daily Totals								

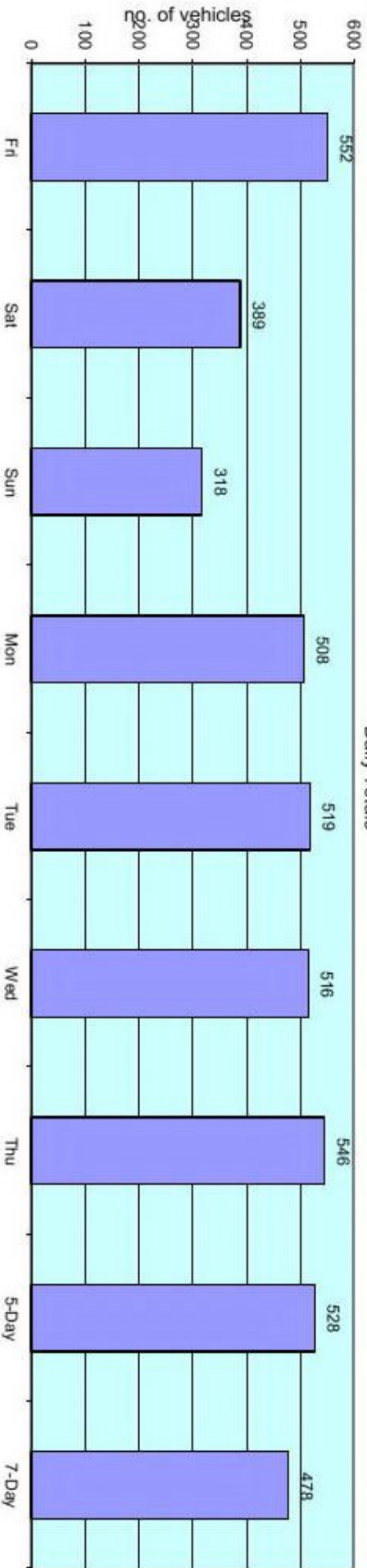

PERIOD	TOTAL VEHICLES	MOTOR-CYCLES	CARS OR CAR-BASED LGV	LIGHT GOODS VEHICLES	BUSES	TWO AXLE, SIX TYRE, RIGID/BUSES	THREE AXLE RIGID	FOUR OR MORE AXLE RIGID	FOUR OR LESS AXLE ARTIC	FIVE AXLE ARTIC	SIX OR MORE AXLE ARTIC	FIVE OR LESS AXLE MULTI-TRAILER ARTIC	SIX AXLE MULTI-TRAILER ARTIC	SEVEN OR MORE AXLE ARTIC
Fri 11-Mar-22														
00:00	1	0	1	0	0	0	0	0	0	0	0	0	0	0
01:00	2	0	2	0	0	0	0	0	0	0	0	0	0	0
02:00	0	0	0	0	0	0	0	0	0	0	0	0	0	0
03:00	2	0	1	1	0	0	0	0	0	0	0	0	0	0
04:00	4	0	3	1	0	0	0	0	0	0	0	0	0	0
05:00	15	2	8	5	0	0	0	0	0	0	0	0	0	0
06:00	31	0	26	4	1	0	0	0	0	0	0	0	0	0
07:00	60	1	43	13	1	2	0	0	0	0	0	0	0	0
08:00	57	2	47	6	1	1	0	0	0	0	0	0	0	0
09:00	46	1	37	7	1	0	0	0	0	0	0	0	0	0
10:00	34	0	23	8	1	1	0	0	0	0	1	0	0	0
11:00	27	0	21	5	1	0	0	0	0	0	0	0	0	0
12:00	42	0	34	6	1	0	0	0	0	0	0	1	0	0
13:00	33	0	27	4	1	0	1	0	0	0	0	0	0	0
14:00	45	0	32	11	1	0	0	0	0	0	1	0	0	0
15:00	33	0	25	6	1	0	0	0	0	0	1	0	0	0
16:00	36	2	28	5	1	0	0	0	0	0	0	0	0	0
17:00	29	1	25	2	1	0	0	0	0	0	0	0	0	0
18:00	21	0	16	2	1	0	0	0	0	1	0	1	0	0
19:00	11	0	9	1	1	0	0	0	0	0	0	0	0	0
20:00	7	1	4	2	0	0	0	0	0	0	0	0	0	0
21:00	4	0	3	1	0	0	0	0	0	0	0	0	0	0
22:00	2	0	2	0	0	0	0	0	0	0	0	0	0	0
23:00	4	0	4	0	0	0	0	0	0	0	0	0	0	0
12H,7-19	463	7	358	75	12	4	1	0	0	1	3	2	0	0
16H,6-22	516	8	400	83	14	4	1	0	0	1	3	2	0	0
18H,6-24	522	8	406	83	14	4	1	0	0	1	3	2	0	0
24H,0-24	546	10	421	90	14	4	1	0	0	1	3	2	0	0
Sat 12-Mar-22														
00:00	0	0	0	0	0	0	0	0	0	0	0	0	0	0
01:00	1	0	1	0	0	0	0	0	0	0	0	0	0	0

TIME PERIOD	TOTAL VEHICLES	MOTOR-CYCLES	CARS OR CAR-BASED LGV	LIGHT GOODS VEHICLES	BUSES	TWO AXLE, SIX TYRE, RIGID/BUSES	THREE AXLE RIGID	FOUR OR MORE AXLE RIGID	FOUR OR LESS AXLE ARTIC	FIVE AXLE ARTIC	SIX OR MORE AXLE ARTIC	FIVE OR LESS AXLE MULTI-TRAILER ARTIC	SIX AXLE MULTI-TRAILER ARTIC	SEVEN OR MORE AXLE ARTIC
02:00	0	0	0	0	0	0	0	0	0	0	0	0	0	0
03:00	2	0	2	0	0	0	0	0	0	0	0	0	0	0
04:00	3	0	1	2	0	0	0	0	0	0	0	0	0	0
05:00	9	2	3	4	0	0	0	0	0	0	0	0	0	0
06:00	10	0	8	1	1	0	0	0	0	0	0	0	0	0
07:00	10	0	9	0	1	0	0	0	0	0	0	0	0	0
08:00	33	1	29	3	0	0	0	0	0	0	0	0	0	0
09:00	41	0	36	4	1	0	0	0	0	0	0	0	0	0
10:00	31	1	23	5	1	0	1	0	0	0	0	0	0	0
11:00	40	3	30	6	0	1	0	0	0	0	0	0	0	0
12:00	43	0	39	3	1	0	0	0	0	0	0	0	0	0
13:00	34	0	30	3	1	0	0	0	0	0	0	0	0	0
14:00	34	1	25	7	1	0	0	0	0	0	0	0	0	0
15:00	30	1	23	5	1	0	0	0	0	0	0	0	0	0
16:00	23	2	19	1	1	0	0	0	0	0	0	0	0	0
17:00	25	2	20	3	0	0	0	0	0	0	0	0	0	0
18:00	21	0	17	3	1	0	0	0	0	0	0	0	0	0
19:00	13	0	12	0	1	0	0	0	0	0	0	0	0	0
20:00	4	0	4	0	0	0	0	0	0	0	0	0	0	0
21:00	5	0	4	1	0	0	0	0	0	0	0	0	0	0
22:00	8	0	6	1	1	0	0	0	0	0	0	0	0	0
23:00	3	0	3	0	0	0	0	0	0	0	0	0	0	0
12H,7-19	365	11	300	43	9	1	1	0	0	0	0	0	0	0
16H,6-22	397	11	328	45	11	1	1	0	0	0	0	0	0	0
18H,6-24	408	11	337	46	12	1	1	0	0	0	0	0	0	0
24H,0-24	423	13	344	52	12	1	1	0	0	0	0	0	0	0
Sun 13-Mar-22														
00:00	1	0	1	0	0	0	0	0	0	0	0	0	0	0
01:00	1	0	0	1	0	0	0	0	0	0	0	0	0	0
02:00	0	0	0	0	0	0	0	0	0	0	0	0	0	0
03:00	1	0	1	0	0	0	0	0	0	0	0	0	0	0
04:00	0	0	0	0	0	0	0	0	0	0	0	0	0	0

TIME PERIOD	TOTAL VEHICLES	MOTOR-CYCLES	CARS OR CAR-BASED LGV	LIGHT GOODS VEHICLES	BUSES	TWO AXLE, SIX TYRE, RIGID/BUSES	THREE AXLE RIGID	FOUR OR MORE AXLE RIGID	FOUR OR LESS AXLE ARTIC	FIVE AXLE ARTIC	SIX OR MORE AXLE ARTIC	FIVE OR LESS AXLE MULTI-TRAILER ARTIC	SIX AXLE MULTI-TRAILER ARTIC	SEVEN OR MORE AXLE ARTIC
05:00	6	0	4	2	0	0	0	0	0	0	0	0	0	0
06:00	4	0	4	0	0	0	0	0	0	0	0	0	0	0
07:00	13	1	11	1	0	0	0	0	0	0	0	0	0	0
08:00	21	1	15	4	1	0	0	0	0	0	0	0	0	0
09:00	29	0	23	5	0	0	1	0	0	0	0	0	0	0
10:00	45	1	37	6	1	0	0	0	0	0	0	0	0	0
11:00	32	1	27	4	0	0	0	0	0	0	0	0	0	0
12:00	31	0	29	1	1	0	0	0	0	0	0	0	0	0
13:00	25	1	20	4	0	0	0	0	0	0	0	0	0	0
14:00	25	0	21	3	1	0	0	0	0	0	0	0	0	0
15:00	17	1	14	1	0	1	0	0	0	0	0	0	0	0
16:00	20	0	18	0	1	0	0	0	0	0	0	1	0	0
17:00	17	0	17	0	0	0	0	0	0	0	0	0	0	0
18:00	16	0	14	1	1	0	0	0	0	0	0	0	0	0
19:00	7	0	7	0	0	0	0	0	0	0	0	0	0	0
20:00	7	0	7	0	0	0	0	0	0	0	0	0	0	0
21:00	2	0	2	0	0	0	0	0	0	0	0	0	0	0
22:00	0	0	0	0	0	0	0	0	0	0	0	0	0	0
23:00	2	0	2	0	0	0	0	0	0	0	0	0	0	0
12H,7-19	291	6	246	30	6	1	1	0	0	0	0	1	0	0
16H,6-22	311	6	266	30	6	1	1	0	0	0	0	1	0	0
18H,6-24	313	6	268	30	6	1	1	0	0	0	0	1	0	0
24H,0-24	322	6	274	33	6	1	1	0	0	0	0	1	0	0
Mon 14-Mar-22														
00:00	0	0	0	0	0	0	0	0	0	0	0	0	0	0
01:00	1	0	1	0	0	0	0	0	0	0	0	0	0	0
02:00	0	0	0	0	0	0	0	0	0	0	0	0	0	0
03:00	2	0	2	0	0	0	0	0	0	0	0	0	0	0
04:00	8	0	5	3	0	0	0	0	0	0	0	0	0	0
05:00	13	2	8	3	0	0	0	0	0	0	0	0	0	0
06:00	33	0	28	4	1	0	0	0	0	0	0	0	0	0
07:00	70	0	58	8	2	1	0	0	1	0	0	0	0	0

TIME PERIOD	TOTAL VEHICLES	MOTOR-CYCLES	CARS OR CAR-BASED LGV	LIGHT GOODS VEHICLES	BUSES	TWO AXLE, SIX TYRE, RIGID/BUSES	THREE AXLE RIGID	FOUR OR MORE AXLE RIGID	FOUR OR LESS AXLE ARTIC	FIVE AXLE ARTIC	SIX OR MORE AXLE ARTIC	FIVE OR LESS AXLE MULTI-TRAILER ARTIC	SIX AXLE MULTI-TRAILER ARTIC	SEVEN OR MORE AXLE ARTIC
08:00	54	1	42	8	1	1	0	0	0	0	1	0	0	0
09:00	36	0	25	9	1	0	1	0	0	0	0	0	0	0
10:00	32	0	26	5	1	0	0	0	0	0	0	0	0	0
11:00	22	1	17	3	1	0	0	0	0	0	0	0	0	0
12:00	29	4	17	7	1	0	0	0	0	0	0	0	0	0
13:00	27	2	22	2	1	0	0	0	0	0	0	0	0	0
14:00	35	0	26	6	1	1	0	0	0	0	1	0	0	0
15:00	27	1	22	3	1	0	0	0	0	0	0	0	0	0
16:00	33	0	27	4	1	0	0	0	0	0	0	1	0	0
17:00	25	0	19	5	1	0	0	0	0	0	0	0	0	0
18:00	27	2	21	3	1	0	0	0	0	0	0	0	0	0
19:00	14	1	11	1	1	0	0	0	0	0	0	0	0	0
20:00	5	0	3	2	0	0	0	0	0	0	0	0	0	0
21:00	5	1	4	0	0	0	0	0	0	0	0	0	0	0
22:00	1	0	1	0	0	0	0	0	0	0	0	0	0	0
23:00	1	0	1	0	0	0	0	0	0	0	0	0	0	0
12H,7-19	417	11	322	63	13	3	1	0	1	0	2	1	0	0
16H,6-22	474	13	368	70	15	3	1	0	1	0	2	1	0	0
18H,6-24	476	13	370	70	15	3	1	0	1	0	2	1	0	0
24H,0-24	500	15	386	76	15	3	1	0	1	0	2	1	0	0
Tue 15-Mar-22														
00:00	0	0	0	0	0	0	0	0	0	0	0	0	0	0
01:00	0	0	0	0	0	0	0	0	0	0	0	0	0	0
02:00	0	0	0	0	0	0	0	0	0	0	0	0	0	0
03:00	1	0	1	0	0	0	0	0	0	0	0	0	0	0
04:00	6	0	5	1	0	0	0	0	0	0	0	0	0	0
05:00	15	2	8	5	0	0	0	0	0	0	0	0	0	0
06:00	34	0	28	5	1	0	0	0	0	0	0	0	0	0
07:00	68	0	56	7	2	1	0	0	0	0	2	0	0	0
08:00	60	1	47	10	1	1	0	0	0	0	0	0	0	0
09:00	33	0	26	6	1	0	0	0	0	0	0	0	0	0
10:00	28	2	21	3	1	0	0	0	1	0	0	0	0	0

TIME PERIOD	TOTAL VEHICLES	MOTOR-CYCLES	CARS OR CAR-BASED LGV	LIGHT GOODS VEHICLES	BUSES	TWO AXLE, SIX TYRE, RIGID/BUSES	THREE AXLE RIGID	FOUR OR MORE AXLE RIGID	FOUR OR LESS AXLE ARTIC	FIVE AXLE ARTIC	SIX OR MORE AXLE ARTIC	FIVE OR LESS AXLE MULTI-TRAILER ARTIC	SIX AXLE MULTI-TRAILER ARTIC	SEVEN OR MORE AXLE ARTIC
11:00	30	2	20	5	1	1	1	0	0	0	0	0	0	0
12:00	29	0	21	5	2	0	0	0	0	0	1	0	0	0
13:00	40	2	28	6	0	1	0	0	1	0	0	2	0	0
14:00	36	1	26	7	1	1	0	0	0	0	0	0	0	0
15:00	41	1	34	5	1	0	0	0	0	0	0	0	0	0
16:00	38	0	35	2	1	0	0	0	0	0	0	0	0	0
17:00	37	1	22	10	1	0	0	0	2	0	0	1	0	0
18:00	23	1	19	2	1	0	0	0	0	0	0	0	0	0
19:00	8	0	5	2	1	0	0	0	0	0	0	0	0	0
20:00	9	0	7	2	0	0	0	0	0	0	0	0	0	0
21:00	1	0	1	0	0	0	0	0	0	0	0	0	0	0
22:00	0	0	0	0	0	0	0	0	0	0	0	0	0	0
23:00	0	0	0	0	0	0	0	0	0	0	0	0	0	0
12H,7-19	463	11	355	68	13	5	1	0	4	0	3	3	0	0
16H,6-22	515	11	396	77	15	5	1	0	4	0	3	3	0	0
18H,6-24	515	11	396	77	15	5	1	0	4	0	3	3	0	0
24H,0-24	537	13	410	83	15	5	1	0	4	0	3	3	0	0
Wed 16-Mar-22														
00:00	0	0	0	0	0	0	0	0	0	0	0	0	0	0
01:00	0	0	0	0	0	0	0	0	0	0	0	0	0	0
02:00	0	0	0	0	0	0	0	0	0	0	0	0	0	0
03:00	2	0	2	0	0	0	0	0	0	0	0	0	0	0
04:00	7	0	5	2	0	0	0	0	0	0	0	0	0	0
05:00	16	2	9	4	0	1	0	0	0	0	0	0	0	0
06:00	36	0	27	7	1	0	0	0	1	0	0	0	0	0
07:00	76	1	60	9	1	2	1	0	0	0	2	0	0	0
08:00	64	3	49	9	2	1	0	0	0	0	0	0	0	0
09:00	40	0	31	8	1	0	0	0	0	0	0	0	0	0
10:00	48	0	29	12	1	0	0	0	5	0	1	0	0	0
11:00	22	0	14	6	1	0	0	0	0	0	1	0	0	0
12:00	30	0	23	4	1	0	0	0	0	0	1	0	0	0
13:00	33	0	28	3	1	0	1	0	0	0	0	0	0	0

TIME PERIOD	TOTAL VEHICLES	MOTOR-CYCLES	CARS OR CAR-BASED LGV	LIGHT GOODS VEHICLES	BUSES	TWO AXLE, SIX TYRE, RIGID/BUSES	THREE AXLE RIGID	FOUR OR MORE AXLE RIGID	FOUR OR LESS AXLE ARTIC	FIVE AXLE ARTIC	SIX OR MORE AXLE ARTIC	FIVE OR LESS AXLE MULTI-TRAILER ARTIC	SIX AXLE MULTI-TRAILER ARTIC	SEVEN OR MORE AXLE ARTIC
14:00	28	0	22	3	1	1	0	0	0	0	0	1	0	0
15:00	36	0	27	5	2	0	1	0	1	0	0	0	0	0
16:00	36	1	29	4	1	0	0	0	0	0	1	0	0	0
17:00	25	0	19	4	1	0	0	0	0	0	0	1	0	0
18:00	26	0	22	3	1	0	0	0	0	0	0	0	0	0
19:00	17	0	12	4	1	0	0	0	0	0	0	0	0	0
20:00	5	0	4	1	0	0	0	0	0	0	0	0	0	0
21:00	3	0	2	1	0	0	0	0	0	0	0	0	0	0
22:00	1	0	1	0	0	0	0	0	0	0	0	0	0	0
23:00	1	0	1	0	0	0	0	0	0	0	0	0	0	0
12H,7-19	464	5	353	70	14	4	4	0	6	0	6	2	0	0
16H,6-22	525	5	398	83	16	4	4	0	7	0	6	2	0	0
18H,6-24	527	5	400	83	16	4	4	0	7	0	6	2	0	0
24H,0-24	552	7	416	89	16	5	4	0	7	0	6	2	0	0
Thu 17-Mar-22														
00:00	0	0	0	0	0	0	0	0	0	0	0	0	0	0
01:00	0	0	0	0	0	0	0	0	0	0	0	0	0	0
02:00	0	0	0	0	0	0	0	0	0	0	0	0	0	0
03:00	2	0	2	0	0	0	0	0	0	0	0	0	0	0
04:00	9	0	6	3	0	0	0	0	0	0	0	0	0	0
05:00	7	2	3	2	0	0	0	0	0	0	0	0	0	0
06:00	33	0	25	7	1	0	0	0	0	0	0	0	0	0
07:00	62	0	47	9	2	1	2	0	0	0	1	0	0	0
08:00	71	2	55	11	1	1	0	0	0	0	1	0	0	0
09:00	38	0	30	5	1	1	0	0	0	0	1	0	0	0
10:00	34	1	24	7	1	0	0	0	0	0	1	0	0	0
11:00	32	1	25	3	1	0	1	0	0	0	1	0	0	0
12:00	32	1	23	7	1	0	0	0	0	0	0	0	0	0
13:00	26	1	19	4	1	0	0	0	0	0	0	1	0	0
14:00	40	2	31	6	0	1	0	0	0	0	0	0	0	0
15:00	38	1	30	6	1	0	0	0	0	0	0	0	0	0
16:00	35	2	26	6	1	0	0	0	0	0	0	0	0	0

TIME PERIOD	TOTAL VEHICLES	MOTOR-CYCLES	CARS OR CAR-BASED LGV	LIGHT GOODS VEHICLES	BUSES	TWO AXLE, SIX TYRE, RIGID/BUSES	THREE AXLE RIGID	FOUR OR MORE AXLE RIGID	FOUR OR LESS AXLE ARTIC	FIVE AXLE ARTIC	SIX OR MORE AXLE ARTIC	FIVE OR LESS AXLE MULTI-TRAILER ARTIC	SIX AXLE MULTI-TRAILER ARTIC	SEVEN OR MORE AXLE ARTIC
17:00	25	1	20	1	1	1	0	0	0	0	0	1	0	0
18:00	29	3	22	3	1	0	0	0	0	0	0	0	0	0
19:00	17	0	13	3	1	0	0	0	0	0	0	0	0	0
20:00	10	1	9	0	0	0	0	0	0	0	0	0	0	0
21:00	3	0	3	0	0	0	0	0	0	0	0	0	0	0
22:00	2	0	2	0	0	0	0	0	0	0	0	0	0	0
23:00	1	0	1	0	0	0	0	0	0	0	0	0	0	0
12H,7-19	462	15	352	68	12	5	3	0	0	0	5	2	0	0
16H,6-22	525	16	402	78	14	5	3	0	0	0	5	2	0	0
18H,6-24	528	16	405	78	14	5	3	0	0	0	5	2	0	0
24H,0-24	546	18	416	83	14	5	3	0	0	0	5	2	0	0
Daily Totals														
Fri 11-Mar-22	546	10	421	90	14	4	1	0	0	1	3	2	0	0
Sat 12-Mar-22	423	13	344	52	12	1	1	0	0	0	0	0	0	0
Sun 13-Mar-22	322	6	274	33	6	1	1	0	0	0	0	1	0	0
Mon 14-Mar-22	500	15	386	76	15	3	1	0	1	0	2	1	0	0
Tue 15-Mar-22	537	13	410	83	15	5	1	0	4	0	3	3	0	0
Wed 16-Mar-22	552	7	416	89	16	5	4	0	7	0	6	2	0	0
Thu 17-Mar-22	546	18	416	83	14	5	3	0	0	0	5	2	0	0
Total Vehicles	3426	82	2667	506	92	24	12	0	12	1	19	11	0	0

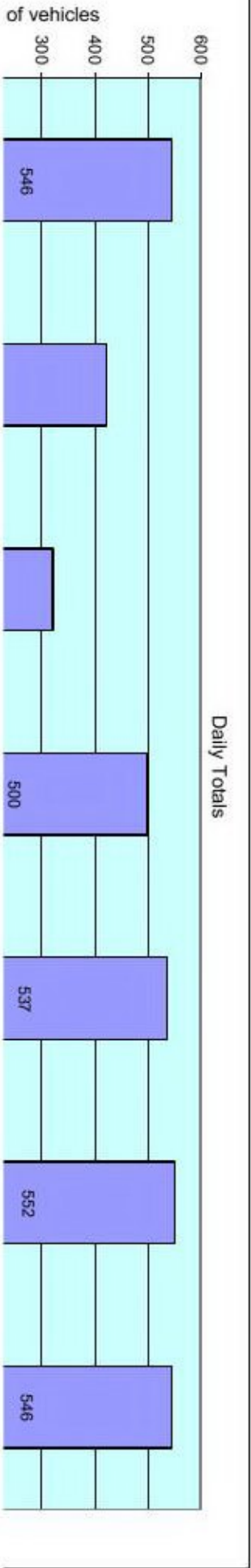

11174 WIX Site No: 11174001 Location Oakley Rd, Wix (att to T/Pole)
 Fri 11-Mar-22 to Thu 17-Mar-22 Channel: Westbound

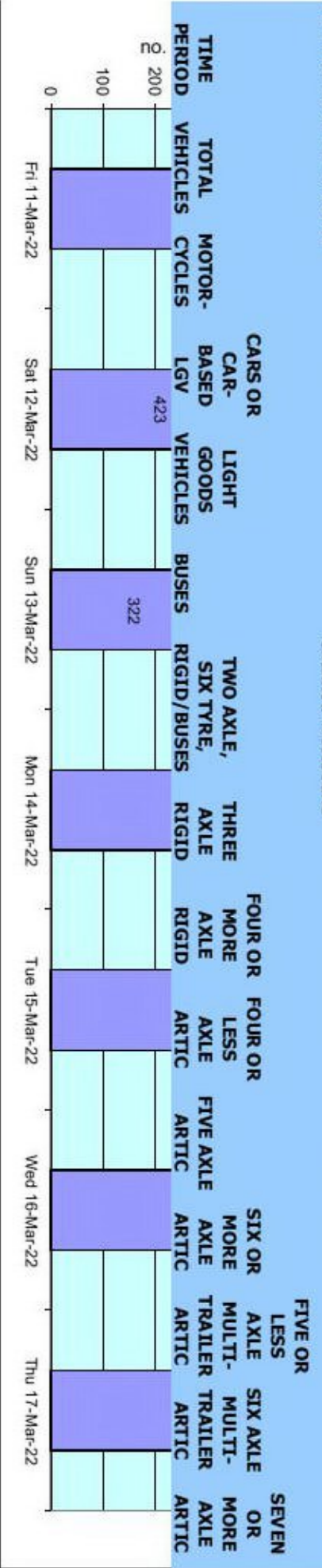

TIME PERIOD	TOTAL VEHICLES	MOTOR-CYCLES	MOTOR-CYCLES%	CARS	CARS %	LGV	LGV %	HGV	HGV %	BUS	BUS %
Fri 11-Mar-22											
00:00	1	0	0.0	1	100.0	0	0.0	0	0.0	0	0.0
01:00	2	0	0.0	2	100.0	0	0.0	0	0.0	0	0.0
02:00	0	0	-	0	-	0	-	0	-	0	-
03:00	2	0	0.0	1	50.0	1	50.0	0	0.0	0	0.0
04:00	4	0	0.0	3	75.0	1	25.0	0	0.0	0	0.0
05:00	15	2	13.3	8	53.3	5	33.3	0	0.0	0	0.0
06:00	31	0	0.0	26	83.9	4	12.9	0	0.0	1	3.2
07:00	60	1	1.7	43	71.7	13	21.7	2	3.3	1	1.7
08:00	57	2	3.5	47	82.5	6	10.5	1	1.8	1	1.8
09:00	46	1	2.2	37	80.4	7	15.2	0	0.0	1	2.2
10:00	34	0	0.0	23	67.7	8	23.5	2	5.9	1	2.9
11:00	27	0	0.0	21	77.8	5	18.5	0	0.0	1	3.7
12:00	42	0	0.0	34	81.0	6	14.3	1	2.4	1	2.4
13:00	33	0	0.0	27	81.8	4	12.1	1	3.0	1	3.0
14:00	45	0	0.0	32	71.1	11	24.4	1	2.2	1	2.2
15:00	33	0	0.0	25	75.8	6	18.2	1	3.0	1	3.0
16:00	36	2	5.6	28	77.8	5	13.9	0	0.0	1	2.8
17:00	29	1	3.5	25	86.2	2	6.9	0	0.0	1	3.5
18:00	21	0	0.0	16	76.2	2	9.5	2	9.5	1	4.8
19:00	11	0	0.0	9	81.8	1	9.1	0	0.0	1	9.1
20:00	7	1	14.3	4	57.1	2	28.6	0	0.0	0	0.0
21:00	4	0	0.0	3	75.0	1	25.0	0	0.0	0	0.0
22:00	2	0	0.0	2	100.0	0	0.0	0	0.0	0	0.0
23:00	4	0	0.0	4	100.0	0	0.0	0	0.0	0	0.0
12H 7-19	463	7	1.5	358	77.3	75	16.2	11	2.4	12	2.6
16H 6-22	516	8	1.6	400	77.5	83	16.1	11	2.1	14	2.7
18H 6-24	522	8	1.5	406	77.8	83	15.9	11	2.1	14	2.7
24H 0-24	546	10	1.8	421	77.1	90	16.5	11	2.0	14	2.6
Sat 12-Mar-22											
00:00	0	0	-	0	-	0	-	0	-	0	-
01:00	1	0	0.0	1	100.0	0	0.0	0	0.0	0	0.0

TIME PERIOD	TOTAL VEHICLES	MOTOR-CYCLES	MOTOR-CYCLES%	CARS	CARS %	LGV	LGV %	HGV	HGV %	BUS	BUS %
02:00	0	0	-	0	-	0	-	0	-	0	-
03:00	2	0	0.0	2	100.0	0	0.0	0	0.0	0	0.0
04:00	3	0	0.0	1	33.3	2	66.7	0	0.0	0	0.0
05:00	9	2	22.2	3	33.3	4	44.4	0	0.0	0	0.0
06:00	10	0	0.0	8	80.0	1	10.0	0	0.0	1	10.0
07:00	10	0	0.0	9	90.0	0	0.0	0	0.0	1	10.0
08:00	33	1	3.0	29	87.9	3	9.1	0	0.0	0	0.0
09:00	41	0	0.0	36	87.8	4	9.8	0	0.0	1	2.4
10:00	31	1	3.2	23	74.2	5	16.1	1	3.2	1	3.2
11:00	40	3	7.5	30	75.0	6	15.0	1	2.5	0	0.0
12:00	43	0	0.0	39	90.7	3	7.0	0	0.0	1	2.3
13:00	34	0	0.0	30	88.2	3	8.8	0	0.0	1	2.9
14:00	34	1	2.9	25	73.5	7	20.6	0	0.0	1	2.9
15:00	30	1	3.3	23	76.7	5	16.7	0	0.0	1	3.3
16:00	23	2	8.7	19	82.6	1	4.4	0	0.0	1	4.4
17:00	25	2	8.0	20	80.0	3	12.0	0	0.0	0	0.0
18:00	21	0	0.0	17	81.0	3	14.3	0	0.0	1	4.8
19:00	13	0	0.0	12	92.3	0	0.0	0	0.0	1	7.7
20:00	4	0	0.0	4	100.0	0	0.0	0	0.0	0	0.0
21:00	5	0	0.0	4	80.0	1	20.0	0	0.0	0	0.0
22:00	8	0	0.0	6	75.0	1	12.5	0	0.0	1	12.5
23:00	3	0	0.0	3	100.0	0	0.0	0	0.0	0	0.0
12H 7-19	365	11	3.0	300	82.2	43	11.8	2	0.6	9	2.5
16H 6-22	397	11	2.8	328	82.6	45	11.3	2	0.5	11	2.8
18H 6-24	408	11	2.7	337	82.6	46	11.3	2	0.5	12	2.9
24H 0-24	423	13	3.1	344	81.3	52	12.3	2	0.5	12	2.8
Sun 13-Mar-22											
00:00	1	0	0.0	1	100.0	0	0.0	0	0.0	0	0.0
01:00	1	0	0.0	0	0.0	1	100.0	0	0.0	0	0.0
02:00	0	0	-	0	-	0	-	0	-	0	-
03:00	1	0	0.0	1	100.0	0	0.0	0	0.0	0	0.0
04:00	0	0	-	0	-	0	-	0	-	0	-

11174
Fri 11-Mar-22 to Thu 17-Mar-22

WIX

Site No: 11174001
Channel: Westbound

Location

Oakley Rd, Wix (att to T/Pole)

TIME PERIOD	TOTAL VEHICLES	MOTOR-CYCLES	MOTOR-CYCLES%	CARS	CARS %	LGV	LGV %	HGV	HGV %	BUS	BUS %
05:00	6	0	0.0	4	66.7	2	33.3	0	0.0	0	0.0
06:00	4	0	0.0	4	100.0	0	0.0	0	0.0	0	0.0
07:00	13	1	7.7	11	84.6	1	7.7	0	0.0	0	0.0
08:00	21	1	4.8	15	71.4	4	19.1	0	0.0	1	4.8
09:00	29	0	0.0	23	79.3	5	17.2	1	3.5	0	0.0
10:00	45	1	2.2	37	82.2	6	13.3	0	0.0	1	2.2
11:00	32	1	3.1	27	84.4	4	12.5	0	0.0	0	0.0
12:00	31	0	0.0	29	93.6	1	3.2	0	0.0	1	3.2
13:00	25	1	4.0	20	80.0	4	16.0	0	0.0	0	0.0
14:00	25	0	0.0	21	84.0	3	12.0	0	0.0	1	4.0
15:00	17	1	5.9	14	82.4	1	5.9	1	5.9	0	0.0
16:00	20	0	0.0	18	90.0	0	0.0	1	5.0	1	5.0
17:00	17	0	0.0	17	100.0	0	0.0	0	0.0	0	0.0
18:00	16	0	0.0	14	87.5	1	6.3	0	0.0	1	6.3
19:00	7	0	0.0	7	100.0	0	0.0	0	0.0	0	0.0
20:00	7	0	0.0	7	100.0	0	0.0	0	0.0	0	0.0
21:00	2	0	0.0	2	100.0	0	0.0	0	0.0	0	0.0
22:00	0	0	-	0	-	0	-	0	-	0	-
23:00	2	0	0.0	2	100.0	0	0.0	0	0.0	0	0.0
12H 7-19	291	6	2.1	246	84.5	30	10.3	3	1.0	6	2.1
16H 6-22	311	6	1.9	266	85.5	30	9.7	3	1.0	6	1.9
18H 6-24	313	6	1.9	268	85.6	30	9.6	3	1.0	6	1.9
24H 0-24	322	6	1.9	274	85.1	33	10.3	3	0.9	6	1.9
Mon 14-Mar-22											
00:00	0	0	-	0	-	0	-	0	-	0	-
01:00	1	0	0.0	1	100.0	0	0.0	0	0.0	0	0.0
02:00	0	0	-	0	-	0	-	0	-	0	-
03:00	2	0	0.0	2	100.0	0	0.0	0	0.0	0	0.0
04:00	8	0	0.0	5	62.5	3	37.5	0	0.0	0	0.0
05:00	13	2	15.4	8	61.5	3	23.1	0	0.0	0	0.0
06:00	33	0	0.0	28	84.9	4	12.1	0	0.0	1	3.0
07:00	70	0	0.0	58	82.9	8	11.4	2	2.9	2	2.9

TIME PERIOD	TOTAL VEHICLES	MOTOR-CYCLES	MOTOR-CYCLES%	CARS	CARS %	LGV	LGV %	HGV	HGV %	BUS	BUS %
08:00	54	1	1.9	42	77.8	8	14.8	2	3.7	1	1.9
09:00	36	0	0.0	25	69.4	9	25.0	1	2.8	1	2.8
10:00	32	0	0.0	26	81.3	5	15.6	0	0.0	1	3.1
11:00	22	1	4.6	17	77.3	3	13.6	0	0.0	1	4.6
12:00	29	4	13.8	17	58.6	7	24.1	0	0.0	1	3.5
13:00	27	2	7.4	22	81.5	2	7.4	0	0.0	1	3.7
14:00	35	0	0.0	26	74.3	6	17.1	2	5.7	1	2.9
15:00	27	1	3.7	22	81.5	3	11.1	0	0.0	1	3.7
16:00	33	0	0.0	27	81.8	4	12.1	1	3.0	1	3.0
17:00	25	0	0.0	19	76.0	5	20.0	0	0.0	1	4.0
18:00	27	2	7.4	21	77.8	3	11.1	0	0.0	1	3.7
19:00	14	1	7.1	11	78.6	1	7.1	0	0.0	1	7.1
20:00	5	0	0.0	3	60.0	2	40.0	0	0.0	0	0.0
21:00	5	1	20.0	4	80.0	0	0.0	0	0.0	0	0.0
22:00	1	0	0.0	1	100.0	0	0.0	0	0.0	0	0.0
23:00	1	0	0.0	1	100.0	0	0.0	0	0.0	0	0.0
12H,7-19	417	11	2.6	322	77.2	63	15.1	8	1.9	13	3.1
16H,6-22	474	13	2.7	368	77.6	70	14.8	8	1.7	15	3.2
18H,6-24	476	13	2.7	370	77.7	70	14.7	8	1.7	15	3.2
24H,0-24	500	15	3.0	386	77.2	76	15.2	8	1.6	15	3.0
Tue 15-Mar-22											
00:00	0	0	-	0	-	0	-	0	-	0	-
01:00	0	0	-	0	-	0	-	0	-	0	-
02:00	0	0	-	0	-	0	-	0	-	0	-
03:00	1	0	0.0	1	100.0	0	0.0	0	0.0	0	0.0
04:00	6	0	0.0	5	83.3	1	16.7	0	0.0	0	0.0
05:00	15	2	13.3	8	53.3	5	33.3	0	0.0	0	0.0
06:00	34	0	0.0	28	82.4	5	14.7	0	0.0	1	2.9
07:00	68	0	0.0	56	82.4	7	10.3	3	4.4	2	2.9
08:00	60	1	1.7	47	78.3	10	16.7	1	1.7	1	1.7
09:00	33	0	0.0	26	78.8	6	18.2	0	0.0	1	3.0
10:00	28	2	7.1	21	75.0	3	10.7	1	3.6	1	3.6

11174
Fri 11-Mar-22 to Thu 17-Mar-22

WIX

Site No: 11174001
Channel: Westbound

Location

Oakley Rd, Wix (att to T/Pole)

TIME PERIOD	TOTAL VEHICLES	MOTOR-CYCLES	MOTOR-CYCLES%	CARS	CARS %	LGV	LGV %	HGV	HGV %	BUS	BUS %
11:00	30	2	6.7	20	66.7	5	16.7	2	6.7	1	3.3
12:00	29	0	0.0	21	72.4	5	17.2	1	3.5	2	6.9
13:00	40	2	5.0	28	70.0	6	15.0	4	10.0	0	0.0
14:00	36	1	2.8	26	72.2	7	19.4	1	2.8	1	2.8
15:00	41	1	2.4	34	82.9	5	12.2	0	0.0	1	2.4
16:00	38	0	0.0	35	92.1	2	5.3	0	0.0	1	2.6
17:00	37	1	2.7	22	59.5	10	27.0	3	8.1	1	2.7
18:00	23	1	4.4	19	82.6	2	8.7	0	0.0	1	4.4
19:00	8	0	0.0	5	62.5	2	25.0	0	0.0	1	12.5
20:00	9	0	0.0	7	77.8	2	22.2	0	0.0	0	0.0
21:00	1	0	0.0	1	100.0	0	0.0	0	0.0	0	0.0
22:00	0	0	-	0	-	0	-	0	-	0	-
23:00	0	0	-	0	-	0	-	0	-	0	-
12H:7-19	463	11	2.4	355	76.7	68	14.7	16	3.5	13	2.8
16H:6-22	515	11	2.1	396	76.9	77	15.0	16	3.1	15	2.9
18H:6-24	515	11	2.1	396	76.9	77	15.0	16	3.1	15	2.9
24H:0-24	537	13	2.4	410	76.4	83	15.5	16	3.0	15	2.8
Wed 16-Mar-22											
00:00	0	0	-	0	-	0	-	0	-	0	-
01:00	0	0	-	0	-	0	-	0	-	0	-
02:00	0	0	-	0	-	0	-	0	-	0	-
03:00	2	0	0.0	2	100.0	0	0.0	0	0.0	0	0.0
04:00	7	0	0.0	5	71.4	2	28.6	0	0.0	0	0.0
05:00	16	2	12.5	9	56.3	4	25.0	1	6.3	0	0.0
06:00	36	0	0.0	27	75.0	7	19.4	1	2.8	1	2.8
07:00	76	1	1.3	60	79.0	9	11.8	5	6.6	1	1.3
08:00	64	3	4.7	49	76.6	9	14.1	1	1.6	2	3.1
09:00	40	0	0.0	31	77.5	8	20.0	0	0.0	1	2.5
10:00	48	0	0.0	29	60.4	12	25.0	6	12.5	1	2.1
11:00	22	0	0.0	14	63.6	6	27.3	1	4.6	1	4.6
12:00	30	0	0.0	23	76.7	4	13.3	2	6.7	1	3.3
13:00	33	0	0.0	28	84.9	3	9.1	1	3.0	1	3.0

11174
Fri 11-Mar-22 to Thu 17-Mar-22

WIX

Site No: 11174001
Channel: Westbound

Location

Oakley Rd, Wix (att to T/Pole)

TIME PERIOD	TOTAL VEHICLES	MOTOR-CYCLES	MOTOR-CYCLES%	CARS	CARS %	LGV	LGV %	HGV	HGV %	BUS	BUS %
14:00	28	0	0.0	22	78.6	3	10.7	2	7.1	1	3.6
15:00	36	0	0.0	27	75.0	5	13.9	2	5.6	2	5.6
16:00	36	1	2.8	29	80.6	4	11.1	1	2.8	1	2.8
17:00	25	0	0.0	19	76.0	4	16.0	1	4.0	1	4.0
18:00	26	0	0.0	22	84.6	3	11.5	0	0.0	1	3.9
19:00	17	0	0.0	12	70.6	4	23.5	0	0.0	1	5.9
20:00	5	0	0.0	4	80.0	1	20.0	0	0.0	0	0.0
21:00	3	0	0.0	2	66.7	1	33.3	0	0.0	0	0.0
22:00	1	0	0.0	1	100.0	0	0.0	0	0.0	0	0.0
23:00	1	0	0.0	1	100.0	0	0.0	0	0.0	0	0.0
12H,7-19	464	5	1.1	353	76.1	70	15.1	22	4.7	14	3.0
16H,6-22	525	5	1.0	398	75.8	83	15.8	23	4.4	16	3.1
18H,6-24	527	5	1.0	400	75.9	83	15.8	23	4.4	16	3.0
24H,0-24	552	7	1.3	416	75.4	89	16.1	24	4.4	16	2.9
Thu 17-Mar-22											
00:00	0	0	-	0	-	0	-	0	-	0	-
01:00	0	0	-	0	-	0	-	0	-	0	-
02:00	0	0	-	0	-	0	-	0	-	0	-
03:00	2	0	0.0	2	100.0	0	0.0	0	0.0	0	0.0
04:00	9	0	0.0	6	66.7	3	33.3	0	0.0	0	0.0
05:00	7	2	28.6	3	42.9	2	28.6	0	0.0	0	0.0
06:00	33	0	0.0	25	75.8	7	21.2	0	0.0	1	3.0
07:00	62	0	0.0	47	75.8	9	14.5	4	6.5	2	3.2
08:00	71	2	2.8	55	77.5	11	15.5	2	2.8	1	1.4
09:00	38	0	0.0	30	79.0	5	13.2	2	5.3	1	2.6
10:00	34	1	2.9	24	70.6	7	20.6	1	2.9	1	2.9
11:00	32	1	3.1	25	78.1	3	9.4	2	6.3	1	3.1
12:00	32	1	3.1	23	71.9	7	21.9	0	0.0	1	3.1
13:00	26	1	3.9	19	73.1	4	15.4	1	3.9	1	3.9
14:00	40	2	5.0	31	77.5	6	15.0	1	2.5	0	0.0
15:00	38	1	2.6	30	79.0	6	15.8	0	0.0	1	2.6
16:00	35	2	5.7	26	74.3	6	17.1	0	0.0	1	2.9

TIME PERIOD	TOTAL VEHICLES	MOTOR-CYCLES	MOTOR-CYCLES%	CARS	CARS %	LGV	LGV %	HGV	HGV %	BUS	BUS %
17:00	25	1	4.0	20	80.0	1	4.0	2	8.0	1	4.0
18:00	29	3	10.3	22	75.9	3	10.3	0	0.0	1	3.5
19:00	17	0	0.0	13	76.5	3	17.7	0	0.0	1	5.9
20:00	10	1	10.0	9	90.0	0	0.0	0	0.0	0	0.0
21:00	3	0	0.0	3	100.0	0	0.0	0	0.0	0	0.0
22:00	2	0	0.0	2	100.0	0	0.0	0	0.0	0	0.0
23:00	1	0	0.0	1	100.0	0	0.0	0	0.0	0	0.0
12H 7-19	462	15	3.3	352	76.2	68	14.7	15	3.3	12	2.6
16H 6-22	525	16	3.1	402	76.6	78	14.9	15	2.9	14	2.7
18H 6-24	528	16	3.0	405	76.7	78	14.8	15	2.8	14	2.7
24H 0-24	546	18	3.3	416	76.2	83	15.2	15	2.8	14	2.6
Daily Totals											
Fri 11-Mar-22	546	10	1.8	421	77.1	90	16.5	11	2.0	14	2.6
Sat 12-Mar-22	423	13	3.1	344	81.3	52	12.3	2	0.5	12	2.8
Sun 13-Mar-22	322	6	1.9	274	85.1	33	10.3	3	0.9	6	1.9
Mon 14-Mar-22	500	15	3.0	386	77.2	76	15.2	8	1.6	15	3.0
Tue 15-Mar-22	537	13	2.4	410	76.4	83	15.5	16	3.0	15	2.8
Wed 16-Mar-22	552	7	1.3	416	75.4	89	16.1	24	4.4	16	2.9
Thu 17-Mar-22	546	18	3.3	416	76.2	83	15.2	15	2.8	14	2.6
Total Vehicles	3426	82	2.4	2667	78.4	506	14.4	79	2.2	92	2.6

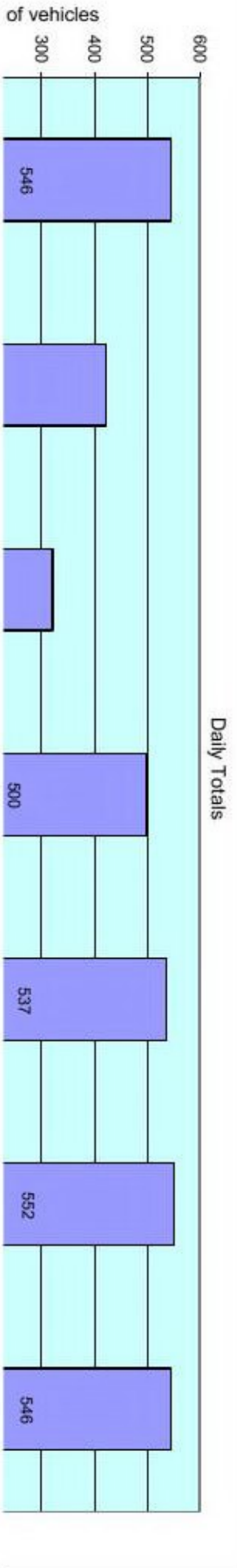

11174
 Fri 11-Mar-22 to Thu 17-Mar-22

WIX
 Site No: 11174001
 Channel: Westbound

Location
 Oakley Rd, Wix (att to T/Pole)

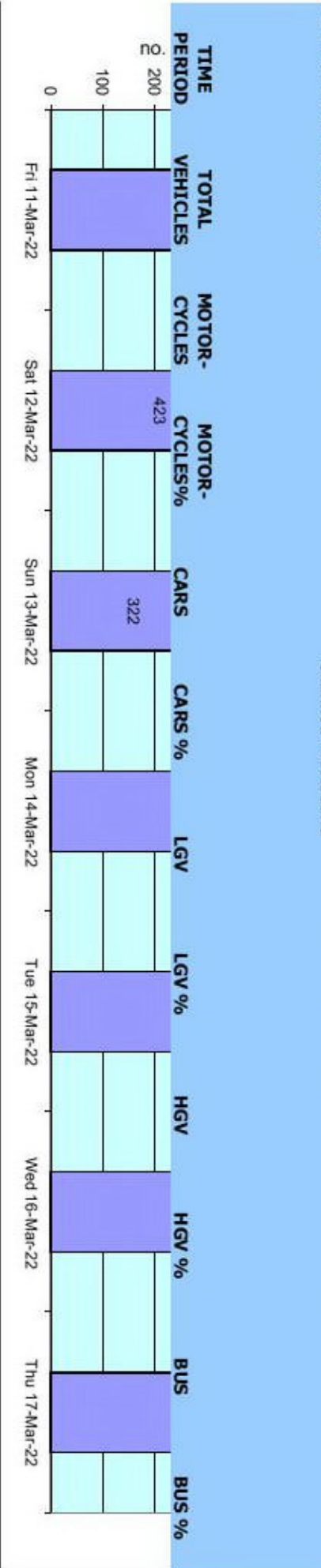

11174
Fri 11-Mar-22 to Thu 17-Mar-22

WIX

Site No: 11174001
Channel: Westbound

Location Oakley Rd, Wix (att to T/Pole)

Time Period	Total Vehicles	85%ile Speed	Mean Speed	Stand Dev.	<11Mph	11-<21	21-<31	31-<41	41-<46	46-<51	51-<56	56-<61	61-<66	66-<71	71-<76	=>76
Fri 11-Mar-22																
00:00	1	-	36	-	0	0	0	1	0	0	0	0	0	0	0	0
01:00	2	-	43.5	1.8	0	0	0	0	2	0	0	0	0	0	0	0
02:00	0	-	-	-	0	0	0	0	0	0	0	0	0	0	0	0
03:00	2	-	51	3.5	0	0	0	0	0	1	1	0	0	0	0	0
04:00	4	-	57.3	8.5	0	0	0	0	0	1	1	1	0	1	0	0
05:00	15	54.3	44.8	14.9	0	2	0	2	3	2	5	0	0	0	1	0
06:00	31	59.8	50.6	11	0	0	3	1	5	4	6	9	2	1	0	0
07:00	60	53.5	46.2	8.1	0	0	3	9	12	21	11	3	1	0	0	0
08:00	57	55.5	47.1	8.3	0	0	3	4	20	12	10	7	1	0	0	0
09:00	46	54.5	46.2	9.1	0	1	1	9	7	13	11	4	0	0	0	0
10:00	34	51.7	43.6	9	0	0	1	13	7	7	3	1	2	0	0	0
11:00	27	50.6	45.4	7.2	0	0	0	5	11	7	3	0	0	1	0	0
12:00	42	51.2	44.5	7.3	0	0	0	14	8	13	5	2	0	0	0	0
13:00	33	53.6	45.1	8.3	0	0	0	11	7	7	5	2	1	0	0	0
14:00	45	52.5	43.6	8.5	0	0	2	14	13	7	6	2	1	0	0	0
15:00	33	50.3	44	7.7	0	0	1	9	10	8	3	2	0	0	0	0
16:00	36	54.1	45.9	9.3	0	1	0	9	5	9	10	1	1	0	0	0
17:00	29	56.3	46	10	0	0	1	8	5	8	2	3	1	1	0	0
18:00	21	54.9	44.2	11.1	0	0	2	6	5	2	3	2	0	1	0	0
19:00	11	55.3	46	11.7	0	0	1	2	3	2	1	1	0	0	1	0
20:00	7	-	49.2	10.6	0	0	0	2	0	2	1	1	1	0	0	0
21:00	4	-	42.3	7.6	0	0	0	2	0	2	0	0	0	0	0	0
22:00	2	-	42.3	8.8	0	0	0	1	0	1	0	0	0	0	0	0
23:00	4	-	41.6	4	0	0	0	1	3	0	0	0	0	0	0	0
12H,7-19	463	53.9	45.3	8.6	0	2	14	111	110	114	72	29	8	3	0	0
16H,6-22	516	54.6	45.7	8.9	0	2	18	118	118	124	80	40	11	5	0	0
18H,6-24	522	54.6	45.6	8.9	0	2	18	120	121	125	80	40	11	5	0	0
24H,0-24	546	54.7	45.7	9.1	0	4	18	123	126	129	87	41	11	6	1	0
Sat 12-Mar-22																
00:00	0	-	-	-	0	0	0	0	0	0	0	0	0	0	0	0
01:00	1	-	43.5	-	0	0	0	0	1	0	0	0	0	0	0	0
02:00	0	-	-	-	0	0	0	0	0	0	0	0	0	0	0	0

11174
Fri 11-Mar-22 to Thu 17-Mar-22

WIX

Site No: 11174001
Channel: Westbound

Location Oakley Rd, Wix (att to T/Pole)

Time Period	Total Vehicles	85%ile Speed	Mean Speed	Stand Dev.	<11Mph	11-<21	21-<31	31-<41	41-<46	46-<51	51-<56	56-<61	61-<66	66-<71	71-<76	=>76
03:00	2	-	51	3.5	0	0	0	0	0	1	1	0	0	0	0	0
04:00	3	-	38.5	5	0	0	0	2	1	0	0	0	0	0	0	0
05:00	9	-	42.7	17.2	0	2	0	1	1	2	1	1	1	0	0	0
06:00	10	52.7	47.3	5.8	0	0	0	1	3	3	3	0	0	0	0	0
07:00	10	56	49.5	10.3	0	0	0	2	2	1	3	1	0	1	0	0
08:00	33	58.6	49.4	10	0	1	0	3	5	11	6	3	3	1	0	0
09:00	41	50.7	44.7	6.8	0	0	0	11	12	12	4	2	0	0	0	0
10:00	31	52.4	45.3	7.4	0	0	0	8	9	8	3	3	0	0	0	0
11:00	40	51.4	43.1	10.5	0	3	1	8	7	14	6	1	0	0	0	0
12:00	43	54.2	47.3	8.2	0	0	0	9	8	14	8	1	2	1	0	0
13:00	34	50.2	44.5	8	0	0	0	10	10	10	3	0	0	0	1	0
14:00	34	54.6	47.5	7.3	0	0	0	5	10	7	9	2	1	0	0	0
15:00	30	51	46	8.7	0	0	0	6	11	8	3	1	0	0	0	1
16:00	23	51.1	42.8	8.4	0	0	2	6	6	5	4	0	0	0	0	0
17:00	25	55.4	43.8	11.9	0	1	2	6	6	3	3	2	2	0	0	0
18:00	21	59.4	50.6	9.1	0	0	0	2	4	7	3	2	1	1	2	0
19:00	13	52.4	45	8.6	0	0	0	4	4	2	2	0	1	0	0	0
20:00	4	-	49.1	12	0	0	0	1	1	0	1	0	1	0	0	0
21:00	5	-	40.5	4.6	0	0	0	2	3	0	0	0	0	0	0	0
22:00	8	-	43.2	11.6	0	0	0	5	1	0	0	1	1	0	0	0
23:00	3	-	40.2	7.6	0	0	0	2	0	1	0	0	0	0	0	0
12H,7-19	365	54.1	46	9	0	5	5	76	90	100	55	18	9	5	1	1
16H,6-22	397	54	45.9	8.9	0	5	5	84	101	105	61	18	11	5	1	1
18H,6-24	408	54.1	45.8	9	0	5	5	91	102	106	61	19	12	5	1	1
24H,0-24	423	54.1	45.7	9.2	0	7	5	94	105	109	63	20	13	5	1	1
Sun 13-Mar-22	1	-	36	-	0	0	0	1	0	0	0	0	0	0	0	0
01:00	1	-	36	-	0	0	0	1	0	0	0	0	0	0	0	0
02:00	0	-	-	-	0	0	0	0	0	0	0	0	0	0	0	0
03:00	1	-	36	-	0	0	0	1	0	0	0	0	0	0	0	0
04:00	0	-	-	-	0	0	0	0	0	0	0	0	0	0	0	0
05:00	6	-	50.2	6.2	0	0	0	0	2	1	2	1	0	0	0	0
06:00	4	-	52.3	8.5	0	0	0	0	1	1	1	0	0	0	0	0

11174
Fri 11-Mar-22 to Thu 17-Mar-22

WIX

Site No: 11174001
Channel: Westbound

Location Oakley Rd, Wix (att to T/Pole)

Time Period	Total Vehicles	85%ile Speed	Mean Speed	Stand Dev.	<11Mph	11-<21	21-<31	31-<41	41-<46	46-<51	51-<56	56-<61	61-<66	66-<71	71-<76	=>76
07:00	13	53.8	46.2	11.7	0	1	0	1	4	3	2	1	1	0	0	0
08:00	21	52.7	44.2	9.6	0	1	0	5	5	5	4	1	0	0	0	0
09:00	29	54.2	47.5	7.3	0	0	0	6	3	10	8	2	0	0	0	0
10:00	45	52.5	44.4	7.5	0	0	0	13	17	6	6	2	1	0	0	0
11:00	32	53.7	45.2	8.7	0	1	0	5	13	5	5	3	0	0	0	0
12:00	31	50.8	42.7	8	0	0	0	14	9	3	3	1	1	0	0	0
13:00	25	54.8	47.7	10.6	0	0	0	6	6	5	5	1	0	1	0	1
14:00	25	49.1	41.9	8.2	0	0	1	11	5	6	1	0	1	0	0	0
15:00	17	54.7	46	10.4	0	1	0	2	5	3	4	2	0	0	0	0
16:00	20	53.5	43.4	11.6	0	0	2	7	4	2	3	1	1	0	1	0
17:00	17	50.9	42.6	7.9	0	0	0	8	4	2	2	1	0	0	0	0
18:00	16	49.1	42.4	6.7	0	0	0	7	3	5	1	0	0	0	0	0
19:00	7	-	45.6	9.6	0	0	0	2	2	2	0	0	1	0	0	0
20:00	7	-	43.9	4.4	0	0	0	1	4	2	0	0	0	0	0	0
21:00	2	-	47.3	15.9	0	0	0	1	0	0	0	1	0	0	0	0
22:00	0	-	-	-	0	0	0	0	0	0	0	0	0	0	0	0
23:00	2	-	46	3.5	0	0	0	0	1	1	0	0	0	0	0	0
12H,7-19	291	53.5	44.6	8.9	0	4	3	85	78	55	44	15	4	1	1	1
16H,6-22	311	53.5	44.7	8.9	0	4	3	89	85	60	45	16	6	1	1	1
18H,6-24	313	53.5	44.7	8.9	0	4	3	89	86	61	45	16	6	1	1	1
24H,0-24	322	53.6	44.7	8.9	0	4	3	92	88	62	47	17	6	1	1	1
Mon 14-Mar-22																
00:00	0	-	-	-	0	0	0	0	0	0	0	0	0	0	0	0
01:00	1	-	63.5	-	0	0	0	0	0	0	0	0	1	0	0	0
02:00	0	-	-	-	0	0	0	0	0	0	0	0	0	0	0	0
03:00	2	-	58.5	7.1	0	0	0	0	0	0	1	0	1	0	0	0
04:00	8	-	52.3	6.5	0	0	0	0	1	3	2	1	1	0	0	0
05:00	13	53.8	43.3	14.1	0	2	0	1	4	3	1	1	1	0	0	0
06:00	33	51.9	46.2	7	0	0	1	3	12	11	3	3	0	0	0	0
07:00	70	54.3	48.1	6.2	0	0	0	6	20	21	18	4	1	0	0	0
08:00	54	54.6	45.7	9.9	0	1	3	9	12	14	9	3	3	0	0	0
09:00	36	53.9	45	8.6	0	0	0	14	4	8	7	2	1	0	0	0
10:00	32	51.6	43.9	7	0	0	0	11	8	7	6	0	0	0	0	0

11174
Fri 11-Mar-22 to Thu 17-Mar-22

WIX

Site No: 11174001
Channel: Westbound

Location Oakley Rd, Wix (att to T/Pole)

Time Period	Total Vehicles	85%ile Speed	Mean Speed	Stand Dev.	<11Mph	11-<21	21-<31	31-<41	41-<46	46-<51	51-<56	56-<61	61-<66	66-<71	71-<76	=>76
11:00	22	51.3	42.1	9.4	0	1	0	9	3	5	4	0	0	0	0	0
12:00	29	51.2	42	10.7	0	2	0	11	4	7	4	0	1	0	0	0
13:00	27	47.5	38.9	9	0	2	0	14	5	5	1	0	0	0	0	0
14:00	35	52.3	44.4	9.8	0	0	1	12	7	8	5	1	0	0	0	1
15:00	27	55.7	48.8	10.3	0	1	0	2	7	5	8	1	2	1	0	0
16:00	33	50.4	43	6.9	0	0	0	12	12	4	4	1	0	0	0	0
17:00	25	53.2	45	9.3	0	0	0	9	6	4	4	0	1	1	0	0
18:00	27	53.3	43.2	10.2	0	0	2	9	8	3	1	3	0	1	0	0
19:00	14	56.7	44	12	0	1	1	1	5	3	0	3	0	0	0	0
20:00	5	-	39	4.8	0	0	0	3	2	0	0	0	0	0	0	0
21:00	5	-	37.5	12.9	0	1	0	1	2	1	0	0	0	0	0	0
22:00	1	-	36	-	0	0	0	1	0	0	0	0	0	0	0	0
23:00	1	-	58.5	-	0	0	0	0	0	0	0	1	0	0	0	0
12H,7-19	417	53.5	44.7	9.1	0	7	6	118	96	91	71	15	9	3	0	1
16H,6-22	474	53.5	44.6	9.1	0	9	8	126	117	106	74	21	9	3	0	1
18H,6-24	476	53.5	44.7	9.1	0	9	8	127	117	106	74	22	9	3	0	1
24H,0-24	500	53.8	44.8	9.3	0	11	8	128	122	112	78	24	13	3	0	1
Tue 15-Mar-22																
00:00	0	-	-	-	0	0	0	0	0	0	0	0	0	0	0	0
01:00	0	-	-	-	0	0	0	0	0	0	0	0	0	0	0	0
02:00	0	-	-	-	0	0	0	0	0	0	0	0	0	0	0	0
03:00	1	-	43.5	-	0	0	0	0	1	0	0	0	0	0	0	0
04:00	6	-	45.6	6.1	0	0	0	1	2	2	1	0	0	0	0	0
05:00	15	53.1	43.3	13.5	0	2	0	3	1	5	3	0	1	0	0	0
06:00	34	58.4	50	8.3	0	0	0	3	7	12	4	5	1	2	0	0
07:00	68	55	47.2	8.2	0	0	2	9	18	18	13	6	1	1	0	0
08:00	60	53.3	46.3	7.3	0	0	2	6	21	17	10	3	3	1	0	0
09:00	33	54.6	47	8	0	0	0	6	10	8	5	3	0	1	0	0
10:00	28	49.3	42.3	7.9	0	1	0	8	11	5	3	0	0	0	0	0
11:00	30	52.7	40.6	12.6	0	3	2	10	4	5	3	2	1	0	0	0
12:00	29	52.8	44.2	9.2	0	0	0	12	6	4	6	0	0	0	1	0
13:00	40	51.8	43.8	9.3	0	1	1	12	8	11	3	4	0	0	0	0
14:00	36	54.8	47.5	10.7	0	0	2	7	5	7	12	1	0	1	0	1

11174
Fri 11-Mar-22 to Thu 17-Mar-22

WIX

Site No: 11174001
Channel: Westbound

Location Oakley Rd, Wix (att to T/Pole)

Time Period	Total Vehicles	85%ile Speed	Mean Speed	Stand Dev.	<11Mph	11-<21	21-<31	31-<41	41-<46	46-<51	51-<56	56-<61	61-<66	66-<71	71-<76	=>76
15:00	41	49.4	41.1	9.8	0	1	3	16	11	5	2	1	2	0	0	0
16:00	38	55.3	47.4	10	0	0	0	11	6	8	8	1	1	3	0	0
17:00	37	47.6	42.5	9.9	0	0	1	16	13	3	1	0	2	0	1	0
18:00	23	52.3	45.9	7.9	0	0	1	3	7	7	4	0	1	0	0	0
19:00	8	-	45.4	11.4	0	0	0	4	0	2	0	1	1	0	0	0
20:00	9	-	46.8	13	0	0	0	2	5	0	1	0	0	0	0	1
21:00	1	-	36	-	0	0	0	1	0	0	0	0	0	0	0	0
22:00	0	-	-	-	0	0	0	0	0	0	0	0	0	0	0	0
23:00	0	-	-	-	0	0	0	0	0	0	0	0	0	0	0	0
12H,7-19	463	53.8	44.9	9.4	0	6	14	116	120	98	70	21	9	6	1	2
16H,6-22	515	54.2	45.3	9.5	0	6	14	126	132	112	75	27	11	8	1	3
18H,6-24	515	54.2	45.3	9.5	0	6	14	126	132	112	75	27	11	8	1	3
24H,0-24	537	54.1	45.2	9.6	0	8	14	130	136	119	79	27	12	8	1	3
Wed 16-Mar-22																
00:00	0	-	-	-	0	0	0	0	0	0	0	0	0	0	0	0
01:00	0	-	-	-	0	0	0	0	0	0	0	0	0	0	0	0
02:00	0	-	-	-	0	0	0	0	0	0	0	0	0	0	0	0
03:00	2	-	56	10.6	0	0	0	0	0	1	0	0	1	0	0	0
04:00	7	-	55.6	8.1	0	0	0	0	0	3	1	1	1	1	0	0
05:00	16	51.3	41.2	14	0	2	1	4	2	4	2	0	0	1	0	0
06:00	36	57.1	49	8.5	0	0	1	4	6	10	8	5	2	0	0	0
07:00	76	56.1	46.6	8.8	0	1	2	10	23	20	8	10	2	0	0	0
08:00	64	53.1	45.5	8.9	0	0	4	9	21	17	7	4	1	0	1	0
09:00	40	51.8	44.6	7.9	0	0	0	13	11	9	3	3	1	0	0	0
10:00	48	46.3	40.3	6.7	0	0	1	26	13	5	2	1	1	0	0	0
11:00	22	50	43.5	7.5	0	0	1	5	9	4	2	1	0	0	0	0
12:00	30	50.4	43.9	7.8	0	0	1	8	9	8	3	0	1	0	0	0
13:00	33	55.6	44.6	8.1	0	0	0	11	9	7	1	5	0	0	0	0
14:00	28	46.5	41.4	6.5	0	0	1	10	12	3	2	0	0	0	0	0
15:00	36	51.1	43.1	8.9	0	1	1	10	11	7	4	2	0	0	0	0
16:00	36	51.2	43.6	9.5	0	0	2	12	8	8	3	0	3	0	0	0
17:00	25	50.1	42.8	7.1	0	0	0	11	4	7	3	0	0	0	0	0
18:00	26	49.3	42.8	10.8	0	1	0	10	8	4	0	0	2	1	0	0

11174
Fri 11-Mar-22 to Thu 17-Mar-22

WIX

Site No: 11174001
Channel: Westbound

Location Oakley Rd, Wix (att to T/Pole)

Time Period	Total Vehicles	85%ile Speed	Mean Speed	Stand Dev.	<11Mph	11-<21	21-<31	31-<41	41-<46	46-<51	51-<56	56-<61	61-<66	66-<71	71-<76	=>76
19:00	17	50.8	42.5	8.6	0	0	0	9	3	2	1	2	0	0	0	0
20:00	5	-	44.5	9	0	0	0	2	1	0	2	0	0	0	0	0
21:00	3	-	44.3	7.3	0	0	0	1	0	2	0	0	0	0	0	0
22:00	1	-	43.5	-	0	0	0	0	1	0	0	0	0	0	0	0
23:00	1	-	36	-	0	0	0	1	0	0	0	0	0	0	0	0
12H,7-19	464	51.8	43.9	8.5	0	3	13	135	138	99	38	26	10	1	1	0
16H,6-22	525	52.7	44.2	8.6	0	3	14	151	148	113	49	33	12	1	1	0
18H,6-24	527	52.7	44.2	8.6	0	3	14	152	149	113	49	33	12	1	1	0
24H,0-24	552	53	44.3	8.9	0	5	15	156	151	121	52	34	14	3	1	0
Thu 17-Mar-22																
00:00	0	-	-	-	0	0	0	0	0	0	0	0	0	0	0	0
01:00	0	-	-	-	0	0	0	0	0	0	0	0	0	0	0	0
02:00	0	-	-	-	0	0	0	0	0	0	0	0	0	0	0	0
03:00	2	-	43.5	1.8	0	0	0	0	2	0	0	0	0	0	0	0
04:00	9	-	46.8	12	0	0	0	4	0	2	0	0	0	0	0	0
05:00	7	-	36.7	15.2	0	2	0	1	2	1	1	0	0	0	0	0
06:00	33	55.3	49.2	7.3	0	0	0	3	8	9	8	3	2	0	0	0
07:00	62	54.7	47.9	7.5	0	0	0	10	13	18	15	4	1	1	0	0
08:00	71	54.4	46.5	7.6	0	0	0	16	18	13	19	4	1	0	0	0
09:00	38	52	45.5	6.7	0	0	0	7	15	9	4	3	0	0	0	0
10:00	34	53.3	43.4	10.2	0	1	1	12	6	7	3	3	1	0	0	0
11:00	32	50.1	42.3	9.4	0	1	2	8	10	7	2	2	0	0	0	0
12:00	32	50.7	43	8.6	0	1	1	8	9	8	5	0	0	0	0	0
13:00	26	49.3	41	9.9	0	1	3	6	7	7	1	1	0	0	0	0
14:00	40	51.6	44.2	8.7	0	1	0	12	8	12	4	3	0	0	0	0
15:00	38	50	43.1	8.6	0	1	0	13	9	11	2	1	1	0	0	0
16:00	35	53.1	42.4	12.8	0	3	2	9	6	8	3	3	0	0	0	0
17:00	25	50.4	44	10.3	0	0	4	3	4	10	2	1	1	0	0	0
18:00	29	51.3	43.2	9.4	0	0	0	14	6	4	3	1	0	0	0	0
19:00	17	50.9	42.5	7.8	0	0	0	9	1	4	3	0	0	0	0	0
20:00	10	56	49	10.2	0	0	0	2	2	2	1	1	0	0	0	0
21:00	3	-	45.2	3.1	0	0	0	0	2	1	0	0	0	0	0	0
22:00	2	-	53.5	7.1	0	0	0	0	0	1	0	1	0	0	0	0

11174
Fri 11-Mar-22 to Thu 17-Mar-22

WIX

Site No: 11174001
Channel: Westbound

Location Oakley Rd, Wix (att to T/Pole)

Time Period	Total Vehicles	85%ile Speed	Mean Speed	Stand Dev.	<11Mph	11-<21	21-<31	31-<41	41-<46	46-<51	51-<56	56-<61	61-<66	66-<71	71-<76	=>76
23:00	1	-	48.5	-	0	0	0	0	0	1	0	0	0	0	0	0
12H,7-19	462	53.2	44.4	9.1	0	9	13	118	111	114	63	26	5	1	2	0
16H,6-22	525	53.5	44.7	9.1	0	9	13	132	124	130	76	30	7	2	2	0
18H,6-24	528	53.5	44.8	9	0	9	13	132	124	132	76	31	7	2	2	0
24H,0-24	546	53.5	44.7	9.2	0	11	13	137	128	135	78	32	7	3	2	0
Daily Totals																
Fri 11-Mar-22	546	54.7	45.7	9.1	0	4	18	123	126	129	87	41	11	6	1	0
Sat 12-Mar-22	423	54.1	45.7	9.2	0	7	5	94	105	109	63	20	13	5	1	1
Sun 13-Mar-22	322	53.6	44.7	8.9	0	4	3	92	88	62	47	17	6	1	1	1
Mon 14-Mar-22	500	53.8	44.8	9.3	0	11	8	128	122	112	78	24	13	3	0	1
Tue 15-Mar-22	537	54.1	45.2	9.6	0	8	14	130	136	119	79	27	12	8	1	3
Wed 16-Mar-22	552	53	44.3	8.9	0	5	15	156	151	121	52	34	14	3	1	0
Thu 17-Mar-22	546	53.5	44.7	9.2	0	11	13	137	128	135	78	32	7	3	2	0
Total Vehicles																
[-]	3426	53.8	45.0	9.2	0	50	76	860	856	787	484	195	76	29	7	6

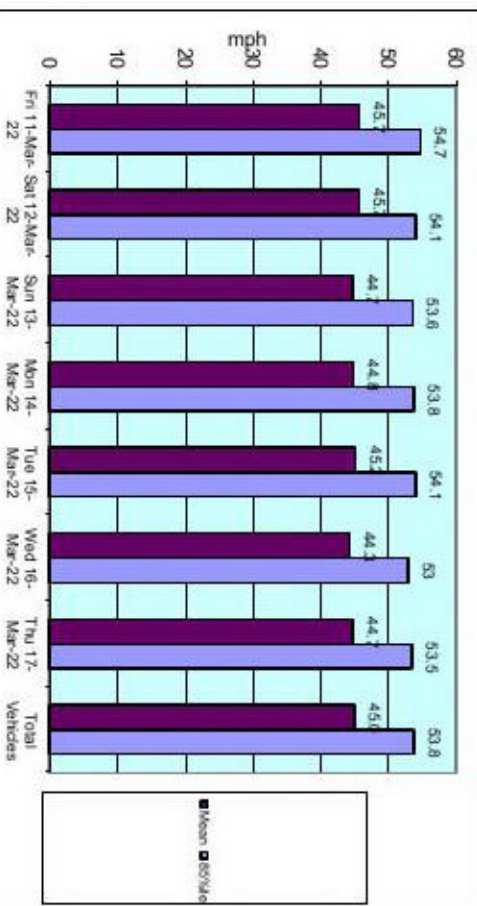
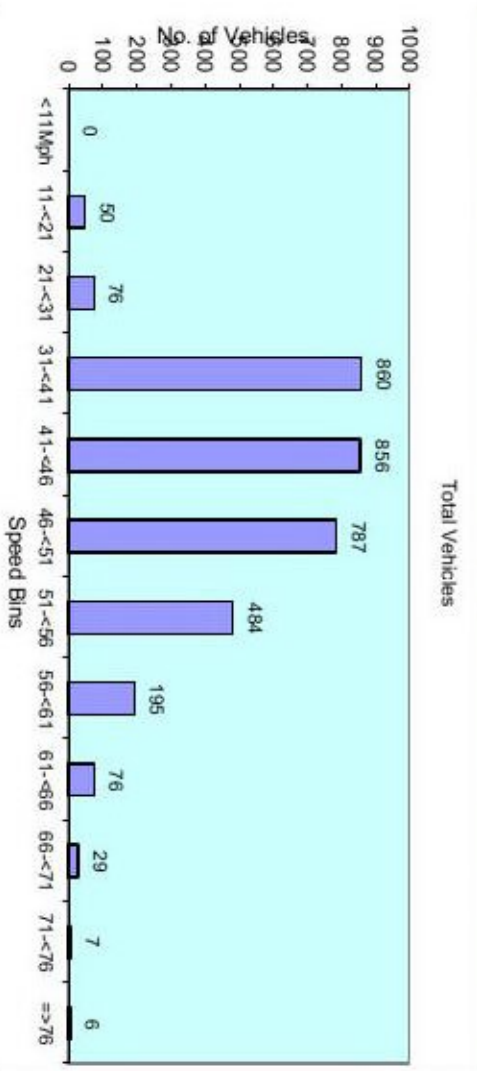

11174 WIX Site No: 11174001 Location Oakley Rd, Wix (att to T/Pole)
 Channel: Westbound

Week Begin: 11-Mar-22

TIME PERIOD	11/03/2022	12/03/2022	13/03/2022	14/03/2022	15/03/2022	16/03/2022	17/03/2022	5-Day Av	7-Day Av
00:00	1	0	1	0	0	0	0	0	0
01:00	2	1	1	1	0	0	0	1	1
02:00	0	0	0	0	0	0	0	0	0
03:00	2	2	1	2	1	2	2	2	2
04:00	4	3	0	8	6	7	9	7	5
05:00	15	9	6	13	15	16	7	13	12
06:00	31	10	4	33	34	36	33	33	26
07:00	60	10	13	70	68	76	62	67	51
08:00	57	33	21	54	60	64	71	61	51
09:00	46	41	29	36	33	40	38	39	38
10:00	34	31	45	32	28	48	34	35	36
11:00	27	40	32	22	30	22	32	27	29
12:00	42	43	31	29	29	30	32	32	34
13:00	33	34	25	27	40	33	26	32	31
14:00	45	34	25	35	36	28	40	37	35
15:00	33	30	17	27	41	36	38	35	32
16:00	36	23	20	33	38	36	35	36	32
17:00	29	25	17	25	37	25	25	28	26
18:00	21	21	16	27	23	26	29	25	23
19:00	11	13	7	14	8	17	17	13	12
20:00	7	4	7	5	9	5	10	7	7
21:00	4	5	2	5	1	3	3	3	3
22:00	2	8	0	1	0	1	2	1	2
23:00	4	3	2	1	0	1	1	1	2
12H 7-19	463	365	291	417	463	464	462	454	418
16H 6-22	516	397	311	474	515	525	525	511	466
18H 6-24	522	408	313	476	515	527	528	514	470
24H 0-24	546	423	322	500	537	552	546	536	489
Am 07:00	09:00	10:00	07:00	07:00	07:00	07:00	08:00		
Peak	60	41	45	70	68	76	71		
Pm 14:00	12:00	12:00	14:00	15:00	16:00	14:00			
Peak	45	43	31	35	41	36	40		

11174

WIX

Site No: 11174001
Channel: Westbound

Location

Oakley Rd, Wix (att to T/Pole)

TIME PERIOD	11/03/2022	12/03/2022	13/03/2022	14/03/2022	15/03/2022	16/03/2022	17/03/2022	5-Day Av	7-Day Av
Fri									
Sat									
Sun									
Mon									
Tue									
Wed									
Thu									
5-Day Av									
7-Day Av									

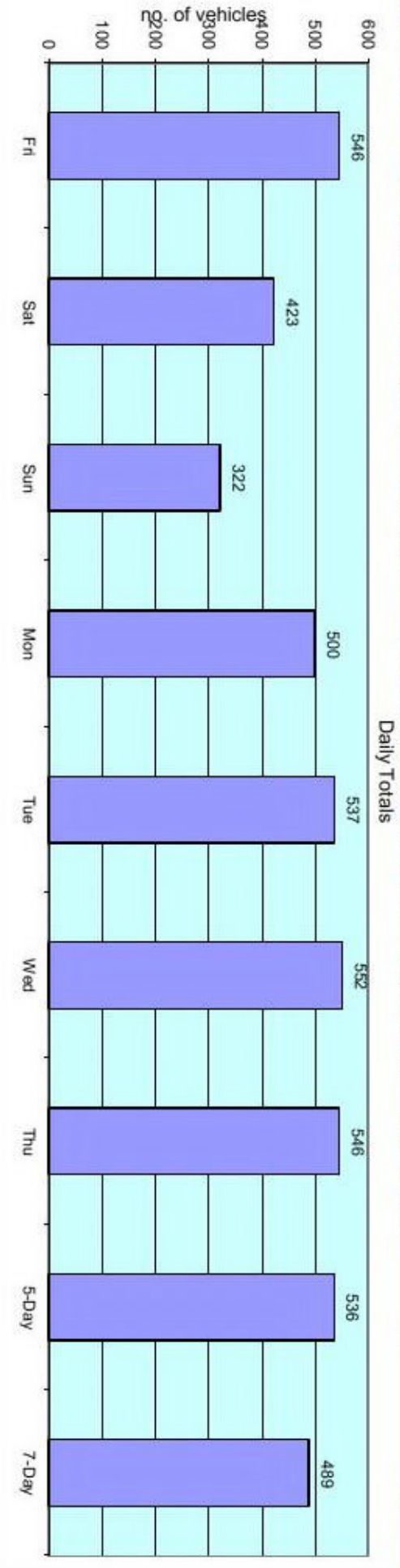

Classification Schemes

Scheme F Classification Scheme (Non-metric)

Scheme F is an attempt to implement the FHWA's visual classification scheme as an axle-based classification scheme. This is one of several interpretations.

Class	Vehicle Type	No. of Axles	Axle spacing in feet				
			Axle 1 to 2	Axle 2 to 3	Axle 3 to 4	Axle 4 to 5	Axle 5 to 6
1	motorcycle	2	<6.0				
2	passenger car	2	6.0 - 10.0				
	car + 1 axle trailer	3	<10.0	10.0 - 18.0			
	car + 2 axle trailer	4	<10.0		<3.5		
3	pickup	2	10.0 - 15.0				
	pickup + 1 axle trailer	3	10.0 - 15.0	10.0 - 18.0			
	pickup + 2 axle trailer	4	10.0 - 15.0		<3.5		
	pickup + 3 axle trailer	5	9.9 - 15.0			<3.5	
4	Traditional bus/coach	2	>20.0				
	Traditional bus/coach	3	>19.0				
5	single unit truck/bus - dual rear axle	2	14.9 - 20.0			<3.5	
6	3 axle truck	3		<18.0			
7	4 axle truck	4					
8	2S1	3		>18.0			
	2S2	4		>5.0	>3.5		
	3S1	4		<5.0	>10.0		
9	3S2	5		<6.1		3.5 - 8.0	
	5 axle combination	5					
10	6 axle combination	6			3.5 - 5.0		
	3S3	6					
11	2S1-2	5		>6.0			
12	3S1-2	6					>10.0
13	truck	7 or more					

Direction	Recorded 85%ile speed		survey weather conditions	Wet weather design speed (with adjustment where appropriate)			Criteria	reaction time	deceleration rate	gradient	stopping sight distance	bonnet adjusted SSD
	mph	kph		mph	kph	m/s						
Channel: Eastbound	53.6	86.3	dry	51.2	82.3	22.9	MFS	1.5	4.4	0.0	93.5	95.9
Channel: Westbound	53.8	86.6	dry	51.3	82.6	23.0	MFS	1.5	4.4	0.0	94.1	96.5

Appendix D
Approved Access Plans

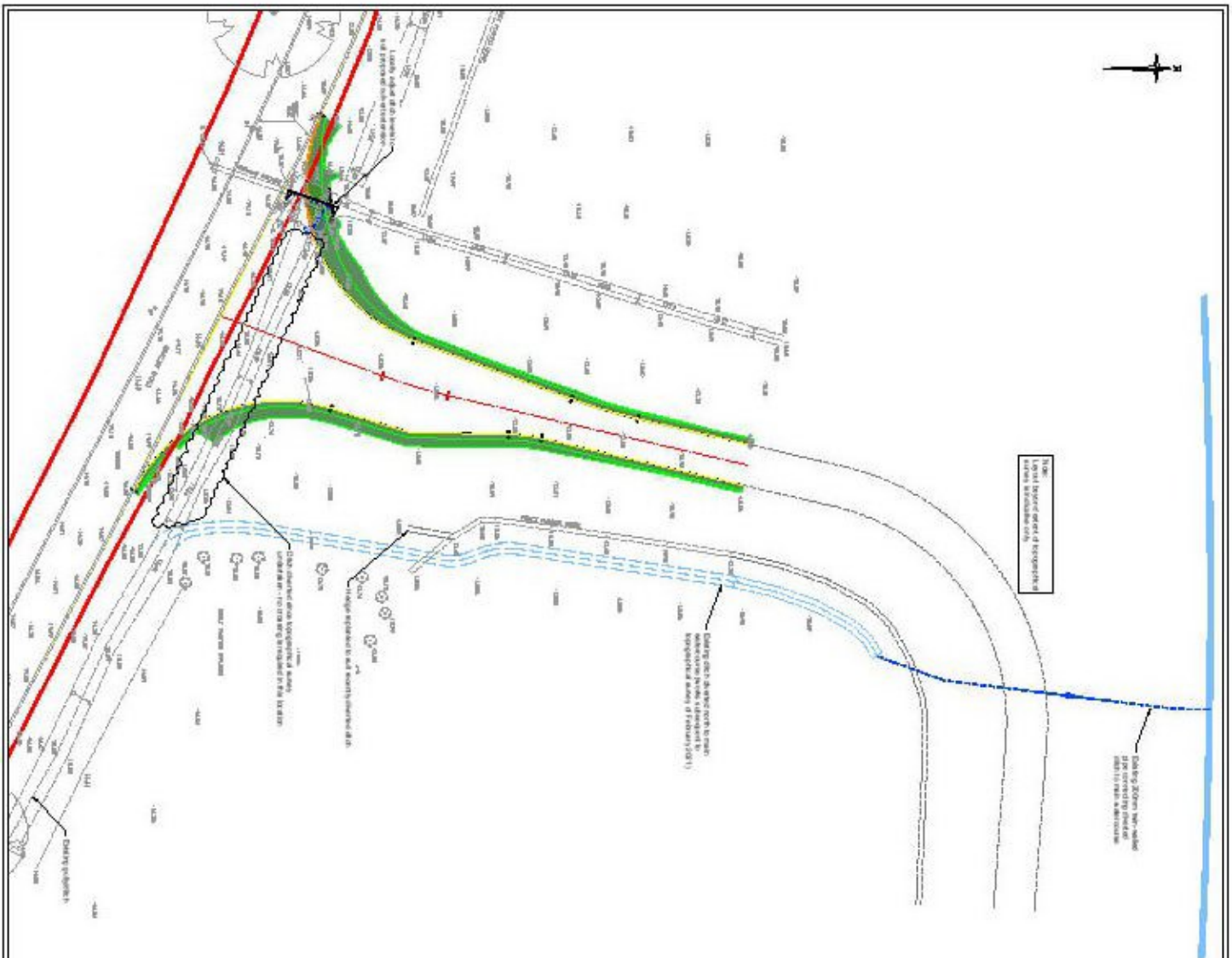

Note: Proposed extent of transportation system boundaries only.

Catch pit zone - see table 2 for covered pit and 3 for open manholes

Catch pit to be removed to meet transportation way of travel (D1)

See construction sequence table and schedule for the project

See schedule for the project

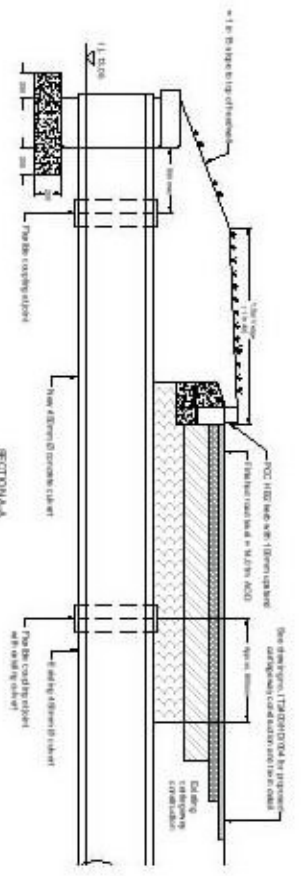

SECTION A-A

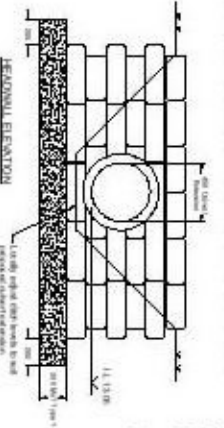

SECTIONAL ELEVATION

1. Invert top of 1.50m x 1.50m
2. Proposed to be level per street level
3. Concrete to be cast in place
4. Report to be reviewed and approved
5. Final design to be reviewed and approved
6. All of the above to be reviewed and approved

NOTE

1. The works to be carried out shall be in accordance with the following:
2. Design and construction shall be in accordance with the following:
3. All construction shall be in accordance with the following:
4. All construction shall be in accordance with the following:
5. The Contractor shall ensure that all construction is in accordance with the following:
6. The Contractor shall ensure that all construction is in accordance with the following:
7. The Contractor shall ensure that all construction is in accordance with the following:
8. The Contractor shall ensure that all construction is in accordance with the following:
9. The Contractor shall ensure that all construction is in accordance with the following:
10. The Contractor shall ensure that all construction is in accordance with the following:
11. The Contractor shall ensure that all construction is in accordance with the following:
12. The Contractor shall ensure that all construction is in accordance with the following:
13. The Contractor shall ensure that all construction is in accordance with the following:
14. The Contractor shall ensure that all construction is in accordance with the following:
15. The Contractor shall ensure that all construction is in accordance with the following:
16. The Contractor shall ensure that all construction is in accordance with the following:

PROPOSED EXTENSION TO OAKLEY ROAD OULVERT		DRAWING NO. 1722101-0-005	
DATE	REVISED	DATE	REVISED
17/03/2021	1	17/03/2021	1
OAKLEY ROAD, WOX		1722101-0-005	
DRAWN BY: [Name]		CHECKED BY: [Name]	
DATE: MAR 2021		DATE: MAR 2021	
SCALE: 1:50		SCALE: 1:50	
PROJECT: HANFORD FARMING		PROJECT: HANFORD FARMING	
DRAWING NO. A1		DRAWING NO. A1	



Appendix E
HGV Tracking Plans



Forester House
Doctor's Lane
Henley-in-Arden
Warwickshire
B95 5AW

