

JELD-WEN JOINERY

YOUR GUIDE TO OUR COMPLETE RANGE OF
DOORS, PATIO DOORSETS, WINDOWS AND STAIRS



www.jeld-wen.co.uk



WINDOW SPECIFICATION COMPARISON GUIDE

This information provides you with a comparison of the specification across our window range. See the 'External Joinery Technical Specification Guide' on our website for more technical detail.

	Elegance Flush Casement	Stormsure Energy+ High Performance Casement	
Specification	Jamb material	Engineered softwood	Engineered softwood
	Frame material	Engineered softwood	Engineered softwood
	Sill material	Engineered softwood	Engineered softwood
	Beading (external)	Timber-composite pinless beading and black gasket on factory paint finished and glazed windows	Timber-composite pinless beading and black gasket on factory paint finished and glazed windows
	Glazing	Double - 24mm Low-E insulating	Triple - 36mm Low-E Insulating
	Spacer bars	Black standard, white & grey optional	Black standard, white & grey optional
	Ventilation detail	Recessed flush fitting vents internally as standard	Recessed flush fitting vents internally as standard
	Bays	Yes	Yes
Operation	Operational detail	Flush casement, side and top hung	Standard casement, side and top hung
	Hardware detail	Espagnolette multi-point locking handle and projecting hinges as standard. Safe clean projecting and fire egress hinges optional	Espagnolette multi-point locking handle and projecting hinges as standard. Safe clean projecting and fire egress hinges optional
	Handles	Inline locking polished chrome standard or white, black, satin chrome, bronze and gold options. Antique black inline and monkey tail handles available.	Inline locking polished chrome standard or white, black, satin chrome, bronze and gold options. Antique black inline and monkey tail handles available.
Dimensions	Frame section size	108mm front to back at head with standard head drip (82mm option without)	96mm from back of head to front of sash (sash sits 3mm proud of frame)
	Sill sizes	Standard 91mm stub sill. Timber nosing options to create overall sizes of - 82mm flush, 132mm, 157mm, 179mm, 207mm	Standard 158mm sill. Timber nosing options to create overall sizes of 93mm stub sill - 67mm flush, 133mm, 183mm, 208mm
	Made to measure options	Yes	Yes
	Brickwork tolerance guidance	12mm	12mm
Finish options	Bar designs	Yes optional	Yes optional
	Ventilator colour	White as standard, brown, grey and green optional, others on request	White as standard, brown, grey and green optional, others on request
Performance	U Values (factory glazed)	1.3-1.4 W/m ² K	0.8-1.0 W/m ² K
	Energy ratings	A and B	A+ and B
	Secured by Design	Yes optional	Yes optional
	Approved Document Q	Yes optional	Yes optional
	Exposure rating	2000pa	2000pa
	Air permeability	Class 4	Class 4
	Performance testing	BS6375: Part 1:2009	BS6375: Part 1:2009
	Strength/operation testing	BS6375: Part 2:2009	BS6375: Part 2:2009
	Acoustic performance	Available to 39dB	Available to 40dB
	Responsibility	FSC®	FSC®



Stormsure Oak/Standard Casement & Regency	Regal Box Sash	Sliding Sash
Engineered softwood or oak*	Engineered softwood	Engineered timber facings with extruded spiral balance channels
Engineered softwood or oak*	Engineered softwood	Engineered softwood
Engineered softwood or oak to match frame*	Engineered softwood	Engineered softwood
Timber-composite pinless beading and black gasket on factory paint finished and glazed windows, excluding oak	Timber-composite pinless beading and black gasket on factory paint finished and glazed windows	Timber-composite pinless beading and black gasket on factory paint finished and glazed windows
Double - 24mm Low-E insulating	Double - 24mm Low-E insulating Single glazing available as an option	Double - 24mm Low-E insulating
Black standard, white & grey optional	Black standard, white & grey optional	Black standard, white & grey optional
Recessed flush fitting vents internally as standard	Recessed flush fitting vents internally as standard	Surface mounted vents internally as standard
Yes (excluding oak)	No	Yes
Standard casement, side and top hung	Sliding sashes with counterweight	Spiral balance, tilt in options (exc PAS 24 windows). Assisted lift spiral balance available as a special order
Espagnolette multi-point locking handle and projecting hinges as standard. Safe clean projecting and fire egress hinges optional	Regal fitch catch standard. Optional sash opening restrictor available upon request	Fitch catch locking as standard, non locking available to order. Optional sash opening restrictor available upon request
Inline locking polished chrome standard or white, black, satin chrome, bronze and gold options. Antique black inline and monkey tail handles available.	Polished gold locking fitch standard or chrome option	Polished chrome locking fitch standard or white, black, satin chrome, bronze, gold and antique black options
93mm front to back at head	148mm front to back at the head and sill	168mm front to back at head
Standard 158mm sill. Timber nosing options to create overall sizes of 93mm stub sill - 67mm flush, 133mm, 183mm, 208mm	Standard 148mm sill, the sill sits flush with the face of the box case.	Standard 168mm sill (flush). Timber nosing options to create overall sizes of 196mm or 225mm
Yes	Yes	Yes
12mm	12mm	12mm
Yes optional	Yes optional	Yes optional
White (as standard on softwood), brown (as standard on oak windows) grey and green optional, others on request	White as standard	White as standard, brown optional
1.3-1.4 W/m ² K	1.5 W/m ² K - excluding single glazing	1.4 W/m ² K
A and B	No performance declared	B
Yes optional	Not currently available	Yes optional
Yes optional	Not currently available	Yes optional
2000pa	No performance declared	2000pa
Class 4	No performance declared	Class 2
BS6375: Part 1:2009	No performance declared	BS6375: Part 1:2009
BS6375: Part 2:2009	No performance declared	BS6375: Part 2:2009
Available to 37dB	No performance declared	Available to 31dB
FSC®	FSC®	FSC®

*Excluding Regency

ELEGANCE

FLUSH CASEMENT

The Elegance range is the perfect choice when renovating period properties or building traditionally designed new build homes, particularly in conservation areas. With a sash that sits flush in the frame, this range achieves traditional sightlines without compromising on performance.

Double glazed with low-E glazing and a thick 82mm frame, this engineered softwood timber window instantly adds a contemporary twist and modern energy performance to any property.

This classic range is fitted with high quality ERA hardware including polished chrome handles, robust espagnolette multi-point locking and projecting hinges to provide both a premium finish and a high level of security. PAS 24 specification options are available.

Choose from a variety of bar designs to enhance the look of a property.

Available factory finished in any RAL colour including dual colour options – all with up to 10 years guarantee on the paint finish. See pages 35–37 for all hardware, glazing and finishing options.

For full specification details see page 14.



BAR DESIGN OPTIONS



Non Bar



Victorian Bar



Cottage Bar



Horizontal Bar



Deco Bar



All Bar

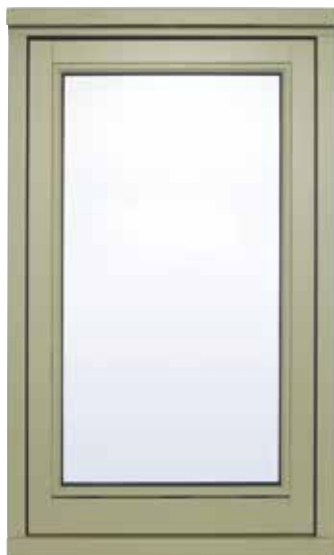

External view



Internal view

SILL & HEAD DETAIL

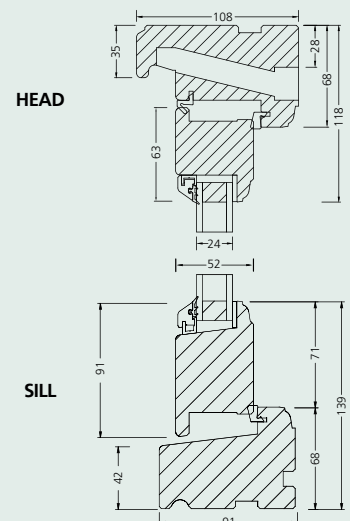

CAVITY CLOSERS

Our BBA certified cavity closer system is an installation option for the JELD-WEN window range and guarantees compliance with Approved Document L of Building Regulations when closing the cavity around the window openings.

Universal closer system

Our standard Universal cavity closer system suits 75mm and 100mm cavities, other sizes as shown are available on a special order. Please specify which ones you need when ordering. Fixing packs are available separately – see price list for details. If using a thin joint mortar construction method, we can supply a thin joint brick tie on special order.

Big Blok closer system

Recognising the need for super insulated homes, we offer a super insulating Big Blok closer which are designed to fit into the larger cavity sizes. Our Big Blok closer system suits 125mm and 150mm cavities and other sizes as shown are available on a special order.

Fire stops

Fire stops are not normally needed in conventional masonry construction but when they are needed we offer the Flameblok cavity closer system. This is a one hour fire rated all in one cavity closer option available to suit 100mm, 125mm and 150mm cavities.

Certification

These are the certification details for our cavity closer systems:

Flameblok Fire certification – Chilt/IF09035 in accordance with general principles of BSEN 1363-1:1999

BBA certification 00/3673

Our cavity closer systems are made from 100% post consumer recycled PVC-U. With an ODP and GWP of zero, this product is ideal to meet sustainable construction standards.

Frame hangers

If you are using cavity closers in a timber frame construction, please check with our technical team to ensure you choose the correct specification. Frame hangers suitable for cavities 50mm and 75mm are available to special order.

When you order a window to fit into a cavity closer, always state this on the order. Cavity closer orders will only be accepted when JELD-WEN windows are being supplied.

Brick fixing ties will automatically be added to your order when ordering a cavity closer system. Please let us know if you do not require them.

You can also order a window fixing pack which includes screws, packers and ties. Ask a member of staff for details.

For bespoke window sizes, orders or further information on all of these systems contact the sales office or view the technical manual on our website.

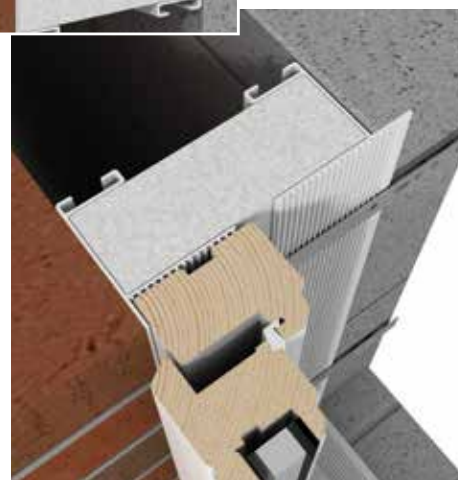
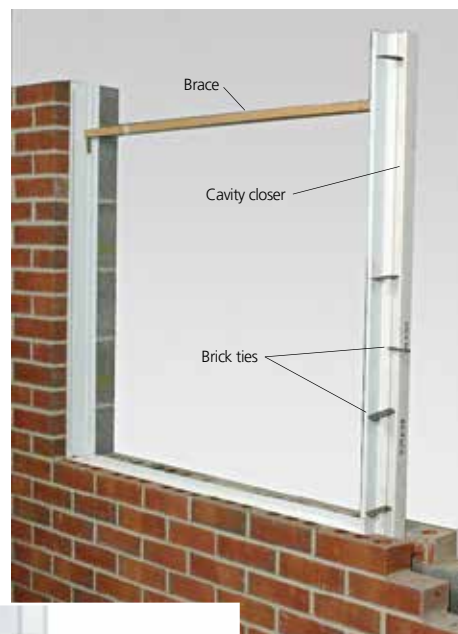

In check installation detail

Examples of brickwork opening sizes for windows when using cavity closers

Actual window size (mm)	Brickwork opening size (mm)
625 x 895	642 x 908
910 x 1045	927 x 1058
1195 x 1195	1212 x 1208
1765 x 1345	1782 x 1358

Cavity opening sizes

	50mm	75mm	100mm	125mm	140mm	150mm	170mm	200mm	300mm
Universal	X	✓	✓	X	X	X	X	X	X
Big Blok	X	X	X	✓	SO	✓	SO	SO	SO
Flameblok	X	X	SO	SO	X	SO	X	X	X
Timber Frame Hangers	SO	SO	X	X	X	X	X	X	X

✓ = available X = not available SO = Special order.
Minimum order value applies.

HARDWARE

JELD-WEN's windows are supplied factory fitted with stylish handles suited to match many of our exterior doorset and patio ranges. All finishes are salt spray tested to 480 hours (BS EN 1670: Class 5) coupled with a 10 year manufacturing guarantee.

ELEGANCE, STORMSURE ENERGY+, STORMSURE STANDARD, STORMSURE OAK AND REGENCY CASEMENT



Hardex Handles
Polished chrome (standard), satin chrome, gold, bronze, white, black, antique black



Hardex Monkey Tail Handle
Antique black
(Specify left/right)



Hardex Monkey Tail Mock Stay
Antique black



Vents
White, grey, conservation green, brown

REGAL BOX SASH



Fitch Catch
Gold (standard), chrome



Sash Lift
Gold (standard), chrome



Gold Ring Pull
Gold (standard), chrome



Vents
White, brown

SLIDING SASH (none SBD options only)



Fastener and Keep
Polished chrome (standard), satin chrome, gold, bronze, white, black, antique black



Sash Lift
Polished chrome (standard), satin chrome, gold, bronze, white, black, antique black

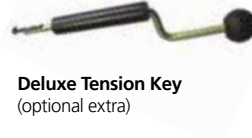

Deluxe Tension Key
(optional extra)



Vents
White, brown

COLOUR REFERENCES

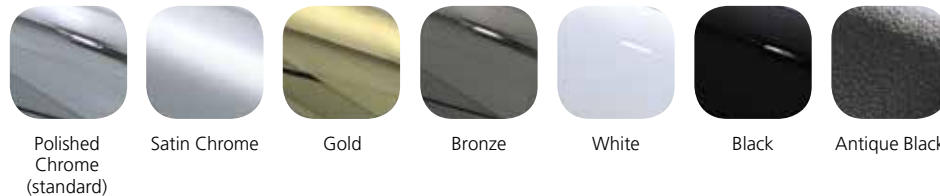

ADDITIONAL HARDWARE



Restrictor
inc. Peg and Packer



Lockable Cord Restrictor
Polished chrome (standard), white and brass



Replacement hardware can be found at:
www.jeld-wen.co.uk

GLAZING & FINISHING

We recommend ordering factory painted and glazed products to ensure they are finished correctly in order to protect and maintain their appearance for as long as possible.

GLAZING OPTIONS

Our glazing units have a 10 year guarantee. The obscure glass options shown below are the most common options, with Cotswold™ glass fitted as the standard. If you want a different specification give us a call to discuss your requirements.

Some of our most popular options are shown below:

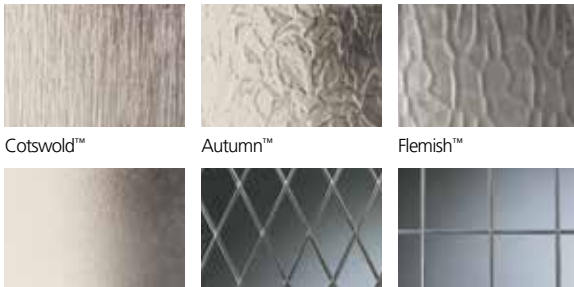

Cotswold™

Autumn™

Flenish™

Stippolyte™

Diamond leaded*

Rectangular leaded*

* Not available with simulated divided lite design

Using 'low emissivity' (low-E) coated glass units helps to reduce the amount of internal condensation, normally produced when warm moist air comes into contact with a cold surface, due to its energy efficient performance compared to conventional uncoated or single glazing. All low-E glass types retain more heat in the home.

Leaded glass is not available for simulated divided lite windows. Leaded lites are supplied to match JELD-WEN standard designs. If you require equal divided designs please specify when ordering.

ENERGY RATED OPTIONS

For windows **Energy rated A** and above will be supplied with Optiwhite™ as standard. This is available as an optional extra on other windows, please enquire.

For windows **Energy rated B** and under will be supplied with Optifloat™ KS as standard.



Optiwhite™

Optifloat™ KS

IMPROVED SOLAR CONTROL

We offer a range of solar controlled glazing options from the range, please call us to discuss your requirements.



Dual colour

BAR DESIGNS

Simulated divided lite has bonded fret bars on the outside and inside with an aluminium integral bar in the glass unit and gives better thermal performance than a traditional divided lite. This is available across the whole window range. The fitted fret has a tolerance of +0mm/-2mm.

Triple glazed windows with bars have timber frets internally and externally however there is no integral bar inside the unit.

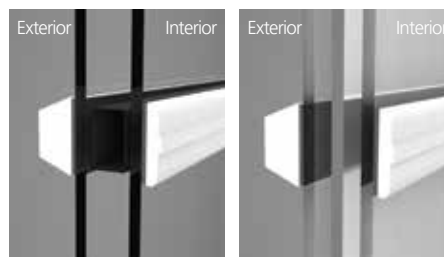

Double glazed simulated bars

Triple glazed simulated bars

Add a splash of colour...

If you want to add a touch of colour to the outside of a property choose from our standard colour palette below. Alternatively, if you don't like any of these you can pick any RAL colour you like!

We also offer dual colour finishing on all casement windows giving you lots to choose from. Dual colour is not available on Sliding Sash and Regal Box Sash windows.

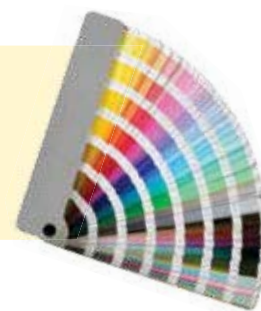

Standard paint options



Primed (Grey)
for site finishing

Hi-Build White
BS 00E 55 (10yr)

Hi-Build paint options



Gardenia
BS 10 B 15 (10yr)

Cream White†
RAL 9001 (8yr)

Buttermilk
BS 10 C 31 (10yr)

Light Ivory†
RAL 1015 (8yr)

Dark Red†
RAL 3001 (6yr)

Pastel Blue†
RAL 5024 (6yr)

Sapphire Blue†
RAL 5003 (6yr)

Turquoise Blue†
RAL 5018 (6yr)



Pastel Green†
RAL 6019 (8yr)

Conservation Green*
BS 12 B 19 (6yr)

Reed Green†
RAL 6013 (6yr)

Forest Green†
RAL 6028 (6yr)

Pebble Grey†
RAL 7032 (6yr)

Stone Grey†
RAL 7030 (6yr)

Powder Grey†
RAL 7040 (6yr)

Dusky Grey*
RAL 7037 (6yr)



Iron Grey†
RAL 7011 (6yr)

Slate Grey†
RAL 7015 (6yr)

Anthracite Grey†
RAL 7016 (6yr)

Black Grey†
RAL 7021 (6yr)

Black†
RAL 9017 (6yr)

*Matching ventilators available at extra cost.
†Minimum order quantity will apply.

Hi-Build stain options

Oak



Golden Oak (6yr)

Dark Oak (6yr)

Softwood



Baltic (6yr)

Basecoat stain for
site finishing

Golden oak (6yr)

Dark oak (6yr)

Baltic (6yr)

Finishing options shown are for guidance purposes only. There may be some variation to the finished product supplied.

FINISHING EXTERNAL JOINERY

It is important that timber products are finished correctly to prolong their life and keep them looking beautiful. We recommend buying fully finished painted or stained windows from us, giving you a great finish that protects and maintains their appearance while saving you the time and cost of finishing them on site.

Products will arrive ready to fit, requiring nothing more than a light clean with a soft sponge and soapy water to retain their condition.

If you do want to finish windows on site, make sure you choose a good quality primer and Hi-Build paint or stain which is microporous to protect the timber, whilst allowing it to breathe. It is essential that windows are finished before you expose them to the elements.

GUARANTEES

Our Hi-Build paint and stains are microporous which allow moisture to be released whilst protecting the timber. We guarantee our paint finishes for up to 10 years on a selection of colours.

Light colours carry a higher warranty than dark colours as they don't absorb the heat as quickly – **see the number in brackets to demonstrate the guarantee period on each colour.** Metallic and fluorescent colour options are not available.

For more information see page 174.

Refer to our website for our full factory finishing and maintenance guidelines.

EXTERIOR DOORSETS & PATIOS SPECIFICATION COMPARISON GUIDE

	INSULUX Timber Composite	Castle Composite – Standard	DreamVu™ – Single and French	
Specification	Door construction	AluClassic® - insulating foam core, laminated veneer lumber stiles and rails. Routed Alutherm facings	Insulating foam core, moulded thermoset GRP skins	Engineered softwood
	Door thickness	55mm	44mm	64mm
	Frame material	Engineered hardwood	Engineered softwood, oak or hardwood	Engineered Softwood
	Sill material	Hardwood standard. Aluminium option	Hardwood standard. Aluminium option	Low level aluminium
	Glazing	Double - 28mm Low-E insulating. Obscure Cotswold™ as standard. 6.8mm laminated/toughened. Other options available	Double - 24mm Low-E insulating. Obscure Cotswold™ as standard. Other options available	28mm toughened/laminated double glazing as standard or triple glazing optional
	Beading	External timber composite pinless beading for painted finishes. Pinned hardwood for stain	Glazing cassette	Timber-composite pinless external beading on factory paint finished and glazed doorsets
	Ventilation	Not available	Not available	No vents as standard
	Spacer bar	Black standard, white and grey optional	Black standard, white and grey optional	Black standard, white and grey optional
Operation	Operational detail	Open in/out left hand or right hand hung	Open in/out left hand or right hand hung	French open in or open out
	Locking detail	Multi-point espagnolette locking. Thumb-turn handle (chrome standard, gold option) with split spindle standard to front doors. Key/Key Vectis lock standard to rear doors	Multi-point espagnolette locking. Key/Key Vectis lock standard. Thumb-turn with split spindle option.	Multi-point espagnolette locking key/key Vectis Plus lock
	Handles	Inline locking polished chrome standard or white, black, brushed chrome, bronze and gold options	Inline locking polished chrome standard or white, black, antique black, brushed chrome, bronze and gold options	Black standard, white and grey optional Inline polished chrome as standard, choice of six colours
Dimensions	Standard or made to measure	Made to measure & standard	Made to measure & standard	Made to measure & standard
	Brickwork tolerance guidance	12mm overall	12mm overall	12mm overall
	Frame section size (inc. head)	50 x 91mm at head	56 x 66mm at head	92mm front to back
	Sill sizes	Timber 170mm standard. Low level aluminium threshold option	Timber 170mm standard, 140mm option. Low level aluminium threshold option	117mm open in, 120mm open out
	Standard doorset sizes (exc side lights) - Min/Max	Width: 854mm/943mm/1006mm Height: 2086mm	Width: Standard - 854mm/943mm/1006mm FD30 - 854mm/930mm/1006mm Height: 2086mm	Single: Width: 844, 920mm / Height: 2088mm French: Width: 1188, 1488 & 1788mm / Height: 2088mm
Side/half side lights/top lights	Optional	Optional on standard only	Width: 300, 450 & 600mm Height: 2088mm Top-lights available	
Finish options	Finish	Factory paint and stain finish to frame and door including dual finish paint options	Door - choice of colours for external face, white internal. Frame - Factory finish options	Factory paint and stain finish to frame and door(s) including dual finish paint options
	Bar designs	Optional	N/A	Optional
	Hardware accessories	Front doors: Chrome security chain, viewer, threshold and rain deflector. Gold option. Polished chrome letter plate to front doors as standard. Colour options see handles. White internal letter plate cowl supplied loose. Rear doors: chain viewer and letter plate optional	Front doors: Chrome security chain, viewer, threshold and rain deflector. Gold option. Polished chrome letter plate to front doors as standard. Colour options see handles. White internal letter plate cowl supplied loose. Rear doors: chain viewer and letter plate optional	Chrome threshold & rain deflector as standard, gold option. Handles supplied loose for fitting on site.
Performance	U values (factory glazed)	1.2-1.6 W/m²K	1.0-2.0 W/m²K	1.1 -1.5 W/m²K
	Secured by Design	Standard	Optional	Standard
	Approved Document Q	Standard	Optional	Standard
	Approved Document M - M1	943mm and above	943mm and above	Single - 961mm and above
	Exposure rating	800X	800X	800X
	Air permeability	Class 4	Class 2	Class 3
	Wind loading	Class C4	Class C2/C3	Class C2/C3
	Performance testing	BS6375: Part 1:2009	BS6375: Part 1:2009	BS6375: Part 1:2009
	Strength/operation testing	BS6375: Part 2&3:2009	BS6375: Part 2&3:2009	Single: BS6375: Part 2&3:2009 French: BS6315: Part 2
	Acoustic performance	No performance declared	No performance declared	Up to 34dB
Responsibility	FSC®	FSC®	FSC®	

FS* = Folding Sliding

This information provides you with a comparison of the specification across our exterior doorset and patio ranges. See the 'External Joinery Technical Specification Guide' on our website for more technical detail.

Farndale – Single and French	Canberra – French and Folding Sliding	Darwin – French and Folding Sliding	Fenton – Sliding
Engineered softwood	Solid oak laminate	Solid hardwood laminate	Engineered softwood
54mm	54mm	54mm	54mm
Engineered softwood	Oak veneer	Solid hardwood laminate	Engineered softwood
Hardwood standard	Aluminium and timber	Aluminium and timber	Aluminium and timber
28mm toughened double or triple glazing	28mm toughened double glazing and triple glazing options	28mm toughened double glazing and triple glazing options	26mm toughened double glazing with leaded design option available
Timber-composite pinless external beading on factory paint finished and glazed doorsets	Fully finished oak bead. Externally pinned	External timber composite pinless beading for painted finishes. Pinned hardwood for stain	Externally beaded
Trickle ventilation through head of the door top rail. White as standard, brown, grey, green optional	Trickle ventilation through head of the door top rail. Brown	Trickle ventilation through head of the door top rail. White as standard, grey, green and brown optional	Trickle ventilation through head of the fixed door top rail. White as standard
Black standard, white and grey optional	Black standard, white and grey optional	Black standard, white and grey optional	Black standard, white and grey optional
French open in or open out	Top hung folding sliding or French open out options	Top hung folding sliding or French open out options	Sliding double or single left hand or right hand doors on smooth nylon runners
Multi-point espagnolette locking key/key Vectis Plus lock	Multi-point espagnolette locking key/key or key/thumb depending on configuration	Multi-point espagnolette locking key/key or key/thumb depending on configuration	4 point bolt locking system
Inline polished chrome as standard, choice of six colours	Inline polished chrome as standard, choice of six colours	Inline polished chrome as standard, choice of six colours	Brushed chrome
Made to measure & standard	Folding Sliding: made to measure & standard French: standard only	Folding Sliding: made to measure & standard French: standard only	Standard only
12mm overall	12mm overall	12mm overall	12mm overall
91mm front to back	FS* 139mm front to back, French 91mm	FS* 139mm front to back, French 91mm	137mm front to back
170mm	190mm - Folding Sliding, 170mm - French 170mm - Side lights	190mm - Folding Sliding, 170mm - French 170mm - Side lights	166mm
Single - Width: 844, 930mm / Height: 2088mm French - Width: 1188, 1488 & 1788mm / Height: 2088mm	FS: Width: 1794-4794mm / Height: 1944-2094mm French - Width: 1194, 1494, 1794mm /Height: 2094mm	FS: Width: 1794-4794mm / Height: 1944-2094mm French - Width: 1194, 1494, 1794mm /Height: 2094mm	Width (exc sidelights) - Single: 1588, 1788, 2088, 2388 / Double: 3576, 4176, 4776mm Height - 2088mm
Width: 300, 450 & 600mm Height: 2088mm Top-lights available	Width: 300, 450 and 600mm Height: 2094mm	Width: 300, 450 and 600mm Height: 2094mm	Width: 968, 1118 & 1268mm Height: 2088mm
Factory paint and stain finish to frame and door(s) including dual finish paint options	Factory paint and stain finish to frame and doors	Factory paint and stain finish to frame and doors	Factory paint and stain finish to frame and doors
Optional	Optional	Optional	Optional
Chrome threshold & rain deflector as standard, gold option	FS: Brushed steel hardware as standard, Titanium or Gold options French: thresholds, rain deflector polished chrome or Gold options	FS: Brushed steel hardware as standard, Titanium or Gold options French - thresholds, rain deflector polished chrome or Gold options	N/A
1.2 -1.6 W/m ² K	Folding Sliding: 1.3-1.7 W/m ² K French: 1.3-1.6 W/m ² K	Folding Sliding: 1.3-1.7 W/m ² K French: 1.3-1.6 W/m ² K	1.4 -1.5 W/m ² K
Optional	Folding Sliding: optional French: optional	Folding Sliding: optional French: optional	Not available
Optional	Optional	Optional	Not available
Single - 952mm and above	N/A	N/A	N/A
800X	800X	800X	No performance declared
Class 3	Class 3	Class 3	No performance declared
Class C2	Class C2	Class C2	Class C3
BS6375: Part 1:2009	BS6375: Part 1:2009	BS6375: Part 1:2009	No performance declared
Single: BS6375: Part 2&3:2009 French: BS6315: Part 2	No performance declared	No performance declared	No performance declared
Up to 31dB	No performance declared	No performance declared	No performance declared
FSC®	FSC®	FSC®	FSC®

FARNDALE

SOFTWOOD DOORSET

The Farndale softwood single doorset features an attractive, contemporary design, with slim timber sections to maximise the glazed area, helping to create a light airy living space.

With 54mm thick door leaves and 28mm double or triple glazing the Farndale doorset offers U values down to 1.2 W/m^2K .

Supplied with high quality ERA hardware including Vectis locking system with cylinder-free multi-point locking (handles supplied loose for fitting on site). PAS 24 specification options are available, to meet the requirements of Approved Document Q and Secured by Design.

Available factory finished in any RAL colour including the option for a dual colour finish, with a choice of glazing and hardware colours. For Hi-Build paint and stain options see page 74–75.

Select from a range of standard sizes shown opposite with side lights to match, or if you have a specific size requirement you can order the Farndale doorset made to measure to suit. Available left or right hand hung with 'open in' or 'open out' options.

For the full suite of products for your project you can also order a Farndale French doorset, see page 64 for details.

For full specification details see page 42.



Single doorset

AS LOW AS
1.2
U-VALUE W/m^2K

ANY
RAL
COLOUR

PAS 24/SBD
STANDARD

MADE TO
MEASURE

54mm
DOOR
LEAVES

BAR OPTIONS & SIDE LIGHT VARIATIONS

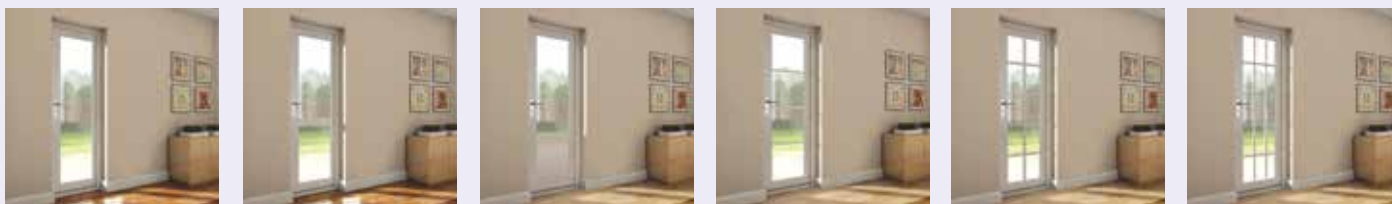

Non bar

Midrail

Midrail with bottom panel

4 light glazing

10 light glazing

15 light glazing

Side light variations

Depending on the width of your chosen side light, the vertical bars may not replicate the bars on the doorleaves. These diagrams illustrate how the bars on the side light vary depending on the width of the side light/s. These variations apply to both single and double side lights.

4 Light (Pattern 70)

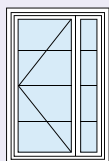

The side light is identical for all 300, 450 or 600mm widths.

10 Light (Pattern SC)

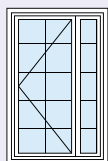

300mm side light

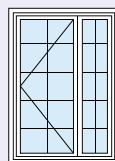

450, 600mm side light

15 Light (Pattern SA)

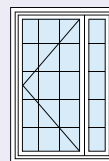

300mm side light

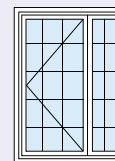

450mm side light

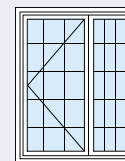

600mm side light

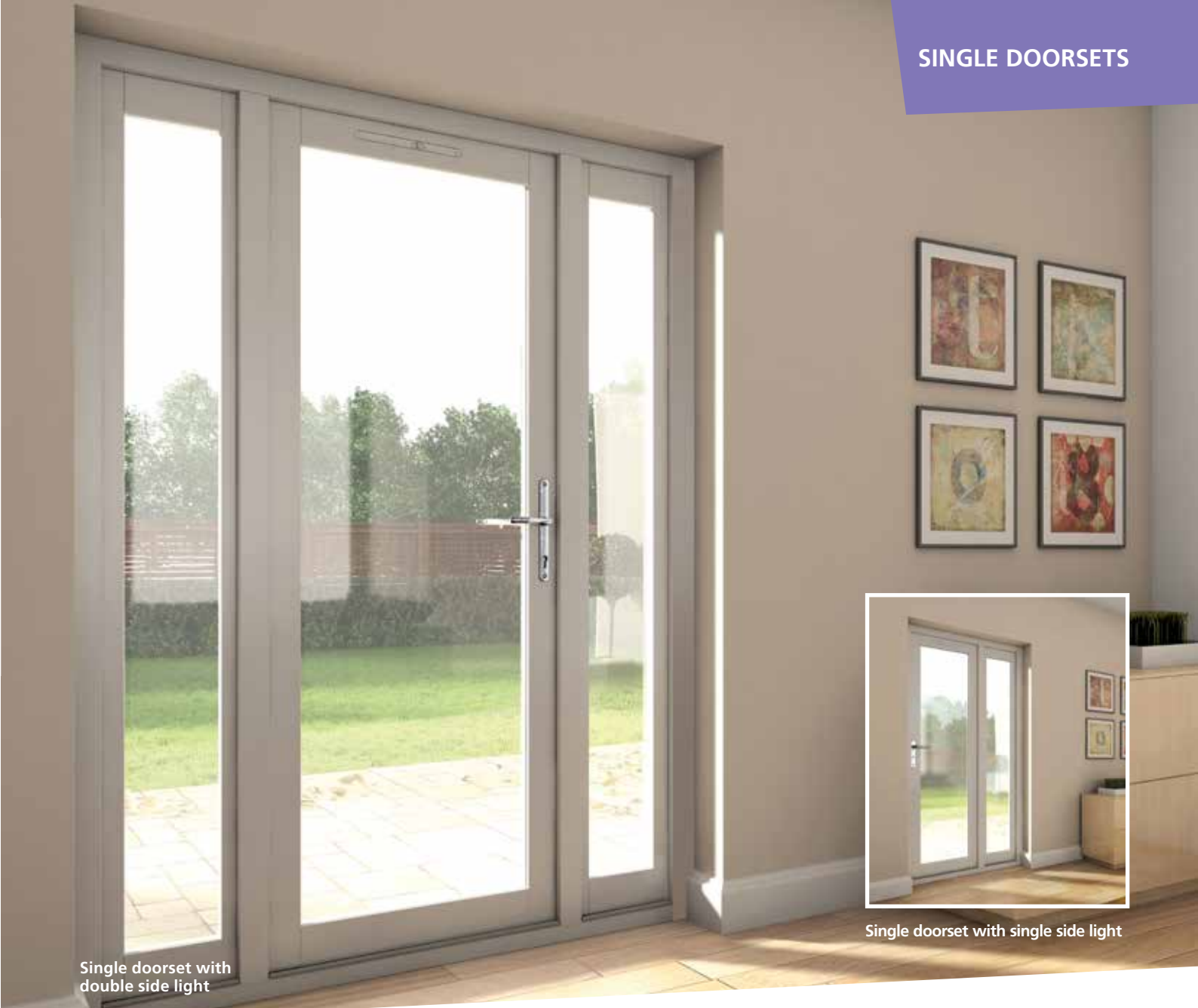

Single doorset with double side light

Single doorset with single side light

Single Doorset - open out (open in available)

Frame Size (mm) WxH	Doorleaf Width (mm)	PAS 24 Security Tested	
844x2088	750		FR8X-SFF
844x2088	750	✓	FR8XSBD-SFF
920x2088	836		FR9X-SFF
920x2088	836	✓	FR9XSBD-SFF

Single Doorset with Double Side Light - open out (open in available)

Overall Frame Size (mm) WxH	Doorleaf Width (mm)	Side Light (mm)	
1144x2088	750	300	FR8X3SS-SFF
1220x2088	836	300	FR9X3SS-SFF
1294x2088	750	450	FR8X4SS-SFF
1370x2088	836	450	FR9X4SS-SFF
1444x2088	750	600	FR8X6SS-SFF
1520x2088	836	600	FR9X6SS-SFF

Doorset U value 1.5W/m²K.

Single Doorset with Single Side Light - open out (open in available)

	Overall Frame Size (mm) WxH	Doorleaf Width (mm)	Side Light (mm)	
LEFT SIDE LIGHT	1144x2088	750	300	FR8X3S/A-SFF
	1220x2088	836	300	FR9X3S/A-SFF
	1294x2088	750	450	FR8X4S/A-SFF
	1370x2088	836	450	FR9X4S/A-SFF
	1444x2088	750	600	FR8X6S/A-SFF
	1520x2088	836	600	FR9X6S/A-SFF
RIGHT SIDE LIGHT	1144x2088	750	300	FR8X3S/O-SFF
	1220x2088	836	300	FR9X3S/O-SFF
	1294x2088	750	450	FR8X4S/O-SFF
	1370x2088	836	450	FR9X4S/O-SFF
	1444x2088	750	600	FR8X6S/O-SFF
	1520x2088	836	600	FR9X6S/O-SFF

Table Guide

Note: All codes shown on this page are for 'open-out' doorsets. For an 'open-in' doorset, please replace the 'X' for an 'N', i.e. FR8X becomes FR8N. Specify on your order 'open-in' or 'open-out' doorset, configuration and handing. Sill depth is 170mm.

HARDWARE

Our INSULUX, Castle, Canberra, Darwin, DreamVu™ and Farndale doorsets, offer the full suited colour options for you and your customers. Polished chrome is the standard colour option, but you can choose from any shown below.

INSULUX, CASTLE, CANBERRA, DARWIN, DREAMVU™ & FARNDALE



Hardex Handles
Polished chrome (standard), satin chrome, gold, bronze, white, black, antique black

FENTON



Brushed chrome locking handle, left or right.
Tandem rollers.

INSULUX & CASTLE



Letter Plates
Polished chrome, satin chrome, gold, bronze, white, black, antique black



Urn Door Knocker
Polished chrome, satin chrome, gold, bronze, white, black, antique black



Viewer
Chrome, gold



Security Chain
Chrome, gold

COLOUR REFERENCES



Polished Chrome (standard)

Satin Chrome

Gold

Bronze

White

Black

Antique Black



Replacement hardware can be found at:
www.jeld-wen.co.uk



Darwin French,
Reed Green RAL 6013

GLAZING & FINISHING

We recommend ordering factory painted and glazed products to ensure they are finished correctly in order to protect and maintain their appearance for as long as possible.

GLAZING OPTIONS

Our doorsets are factory fitted in a choice of glass designs and come with a 10 year guarantee. The obscure glass options shown are the most common options with Cotswold™ as the standard, but if you want a different specification give us a call to discuss your requirements, some of the most popular options are shown below:



Cotswold™

Autumn™

Flemish™



Stippolyte™

Diamond leaded*

Rectangular leaded*

* Not available with simulated divided lite design.

Using 'low emissivity' (low-E) coated glass units (to EN1279 Pt3) as standard which helps to reduce the amount of internal condensation, normally produced when warm moist air comes into contact with a cold surface, due to its energy efficient performance compared to conventional uncoated or single glazing. All low-E glass types retain more heat in the home.

FINISHING EXTERNAL JOINERY

It is important that timber products are finished correctly to prolong their life and keep them looking beautiful. We recommend buying fully finished painted or stained doorsets from us, to give a great finish that protects and maintains their appearance for as long as possible and also saves in added decorating costs.

Products will arrive ready to fit, requiring nothing more than a light clean with a soft sponge and soapy water to retain their condition for quite some time.

If you do want to finish your own products, make sure you choose a good quality primer and Hi-Build paint or stain which is microporous to protect the timber whilst allowing it to breathe. You must finish your products before you expose them to the elements.

Refer to our website for more detail on finishing and maintenance of our products.

Add a splash of colour...

If you want to add a touch of colour to the outside of a property choose from our standard colour palette below. Alternatively, if you don't like any of these you can pick any RAL colour you like!

We also offer dual colour finishing on the INSULUX, Darwin, DreamVu™ and Farndale doorset ranges, giving you lots to choose from.



Standard paint options



Primed (Grey)
for site finishing

Hi-Build White
BS 00E 55 (10yr)

Hi-Build paint options



Gardenia
BS 10 B 15 (10yr)

Cream White†
RAL 9001 (8yr)

Buttermilk
BS 10 C 31 (10yr)

Light Ivory†
RAL 1015 (8yr)

Dark Red†
RAL 3001 (6yr)

Pastel Blue†
RAL 5024 (6yr)

Sapphire Blue†
RAL 5003 (6yr)

Turquoise Blue†
RAL 5018 (6yr)



Pastel Green†
RAL 6019 (8yr)

Conservation Green*
BS 12 B 19 (6yr)

Reed Green†
RAL 6013 (6yr)

Forest Green†
RAL 6028 (6yr)

Pebble Grey†
RAL 7032 (6yr)

Stone Grey†
RAL 7030 (6yr)

Powder Grey†
RAL 7040 (6yr)

Dusky Grey*
RAL 7037 (6yr)



Iron Grey†
RAL 7011 (6yr)

Slate Grey†
RAL 7015 (6yr)

Anthracite Grey†
RAL 7016 (6yr)

Black Grey†
RAL 7021 (6yr)

Black†
RAL 9017 (6yr)

*Matching ventilators available at extra cost for Farndale and DreamVu™ doorsets.

†Minimum order quantity will apply.

Hi-Build stain options

Oak



Golden Oak (6yr)

Dark Oak (6yr)

Hardwood



Baltic (6yr)



Golden Oak (6yr)



Dark Oak (6yr)

Softwood



Basecoat stain for
site finishing



Golden Oak (6yr)



Dark Oak (6yr)



Baltic (6yr)

Castle composite – exterior face colour options

All doors supplied with a white interior finish.

Through colours



Black

Blue

Green

Red

White

Stained effect



Golden Oak

Rosewood

Finishing options shown are for guidance purposes only. There may be some variation to the finished product supplied.

GUARANTEES

Our Hi-Build paint and stains are microporous which allow moisture to be released whilst protecting the timber. We guarantee our paint finishes for up to 10 years on a selection of colours.

Light colours carry a higher warranty than dark colours as they don't absorb the heat as quickly – **see the number in brackets to demonstrate the guarantee period on each colour.** Metallic and fluorescent colour options are not available. See page 174 for more information.

EXTERIOR DOORS TECHNICAL INFORMATION

CONSTRUCTION

Our exterior door constructions vary by material type. Full details for each range are listed below.



White Oak 44mm thick

Made using a solid core that gives a door a substantial feel. You can also fix ironmongery anywhere across the surface of the door. The weight is approximately 40kg.

Hemlock Unglazed 44mm thick

Made using solid hemlock and ready for glazing. You can also fix ironmongery anywhere across the surface of the door. The weight is approximately 30kg.

Redwood Unglazed 44mm thick

Made using solid redwood and ready for glazing. You can also fix ironmongery anywhere across the surface of the door. The weight is approximately 30kg.

Boarded FLB & LB 44mm thick

Made using v-jointed European softwood tongue and groove boards. You can also fix ironmongery anywhere across the surface of the door. The weight is approximately 27kg.

Paint Grade Standard 44mm thick

Made using a solid core that gives a door a substantial feel. You can also fix ironmongery anywhere across the surface of the door. The weight is approximately 35kg.

Paint Grade Standard & FD30 Fire 44mm thick

Tubeboard construction 30 minute fire doors to fit existing frames. Ideal for upgrading from standard doors to fire doors and ironmongery can be placed anywhere across the surface of the door. The weight is approximately 32kg.

STORAGE

Store doors flat in dry conditions on three equally spaced lever bearers. Plastic wrapping should remain on the door until ready for finishing and installing.



TRIMMING

White Oak doors have a maximum trim allowance of 10mm on all four edges. Hemlock and Redwood doors have an allowance of 8mm on all four edges. Paint Grade doors allow for 4mm on the long edges, 6mm bottom edge, the top edge must not be trimmed.



Fire doors should not be trimmed at the top as this provides a unique traceable label. Please refer to our product data sheets available at jeld-wen.co.uk

Trimming more than the specified allowance will void the product guarantees.

GLAZING OPTIONS

Glazed White Oak doors are supplied with 14mm glass in a choice of clear or decorative designs.

Glazed Paint Grade doors feature 6mm clear wired glass.



DECORATION

White Oak and Hemlock doors are supplied unfinished, ready for finishing with Hi-Build microporous paint or stain only.

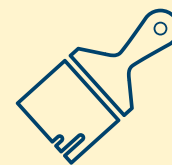

Redwood boarded and Paint Grade doors are suitable for Hi-Build microporous paint only.

GENERAL SPECIFICATION

Timber type

We have a sustainable, renewable timber sourcing policy and maintain FSC® and PEFC multi-site chain of custody certifications, both dedicated to promoting responsible forest management. All timber complies with the requirements of BS EN 942 2007.

We offer oak, hardwood and softwood timber options across our range which is either finger jointed engineered, knotty (door frames only) or laminated engineered timber.

Due to the construction of engineered timber:

- finger/laminate joints maybe visible on the finished product.
- visible grain can vary between individual engineered sections.
- timber is a natural product and will swell or shrink to varying degrees dependent on location etc.

Finger jointed engineered

Finger jointed engineered timber has all the benefits of being a natural material, except it has all of its natural defects removed such as knots and splits. The engineering of the component reduces the risk of twisting and warping, allowing the product to operate as designed.

Knotty

Knotty timber is used in door frames and gives a natural grain pattern to achieve a high quality finish. Knots are visible in this type of timber, which need treatment before finishing as described in our fitting instructions.

Laminated engineered

Laminated timber is another form of engineered timber with finger joints. The timber has all knots and splits removed from the component and it is laminated with glue under high pressure, producing a stable and strong component.

Engineered

Can be finger jointed, laminated or finger jointed and laminated timber.

Oak veneer

Oak veneer is a thin layer of oak applied to the surface of some of our products. The interior components are usually made from engineered timber or particle-board to give it strength and weight

Glazing

Glazing is undertaken in controlled factory conditions which provide quality and adherence to correct glazing practices in line with BS 6262 standard. This includes a 5mm clearance between the edge of the glass unit and the rebate to assist with drainage and ventilation commonly referred to as a drained and vented glazing system.

We recommend ordering factory finished glazed windows to ensure windows comply with legislation and are at recommended standards for the best overall performance.

We recommend using toughened or laminated glass around low level areas or in areas that need extra safety. We also offer extra security through enhancements on products to comply with Approved Document Q and Secured by Design.

All safety glazing and insulating glass units are marked with the appropriate identification to ensure correct, safe installation and permanent traceability. See *diagram opposite (Safety glazing locations)*.

All double and triple insulated glass units in windows and patios where triple glazed options are available, come with either argon or Krypton gas filled cavities.

The type will be determined by the overall thermal performance of the specified windows.

Acoustic windows

Demand has increased for good acoustic performance on windows and doors. JELD-WEN has various specifications of glazing and window designs to meet these requirements. Download the External Joinery Technical Specification Guide on the website for further details.

Acoustic doorsets

Approved Document E of the Building Regulations 2003: Resistance to the Passage of Sound. In situations where a fire resisting door is used as an entrance door for flats into a corridor, it is now required to have a minimum mass per unit area of 25kg/m² or a minimum sound reduction index of 29d BRw.

U Values

Thermal performance is a measure of whole product *U* value not just the value of the centre pane. We have standardised to 1.4W/m²K for our factory glazed standard casement windows but offer a range of *U* values as shown in the product pages which will meet new build and other project and regional requirements. Each of our factory glazed product ranges has it's standard *U* value quoted in accordance with BR 443 or EN 14351-1.

Energy ratings

Offers an alternative method of assessing the energy efficiency and thermal performance. Available as an option across the JELD-WEN window range.

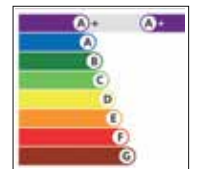

Security

Approved Document Q

Approved Document Q of the Building Regulations for England now details the requirement for security in new dwellings and material change of use. PAS 24 is the product test standard required to meet this regulation. We offer PAS 24 tested options on a selection of our products.

Secured by Design

We offer Secured By Design (SBD) on a selection of our products. This is highlighted on each product page for clarification.

Prior to ordering your SBD products, you should check with the CPDA (Crime Prevention Design Advisors) or ALO (Architectural Liaison Officer) that you are requesting the correct specification.

Performance

JELD-WEN products undergo rigorous testing processes for security, safety, environmental, durability, load bearing and weather resistance to ensure they meet the highest standards.

JELD-WEN products are tested for exposure categories and their performance is declared. It is the customers' responsibility to check that the declared performance meets the requirements for their project. Your architect or specifier should provide you with the required performance figures. With your enquiry please provide the performance levels required for corrosion resistance, wind loading, exposure category and air tightness. If you are unsure of your requirements please contact us. If not specified JELD-WEN will supply the standard product.

Thermal bridging: In certain applications this may result in condensation forming on the products metallic surfaces.

If trickle vents are fitted, please note they are not designed to be fully air tight in the closed position.

Glass units

Defects will only be considered under the standards of the GGF Code of Good Practice. Due to the high thermal properties of insulating glass units, condensation may form on external faces of the glass units if environmental conditions allow.

Safety glazing locations

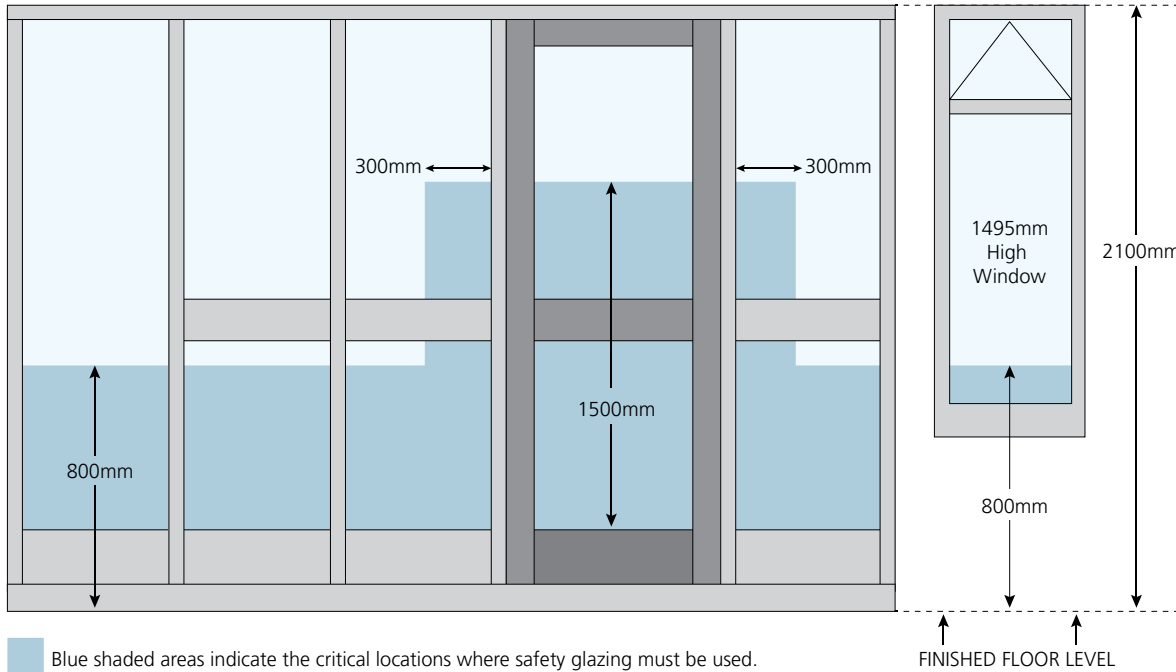

ACCREDITATIONS

We also carry a number of third party accreditations and affiliations including:



Secured by Design (SBD) is the official UK Police flagship initiative supporting the principles of 'designing out crime'. Products have been tested and approved under the scheme wherever you see the logo.



All JELD-WEN fire resisting doors come with the added assurance of the BWF-Certifire third party certification scheme by the British Woodworking Federation. All specifications and manufacturing methods are assessed with periodic inspections and full fire tests for audit purposes providing the evidence necessary for continued compliance.

JELD-WEN stairs are independently assessed by the British Woodworking Federation to guarantee that all staircases meet Building Regulations.



We actively support the development and standards of timber windows and our membership ensures we are performing on quality, performance and sustainability. WWA life cycle assessments confirm that JELD-WEN windows will provide a minimum service life of 60 years.



The TWA Scheme, set up by the British Woodworking Federation, provides one of the most rigorous and best supported of the UK certification schemes for wood windows.



Our timber window, patios and exterior doorset ranges are certified under the BSI Kitemark certification to ensure quality, performance and safety standards.

Quality standards

We understand how important quality is to our customers and therefore continually develop our products and services to achieve the high standards that are expected.

We are formally assessed under quality and environmental practices and all our factories are ISO 9001: 2015 and ISO 14001: 2015 certified. Our products undergo rigorous testing to ensure they can perform to the highest standards when installed.

LEGISLATION

Responsibility

JELD-WEN aspires to be the industry leader in environmentally responsible practices and products. We have committed ourselves to more responsible business practices and environmental stewardship. This affects every aspect of our organisation and governs our approach to energy efficiency, air and water emissions and indoor air quality.

At JELD-WEN we have a responsible, renewable timber sourcing policy and are extremely proud to have received FSC® multi-site chain of custody certification dedicated to promoting responsible forest management.

We have also received PEFC multi-site chain of custody certification. If you want FSC® or PEFC products speak to your local branch or a member of our team to discuss your requirements.

All JELD-WEN products meet the EU Timber regulations which aims to prevent the trade in illegal harvesting of timber.

Biocide Regulation

JELD-WEN exterior joinery is treated with an approved wood preservative and protected against wood decaying fungi.

For all timber windows, door frames, DreamVu™, Farndale & Fenton patio products the active ingredients are tebuconazole, propiconazole and cypermethrin.

For Wellington patio products the active ingredients are Carbamic acid, butyl, 3-iodo-2-propynylester.

For Oakfold products the active ingredients are copper carbonate and Didecyldimethylammonium Chloride.

Preserved wood should not be cut or otherwise reworked as this will expose un-preserved wood. Any surface which is exposed by cutting or drilling must be retreated with an HSE approved cut end preservative. Follow the instructions for safe use on the manufacturers' safety data sheet.

CE Marking

JELD-WEN factory glazed windows and external doorsets have been CE marked as directed under European law on 1 July 2013. CE marking is not required for internal doorsets or staircases at this time.



What is the purpose of CE Marking?

It is the "passport" for products allowing them to be sold legally across the whole of the European Single Market. It is European Law, standing above UK legislation. It also provides tighter control of products and their claimed performance, ensuring products do what they should and completed buildings meet their claimed performance.

What has JELD-WEN done to implement CE Marking?

- Placed the CE mark as a label on each product or packaging
- Provided a Declaration of Performance (DoP) for each product available to download from the website in our download centre which is the legal declaration of its performance.

U Value Declarations

U Values stated are determined by reference to BR 443 or EN14351-1 standard window and doorset dimensions. Window type is single frame and full opening sash.

U Values of windows and doorsets are less than or equal to DoP values.

JELD-WEN recommends that customers buy fully glazed windows to ensure compliance.

For more information about CE Marking visit our website.

The responsibility for correct specification remains with the Building designer (for new build) or the installer (for replacement products). If in any doubt customers should always seek the advice of their Local Authority Building Control Department. There may be other regional differences in requirements not included in the above (Northern Ireland, Channel Islands, etc.). JELD-WEN UK Ltd does not accept any liability for incorrectly specified product and resulting non-compliance with regulations.

FINISHING ADVICE

It is strongly recommended that freshly plastered locations are completely dry and there is no rapid change in humidity when you are installing any timber products. This will avoid excessive moisture penetration or warping. Excessive moisture intake is the most common cause of failure.

EXTERNAL JOINERY

If you prefer to finish your own products, JELD-WEN windows and patio doorsets can be ordered primed or base coat stained. Basecoat stained products can be site finished in paint or stain, primed products can only be finished using Hi-Build microporous paint.

Basecoat stained doorframes will have knotting treatment pre-applied and we recommend further knotting treatment as required.

Final decoration must be completed within 3 months of exposure for primed products and 1 month for stained. **Any unfinished external products including oak must be treated before exposure on site or guarantees become void.**

Owing to the natural properties of timber, the colour may vary across the finished product.

It is essential that doors and frames where applicable are fully sealed on the two faces and ALL edges plus any cut-outs for locks, handles, hinges and letter plates etc in accordance with British Standards. As soon as products are taken out of wrappings they should be fully decorated. Prior to priming or sealing, lightly sand any handling marks or variations and ensure the door is dust free before any treatment. Do not use wire wool or other sanding materials containing steel/iron on our products. Failure to seal products accordingly will invalidate any claims. Ensure door sills are fully finished upon installation.

Use a proprietary branded Hi-Build microporous paint or stain and treat in accordance with the manufacturer's instructions. Note: Redwood boarded doors, garage doors and Paint Grade doors are only suitable for Hi-Build microporous paint finish.

A light sanding between coats will provide the best finish. Adequate drying time must be allowed between the coats and ensure you allow drying time before closing window sashes against frames otherwise you may damage the weather strip next time you open the window.

Think carefully before painting exterior joinery black or other dark colours, as the sun can shorten the lifespan of these finishes making them vulnerable to the elements.

In areas of severe exposure, we suggest covering your external door with a porch, hood or canopy in addition to the decorative protection. Regular maintenance should also be made to stop deterioration of the wood, its construction or the finish.

Take care not to apply paint or stain to weather strips, ironmongery, projecting hinges or moving parts as this may cause lasting damage to the performance of your products.

JELD-WEN external joinery is NOT suitable for varnishes, waxes, polishes, dyes, oils including Danish Oil, yacht varnish or lacquers as these finishes do not protect our products.

INTERNAL JOINERY

As soon as products are taken out of wrappings they should be fully decorated.

Moulded primed doors require decoration using a suitable base coat primer and top coat paint system to the two faces, four edges and cut outs for locks, handles and hinge recesses within 24 hours of fitting, failure to do so may result in the door warping. Adequate drying time must be allowed between the coats.

Flush real wood veneer doors come already finished and are ready to hang. You will need to finish door edges if they are trimmed to fit, in which case we recommend a polyurethane varnish.

Oak timber feature doors and stair parts can be finished with paint, stain, varnish or lacquer, whilst primed timber feature doors can be decorated with a good quality paint to suit your tastes and the style of your property.

JELD-WEN internal joinery is NOT suitable for waxes, polishes, dyes and oils etc. Please refer to manufacturers instructions.

SUGGESTED REDECORATION CYCLES:

For pigmented coating system (e.g. white or pastel colours) applied on timber windows:

Construction	Moderate climate	Hard climate	Extreme climate
Sheltered	10 Years	10 Years	7 Years
Partly sheltered	10 Years	7 Years	5 Years
Unsheltered	7 Years	5 Years	5 Years

For stain and lacquer coating system applied on timber windows:

Construction	Moderate climate	Hard climate	Extreme climate
Sheltered	6 Years	5 Years	3 Years
Partly sheltered	5 Years	3 Years	2 Years*
Unsheltered	3 Years	2 Years*	2 Years*

*Only dark stain allowed.
Golden oak stain 2 years maximum.

Moderate climate: includes non coastal areas at low altitude
Hard climate: includes an area within 5km of coastline
Extreme climate: any area of high altitude or exposed coastal areas

This guide is based on EN927

For further maintenance advice see the External Joinery Technical Specification Guide on our website.

GUARANTEES & MAINTENANCE GUIDELINES

We offer the following guarantees on products. These will become void when surface finishes or faults are caused by wilful or neglectful damage or by excessive wear and tear. Shattering glass due to the thermal stress and other non product related issues are not covered under these guarantees.

Product range	Manufacturing Defects				Rot & Fungal		Glass	Hi-Build Paint			Hi-Build Stain
	1 year	2 years	5 years	10 years	30 years	40 years	10 years	up to 6 years	up to 8 years	up to 10 years	up to 6 years
Casements - Softwood				✓		✓	✓	✓	✓	✓	✓
Casements - White Oak				✓	✓		✓	✓	✓	✓	✓
Sliding Sash & Regal Box Sash				✓		✓	✓	✓	✓	✓	✓
Exterior doorsets				✓			✓	✓	✓	✓	
Canberra & Darwin				✓	✓		✓	✓	✓	✓	✓
DreamVu™, Farndale, Fenton				✓		✓	✓	✓	✓	✓	
Bedgebury & Kinsley		✓									
Interior doors - Moulded/Flush				✓							
Interior doors - Timber Feature			✓								
Exterior doors - White Oak			✓								
Exterior doors - Hemlock				✓							
Exterior doors - Redwood/Garage	✓										
Exterior door frames - Oak				✓	✓						
Exterior door frames - Softwood				✓		✓					
Stairs				✓							

MAINTENANCE

The decoration and finishing of joinery products is covered in BS6150: 2006 'Painting in buildings' and BS8000 Part 12: 1989.

The decorative finish applied to windows, external doors and patio doorsets must be preserved while they are in service to ensure moisture does not penetrate the wood.

JELD-WEN products should be maintained in accordance with the guarantees or the paint or stain manufacturer's guidelines, to prevent the finish from deteriorating and to protect the timber underneath. See the finishing section for advice on paint and stain recommendations.

We recommend the following to maintain and extend the life of your exterior joinery products:

- All joinery should be washed down a minimum of twice a year with a mild solution of soapy water and rinsed off with clean water to remove any surface debris. This should be increased to a minimum four times a year in marine and industrial environments.
- Once cleaned, scrape, lightly sand and touch up any areas of wear and tear with a matching microporous paint or stain. Any bare wood should be primed first.
- All mechanical items, i.e. hinges etc. should such be oiled with grease or neutral oil.
- Weather seals should be checked and cleaned.
- Vents should be cleaned and any blockages removed.
- Timber is a natural product and therefore performs differently through the year, seasonal adjustment may be required to assure ongoing performance.

Do not attempt to paint when temperatures fall below 8°C or if the humidity is above 85% or in direct sunlight as this will impair the curing process.

Interior products should be kept clean and new coats reapplied as necessary of good quality paint, stain, varnish or lacquer. You may need to sand and apply undercoat again first depending on the condition or choice of finish.

MANUFACTURING DEFECTS – JELD-WEN will accept no responsibility for products cut down to size after receipt, or which use or structural strength is impaired following improper fitting.

ROT & FUNGAL – guarantees against rot and fungal attack.

GLASS – guarantee against double and triple glazing unit failure on factory glazed products.

HI-BUILD PAINT AND STAIN – guarantees against factory finished paint and stain coloured products under normal exposure.

The guarantee period for paint and stain will vary according to colour selected and location of installation in line with EN927.

HARDWARE

Hinges, pivots, rivets and other moving parts must never be painted and should be kept clean and lubricated lightly at all times with grease or neutral oil.

Products should be cleaned and lubricated at least once a year - more often in coastal areas and places where pollution is high.

Guarantees will reduce depending on location even if general maintenance advice is undertaken.

JELD-WEN external hardware is tested to BS EN1670:2006 for corrosion resistance and generally achieves 480 hours. Areas such as coastal or industrial may require higher performance. This should be specified at time of order/enquiry. The test exposure time above relates to the amount of time that a component part has been exposed to a neutral salt spray under laboratory conditions. There is no direct correlation between a given number of hours salt spray testing and real time natural environment exposure. If handles are not cleaned and maintained the resistance is impaired.

For accessible cleaning options to the glass on your side hung windows opt for the Reflex Plus projecting hinge in compliance with BS 8213-1:2004. Projecting hinges should not be used on top hung windows for cleaning as this would contravene BS 8213-1:2004 Annex C and Scottish Building Regulations.

WARRANTY TERMS AND CONDITIONS

WARRANTY AND LIMIT OF RESPONSIBILITY

The Customer's attention is particularly drawn to this Condition.

- (a) It is the sole responsibility of the Customer to ensure that all Goods in an order are correct for the Customer's requirements and are used in accordance with, but not limited to, the following:
- (i) all current building regulations including, but not limited to, the Building Act 1984, the Building Regulations 2010 and the Building (Approved Inspectors etc.) Regulations 2010, in each case as updated from time to time;
 - (ii) any regulations regarding fire safety;
 - (iii) Secured By Design and/or Crime Prevention Through Environmental Design requirements of the Customer's local Crime Prevention Design Advisors & Police Architectural Liaison Officers (where applicable); and
 - (iv) any applicable planning permissions and/or consents and any local planning requirements.
- The Company shall have no liability to the Customer in respect of any of the above and by submitting an order the Customer acknowledges and agrees to the above.
- (b) The Company's only warranty to the Buyer in respect of the Goods is the Guarantee. Subject to Condition 12(b), all warranties, conditions and other terms implied by law (whether by statute, common law or otherwise) are excluded from the Contract.
- (c) If any Goods of the Company's manufacture are defective, the Company will (at the Company's choice) either repair or supply replacements, or refund a reasonable proportion of purchase price for the Goods, provided that the Company shall have no liability (including without limitation in negligence) for:-
- (i) apparent defects notified to the Company later than 2 working days from delivery of such Goods to the Customer; or
 - (ii) any latent or other defects notified to the Company later than 14 days after the Customer becomes aware or ought to have become aware of the defect in such Goods from Company's works; or
 - (iii) any latent or other defects notified to the Company outside any guarantee periods given in the Company's then current catalogue at the time of despatch (the 'warranty periods').
- (d) The Company will require a reasonable period of time to carry out any repairs or supply of replacements.
- (e) In relation to Goods not of the Company's manufacture (including but not limited to parts and components supplied by others for Goods manufactured by the Company) the Company will so far as it is able to do so give the Customer the benefit of any express guarantee or warranty by the manufacturer or supplier of such Goods and any of the other rights which the Company has against the manufacturer or supplier.
- (f) The Company shall have no liability (including without limitation in negligence) under Conditions 10(b) to (e) or otherwise to the extent that any defects in the Goods results from a failure of the Customer to comply with the following requirements:-
- (i) all Goods must be stored in a dry place, stacked flat, slightly raised from the ground and adequately protected from the weather. No internal joinery shall be installed in a building, which has not adequately dried out;
 - (ii) all joinery supplied in the white must be suitably primed without delay after receipt and all joinery supplied shall receive further coats of paint within a reasonable period. Joinery supplied with a base-coat of stain must receive further coats as soon as possible, as detailed in the fitting/installing and maintenance instructions provided with the Goods on delivery;
 - (iii) any surface which is exposed by cutting or drilling must be retreated with a HSE approved cut end preservative. Follow the instructions for safe use on the manufacturer's safety data sheet. If required for paint finish, it must also be primed before the joinery is fixed into position;
 - (iv) all joinery shall be installed correctly in accordance with normal trade practices and adequately maintained in service;
 - (v) paintwork or other protective surface finish of external joinery must be maintained in service and excess moisture shall not be allowed to penetrate into the timber;
 - (vi) the Customer must not have fitted, fixed, painted (except where required by the Company and/or the fitting/installing and maintenance instructions provided with the Goods on delivery) or in any way altered the Goods; and
 - (vii) the Customer must have complied with any instructions of the Company relating to the Goods including (but not limited to) all Recommendations and all conditions of any Guarantee.
- (g) Additionally, in the event of any claim under any Guarantee the following provisions shall apply:-
- (i) the Goods to be repaired or replaced shall be made available for collection by the Company at the original point of delivery and the expenses of re-delivery shall also be for the Company's expense;
 - (ii) exchanged Goods will become the property of the Company; and
 - (iii) if any claim is invalid, the Company may make charge to the Customer for any costs and expenses incurred in investigating the claim, recover any refunds given, and charge for any repairs or replacements made.
- (h) The Customer's remedies and the Company's liability in respect of any defects in the Goods shall be limited to the remedies and liability set out in this Condition 10. All replaced or repaired Goods will be warranted for the unexpired portion of the warranty periods set out in the relevant Guarantee.
- (i) Descriptions in the Company's Catalogue (including, without limitation, as to colours, designs, methods of manufacture and specifications) are illustrative only and the Goods delivered may alter from their description. The Company shall be entitled to alter the description of Goods at any time without notification.

To read our full **TERMS AND CONDITIONS OF SALE** go to
jeld-wen.co.uk



JELD-WEN PROVIDES ALL JOINERY PRODUCTS IN THIS CATALOGUE FROM THREE UK ADDRESSES

WINDOWS EXTERIOR DOORSETS PATIO DOORSETS DOOR FRAMES

JELD-WEN UK
Snow Hill
Melton Mowbray
LE13 1PD
E: windowsuk@jeldwen.com

INTERIOR DOORS EXTERIOR DOORS GARAGE DOORS

JELD-WEN UK
Retford Road
Woodhouse Mill
Sheffield
S13 9WH
E: doorsuk@jeldwen.com

STAIRS

JELD-WEN UK
Snow Hill
Melton Mowbray
LE13 1PD
E: stairsuk@jeldwen.com

FOR ALL ENQUIRIES CALL
0845 122 2891

To request additional
JELD-WEN catalogues
go to jeld-wen.co.uk

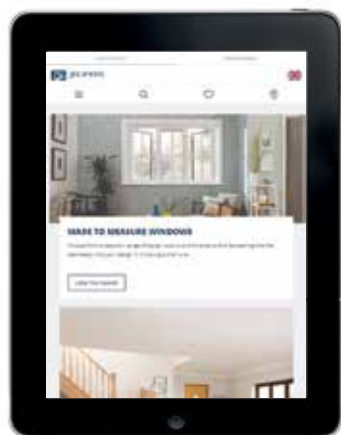

Visit our **NEW WEBSITE**
for further information, fitting
advice and technical guides
jeld-wen.co.uk

