

- NOTES:
1. ALL DIMENSIONS IN mm UNLESS NOTED OTHERWISE.
 2. ALL LEVELS ARE IN m.
 3. EXISTING FENCE IS GALVANISED STEEL STOCK WIRE TYPE SPANNING BETWEEN TIMBER POSTS.
 4. THERE ARE TWO TIMBER POSTS ALONG THE FRONT CURTLAGE AT DISTANCES 9140 AND 8545 FROM A PERPENDICULAR LINE FROM THE STW METER TO THE TRACK THAT FORM THE REFERENCE POINTS OF THE PROPOSED FENCING EXTENTS.
 5. PAST EXTENTS OF PROPOSED INTERVENTIONS EXISTING FENCE SHALL BE RETAINED.
 6. CURTLAGE LINE SHOWN ON THE DRAWING IS THE TRACK SIDE LINE BETWEEN POSTS. PROPOSED FENCING SHALL BE INSTALLED SUCH THAT EXTERIOR FACES OF THE FENCE DO NOT OVER SAIL THE CURTLAGE LINE ALONG THE TRACK.
 7. DRIVEWAY FLAGS WILL HAVE TO BE RELAYED TO SUIT THE NEW GATE ARRANGEMENT. TO BE DETERMINED BY CLIENT TO SUIT FINAL GNERAL ARRANGEMENT.
 8. EXACT LOTION OF BOLLARDS SHALL BE CONFIRMED BY CLIENT.

REV B

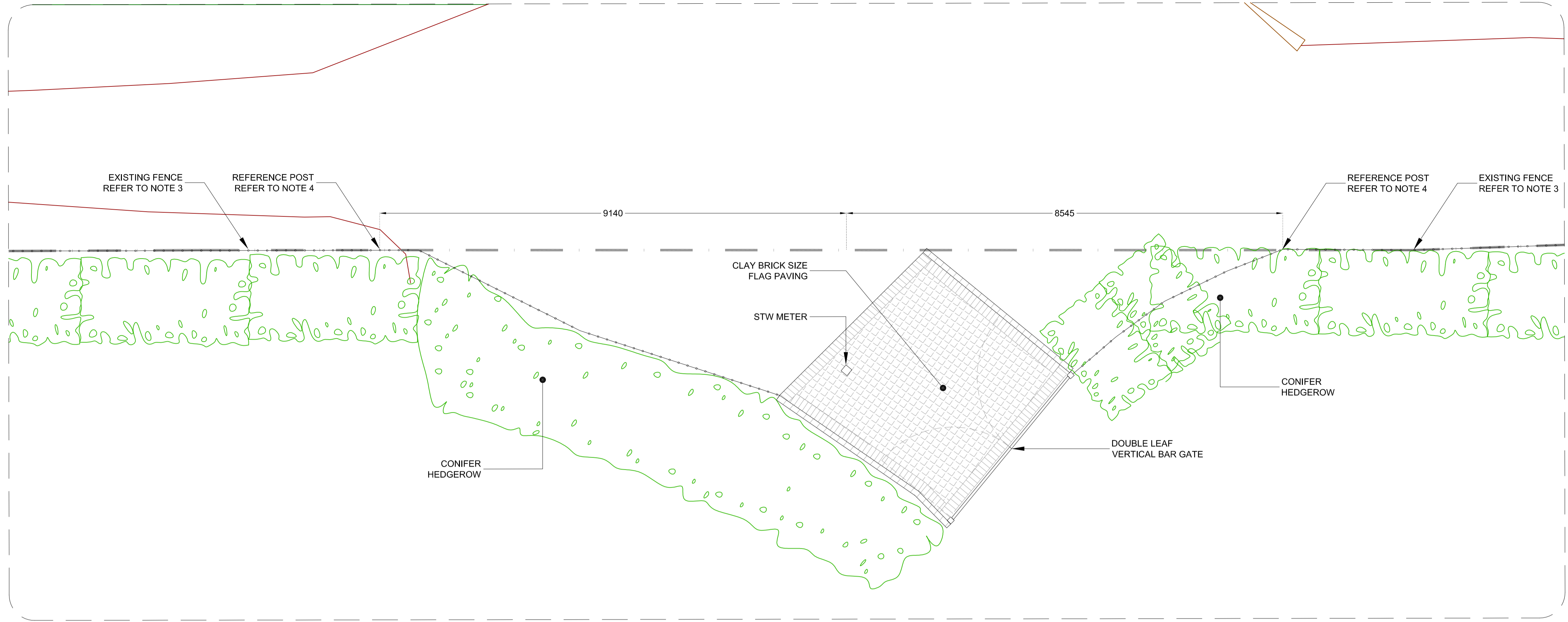

EXISTING FRONT ENTRANCE - PLAN
SCALE 1:50

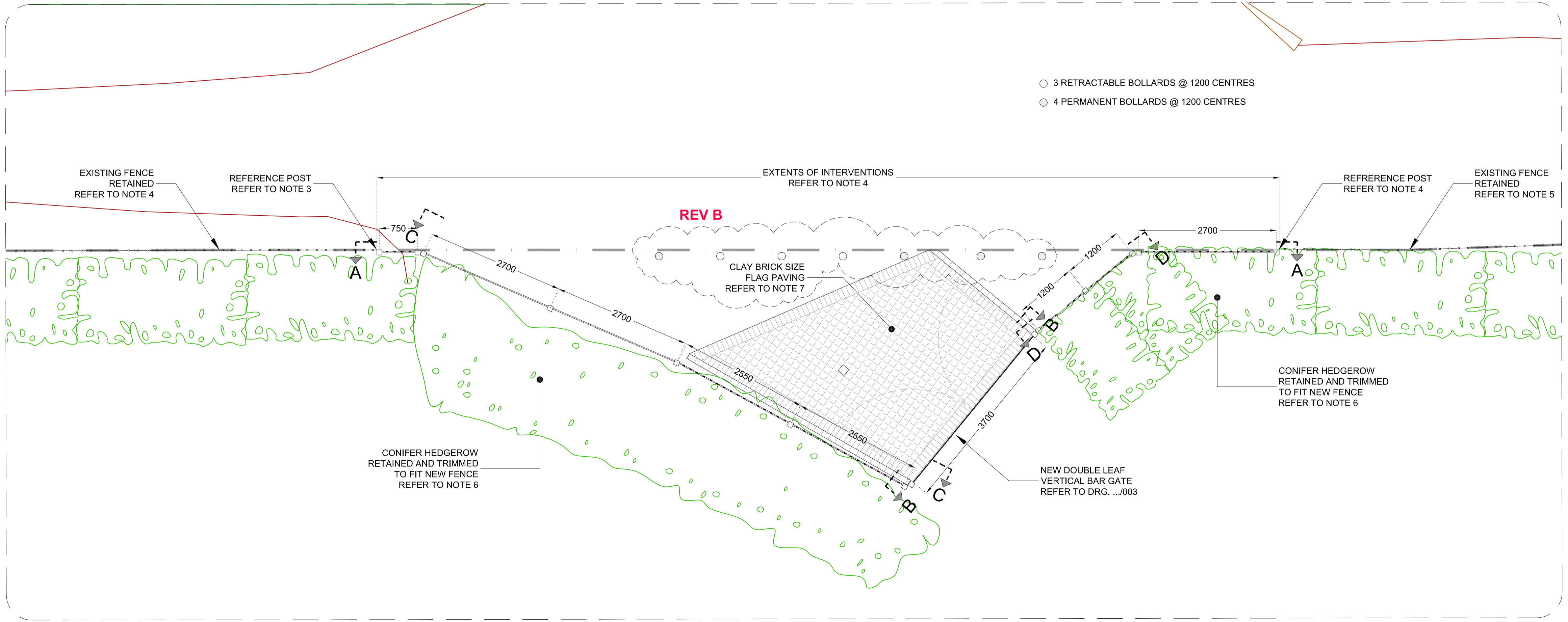

PROPOSED FRONT ENTRANCE - PLAN
SCALE 1:50

B	Notes / bollards	N.M.	E.V.	E.V.	17/05/22
A	Fence line / No. bollards	N.M.	E.V.	E.V.	12/05/22
PA	1st Issue	N.M.	E.V.	E.V.	02/05/22
REV.	MODIFICATION:	DRAWN:	CHECKD:	APPRVD:	DATE:

PROJECT STATUS:
PERMITTED DEVELOPMENT
EVAN'S
CONSULTING ENGINEERS LIMITED
CIVIL, STRUCTURAL AND GEOTECHNICAL CONSULTING
TEL: +44(0)1527 584850, EMAIL: admin@evans-consulting.co.uk

CLIENT:
MELA AND NIGEL WHITLING
THE WOODLANDS - STONE
KIDDERMINSTER - DY10 4AY

PROJECT:
BOUNDARY FENCE AND
ENTRANCE GATE REPLACEMENT
TITLE:
EXISTING AND PROPOSED
PLAN

DRAWN BY: N.Madenizoglou	CHECKED BY: Evan Vrysoulis	APPROVED BY: Evan Vrysoulis
B20117/ECEL/DRG/BU/002	REV: B	SCALE: 1:50 @ A1