

# DRAWINGS - PROPOSED

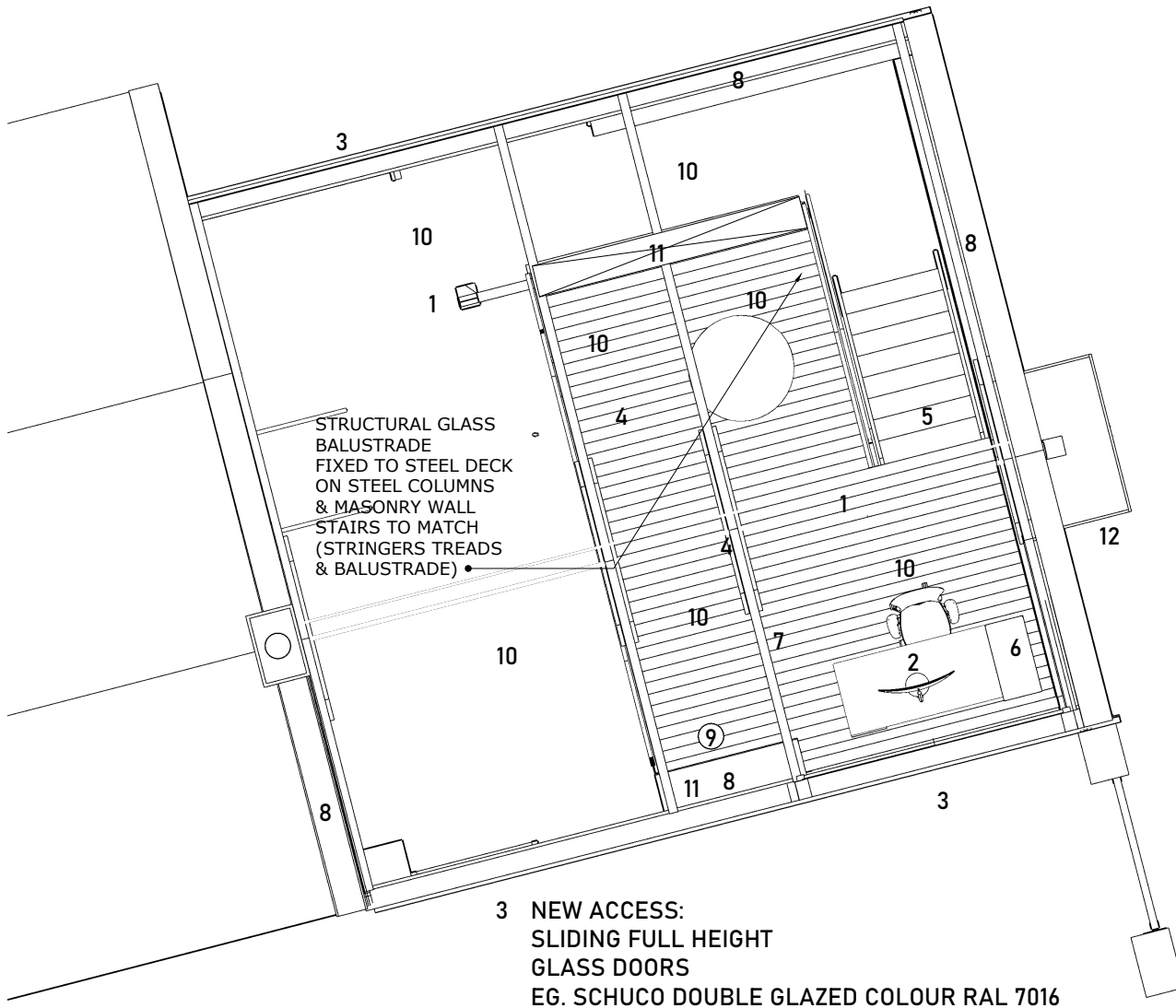

FIRST FLOOR PLAN 1:50

## PROPOSED MATERIALS:

1. STEEL MEZZANINE DECK WITH RAL7016 / BLACK INTUMESCENT PAINT
2. PITCHED DORMER IN SLATE WITH STEEL FRAME WITH LEAD FLASHINGS TO MEET NEW SLATE ROOF (BOTH INSULATED)
3. RAL 7016 GREY ALUMINIUM DOUBLE GLAZED OPENING WINDOWS
4. OAK TONGUE & GROOVE FLOOR EG. PARADOR CLICK SYSTEM
5. STAIR WITH STEEL STRINGER, FRAMELESS GLASS WITH BESPOKE BRACKETS BALUSTRADE WITH OAK RAIL
6. DESK WITH CONCEALED POWER AND DATA
7. SEMI EXPOSED OAK TRUSSES: AS PER ENGINEER SPEC.
8. ALL WALLS INSULATED FACES PLASTER BOARDED SKIMMED & DECORATED WHITE
9. TWINWALL FLUE, MULTI FUEL STOVE, CARBON MONOXIDE & SMOKE ALARM
10. LED LIGHTING FLUSH TO CEILING EG. IGUZZINI BLADE
11. JOINERY SPRAYED FINISH WHITE: BOXING IN CHIMNEY TWINWALL FLUE CUPBOARD STORAGE TO NORTH ELEVATION
12. 2M+ HIGH LOG STORE FOR NESTING BIRD MITIGATION

**STRIPP**

13

07513 782517