

Survey Notes

- It should be highlighted that this forms part of a measured survey, and does not form any comment on the condition of the property.
- We have not inspected woodwork or other parts of the structure which are covered, unexposed or inaccessible and we are therefore unable to report that any such part of the property is free from defect.
- All rights described in chapter IV of the copyright, designs and patents act 1988 have been generally asserted.
- Lacey Architecture Ltd owns the copyright of this design/drawing, which must not be reproduced in whole or part without the written permission of Lacey Architecture.
- Where any drawing is to be read in conjunction with another, including specialists, the two drawings shall be cross-checked and any discrepancies reported to the architectural designer before the work is put in hand.
- All dimensions are in millimetres, all levels are in metres, unless shown otherwise.
- Any discrepancies in dimensions or details on or between these drawings/specifications should be drawn to the attention of the Lacey Architecture and or the engineer in writing for clarification.
- Drawing prepared solely for the use of client, as detailed in text box, and is not to be copied, lent or used by any third party without written permission.
- Do not scale from drawing, use figured dimensions only after checking. Report any discrepancies or omissions to architectural designer before ordering materials or putting work in hand.

| Rev | Date | Description | Dwn |
|-----|------|-------------|-----|
| | | | |

Lacey Architecture Ltd.

A 14 North Road - Cornhill Down - Bath - BA2 8DQ
 Reg No. 3732826 - England and Wales
 VAT No. 254 093 724
 W: www.lacey-architecture.co.uk

Project

Proposed Development at
 Holmlia
 Ridgeway Lane
 Nunney, Frome - BA11 4NS

Client

Colin Garroghan and Emily Helmick

Drawing Title

Existing Plans
 Ground Floor Plan

Scale 1:50 @ A3 Date 13.01.21

Drawn V. Lacey CHMD

DWG No. 02-01-00 Rev. -

©COPYRIGHT

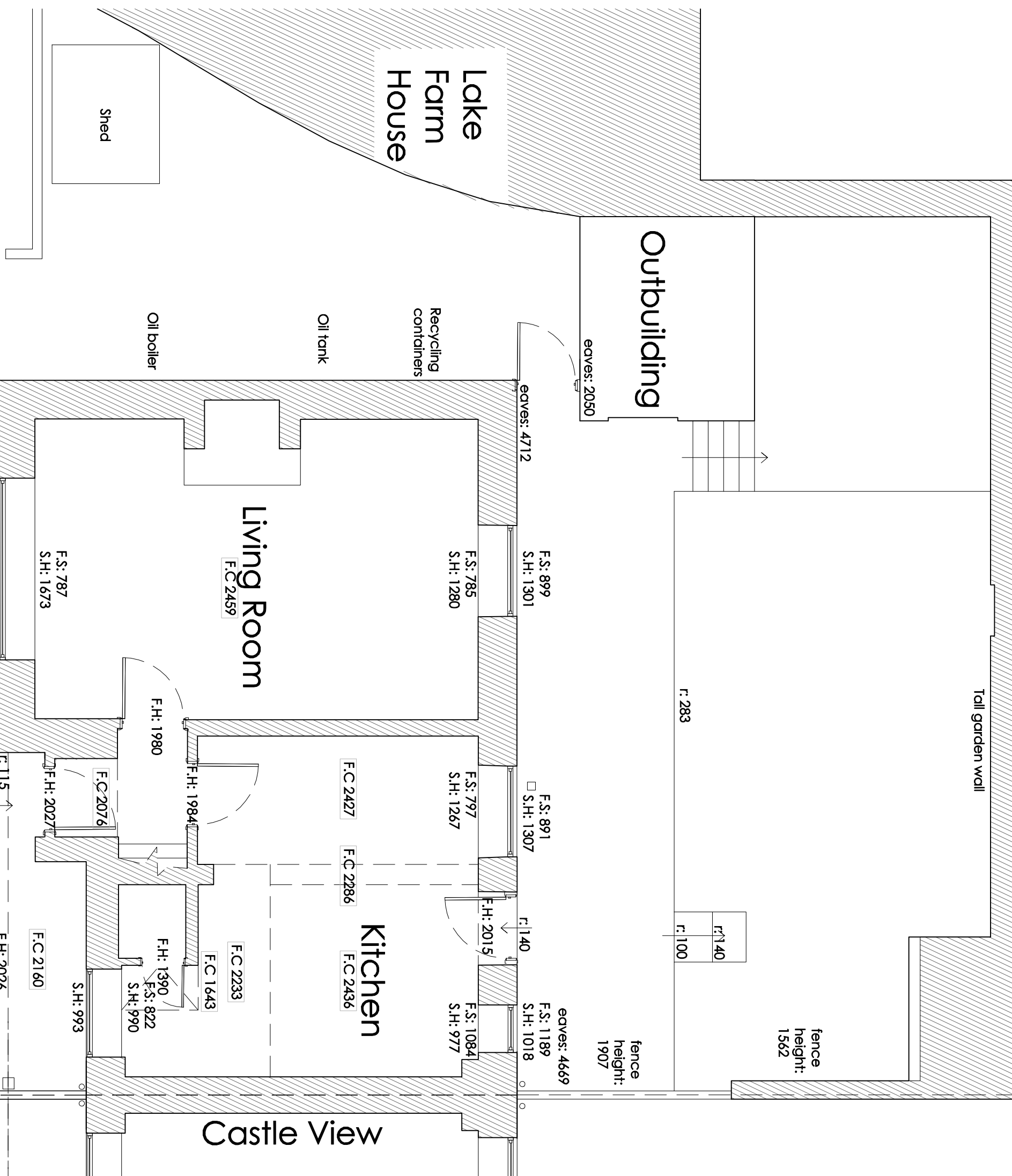

Ground Floor Plan

