

Legend of Abbreviations		Tree Abbreviations	
AV	Air Valve	ALD	Alder
BEDS	Flower Beds	BCH	Beech
BK/W	Brick Wall	CED	Cedar
BLK/W	Block Wall	CHE	Cherry
BOL	Bollard	CYP	Cypress
BS	Brick Setts	ELD	Elder
BT	British Telecom	EUC	Eucalyptus
BW	Barbed Wire Fence	FAC	False Acacia
CB	Close Board Fence	FRT	Fruit
CCTV	Closed Circuit Television Camera	HAW	Hawthorn
CELL	Cellar Cover	HAZ	Hazel
CGI	Corrugated Iron Fence	HOL	Holly
CL	Cover Level	HORN	Hornbeam
C/L	Chain Link Fence	HCH	Horse Chestnut
CONC	Concrete Surface	LAR	Larch
CONC/P	Concrete Panel Fence	LAL	Laurel
CP	Chestnut Paling Fence	MAP	Maple
CRB	Crash Barrier	PLN	London Plane
D	Diameter (trees in metres / drainage pipes in millimetres)	POP	Poplar
DK	Drop Kerb	RHO	Rhododendron
E	Electricity Cover	ROW	Rowan
EP	Electricity Pole	SAL	Sallow
ER	Earth Rod	SB	Silver Birch
FHL	Finished Floor Level	SCH	Sweet Chestnut
FH	Fire Hydrant	WBM	Whitebeam
FLAG	Flag Pole	WIL	Willow
ELP	Floodlight Post		
FP	Footpath		
G	Gully		
GV	Gas Valve		
HW	Head Wall		
IC	Inspection Cover		
IL	Invert Level		
IR	Iron Railing		
LL	Larch-lap Fence		
LP	Lamp Post		
MB	Multihole Tree		
MH	Manhole		
MP	Marker Post		
MP-E	Marker Post - Electric		
MP-G	Marker Post - Gas		
MP-T	Marker Post - Telephone		
MP-W	Marker Post - Water		
NAME	Road Nameplate		
PAL	Palisade Fence		
POK	Top of Kerb Level		
PR	Post and Rail Fence		
PW	Post and Wire Fence		
RE	Rodding Eye		
RET	Retaining		
RS	Road Sign		
RWP	Rainwater Pipe		
SCK	Stop Cock		
SOF	Soffit Level		
ST/W	Stone Wall		
SV	Sluice Valve		
SVP	Soil Vent Pipe		
TEL	Call Box (telephone)		
TH	Threshold Level		
TL	Traffic Light		
TP	Telegraph Pole		
TV	Cable Television		
U/L	Unable to Lift (Cover)		
V	Valve (Unknown Type)		
VP	Vent Pipe		
W-HT	Top of Wall Level		
WL	Water Level		
WM	Water Meter		
W/M	Wire Mesh Fence		
WO	Washout Valve		
WV	Water Valve		

Notes

- Datum : Ordnance Survey Benchmark (OSBM) on The Mount, value 172.047m A.O.D.
- Survey Grid : Ordnance Survey National Grid co-ordinates derived via OS Active GPS Network.
- Survey contents correct as of date of survey and survey undertaken to agreed specification
- All critical dimensions to be checked prior to site works
- All kerb levels shown are channel levels
- Drainage and Survey covers : Covers buried or obscured at the time of the survey are not shown. Manholes have not been entered for safety reasons and all pipe diameters are estimated from the surface. Drainage pipe diameters are in millimetres, eg. D100 means a 100mm diameter pipe. The flow type stated is based on visual evidence seen from the surface at the time of the survey. All internal manhole details should be confirmed by the contractor on site prior to site works.
- Trees : For concentric spread trees the spread plotted is an average value drawn to scale to the nearest metre. The minimum individual diameter surveyed is 0.15m at 1m up the trunk from the ground. Trunk diameters are not plotted to size. General species are only stated where noted. A qualified arboriculturalist should be consulted for species type and condition. Heights (when requested) are approximate to the nearest metre.

Survey Stations

Station	Easting	Northing	Level
S001	402322.847	219457.128	166.009
S002	402298.425	219483.228	166.258
S003	402282.577	219488.323	166.293
S004	402286.382	219497.112	166.434
S005	402275.863	219502.457	166.414
S006	402285.519	219507.695	166.245
S007	402302.549	219497.293	166.227
S008	402312.253	219493.345	165.772
S01A	402278.573	219402.454	168.661
S08A	402300.335	219508.296	166.321

A D Horner Limited
 Land and Measured Building Surveyors

51 Bridge Street
 Pershore
 Worcestershire
 WR10 1AL

1 Folly House
 Venton
 Plymouth, Devon
 PL7 5DS

Telephone: 01386-555486 Telephone: 01752-837382

Website: www.adhorner.co.uk
 E-mail: enquiries@adhorner.co.uk

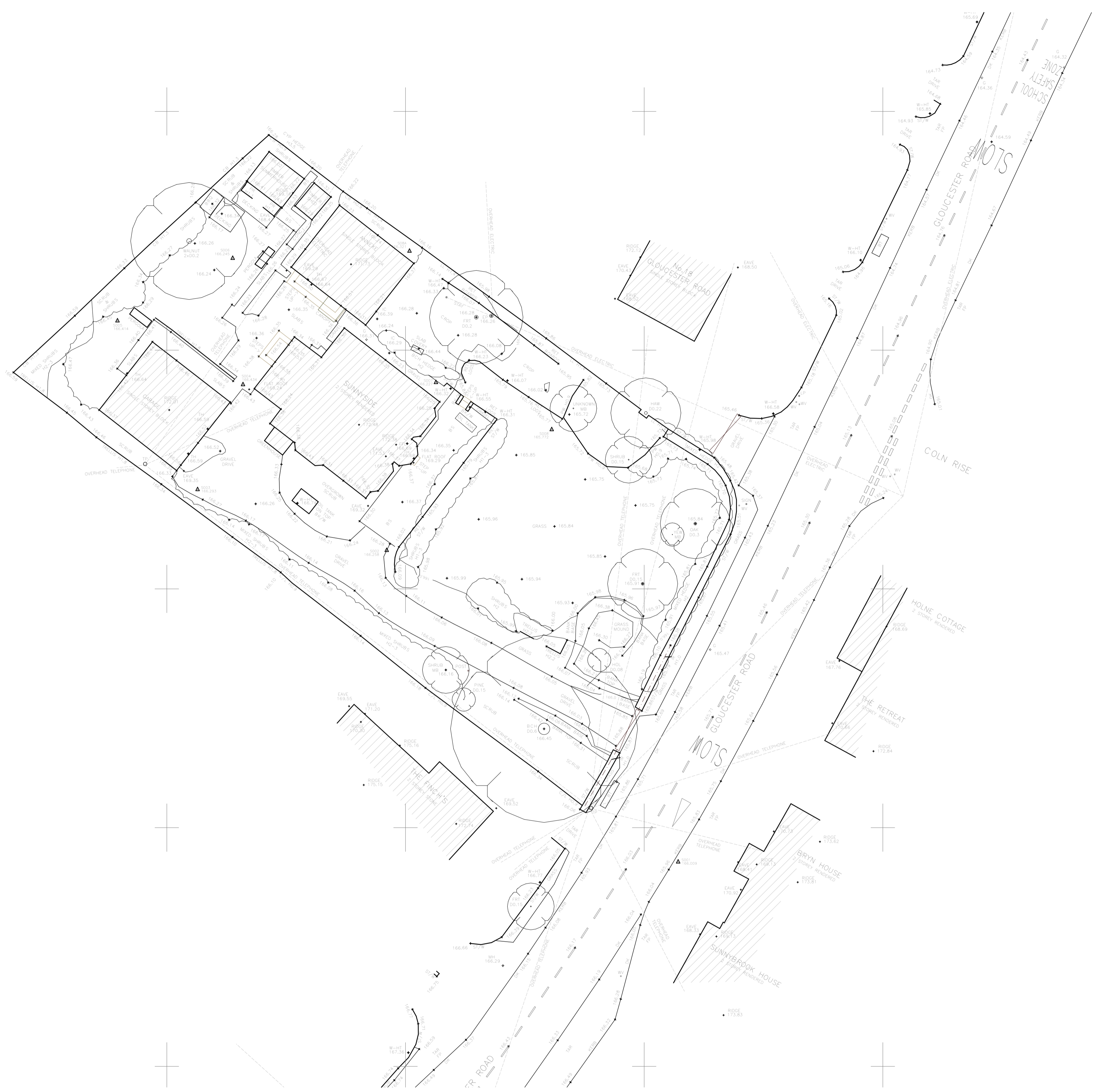
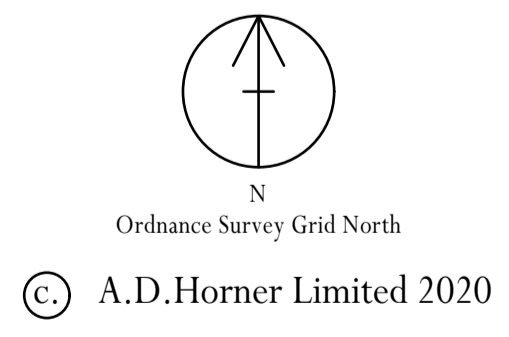

coombes : everitt architects limited
 105-107
 Bath Road
 Cheltenham
 Gloucestershire
 GL53 7LE

t: 01242 807727 f: 0845 5575833
 e: info@ce-architects.co.uk
 www.ce-architects.co.uk

- Preliminary
- Feasibility
- Planning
- Building Regulations
- Tender
- Construction issue
- As Built

1. This drawing and content is copyright © of coombes : everitt architects limited and should not be copied without their prior written consent.

2. Do not scale drawing. all dimensions to be checked on site prior to construction and any discrepancies reported to contract administrator.

3. Do not use this drawing for setting out unless drawing specifically indicates setting out points.

4. Engineering information is indicative only and should be taken from structural engineers design.

RIBA
 Chartered Practice

Drawing title: Topographical Site Survey	Project: Land at Sunnyside, Gloucester Road, Andoversford GL54 4HR
Client: Mrs N Stranks	Scale: 1:200 @ A1
Drawn by: AH Checked: JE	Date: November 2020
Project No: 20.20.018	Project / Drawing No: 20.20.018 PL103