

Proposed development of Land to front of Sunnyside, Gloucester Road, Andoversford, Gloucestershire

Heritage Impact Assessment

May 2022

Prepared on behalf of Mrs N Stranks

by coombes everitt architects Ltd

Heritage Impact Assessment

Introduction

This Heritage Impact Assessment has been prepared to accompany the planning application for a new bungalow on the land to the front of Sunnyside, Andoversford.

There is a listed structure on the land adjacent to the site. This assessment has been undertaken to assess the impact of the development on the listed structure.

Identification of heritage Asset.

The listed structure is a boundary marker. Details of the listing are set out below

Listing

*ANDOVERSFORD GLOUCESTER ROAD
SP 01 NW (west side)
at NGR 02331905
5/12 Boundary stone
II*

Boundary stone on former boundary between parishes of Dowdeswell and Withington. C18 or C19. Limestone. Approximately 0.4m in height. Segmental-headed stone with large incised 'D' on side formerly facing into Withington parish.

Listing NGR: SP0231519463



The listed item



Listed item in wider context.

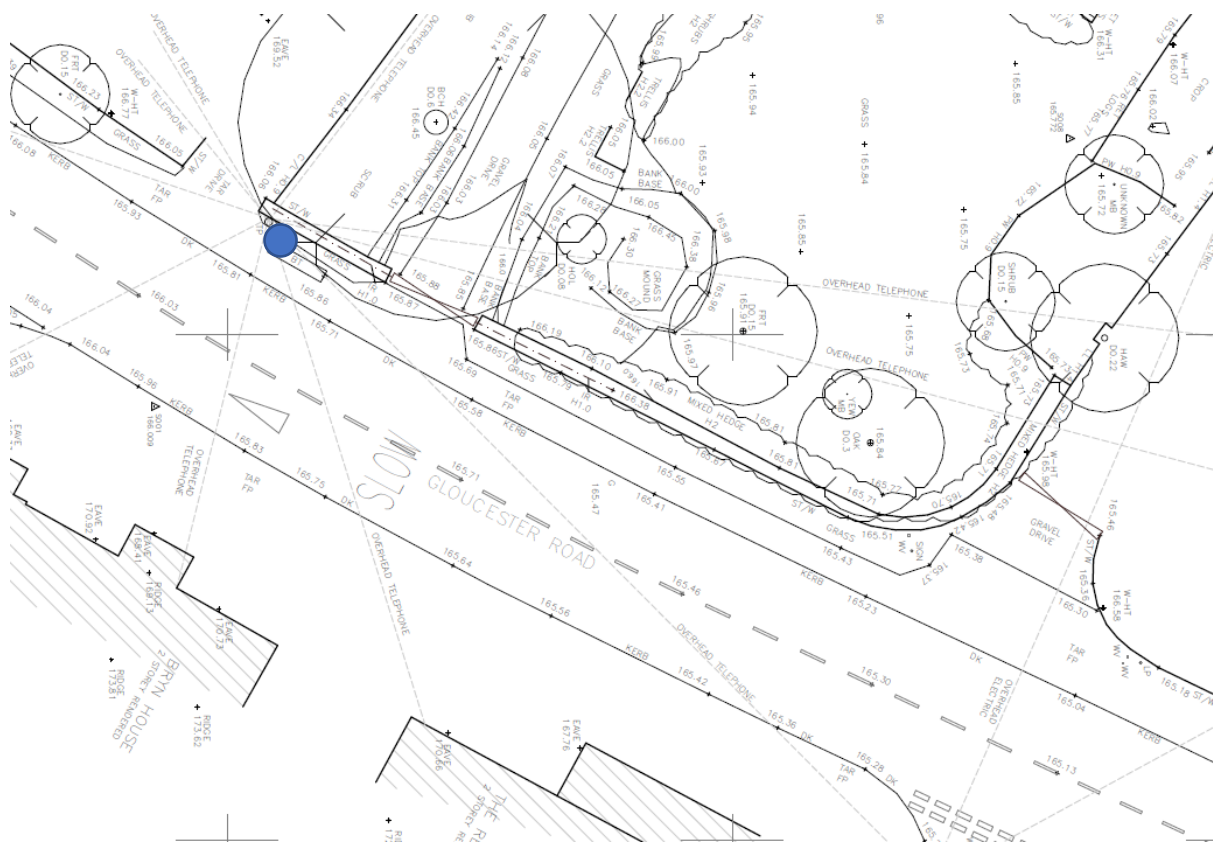

Location of the listed item.

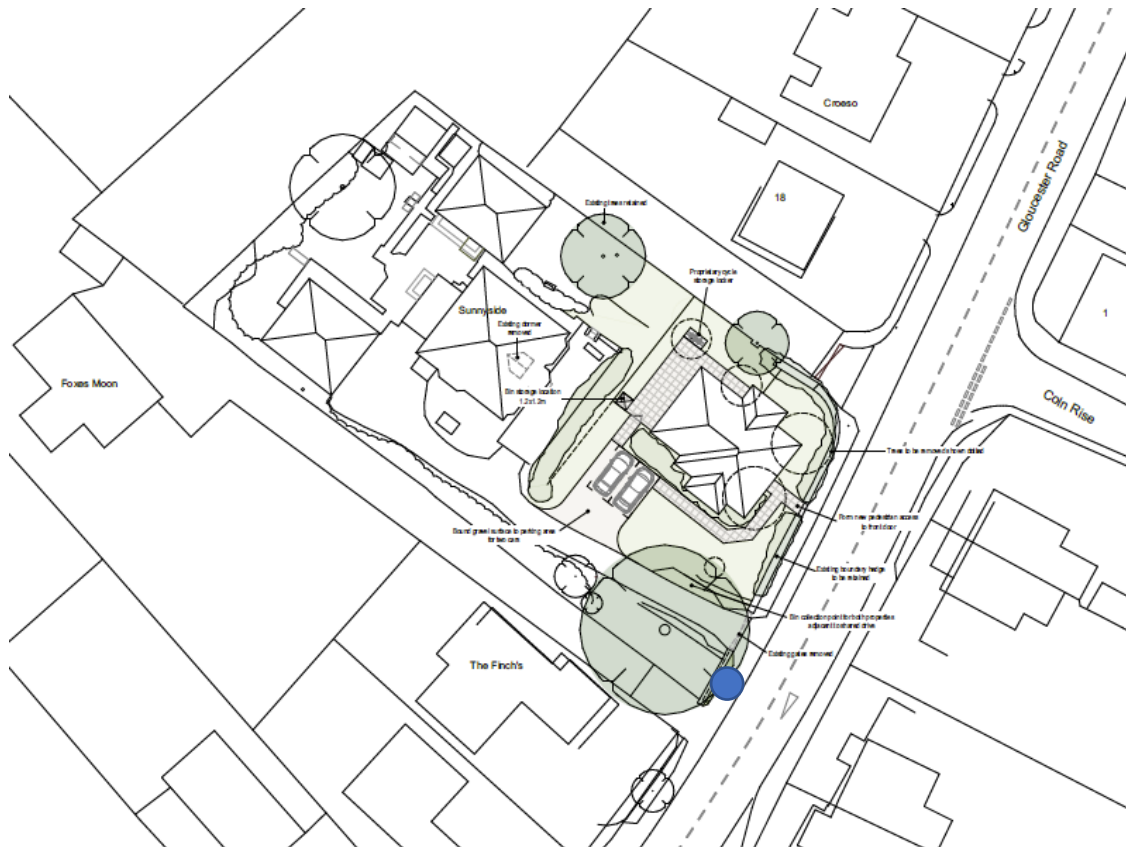

Location of the listed item within the context of the scheme.

Assessment of impact

As can be seen from the photographs and diagrams above the item is located in the soft landscaping just outside the site at the back edge of the pavement in front of a low stone boundary wall.

There are no works proposed within the scheme that will affect this section of the footpath. The existing driveway between the area where the listed item is located and the development site is to remain as existing.

Conclusion

Due to the location of the listed item and the scope of the proposed works we do not believe the proposal will have any impact at all on the listed item.