

01 existing location plan
Scale: 1:1250
OS Licence No. OI1543184

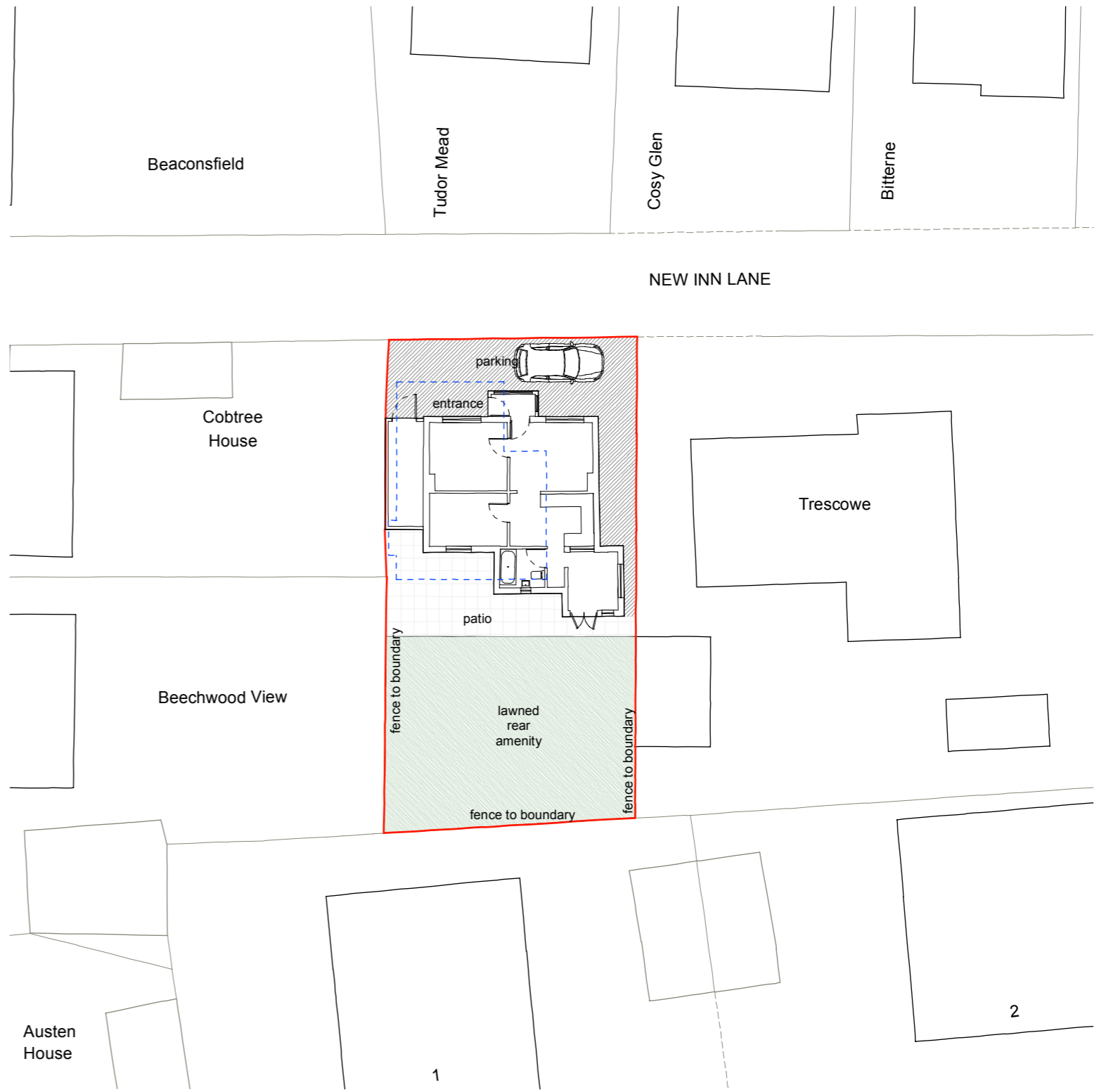

02 existing site plan
Scale: 1:250
approved footprint

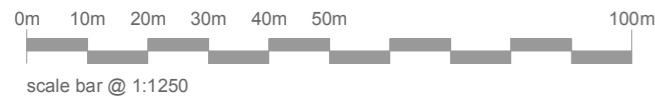
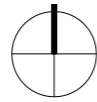
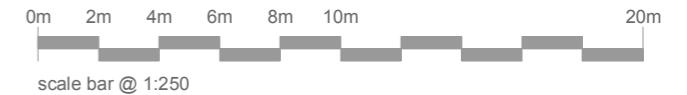

THIS DRAWING REMAINS PROPERTY OF KODE ARCHITECTURE LTD AND CANNOT BE REPRODUCED OR COPIED WITHOUT PRIOR WRITTEN CONSENT.

DRAWING TO BE USED FOR THE STATUS AS NOTED. DO NOT SCALE FROM THE DRAWING OTHER THAN FOR PLANNING PURPOSES. ALL SIZES TO BE CONFIRMED ON SITE BEFORE CONSTRUCTION. ALL WORKS MUST BE CARRIED OUT IN ACCORDANCE WITH THE RELEVANT STATUTORY AUTHORITIES.

UNLESS STATED, NO TOPOGRAPHICAL SURVEY CARRIED OUT. KODE ARCHITECTURE ACCEPT NO RESPONSIBILITY FOR ERRORS OR OMISSIONS ON DRAWINGS/MEASUREMENTS.

notes: *

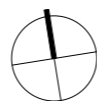

project date: Jun 2022
status: Planning
scale: as noted @ A3

project title: 'Staindrop' New Inn Lane, Bartley
sheet name: Existing Location / Site Plan
drawing no.: KA/2022/J18.01

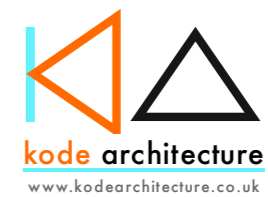

Kode Architecture Limited
47 Ramley Road
Lymington
SO41 8GZ

rob@kodearchitecture.co.uk
01590 676137