

EASTWICK HALL LANE

Green Man Court

Norbrook

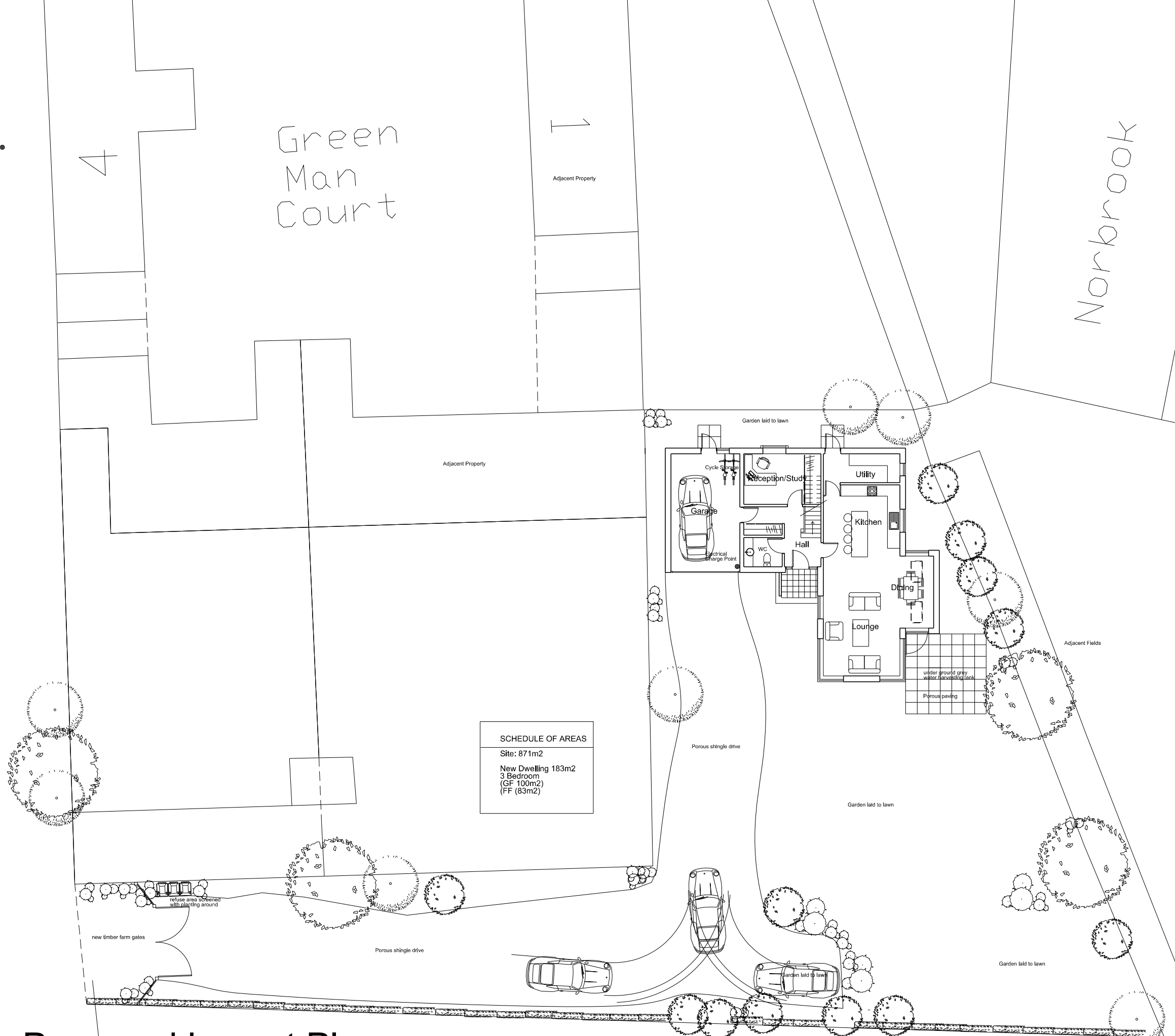
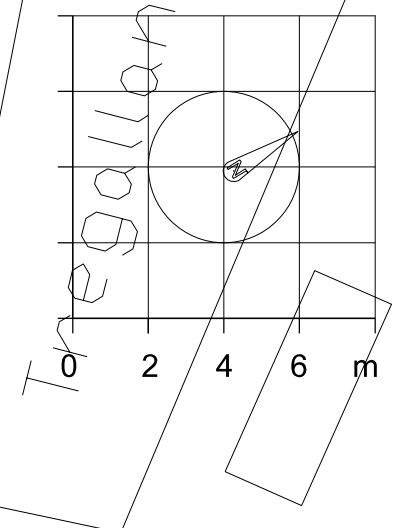

SCHEDULE OF AREAS	
Site:	871m ²
New Dwelling:	183m ²
3 Bedroom:	(GF 100m ²)
(FF):	(83m ²)

Revision

Project Title
Eastwick Hall Lane Site
Eastwick
Herts CM20 2QP

Drawing Title
New Dwelling

Proposed Layout Plan

Client
White Hart Developments

Scale
1:200@A3

Date
Jan 2022

Drg. No.
0572_00_005

Notes

All dimensions must be checked and NEO Architects are to be informed of any discrepancies prior to construction. This drawing and any of the details therein remain the copyright of NEO Architects.

NEO Architects
105a Park Road
New Barnet
EN4 9QR

Phone +44 (0) 20 33040480
Mobile 07802 237666

michael@neoarchitects.co.uk

Proposed Layout Plan

97m² GIA