

Ground Floor

Approx. 87.7 sq. metres (944.4 sq. feet)

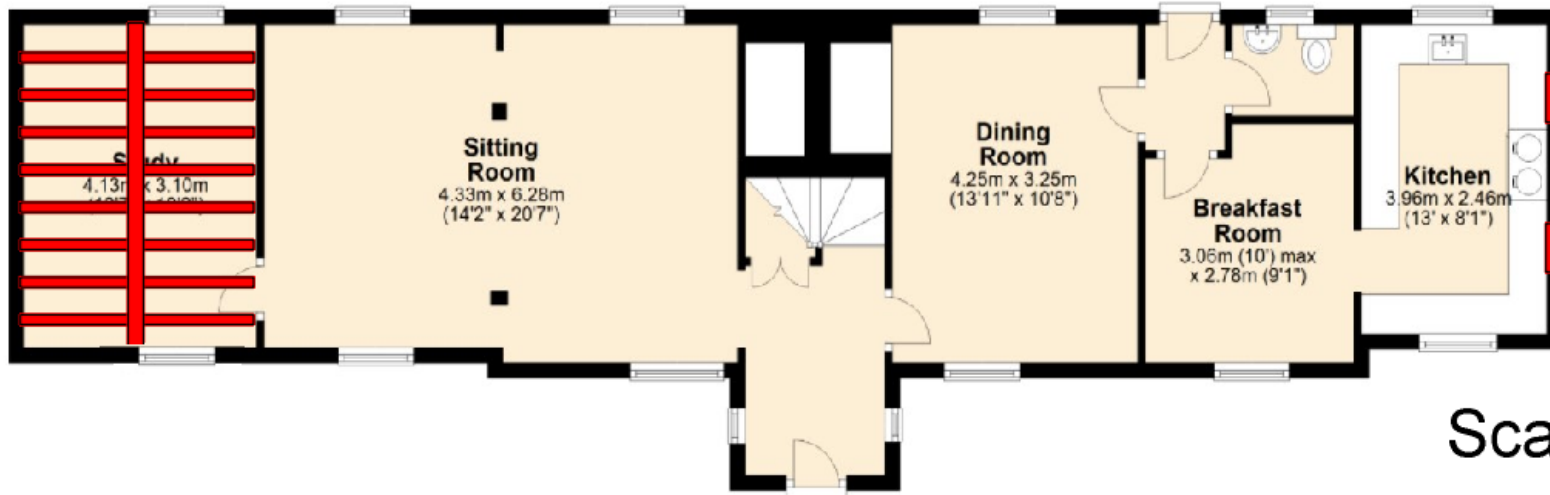

Scale 1:100

First Floor

Approx. 74.5 sq. metres (801.9 sq. feet)

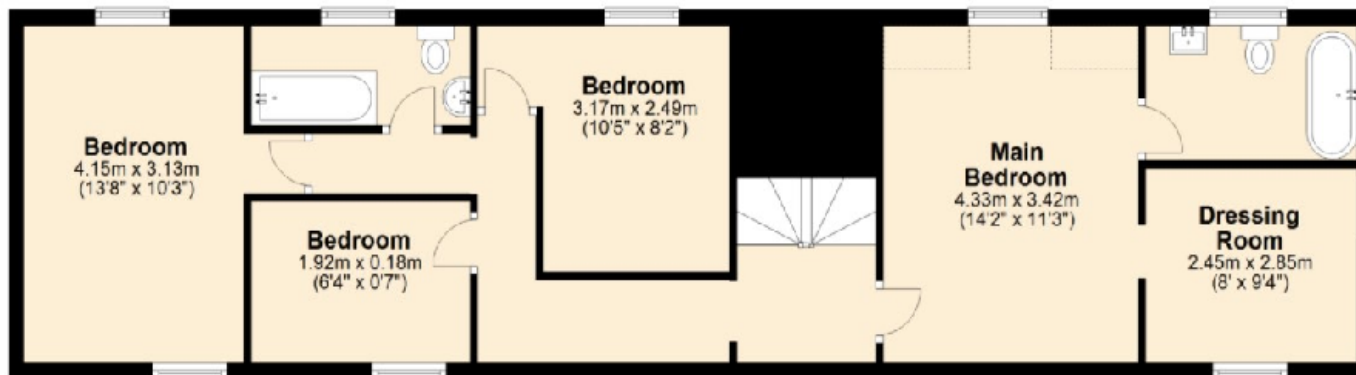

Total area: approx. 162.2 sq. metres (1746.3 sq. feet)

Proposal to remove red coloured beam and joists from ground floor ceiling and replace with joists to span 3.15m without support beam.
Also proposal to install 2x new windows in western aspect of ground floor kitchen wall.

Application to remove beam and to add two kitchen windows.

**Applicant ; Mark Sheppard
Address: 20-21 Snow Street
Roydon IP225SB**