

# SCHEDULE OF TREES

REF	SPECIES	TRUNK DIA MM	HEIGHT M	CANOPY SPREAD N S E W	CAN ABOVE G.L.	RPA RAD'	CAT	COMMENTS / PRELIMINARY RE'S.
1	HOLLY (ILEX AQUIF)	80	6	1.2 1.2 1.2 1.2	0.5	1.0	C	SMALL SELF-SET TREE, NOT SIGNIFICANT.
2	OAK (Q. ROBUR)	360	12	5 3.5 4.5 4.5	5	4.32	B	ASSUMED OFF-SITE - T.B.C. YOUNG TREE REASONABLE FORM. CLEAR OF PROPOSALS.
* T68	YEW (TAXUS BACCATA)	300 (MULTI)	11	6 4 5 5	1.5	5.0	B	MATURE SPECIMEN. LOWER CANOPY ON E. SIDE COULD BE RAISED TO BALANCE CROWN - ROOT ZONE - SEE 'IMPLICATIONS'.
4	LAVINEL (P. LUSITANICA)	-	4	-	-	-	-	'BUSHES' NOT TREES, POOR FORM NOT SIGNIFICANT.
5	OAK (Q. ROBUR)	380	15	4 2 2 5	8	4.56	C	SMALL, HIGH CANOPY RESULTING FROM COMPETITION. MODERATE EXAMPLE.
* T69	HOLLY (ILEX AQUIF)	100	9	1.2 1.2 1.2 1.2	1.5	1.2	C	'THIN/NARROW CROWN, NOT SIGNIFICANT BUT CAN BE RETAINED CLEAR OF WORKS
7	BEECH (FAGUS SYLV)	340	15	4 4 5 3	2	4.08	B	REASONABLE FORM, SOME CANOPY IMBALANCE - CAN BE RECTIFIED ROOT ZONE - SEE IMPLICATIONS.
8	MAPLE (ACER SP)	MULTI STEM (400)	9	3.5 5 5 4	3.5	4.0	C	BROAD, OPEN CANOPY, MODERATE EXAMPLE MINOR DECAY IN ONE LIMB.
9	HOLLY (ILEX AQUIF)	120	6	1.2 1.2 1.2 1.2	1	1.44	C	SMALL SELF-SET TREE, NOT SIGNIFICANT.
10	HOLLY (ILEX AQUIF)	120	7	-	-	-	-	CLEAR OF PROPOSALS.
11	HAZEL (CORYLLUS AV)	-	-	-	-	-	-	MULTI-STEM LARGE 'BUSH' CLEAR OF PROPOSALS.
12	CYPRESS (C. LAUSANNENSIS)	-	-	-	-	-	-	SMALL GARDEN CONIFER CLEAR OF PROPOSALS.
13	WILLOW (S. CAPREA)	MULTI STEM	4	-	-	-	-	SMALL SELF-SET TREE CLEAR OF PROPOSALS.
14	SWEET GUM (LIQUIDAMBAR)	250	9	4 3.5 3 4	1.8	3.0	B	GOOD FORM. CLEAR OF PROPOSALS.
15	APPLE (MALUS SP)	200	5	2.5 3 3 3	1.2	2.4	C	GARDEN FRUIT. NOT SIGNIFICANT.
16	HAZEL (C. CONFORTA)	3	-	-	-	-	-	'CONTORTED' FORM, GARDEN ORNAMENTAL BUT NOT SIGNIFICANT.
17	CHERRY (PRUNUS SP)	3	-	-	-	-	-	SMALL 'SPARSE' BUSH, - NOT TREE. NOT SIGNIFICANT.
18	APPLE (MALUS SP)	120	4	3 2 2 3	-	1.44	C	SMALL GARDEN FRUIT NOT SIGNIFICANT.
* T64	OAK (Q. ROBUR)	530	15	8 9 7 6	5	6.36	B	BROAD CANOPY, REASONABLE FORM 'LEARNING' SLIGHTLY TO S.
* T65	YEW (TAXUS BACCATA)	1.2 APPROX	-	-	-	-	-	OFF SITE TREE NEAR BOUNDARY RESTRICTED ACCESS - PLOTTED TO ESTABLISH POTENTIAL ROOT ZONE SEE 'IMPLICATIONS'.
21	MAPLE (ACER SP)	110	3.5	2 2 2 2	1.2	1.32	C	SMALL ORNAMENTAL TREE CLEAR OF PROPOSALS.
22	WEEDING PEAR (PYRUS SALIC)	180	3.5	2 2 2 2	0	1.2	C	SMALL ORNAMENTAL TREE. CLEAR OF PROPOSALS.
23	BEECH (FAGUS SYLV)	260	11	4 4 4 3	1.5	3.12	B	YOUNG TREE, REASONABLE FORM CLEAR OF PROPOSALS.
* T66	WILLOW (SALIX SP)	-	-	-	-	-	-	NO LONGER PRESENT (REASON UNKNOWN)
* T65	WILLOW (SALIX SP)	-	-	-	-	-	-	MATURE RIVERSIDE TREE CLEAR OF PROPOSALS.

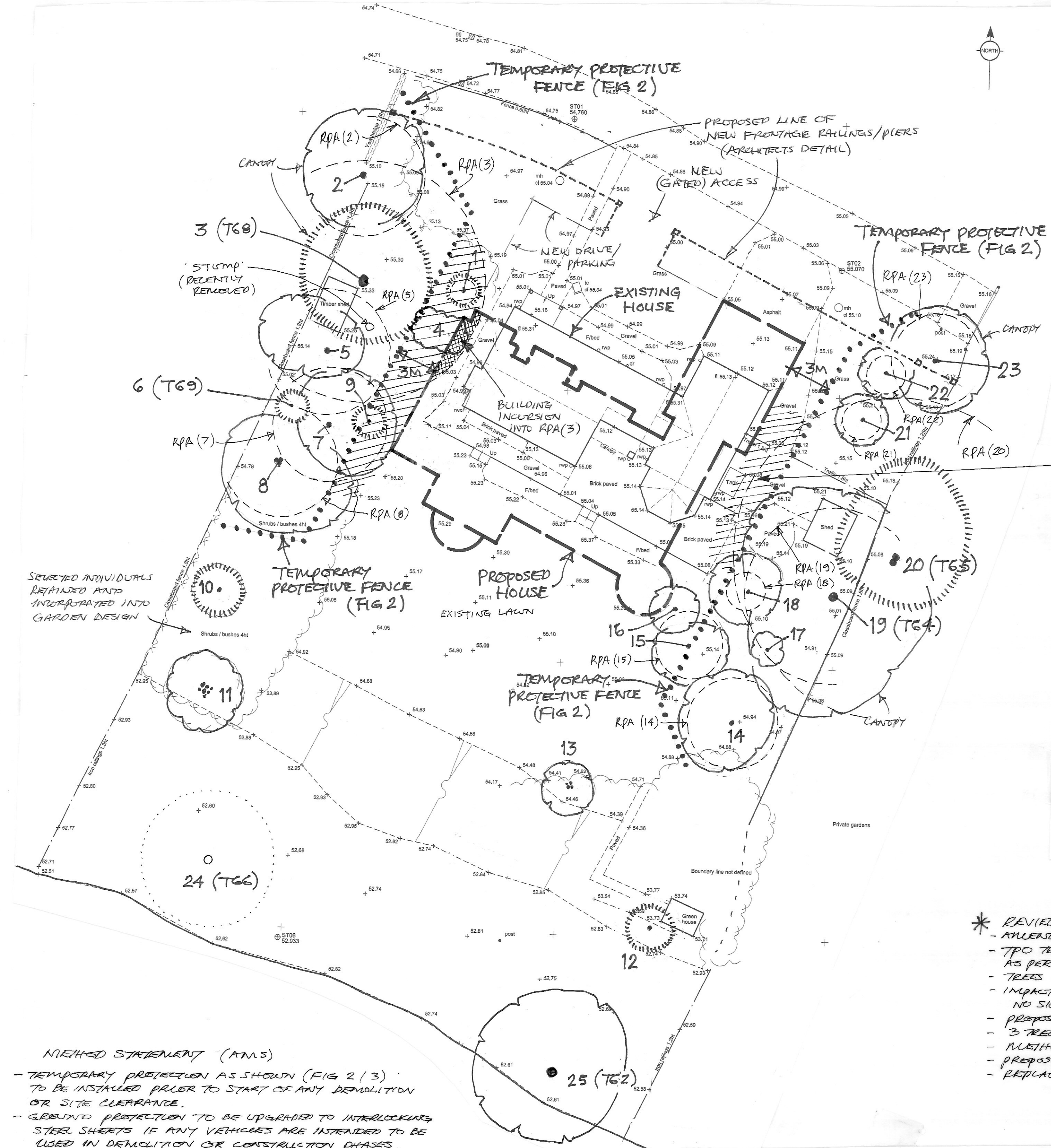

- NOTES:
- SITE INSPECTED ON 9 DEC '21.
  - THIS DRAWING IS BASED ON TOPO SURVEY BY OTHERS WITH PROPOSED DWELLING SUPERIMPOSED.
  - CANOPY SHAPES/SIZES SHOWN TO SCALE BASED ON DIMENSIONS CHECKED ON SITE.
  - RPA'S (ROOT PROTECTION AREAS) CALCULATED AS PER REC'S OF B.S. 5837.

- REPLACEMENT TREES:
- BASED ON PROPOSED REMOVAL OF TREES 1, 9, AND 15. (CONS' AREA STATUS). MINIMUM OF 3 ARE NEW TREES TO BE PLANTED - SPEC/Locations SHOWN ON SEPARATE DRAWING (M.F.H. DRG 2).
  - TREE 2A - REPLACEMENT IF REQUIRED T.B.C. BY L. MATH (REASONS FOR REMOVAL UNKNOWN) SPEC/Locations AGREED IF NECESSARY.
  - TREES 4 AND 16 - NO DIRECT REPLACEMENTS PROPOSED UNLESS OTHERWISE REQUIRED.

SHADED AREAS (BOTH SIDES OF HOUSE) INDICATE GROUND PROTECTION AS PER FIG 3 TO PREVENT SOIL COMPACTION OVER ROOTS.

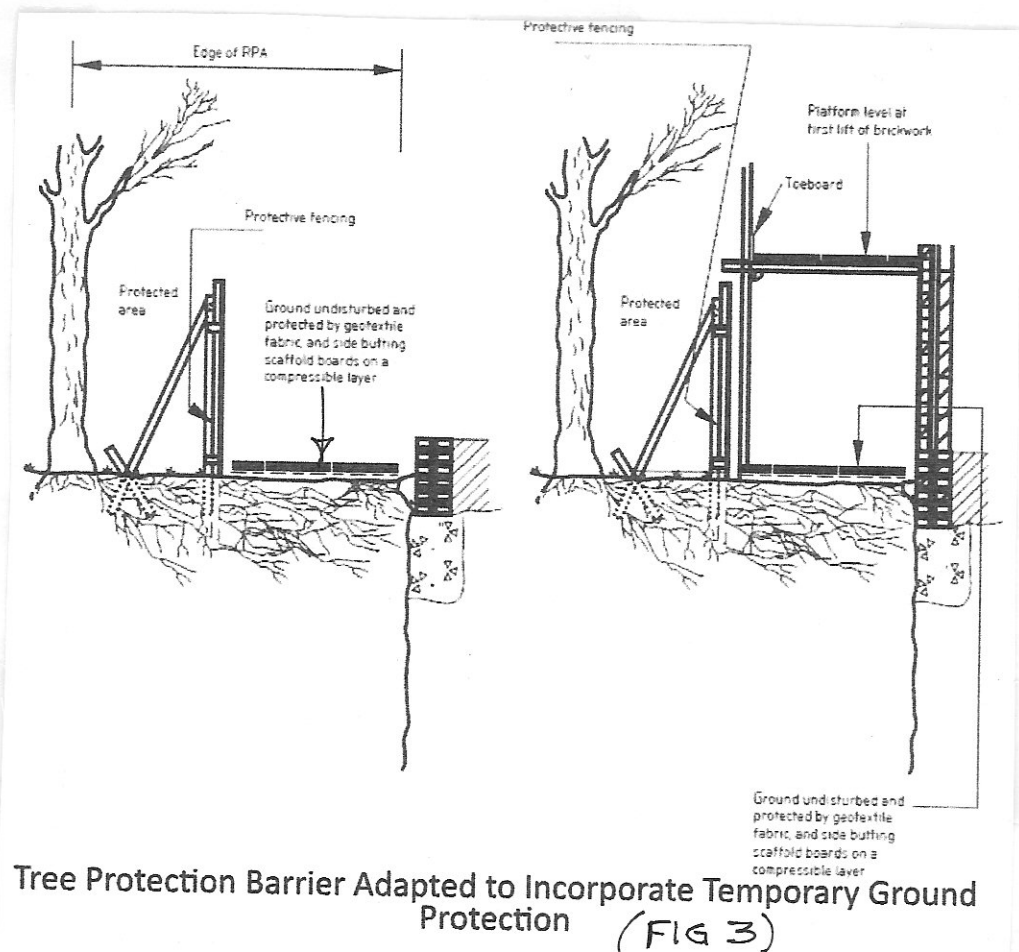

- IMPLICATIONS ASSESSMENT (A1A)
- BASED ON ARCHITECTS PROPOSED LAYOUT 151B.
  - TREES/BUSHES 1, 4 AND 9 TO BE REMOVED TO FACILITATE CONSTRUCTION. NOT SIGNIFICANT SPECIMENS, LITTLE OR NO IMPACT ARISING FROM REMOVAL.
  - TREES 2, 3 (TPO 68), 5, 6 (TPO 69), 7 AND 8 - ALL RETAINED. POTENTIAL FOR SOME ROOT DAMAGE FROM GROUND COMPACTION DURING CONSTRUCTION, CAN BE MITIGATED BY USE OF GROUND PROTECTION OVER AREA SHOWN (FIG 3). POTENTIAL FOR MINOR ROOT DAMAGE TO 3 (TPO 68) WHERE BUILDING ENVELOPES INTO RPA, BUT THIS IS UNLIKELY TO BE OF ANY SIGNIFICANCE AS THE INCLUSION IS UNDER 5% OF THE TOTAL RPA OF 954.5m<sup>2</sup>.
  - TREE 7, RETAINED. POTENTIAL FOR ROOT DAMAGE FROM GROUND COMPACTION DURING CONSTRUCTION, CAN BE MITIGATED BY USE OF GROUND PROTECTION AS SHOWN (FIG 3). POTENTIAL FOR DAMAGE TO CANOPY (CONSTRUCTION ACCESS) - CAN BE RECTIFIED BY CANOPY REDUCTION (PRE-DEVT) TO RE-BALANCE CURRENTLY CANOPY DISTORTION AS NOTED AND SHOWN ON PLAN.
  - TREE 8 - CLEAR OF PROPOSALS, BUT WOULD BENEFIT FROM MINOR PRUNING TO E. TO BALANCE.
  - TREES 10, 11, 12, 13 AND 14 - ALL RETAINED, CLEAR OF PROPOSALS.
  - TREES 15 AND 16 - TO BE REMOVED TO FACILITATE PROPOSALS. 15 (APPLE) 16 (SMALL HAZEL BUSH).
  - TREES 17, 18, 19 (TPO 64), 21, 22, 23 AND 25 - ALL RETAINED, CLEAR OF PROPOSALS.
  - TREE 20 (TPO 65) OFF SITE NEAR BOUNDARY. POTENTIAL FOR MINOR ROOT DAMAGE FROM GROUND COMPACTION DURING CONSTRUCTION - CAN BE MITIGATED BY USE OF GROUND PROTECTION OVER AREA SHOWN (FIG 3).
  - PROPOSED FRONTAGE RAILINGS - POTENTIAL FOR MINOR LOCAL DAMAGE TO 23 FROM EXCAVATION TO CONSTRUCT 2/3 BRICK PIERS (NSM 450<sup>2</sup> AT 3m<sup>2</sup>) - UNLIKELY TO BE SIGNIFICANT, HARDY DIG ONLY. REMAINDER OF RAILINGS/PIERS CLEAR OF RPA'S.
  - NEW FRONTAGE DRIVING/DRIVE - ALL CLEAR OF RPA'S.

- METHOD STATEMENT (AMS)
- TEMPORARY PROTECTION AS SHOWN (FIG 2/3) TO BE INSTALLED PRIOR TO START OF ANY DEMOLITION OR SITE CLEARANCE.
  - GROUND PROTECTION TO BE UPGRADED TO INTERLOCKING STEEL SHEETS IF ANY VEHICLES ARE INTENDED TO BE USED IN DEMOLITION OR CONSTRUCTION PHASES.
  - THE SITE AGENT WILL BE RESPONSIBLE FOR THE INSTALLATION AND IS TO CONTACT THE S.O. WHO WILL INSPECT, RECORD, AND APPROVE POSITIONING (INC L. MATH APPROVAL WHERE RECD).
  - BEYOND FENCE LINES:
    - NO FIRES
    - NO STORAGE OF ANY MATERIALS
    - NO ALTERATION OF LEVELS +/-
  - ALL SITE OPERATIVES AND VISITORS ARE TO BE MADE AWARE OF THE CONSTRUCTION EXCLUSION ZONE BOUNDARIES.
  - FENCING/GROUND PROTECTION TO BE MAINTAINED IN POSITION THROUGHOUT ALL MAIN CONSTRUCTION WORK UNTIL REMOVAL IS REQUIRED FOR EXTERNALS.
  - CONTACT THE S.O. PRIOR TO ANY REMOVAL OR IF ADJUSTMENT IS REQUIRED FOR ANY REASON.
  - \* SERVICES - TO BE DESIGNED OUTSIDE ALL RPA'S TO AVOID EXCAVATION - IN PARTICULAR TO THE W. OF THE NEW BUILDING. (SLOPE EXIST TO E. SIDE).
- PROPOSED SURGERY:
- TREE 7, CANOPY TO BE REDUCED ON E. SIDE TO GIVE ADEQUATE CONSTRUCTION ACCESS, AND RE-BALANCE.
  - TREE 8, MINOR CANOPY REDUCTION ON E. SIDE TO GIVE ADEQUATE CONSTRUCTION ACCESS, AND RE-BALANCE.
  - TREE 18 - MINOR CANOPY REDUCTION TO GIVE ADEQUATE CONSTRUCTION ACCESS.
  - NO OTHER ESSENTIAL WORKS PROPOSED.
  - SURGERY TO BE CARRIED OUT 'PRE-DEVELOPMENT' BY APPROVED SURGEON ONLY, AND FOLLOWING NECESSARY APPROVALS FROM L. MATH.

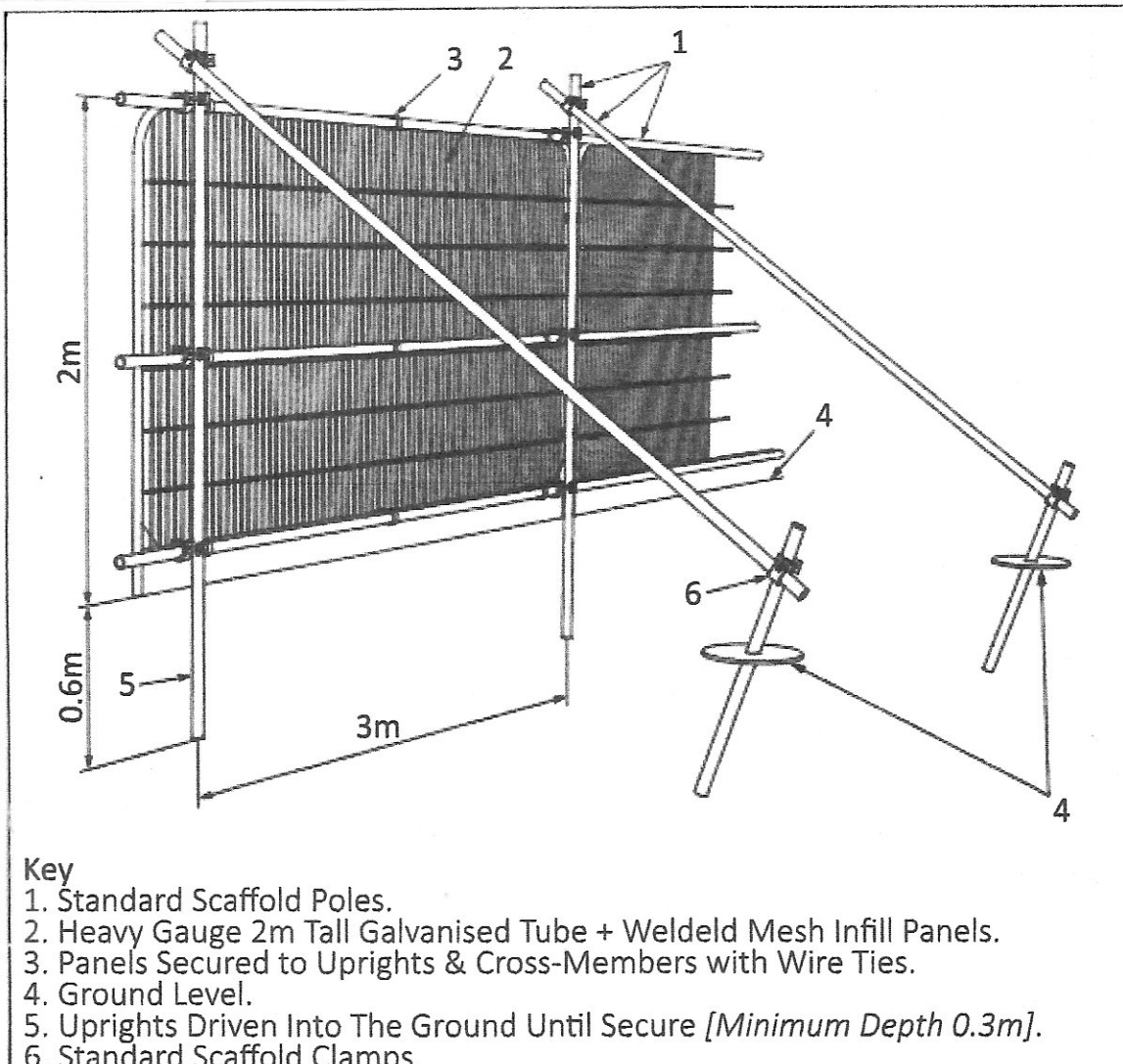

Tree Protection Barrier (FIG 2)  
British Standard 5837, [2012], Trees in Relation to Construction

REPLACEMENT DWELLING AT YEW HOUSE OLD HALL DRIVE ELFORD

ASSESSMENT OF EXISTING TREES (CONSTRAINTS/PROTECTION)

1:200 DEC'21 DRG No. 1A (A1)

MARTIN F. HOLLAND CML  
LANDSCAPE DESIGN CONSULTANT

WOODSIDE HOUSE MUCKLOW HILL HALESOWEN WEST MIDLANDS B62 9BT  
TEL 0121 503 0507 EMAIL martin@mfh.co.uk

'ON SITE' VERGE - LOCATION FOR REPLACEMENT TREES (INC GRASS AND/OR SHRUBS)

\* PRECISE LOCATIONS MAY VARY SLIGHTLY TO INCORPORATE WITH OVERALL FRONTAGE LANDSCAPING WHEN DESIGN IS FINALISED.

REPLACEMENT TREE PLANTING:  
 - TO BE READ IN CONJUNCTION WITH NOTES ON M.F.H. DRG 1 (EXISTING TREES).  
 - MINIMUM 3 NO REPLACEMENTS IN VISIBLE LOCATIONS (PUBLIC AMENITY).

TC = TILIA CERDATA  
 LT = LIRIODENDRON TULIPIFERA  
 LS = LIQUIDAMBAR STYRACIFLUA

- ALL TO BE SUPPLIED AS HEAVY STANDARD 14/16 M ROOTBALL (SUBJECT TO SEASON).  
 - TREE PIT DETAILS AS BELOW.  
 1:20 APPROX.

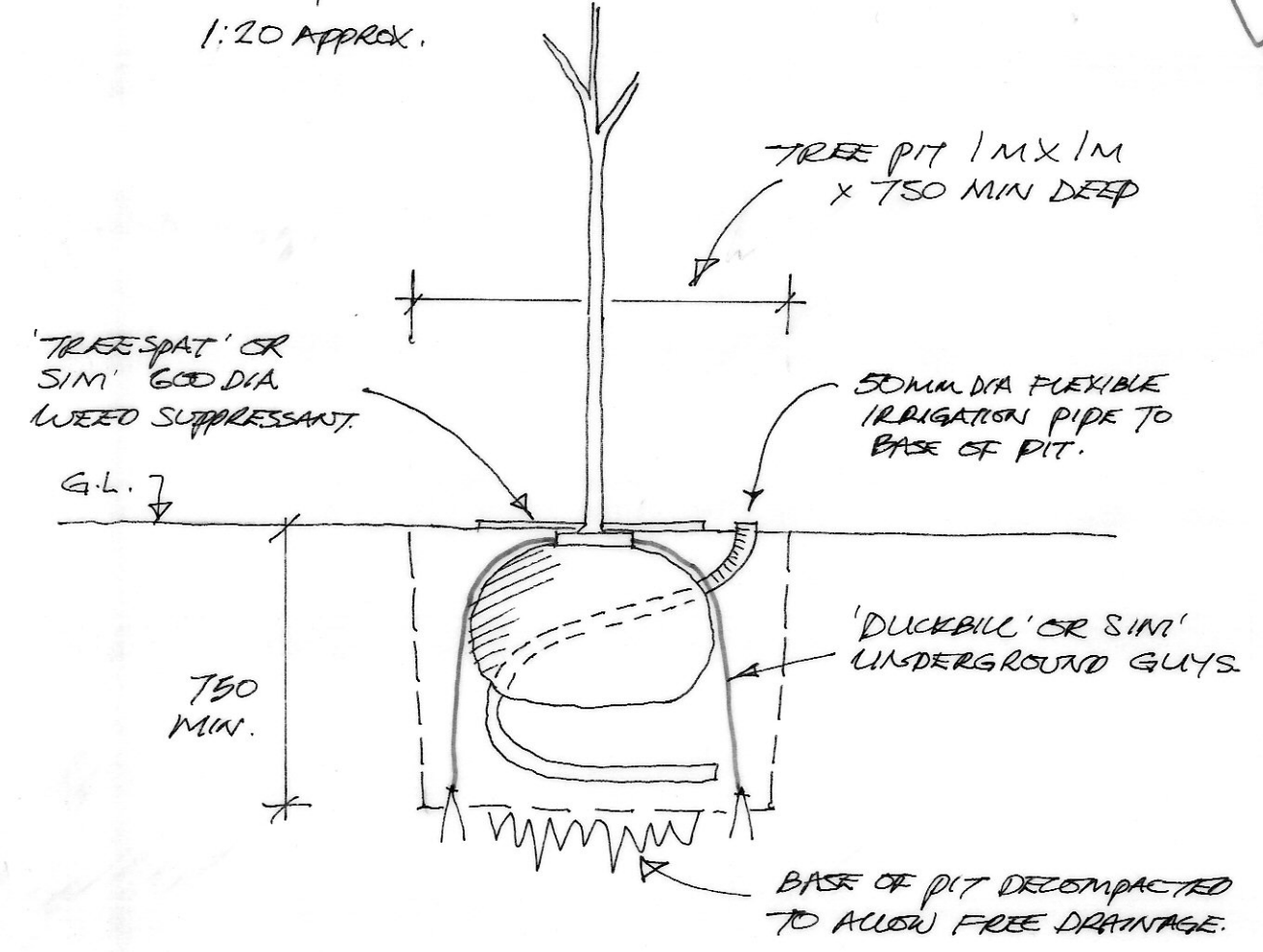

- TREE PITS EXCAVATED AND 20% PERT-FREE COMPOST MIXED WITH SOIL AS BACKFILL.  
 - IF EXISTING SOIL IS FOUND TO BE OF POOR QUALITY, IT IS TO BE REPLACED WITH NEW IMPORTED TOPSOIL (B.S. CERTIFIED).

FRONTAGE LANDSCAPING - DETAILS TO BE PREPARED FOLLOWING CONSULTATION WITH CLIENT, AND TO SATISFY L.A. WITH CONDITION WHERE APPLICABLE.

PRIVATE REAR GARDENS (SEPARATE DETAILS)

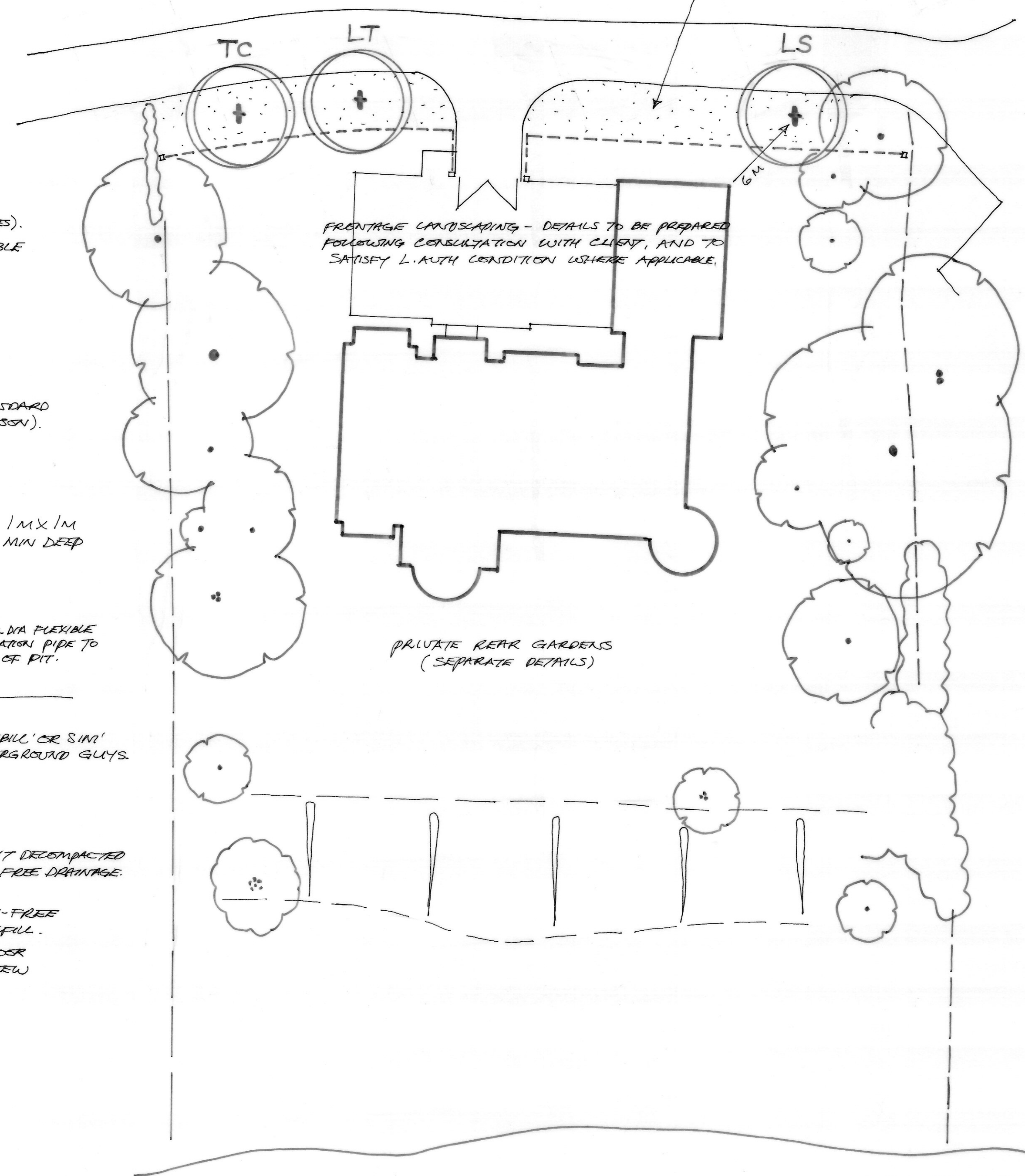

MAINTENANCE: (FOLLOWING PLANTING)  
 - TREES TO BE MONITORED MONTHLY FOR STABILITY ('WIND ROCK') AND FIRMED IN IF REQUIRED.  
 - GROUNDSPRE OR SIMILAR GENERAL FERTILISER TO BE APPLIED ANNUALLY IN MARCH.  
 - WATERING - FIRST 2 YEARS AFTER PLANTING IF THERE HAS BEEN NO APPRECIABLE RAINFALL FOR 10 DAYS, TREES TO BE WATERED AT 3-DAY INTERVALS UNTIL VISIBLE SOIL SATURATION (ALLOW ESTABLISHMENT).  
 - REPLACEMENT - PERIOD OF 5 YEARS FROM PLANTING OR OTHERWISE IF REQ'D BY L.A. WITH CONDITION.  
 - IF TREES FAIL FOR ANY REASON, OR ARE SERIOUSLY DAMAGED, THEY ARE TO BE REPLACED AS PER ORIGINAL SPECIFICATION IN THE FIRST AVAILABLE PLANTING SEASON.  
 - GOOD DIA 'RINGS' AROUND BASE OF EACH TREE TO BE KEPT WEED FREE BY USE OF TREESPAT OR REGULAR HAND WEEDING. SCRUBBING AT BASE OF TREE SHOULD NOT BE CARRIED OUT TO PREVENT BARK DAMAGE.

REPLACEMENT DWELLING AT YEW HOUSE OLD HALL DRIVE ELFORD

REPLACEMENT TREE PLANTING

1:200 (A2) JUNE '22 DRG No. 2

MARTIN F. HOLLAND CMLI LANDSCAPE DESIGN CONSULTANT

WOODSIDE HOUSE MUCKLOW HILL HALESOWEN WEST MIDLANDS B62 8BT TEL 0121 503 0507 EMAIL martinmf@aol.com