



Internal Units			
Name	Level	Flat no.	Type
U34	Third	5	Wall mounted
U35			Perfera-CTXM-R
U36			Daikin
U31	Third	6	Wall mounted
U32			Perfera-CTXM-R
U33			Daikin

External Unit	Type	Level served	Colour assigned
C1	4MXM-N9 Daikin	Third floor (flat 6)	-----
C2		Third Floor (flat 5)	-----
C3		First Floor	-----
C4		Second floor	-----

-  Existing indoor unit
-  Proposed indoor unit

Method statement for internal openings

- The contractor is to perforate the walls using a drill bit hole saw to ensure a clean opening
- All external openings to be perforated from the inside

Air conditioning equipment

- Internal Units: Perfera-CTXM-R Daikin
- External Units: 4MXM-N9 Daikin

SCALE 1:5

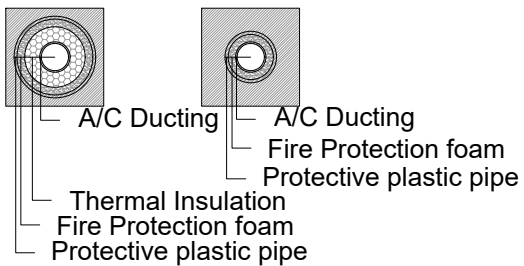

UPBROOK MEWS

GLOUCESTER TERRACE

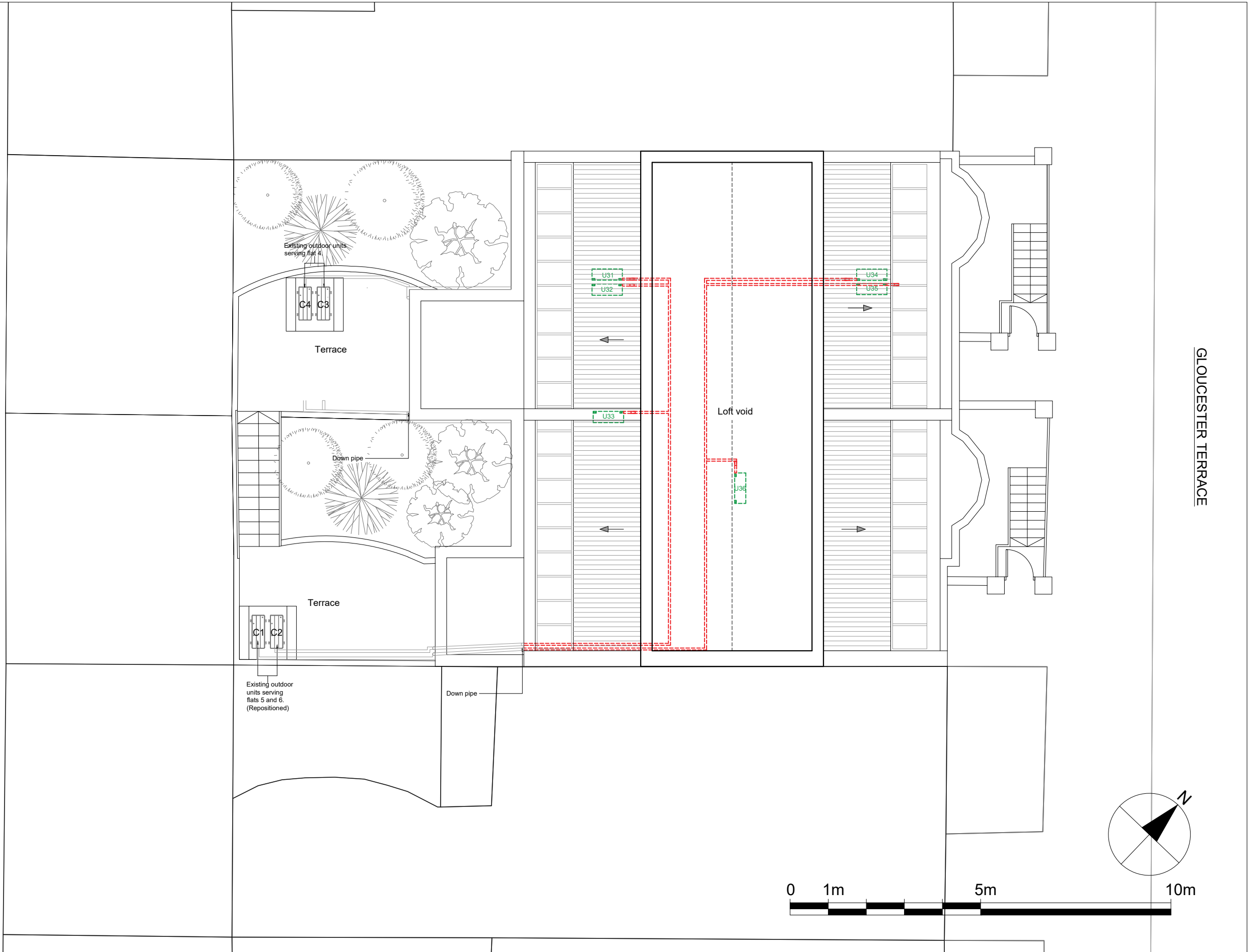

Dimensions Written dimensions to be taken in preference to scaled dimensions. The Contractor is responsible for checking all dimensions before work starts.

Local Authority All work is to be carried out to the requirements, and to the satisfaction of the Local Authority. These drawings are for planning purposes only.

Discrepancies Any discrepancies to be brought to the attention of Drawing And Planning Ltd. Immediately.

REVISIONS				
REV	DATE	DESCRIPTION	BY	CH

PROJECT TITLE
Flat 4-6, Gloucester terrace

DATE
June 2022

REVISION
/

DRAWING TITLE
Proposed - Loft Plan

CLIENT
Michele Beiny Harkins

DRAWING No.
GLOCE-P105

SCALE @ A3
1:100

