

Ground Floor Plan (As Existing)

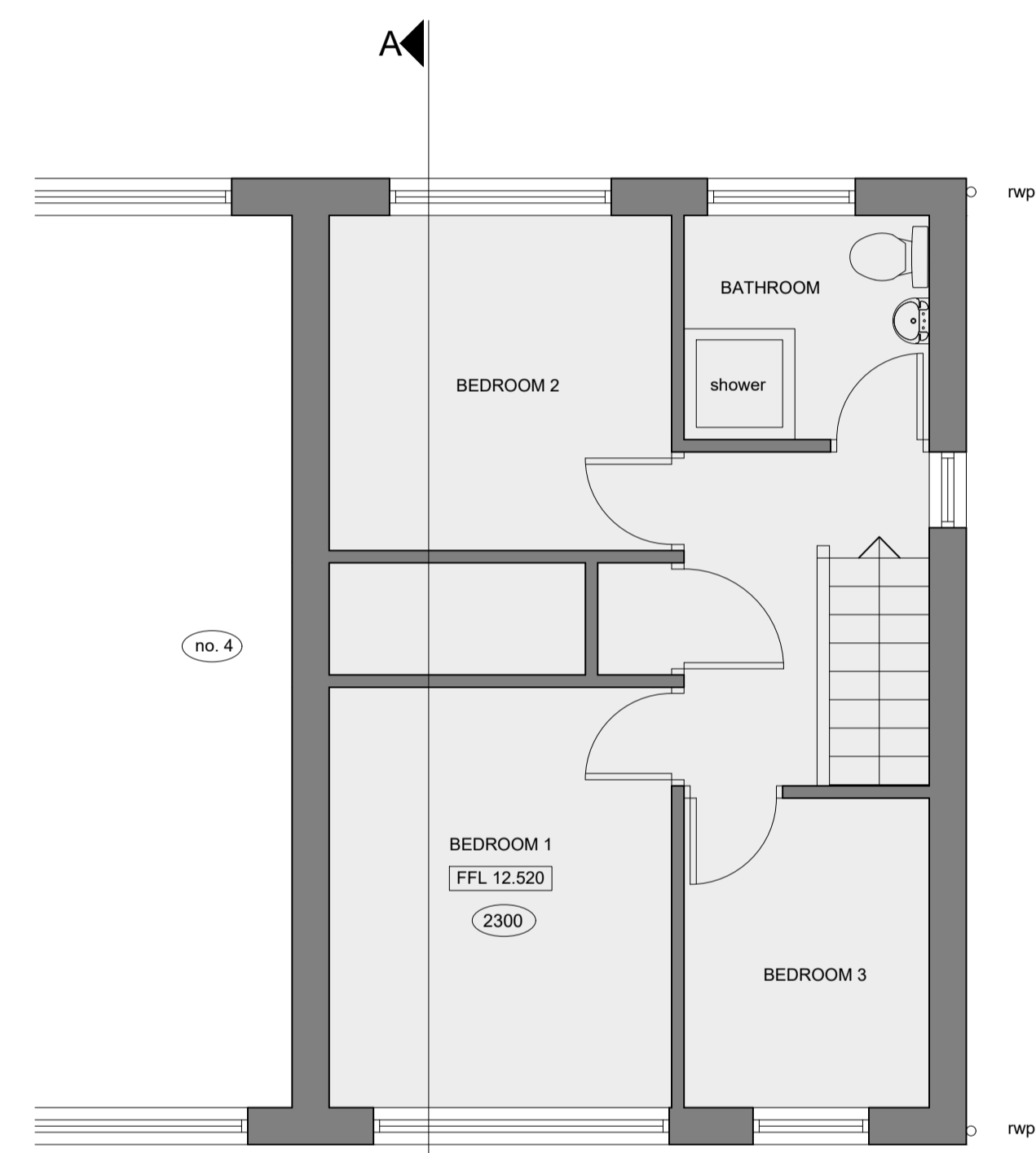

First Floor Plan (As Existing)

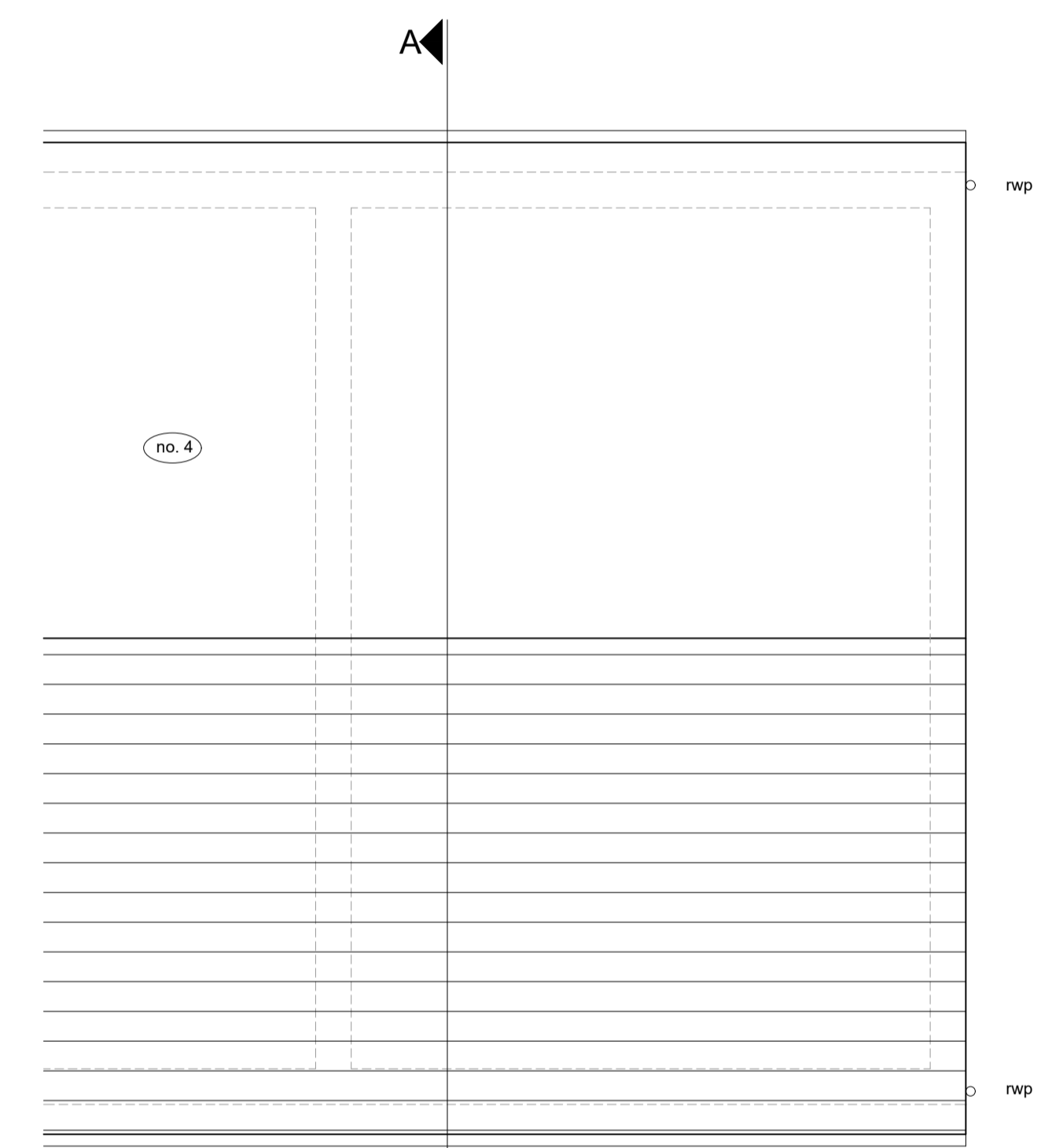

Roof Plan (As Existing)

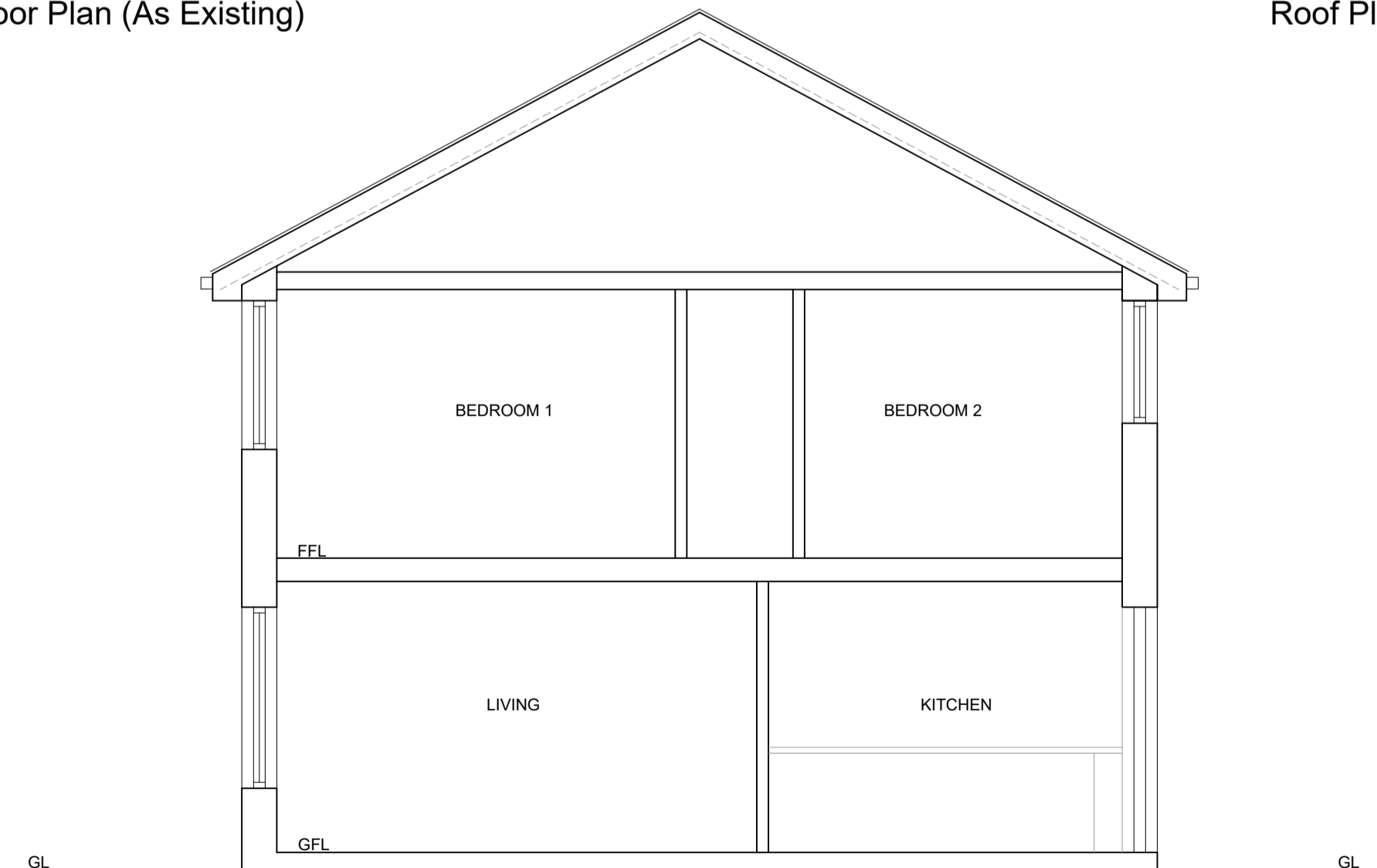

Section A-A (As Existing)

- GENERAL NOTES**
- ALL WORK TO BE CARRIED OUT IN STRICT ACCORDANCE WITH THE BUILDING REGULATIONS AND TO THE SATISFACTION OF THE LOCAL AUTHORITY (TOWN & COUNTRY PLANNING, BUILDING CONTROL AND DRAINAGE DEPARTMENTS).
 - APPOINTED CONTRACTOR RESPONSIBLE FOR NOTIFYING LOCAL AUTHORITY BUILDING CONTROL DEPARTMENT UPON COMMENCEMENT OF BUILDING WORKS ON SITE.
 - DIMENSIONS ALL TO SITE CHECK. DISCREPANCIES IF ANY TO BE BROUGHT TO THE MERCHANT'S ATTENTION OF THE DESIGNER.
 - THESE PLANS HAVE BEEN PREPARED FOR SUBMISSION TO THE LOCAL AUTHORITY FOR TOWN & COUNTRY PLANNING AND / OR BUILDING REGULATIONS PURPOSES ONLY AND DO NOT CONSTITUTE FULL WORKING DRAWINGS. INFORMATION NOTED ON THE PLANS OR ACCOMPANYING DOCUMENTS / DETAILS IS NOT EXHAUSTIVE, AND CONTRACTOR TO CHECK WITH CLIENT AS TO ANY ADDITIONAL WORK NOT SPECIFICALLY NOTED OR IMPLIED.
 - ALL MATERIALS ARE TO BE USED IN STRICT ACCORDANCE WITH THE RECOMMENDATIONS OF THE MANUFACTURERS.
 - ANY WORK COMMENCING ON SITE PRIOR TO BUILDING REGULATIONS APPROVAL IS NOT RECOMMENDED AND IS ENTIRELY THE RESPONSIBILITY OF THE CLIENT.



01535 630772
 info@larkarchitects.co.uk www.larkarchitects.co.uk
 client: Shaun Wood
 project: 2 Tewitt Close, Steeton.
 Proposed two storey side extension
 drawing: Existing plans & section

status: Planning	job no: 1209	dwg no: 02	rev:
scale: 1:50 @ A1	drawn: R.A.K.	check: R.A.K.	
date: June 2022	This drawing is copyright of LARK architects Ltd		

LARK Architects Ltd
 Unit 10 Riparian Court, Riparian Way,
 The Crossings, Green Hills,
 Kettlewell, West Yorkshire, BD20 7BW. Chartered Practice

