

© This drawing and design are copyright.
 Do not scale from this drawing. Use only figured dimensions. If in doubt, ask.
 All dimensions are to be checked on site.
 Any discrepancies should be reported immediately to the Architect.

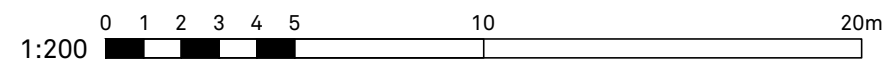
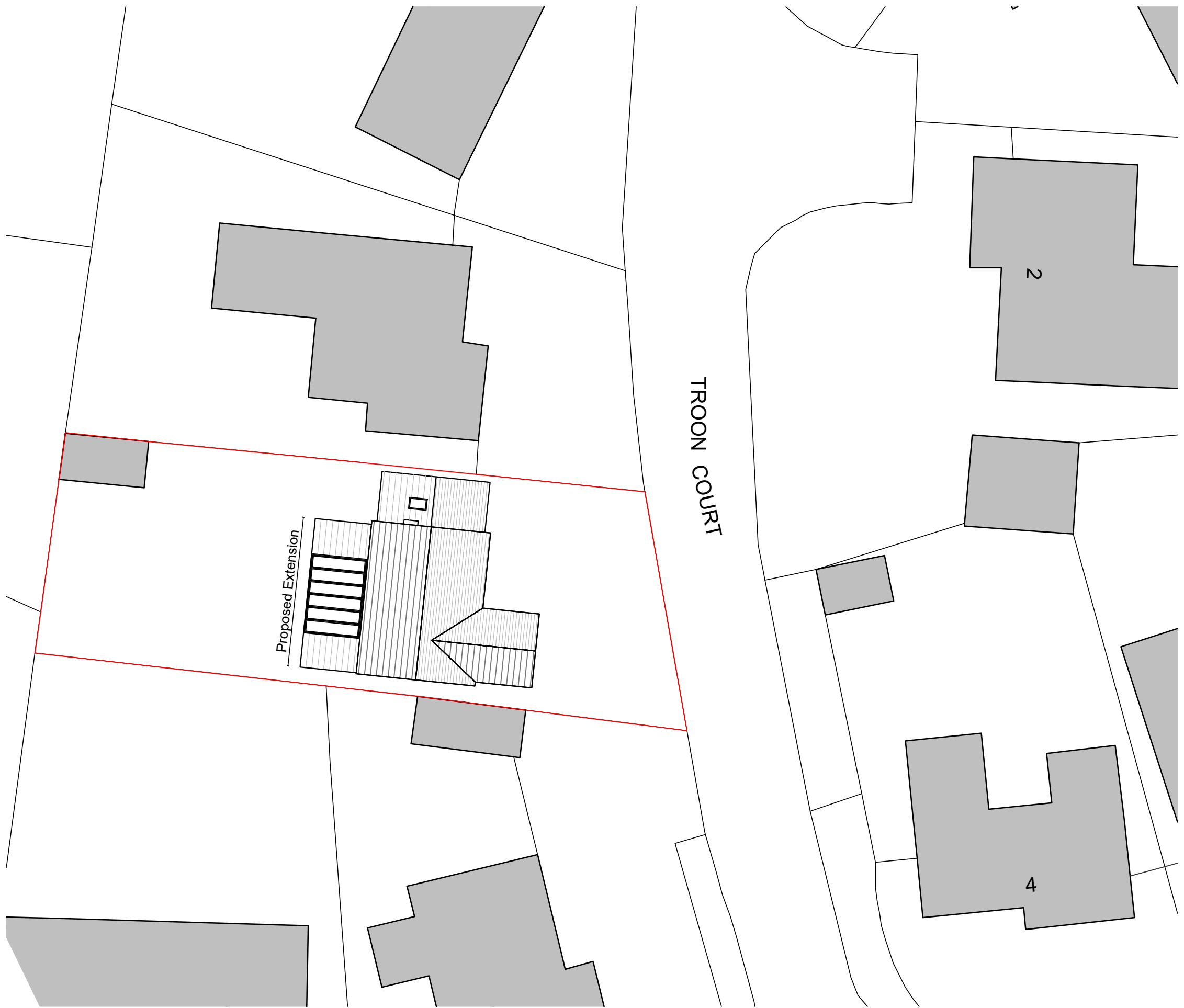
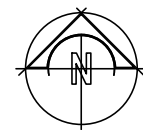

DATE	REV	DESCRIPTION	DRAWN

**PatrickAllen&Associates
Architects**
 architects@patrickallen.org.uk 2 Grange Business Centre
 www.patrickallen.org.uk Tommy Flowers Drive
 +44 (0)1473 620660 Grange Farm
 Kesgrave, Ipswich
 Suffolk, IP5 2BY

Project
 Proposed Extension and Alterations at;
 3 Troon Court, Fornham St Martin,
 Bury St Edmunds, IP28 6TJ

Client
 Mr J. Gould

Drawing Title
 Proposed Block Plan

Drawing Status
 Planning

Scale	Paper Size	Date	Drawn
1:200	A3	June 2022	AG

Drawing Number	Drawing Rev
4345-04	/