

PROPOSED 2 STOREY EXTENSION WITH INTERNAL ALTERATIONS TO MAIN HOUSE AND REFURBISHMENT OF EXISTING 1-BED RESIDENTIAL ANNEXE INCLUDING ALTERATION TO EXISTING FENESTRATION AT 2 MARLEY'S COTTAGE, NEWHOUSE LANE, SHELDWICH, FAVERSHAM, ME13 9QS.  
 DRG NO 10 JUNE 22.01 DATE JUNE 2022  
 SCALE 1:850

© MICHAEL MILLER LOCAL ARCHITECT 01795 890925

REFER TO PLANNING APPLICATION - IMPORTANT NOTES ON DRG NO 10 JUNE 22.02

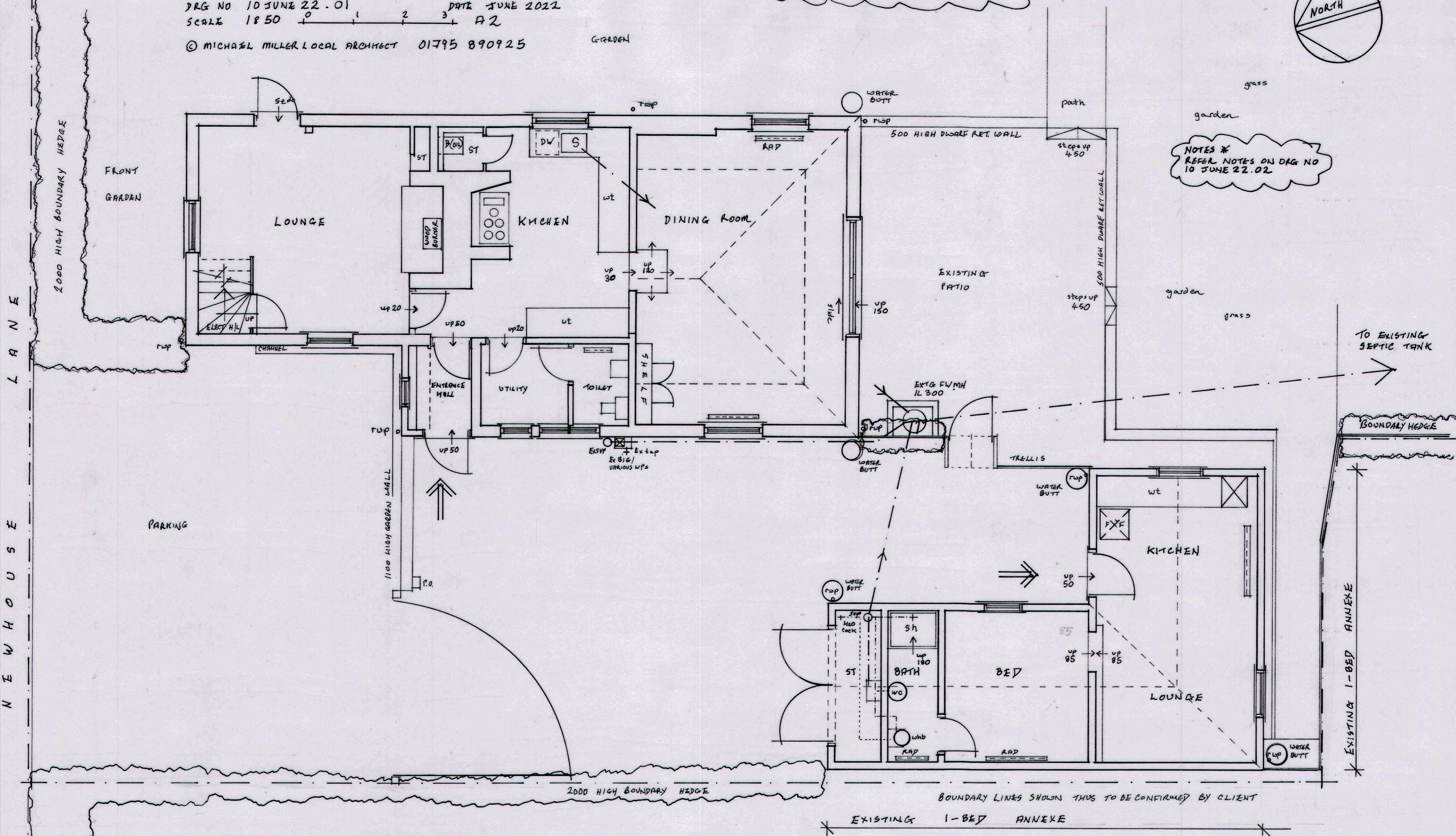
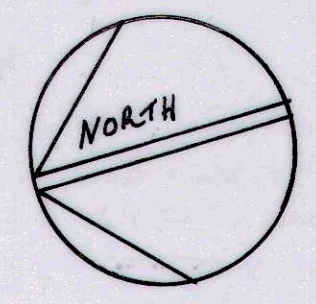

NEWHOUSE LANE

EXISTING GROUND FLOOR PLAN

EXISTING 1-BED ANNEXE

BOUNDARY LINES SHOWN THUS TO BE CONFIRMED BY CLIENT

NOTES \* REFER NOTES ON DRG NO 10 JUNE 22.02