

proposed floor plan

scale: 1:50 @ A1
 existing walls
 proposed external insulation and render

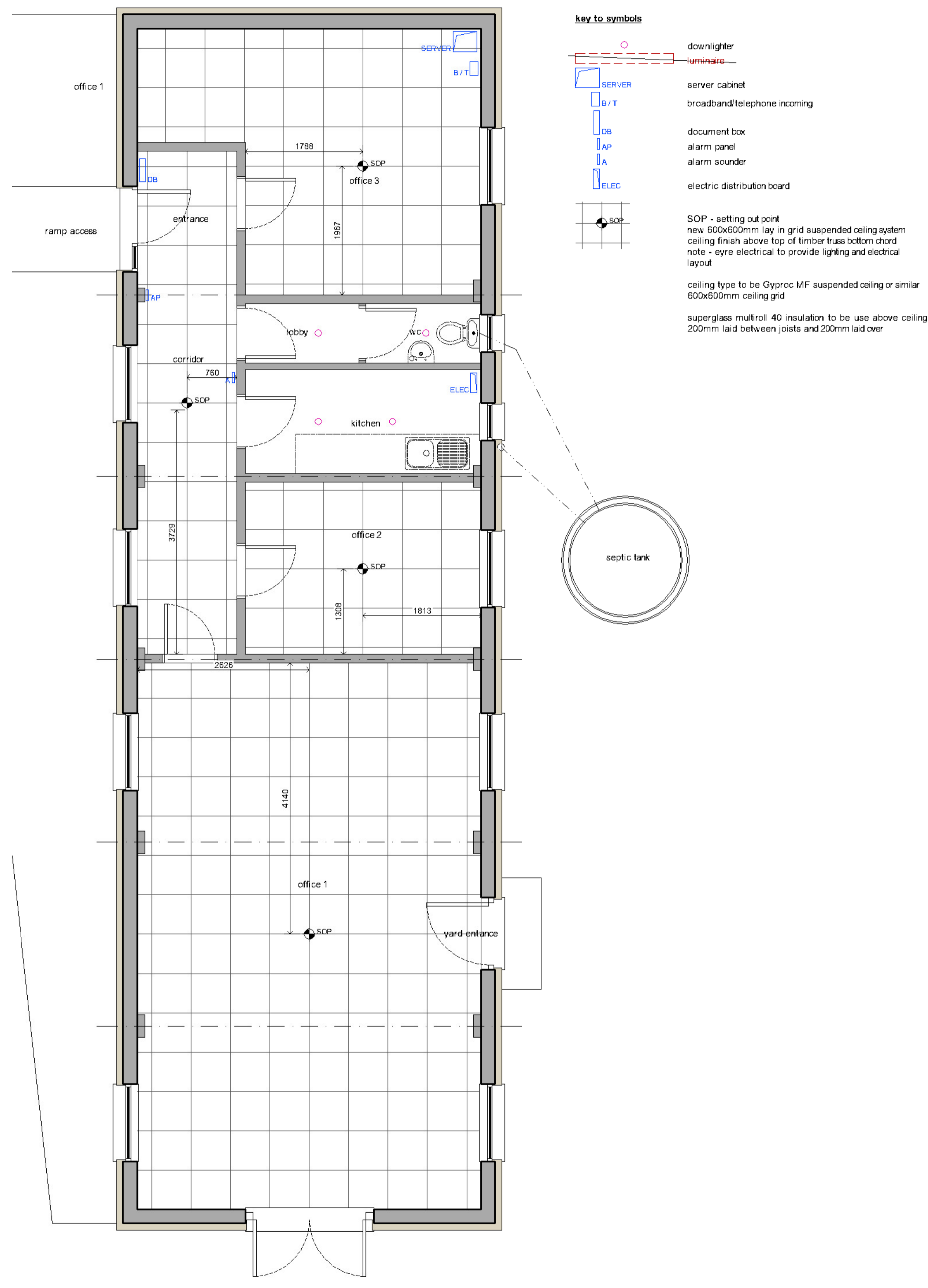

proposed reflected ceiling plan - with some wall mounted items

scale: 1:50 @ A1
 existing walls

key to symbols

- downlighter
- luminaire
- server cabinet
- broadband/telephone incoming
- document box
- alarm panel
- alarm sounder
- electric distribution board
- SOP - setting out point
- new 600x600mm lay in grid suspended ceiling system ceiling finish above top of timber truss bottom chord
- note - refer electrical to provide lighting and electrical layout
- ceiling type to be Gyproc MF suspended ceiling or similar 600x600mm ceiling grid
- superglass multifoil 40 insulation to be used above ceiling 200mm laid between joists and 200mm laid over

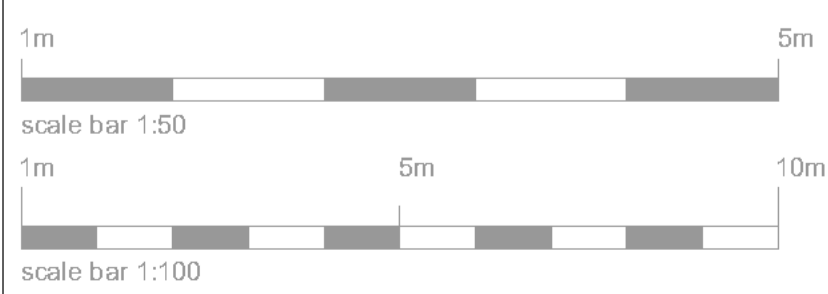

plan | it
 architecture & design

telephone 01954 252 222
 mobile 07786 138 921
 email plan_it@me.com
 web www.plan-it-architecture.com

client **Brown & Ralph Ltd**
 station road, longstanton, cambridge, CB24 3FB

project refurbishment of existing office building at Northfield Farm, Lode Road, Botolphay, installation of new windows, external insulation and render to building envelope

status **PLANNING**

drawing title **proposed floor plan and reflected ceiling plan**

date 210622 scale as indicated sheet size A1 rev

job no. drawing no. revision
667 22PL103