

LOCATION PLAN
 North SCALE 1:1250

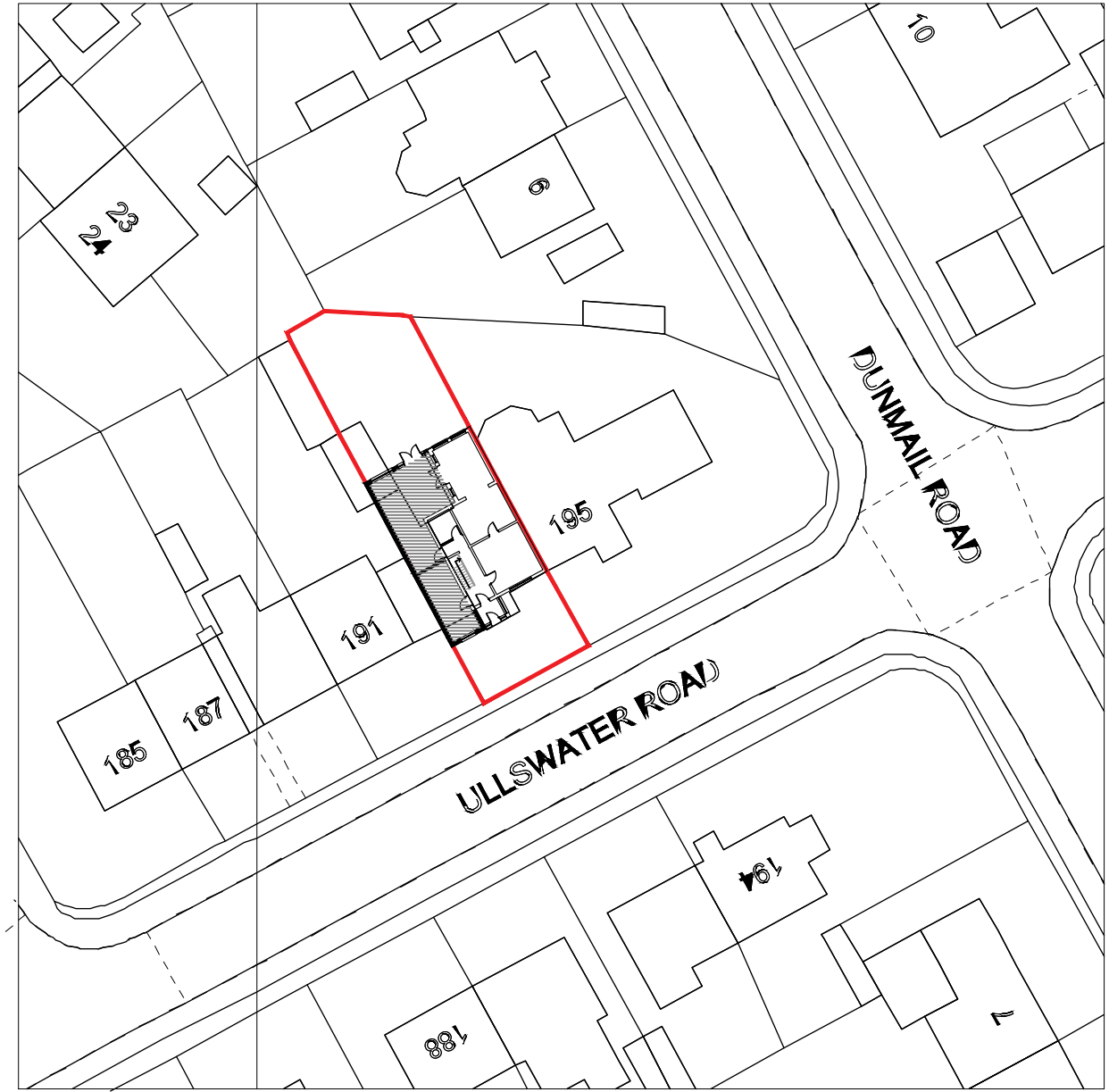

SITE PLAN
 North SCALE 1:500

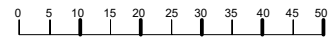
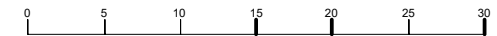

GENERAL NOTES:-

- ALL DIMENSIONS TO BE CHECKED
- THIS DRAWING IS TO BE READ IN CONJUNCTION WITH ALL OTHER PROJECT DRAWINGS, CONSTRUCTION NOTES AND/OR PROJECT SPECIFICATION.
- ANY CONSTRUCTION WORK CARRIED OUT PRIOR TO RECEIVING NECESSARY APPROVALS IS ENTIRELY AT THE PROPERTY OWNERS/CLIENTS/BUILDERS RISK.
- ALL MATERIALS AND METHODS OF WORK TO COMPLY WITH ALL RELEVANT BRITISH STANDARDS AND/OR B.S. CODES OF PRACTICE. THE BUILDER IS TO ENSURE THAT ALL MATERIALS USED ARE FIT FOR THE PURPOSE.
- CONTRACTOR IS TO CARRY OUT A RISK ASSESSMENT FOR ALL ASPECTS OF THE CONTRACT, IN ACCORDANCE WITH THE HEALTH & SAFETY AT WORK ACT, AND IS TO COMPLY IN FULL WITH THE CDM REGULATIONS GIVING THE REQUIRED NOTICES TO ALL REGULATIVE BODIES (INCLUDING THE HEALTH & SAFETY EXECUTIVE).
- IT IS THE BUILDERS / PROPERTY OWNERS RESPONSIBILITY TO OBTAIN ALL NECESSARY PARTY WALL AGREEMENTS. THESE SHOULD BE OBTAINED PRIOR TO ANY WORK BEING CARRIED OUT.

- PRIOR TO THE COMMENCEMENT OF ANY WORKS, THE BUILDER IS TO CHECK AND/OR DETERMINE ALL CONSTRUCTION DETAILS, INCLUDING CHECKING SITE LEVELS AND DIMENSIONS.
- CLIENT TO CONFIRM IF THERE ARE ANY PUBLIC DRAINAGE PIPES WITHIN 3M OF THE PROPOSED EXTENSION AND THEN SECURE APPROVAL FROM WATER AUTHORITY TO BUILD OVER OR CLOSE TO ACCESS TO A MANHOLE TO BE ADVISED BY CLIENT FOR ALL NECESSARY CCTV SURVEYS TO SATISFY WATER AUTHORITY PRE AND POST BUILDING WORKS.
- ALL WORKMANSHIP SHOULD BE CARRIED OUT IN WORKMAN LIKE MANNER AND STRICTLY IN ACCORDANCE WITH CODE OF PRACTICE AND TO BRITISH STANDARDS.
- SHOULD THE CONTRACTOR FIND ANY ERROR/S IN THE DRAWINGS THEN HE MUST CADDWORX LIMITED PRIOR TO COMMENCEMENT / ORDERING ANY MATERIAL.

COPYRIGHT © - THIS DRAWING IS COPYRIGHT & SHOULD NOT BE REPRODUCED WITHOUT PERMISSION

CADDWORX ibrahim_villasenor@yahoo.com 07588490689	ADDRESS: 193 ULLSWATER ROAD SOUTHMEAD BRISTOL BS10 6ED	Drawing No: P000 Rev:
	PROJECT:	DRAWING: LOCATION AND SITE PLANS