

THIS DRAWING IS TO BE READ IN CONJUNCTION WITH ALL RELATED DRAWINGS. ALL DIMENSIONS MUST BE CHECKED AND VERIFIED ON SITE BEFORE COMMENCING ANY WORK OR PRODUCING SHOP DRAWINGS. THE ORIGINATOR SHOULD BE NOTIFIED IMMEDIATELY OF ANY DISCREPANCY. THIS DRAWING IS COPYRIGHT AND REMAINS THE PROPERTY ROGER PARRY & PARTNERS.

Rev	Description	Date	By
-	-	year/mm/dd	--

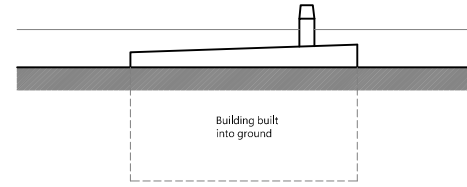

EXISTING NORTH WEST ELEVATION

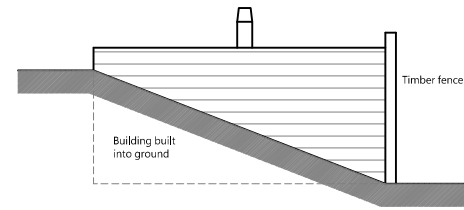

EXISTING SOUTH WEST ELEVATION

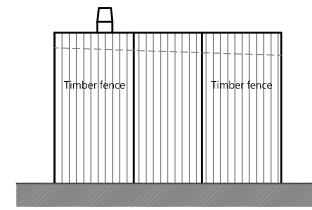

EXISTING SOUTH EAST ELEVATION

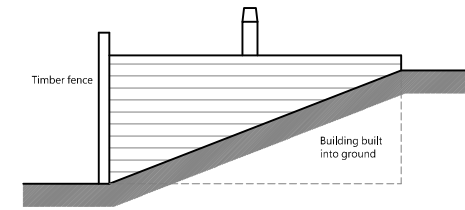

EXISTING NORTH EAST ELEVATION

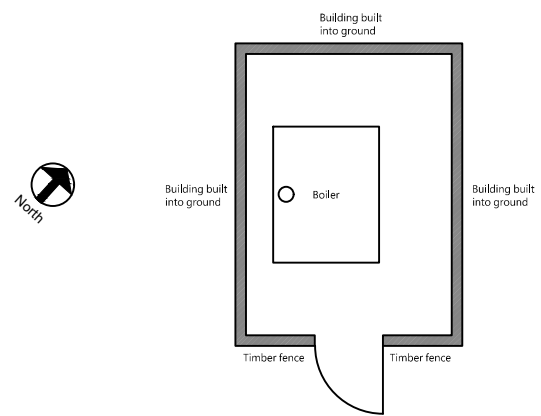

EXISTING FLOOR PLAN



Residential - Agricultural - Commercial

Project	Installation of Biomass Boiler (Retrospective)		
Drawing Title	Existing Plan & Elevations		
Location	Betws Hall Farm, Bettws Cedewain, Powys, SY16 3DS		
Client	G Evans		
Scale	1:100 @ A3		
Drawing No	75948 / GD / 100	Rev	-
Drawn By	NB	Date	2022/07/04

HOGSTOW HALL, MINSTERLEY
 SHREWSBURY, SHROPSHIRE. SY5 0HZ
 Tel: 01743 791336 Fax: 01743 792770
 E-mail: mail@rogerparry.net
 Web address: www.rogerparry.net
Roger Parry & Partners LLP partnership no. OC312203
 Registered Office Hogstow Hall, Minsterley, Shrewsbury, SY5 0HZ
 Registered in England and Wales.
 A list of members of the LLP is available at the above address.