

New fireplaces fitted where they are currently absent see heritage statement

New electrical cable runs to be chased into historic plaster. No picture rails, dado rails or skirtings to be cut into

New heating pipe runs to be fitted sensitively. Not chased into plaster but surface run in carefully considered locations.

Distribution board

Units fitted for the utility room

New ceiling to a lower level

Door changed back to a window

Replacement door

New kitchen fitted as per earlier LBC approval  
Suspended timber floor to be repaired, and UFH fitted. Manifold to be fitted into the back of a kitchen cupboard

Door to be hinged on the right, rather than the left as existing)

New manhole (approved under kitchen LBC)

PHASE I WORKS to the north and west of this line

existing combined drain



23 Union Street, Wells, Somerset, BA5 2PU 01749 673006 mail@cjarchitects.co.uk

Number  
1897/P/01

Project  
Repairs and Alterations  
Mellifont Abbey  
Mr Simon Parks

All dimensions to be checked on site Copyright reserved  
Title  
GROUND FLOOR  
PHASE I  
As Proposed  
Scale  
1/100 @ A3  
Drawn  
Date  
July 2022  
Checked

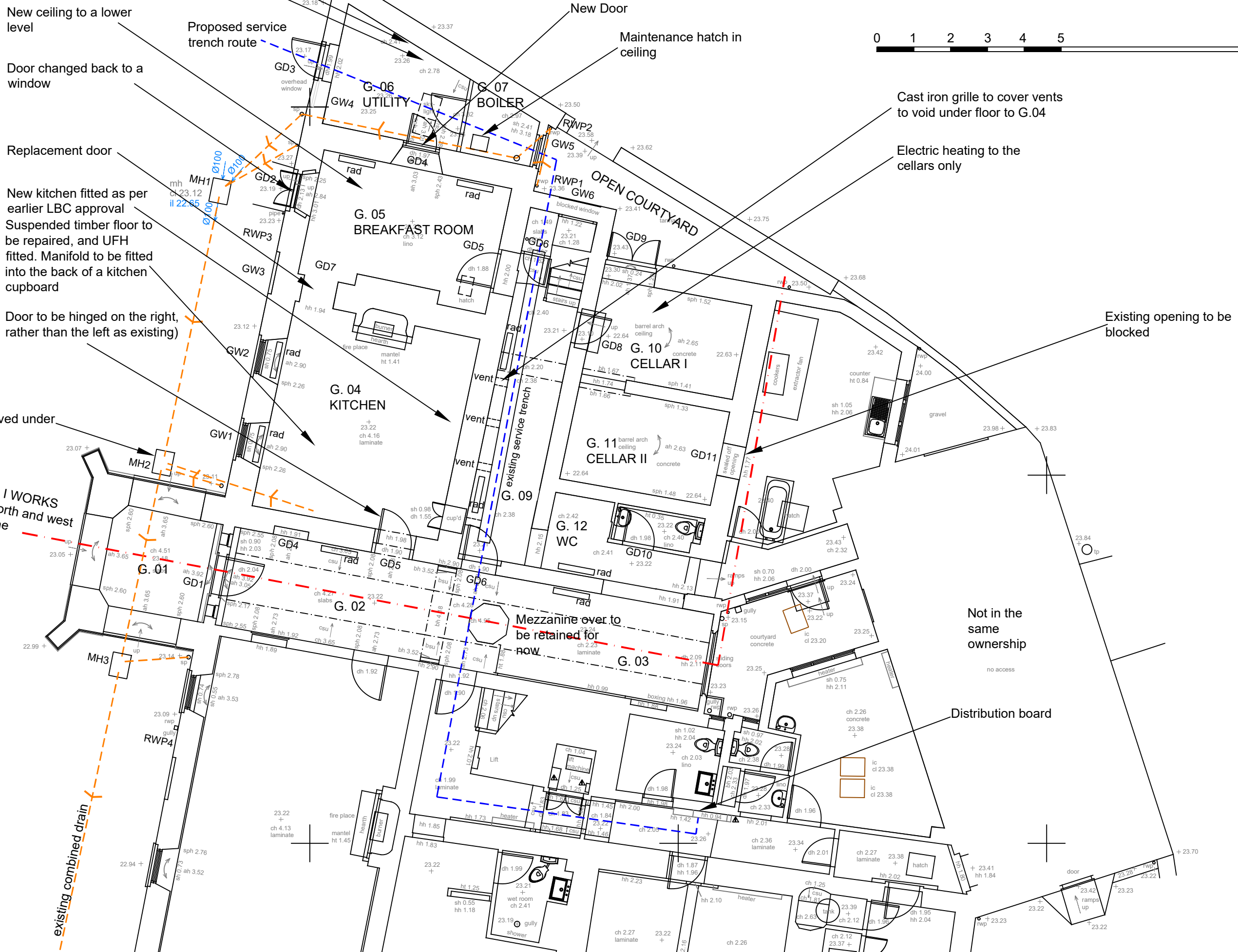
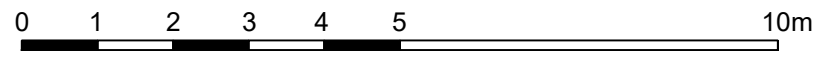

Cast iron grille to cover vents to void under floor to G.04

Electric heating to the cellars only

Existing opening to be blocked

Not in the same ownership

Distribution board

