

Dimensions (mm[inch])

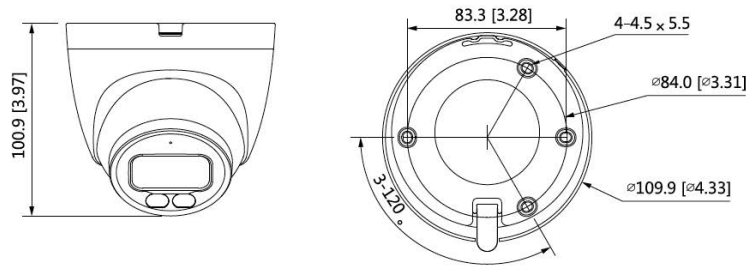

Structure

Casing	Inner core: metal; cover: plastic (pedestal: plastic)
Dimensions	100.9 mm \times \varnothing 109.9 mm (4.0" \times \varnothing 4.3")
Net Weight	0.365 kg (0.8 lb)
Gross Weight	0.527 kg (1.2 lb)

1 camera installed on barn which is visible from Deeves Hall Lane



2 cameras installed on the barn and are visible from Crossoaks Lane

