

Studio Cottage, Tarlton



Proposed Reconfiguration of Studio Cottage and Thatch Annex

Discharge of Conditions ref: 21/01430 and 21/01431

July 2022



Proposed replacement timber cladding to Thatch Annex

Untreated split pale larch cladding

Approximate board size: 150mm

Fixings: As existing

Supplier: Hailey Wood Saw Mill



Fig. 1 Sample of proposed replacement timber cladding to Thatch Annex

**Proposed new timber cladding to Studio Cottage
where required to replace existing boards**

Untreated sawn green oak cladding

Approximate board size: To match existing

Fixings: As existing

Supplier: Hailey Wood Saw Mill



Fig. 2 Sample of proposed new timber cladding to Studio Cottage where required to replace existing boards.

Proposed Floor finish to Glazed Link

Polished Concrete

Proposed Light Fittings

Internal: Delta wall light [up and down]

External: Adjustable Recessed LED Uplight



Fig. 3 Sample of proposed Floor finish to Glazed Link



Fig. 4 Delta Wall light (up + down)



Fig. 5 Adjustable recessed LED uplight

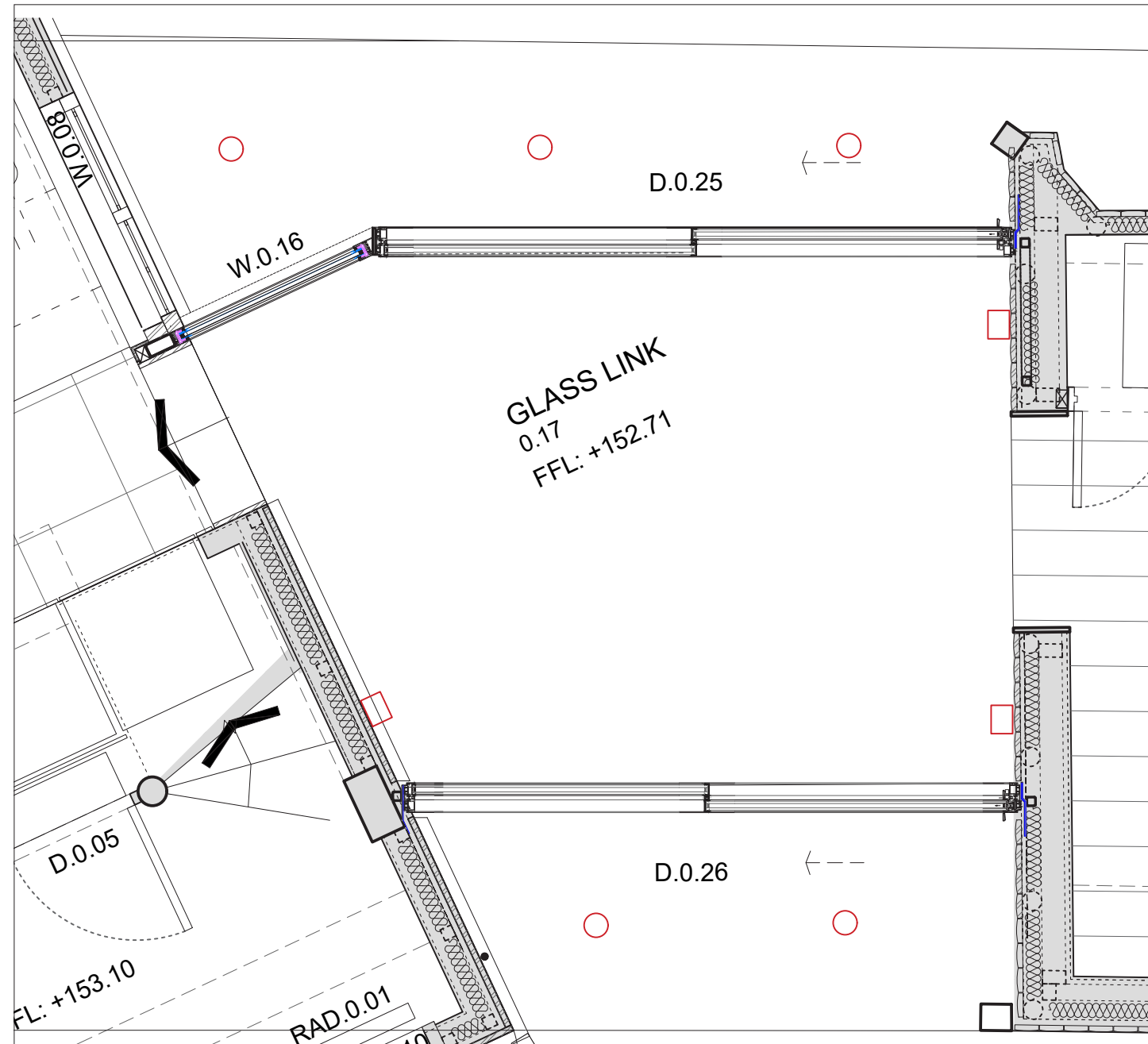

Fig. 6 Positions of lighting to Glazed Link

KEY

○ Recessed Uplight

□ Wall Light



Fig. 7 Matt oiled oak veneer solid core door example image

