

NOTES - Responsibility is not accepted for errors made by others in scaling from this drawing. All construction information should be taken from figured dimensions only. All dimensions are in millimeters. For construction details refer to building regulation notes and structural engineers design where applicable

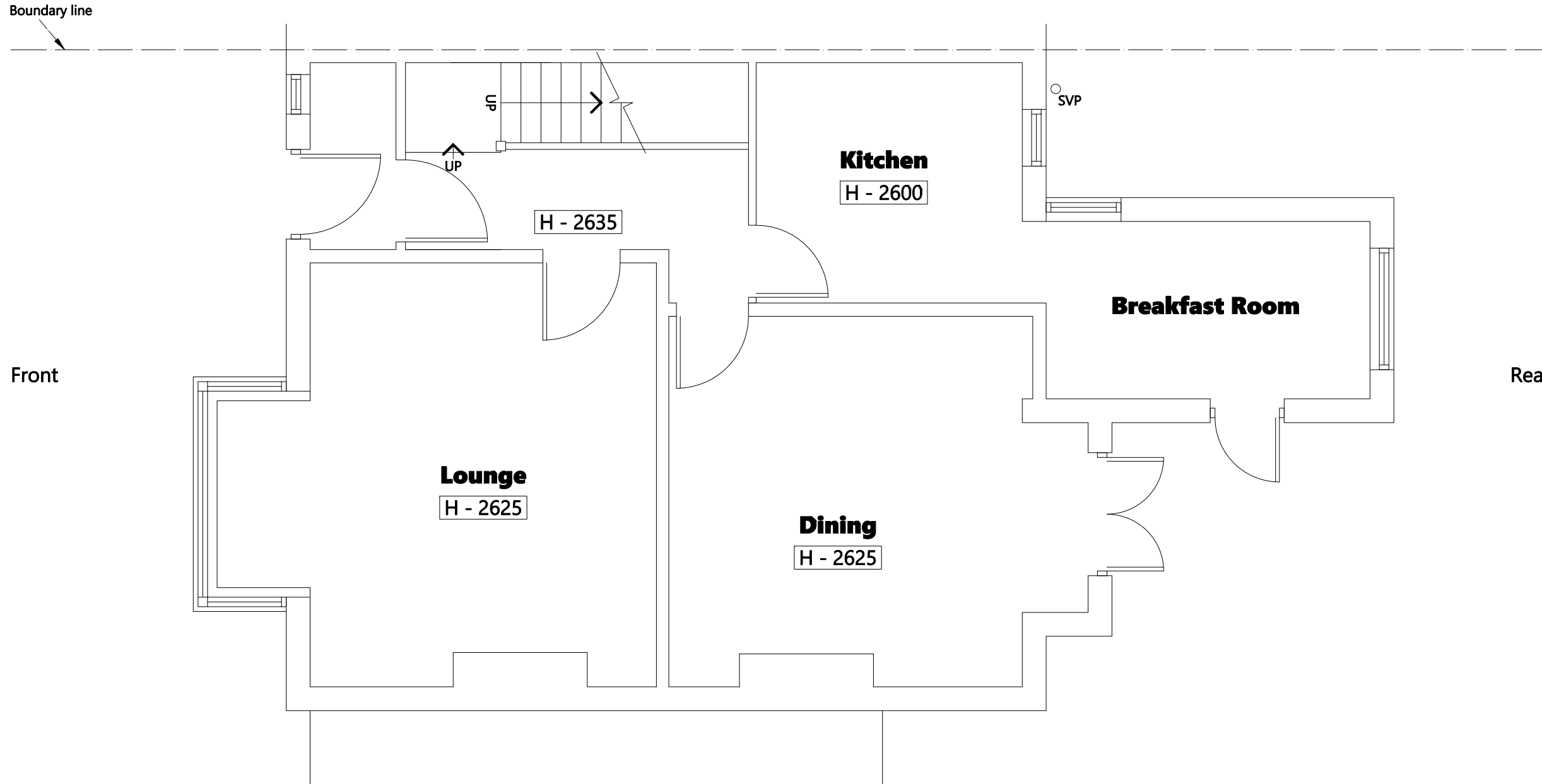

Clifton Design (Bristol) 25 Lower Redland Road Redland Bristol BS6 6TB 0117 973 6000	Rev	Description of Changes	Drawn	Date	Client	Postcode	Drawing Title		
	-	-	-	-	Mr B Lynam	BS7 0BZ	Ground Floor Plan - Existing		
	Scale	0 1m 2m 3m 4m 5m 1:50			Address	Date	Drawing No 24/HR/H/02/P		
					24 Highbury Road, Horfield	Apr.2022	Drawn dM	Option 1b	Rev -