

NOTES:- RESPONSIBILITY IS NOT ACCEPTED FOR ERRORS MADE BY OTHERS IN SCALING FROM THIS DRAWING. ALL CONSTRUCTION INFORMATION SHOULD BE TAKEN FROM FIGURED DIMENSIONS ONLY. ALL DIMENSIONS ARE IN MILLIMETERS

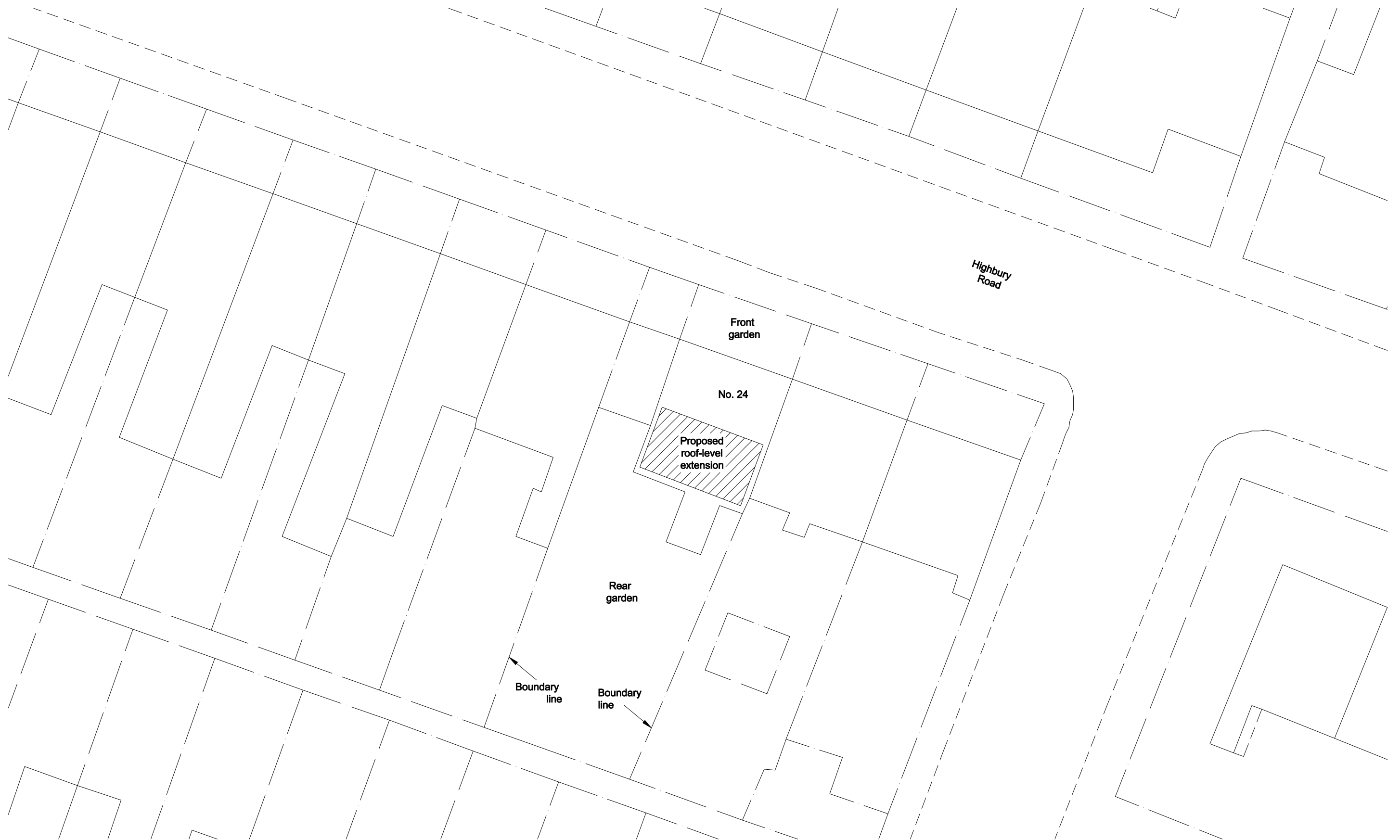

Clifton Design (Bristol) 25 Lower Redland Road Redland Bristol BS6 6TB 0117 973 6000	Rev:	Description of Changes:	Drawn:	Date:	North:	Client:	Postcode:	Drawing Title:		
	-	-	-	-	↑	Mr B Lynam	BS7 0BZ	Block Plan - Existing/Proposed		
	Scale: 1:200					0 4m 8m 12m 16m 20m	Address:	Date:	Drawing No:	Rev: -
						24 Highbury Road, Horfield	Apr.2022	Drawn: dM	420x297mm A3	Rev: -