

**NOTES**

This drawing is the property of Marshal Peters Associates Limited. Copyright is reserved by them and the drawing is issued on the condition that it is not copied in whole or in part without the express written consent of Marshal Peters Associates Limited. Dimensions should not be scaled. All dimensions to be checked on site by the contractor prior to commencement of the works.

**NOTE**  
All levels and coordinates relate to OSGB36(15) using GNSS data.

**ABBREVIATIONS**  
 AB Air Brick  
 ffl Finished Floor Level  
 RWP Rainwater Pipe  
 SVP Soil Vent Pipe  
 ch Ceiling Height  
 usb Underside of Beam  
 usr Underside of Ridge  
 ust Underside of Truss

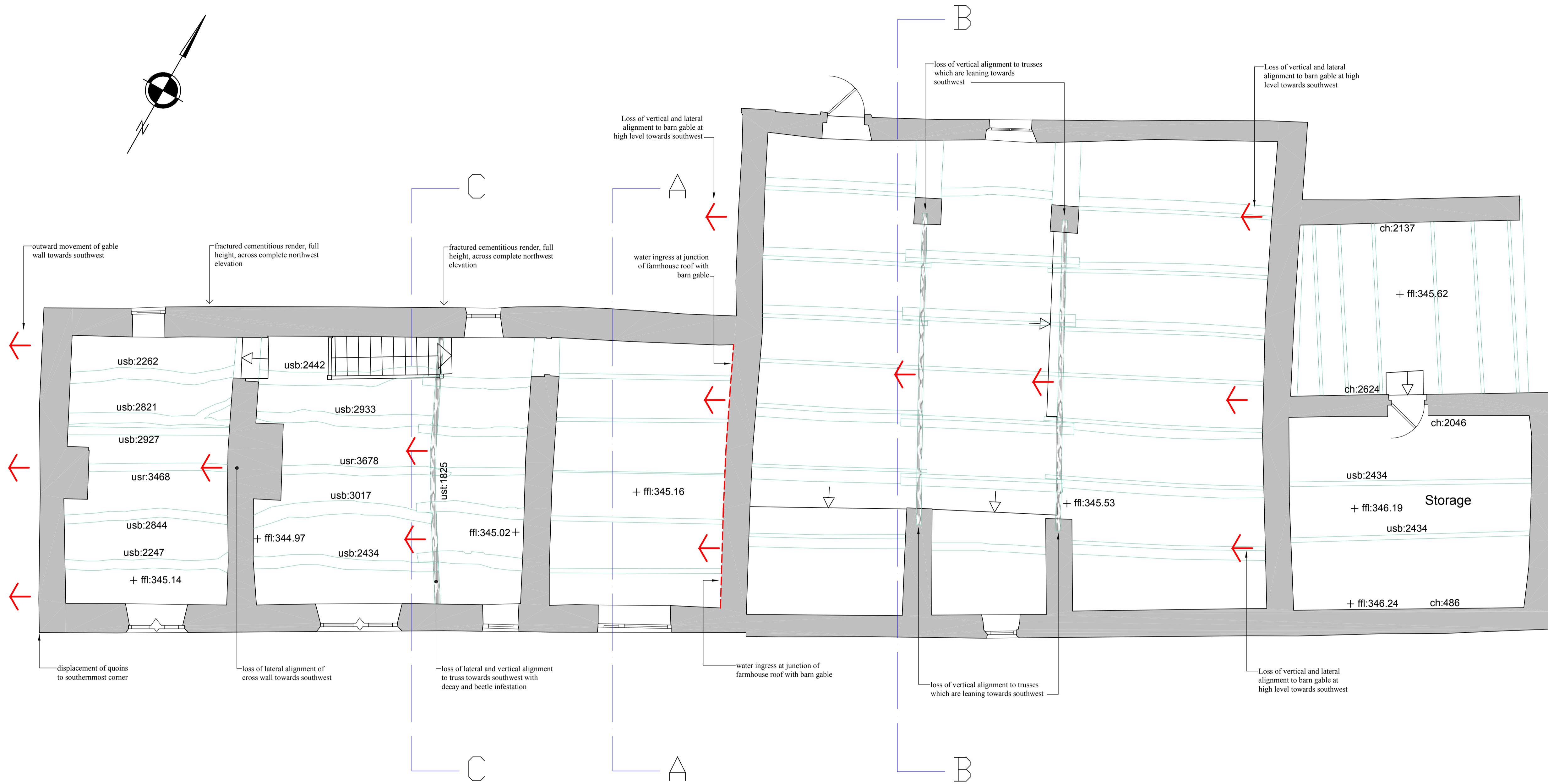
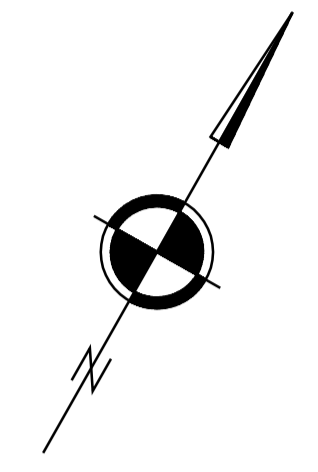

**FIRST FLOOR PLAN**

TO BE READ IN CONJUNCTION WITH DRAWINGS 2522:08 & 10

Revision	Date

**MARSHAL PETERS ASSOCIATES**  
 CHARTERED SURVEYORS & HISTORIC BUILDING CONSULTANTS

Marshal Peters Associates  
 Chartered Surveyors & Historic Building Consultants

1 Pendle View  
 Halton West  
 Skipton  
 North Yorkshire  
 BD23 4LL

Telephone 01729 850 688  
 Email info@marshalpeters.co.uk  
 Web www.marshalpeters.co.uk

PROPOSED REPAIRS to  
 WHITE HOLE  
 PECKET WELL  
 HEBDEN BRIDGE  
 on behalf of  
 The Savile Trust 1965

Title **EXISTING**

Drawing no. **2522: 09** Revision

Scale 1:50 @ A1 Drawn mfp Date July 2022