

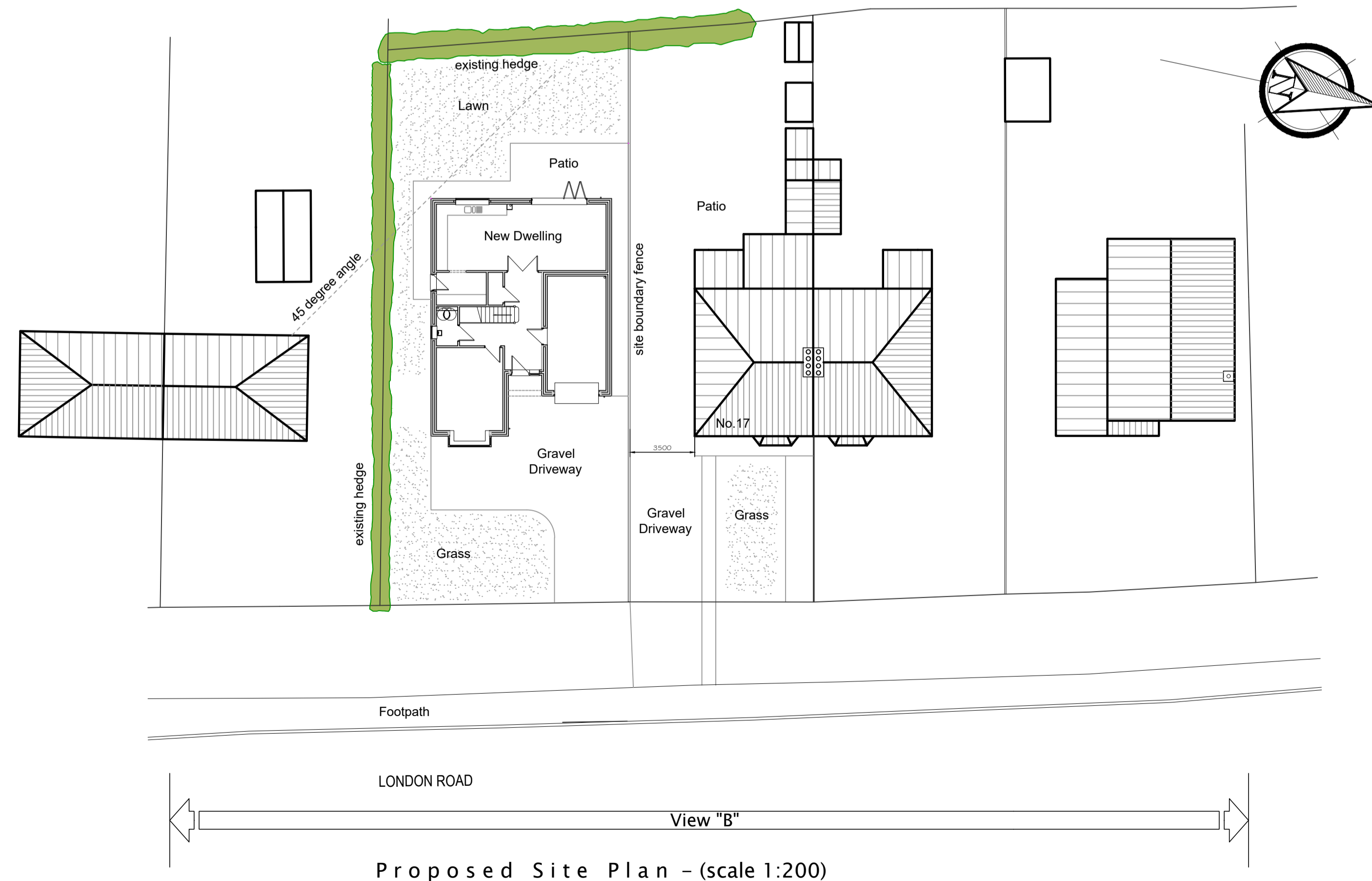

VIEW "B" - 17 London Road - Proposed Street Scene - (scale 1:100)



Proposed Street Scene Visuals (not to scale)



Proposed Site Plan - (scale 1:200)

this drawing is for outline planning purposes and should only be used as a guide

Revision	Amendment	Date

Client:

Project: Proposed Erection of Dwelling Land Adj to No. 17 London Road Osbournby, Sleaford Lincolnshire

Dwg Title: Proposed Site Plan, Street Scene and Visuals

Dwg No: 222958-02 Scale: Date: 06/22

Rick Smith Design
 Architectural Design Consultancy
 Ardent House, 18 Eastgate
 Sleaford, Lincolnshire NG34 7DP
 Tel: 01529 414363 or 07786 838788
 e-mail: rick@ricksmithdesign.com