

This drawing is the copyright of Rosetta Landscape Design and cannot be reproduced in any form without the express consent of the company. Written and scaled dimensions to be checked on site, any discrepancies reported prior to work commencing. **If in doubt please ask.**

This drawing has been prepared for the purpose of planning approval.

Planting Notes
Topsoil shall be a minimum of 400mm depth over planting beds and graded to fall. Imported topsoil must be BS3882:2007 compliant and existing topsoil must be cultivated in accordance with BS3882:2007. No cultivation should take place in wet/ waterlogged conditions.
Herbicide and cultivation: Topsoil to be treated with two applications of herbicide prior to planting, where necessary, strictly in accordance with the Control of Pesticides Regulations 1986 (as amended 1997 or, otherwise, updated/superseded legislation) and following manufacturer's instructions by qualified staff. The topsoil shall than be cultivated to 150mm depth.
Planting: All planting and turfing shall conform to BS: 3936: 1992 and BS:4428:1989.
Trees: Standard trees to be planted in pits 800x800x450mm or dimensions of rootball, whichever is greater. Tree to be supported by 1Nr stake (1500mm long, per tree, 600mm above ground, 75mm diameter) and 1Nr bio-degradeable tie. Alignure soil improver and 150g Enmag (or, equivalent) to be incorporated into the soil of all new tree pits. Trees to be planted centrally within a tree pit. Trees planted within grass to have 1m diameter circle around stem kept clear of vegetation using mechanical or chemical means.
Container grown shrubs, transplants and whips: Shrubs and transplants shall be planted in pits 300x300x400mm depth), and the backfill shall include 3 litres of peat-free tree and shrub compost. Where two or more shrub species are indicated within a single bed each species shall be randomly mixed throughout the bed in groups of 3/5.
Herbicide: Spot treat with herbicide throughout the maintenance period in accordance with the manufacturer's instructions.
Mulch: Planting beds to receive 75mm depth pulverized ornamental bark mulch. Native woodland/edge plants to be planted with 800g flax fibre mulch mat pinned to soil. Native hedgerow to be planted through 800g flax fibre mulch roll, edges tucked. Ensure the top of the mulch layer is a minimum of 15mm below adjacent pavements and other surfaces, to prevent spillage.
Plant position: Final position of trees and shrubs subject to confirmation of service location and approval of statutory undertakers.
Protection to planting: Native hedgerow plants to be protected by spiral shelters. Native trees and shrubs within mixes to be protected by shelter guards as supplied by Acorn Planting Products Ltd (01508 528763), or equivalent.
Ornamental hedging: Hedges to comprise a single row of plants. 400mm wide trench excavated to take plants and topsoil cultivated to 400mm depth prior to application of fertilizer.
Grass: All turfseeded areas to be cultivated and levelled as required removing any stones, rubble, subsoil, general construction waste.

LEGEND

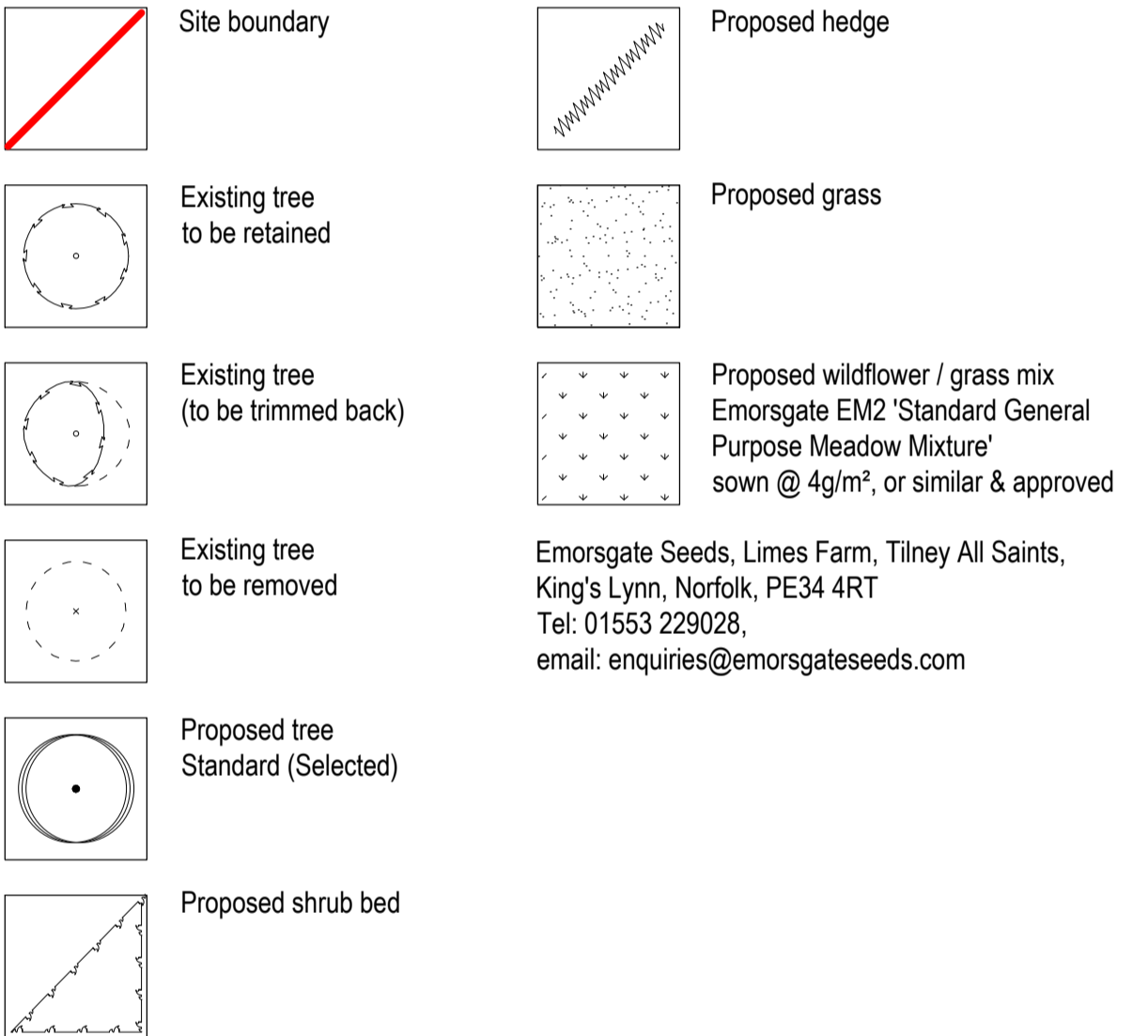

Proposed Hedging

Nr	Code	Plant Name	Ht(cm)	Root	Cntr(l)	Nr/m²
209	Lo	Ligustrum ovalifolium	40-60	C	5	4.00
144	PxRR	Photinia x fraseri 'Red Robin'	60-80	C	5	4.00

Proposed Shrubs

Nr	Code	Plant Name	Ht(cm)	Root	Cntr(l)	Nr/m²
18	BrS	Brachyglottis 'Sunshine'	30-40	C	5	3.00
17	Ctr	Ceanothus thyrsiflorus repens	30-40	C	5	3.00
12	CxsCG	Chaenomeles x superba 'Crimson and Gold'	40-60	C	5	3.00
29	EpM	Elaeagnus pungens 'Maculata'	30-40	C	5	2.00
16	EIEG	Euonymus fortunei 'Emerald 'n' Gold'	20-30	C	5	4.00
8	EISQ	Euonymus fortunei 'Silver Queen'	20-30	C	5	4.00
25	Hca	Hypericum calycinum	45-60	C	5	4.00
12	LaH	Lavandula angustifolia 'Hidcote'	20-30	C	5	4.00
36	LnBG	Lonicera nitida 'Baggesen's Gold'	30-40	C	5	3.00
14	PSY	Pyracantha 'Saphyr Yellow'	40-60	C	5	2.00
11	Vni	Vinca minor	15-20	C	5	4.00

Proposed Trees

Nr	Code	Plant Name	Form	Ht(cm)	Girth(cm)	CStm(cm)	Root
4	AcS	Acer campestre 'Streetwise'	Standard (Selected)	300-350	10-12	175-200	RB
2	Al	Amelanchier lamarckii	Standard (Selected)	300-350	10-12	175-200	RB
3	Bp	Betula pendula	Standard (Selected)	300-350	10-12	175-200	RB
2	BpD	Betula pendula 'Dalecarlica'	Standard (Selected)	300-350	10-12	175-200	RB
1	Buj	Betula utilis jacquemontii	Standard (Selected)	300-350	10-12	175-200	RB
1	Sau	Sorbus aucuparia	Standard (Selected)	300-350	10-12	175-200	RB
2	SaJR	Sorbus aucuparia 'Joseph Rock'	Standard (Selected)	300-350	10-12	175-200	RB

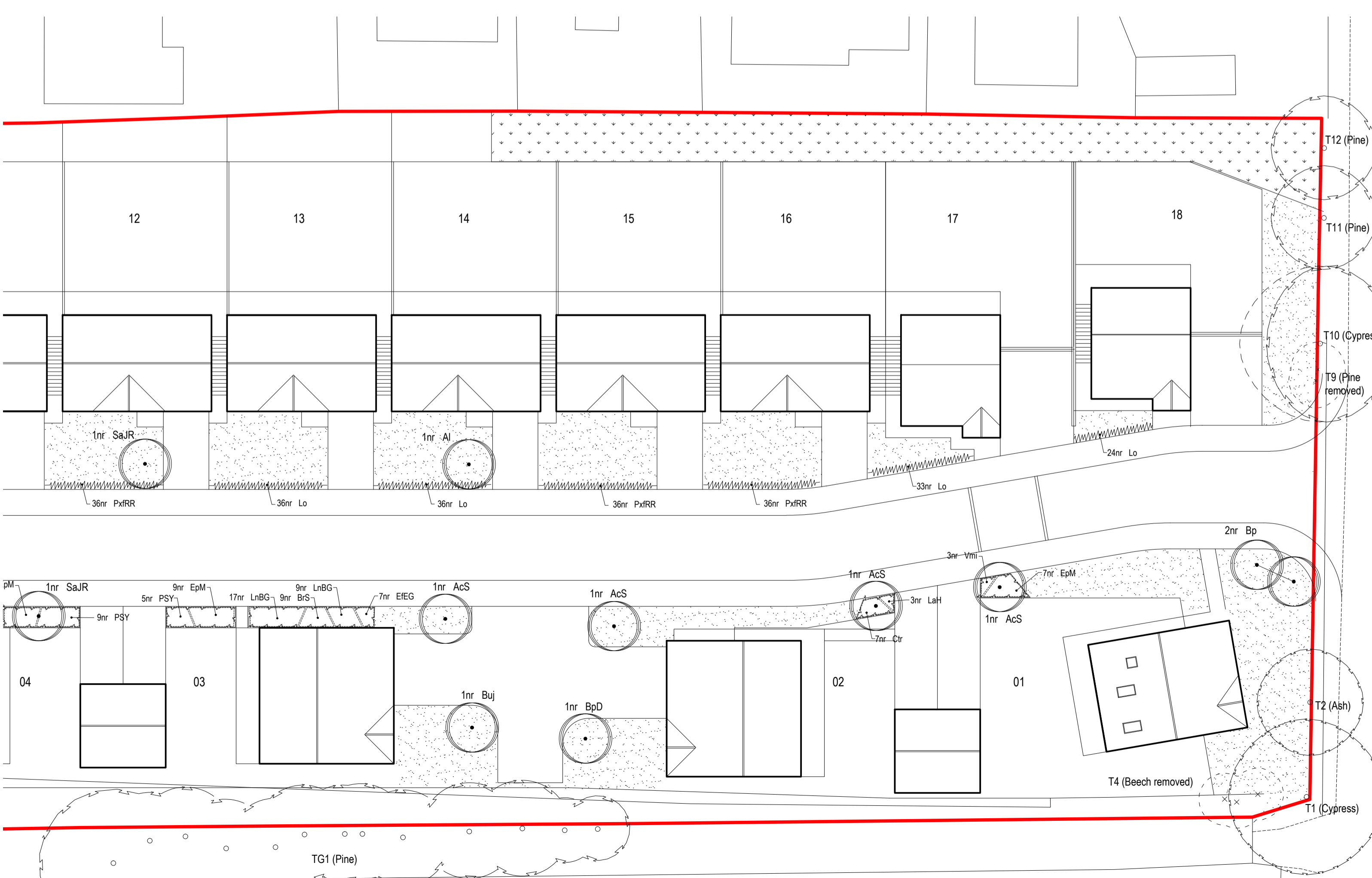

Rev B: Revised to 2143/P-001K - 30Jun22 (BP)

Rev A: Revised to 2143/P-001F received 22Dec21 - 23Dec21 (MP/jr)

Base: Elder Lester McGregor 'Proposed Site Layout', 2143/P-001E received 14Dec21

PROJECT	Limestone Road, Burniston		
TITLE	Detailed Landscape Proposals		
CLIENT	Mandale Construction North Ltd.		
DATE	17 Dec 21	SCALE 1 : 250	SHEET A1
DRAWN	MP/jr	DRAWING NO	3857/1
CHECKED	MP	REVISION	B

ROSETTA
LANDSCAPE DESIGN

Chartered Landscape Architects

Swallow's Nest, Main Street
Askham Richard, York, YO23 3PT

Telephone +44 (0)1904 500410

Email design@rosettalandscapedesign.co.uk
Web www.rosettalandscapedesign.co.uk