

PROPOSED MODULAR BUILDING Layout Option F

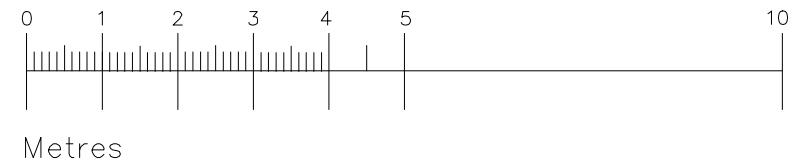

Client



Barming Primary School
Belmont Close
Barming
Maidstone
ME16 9DY

Details

6 Bay Modular Building @
9.95m x 2.95m ea

Amendments

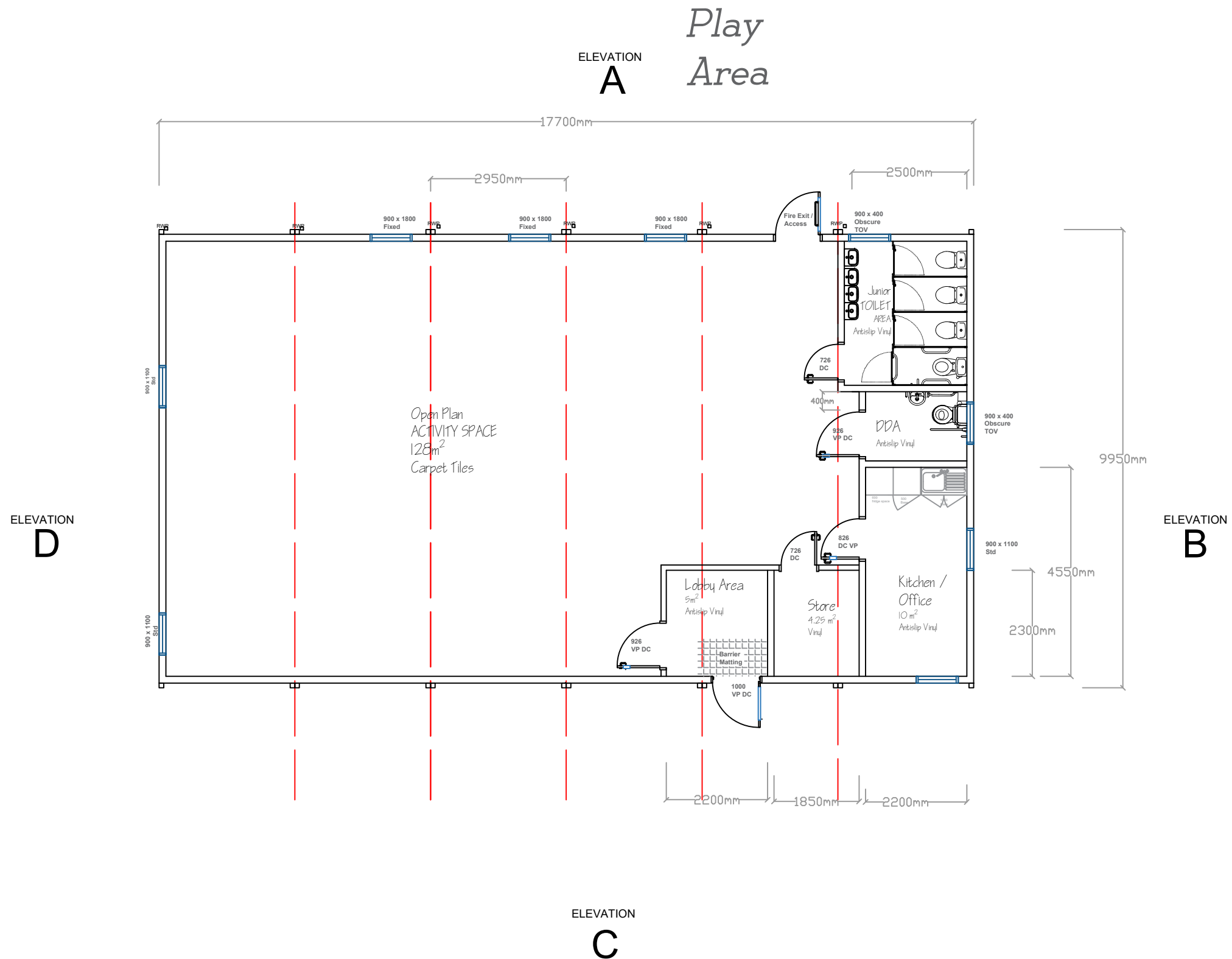

Ramp / Steps dependant upon finished site levels

Scale 1:100 @ A3

Drw Ref: 10514 F

Rev: 01



Advantage Unit
132-134 Great Ancoats St
Manchester
M4 6DE

t: 0161 689 5917
f: 0161 601 0287
e: info@spacebuilder.co.uk

This drawing is confidential & the sole property of the agent company. It must not be reproduced either wholly or in part & is subject to Spacebuilder standard terms and conditions. All rights in respect of patents & design copyright are reserved.