

NOTES

This drawing and design is for use solely in connection with the project described.

The drawing and design is the copyright of MCGINLAY BELL LTD, and must not be re-issued, loaned or copied without written consent.

Do not scale from this drawing, use figured dimensions only where provided.

Existing site, trees and building information has been compiled from different sources, all dimensions and information to be checked on site by contractor.

If in any doubt regarding the information contained on drawing, consult with Architect at earliest opportunity.

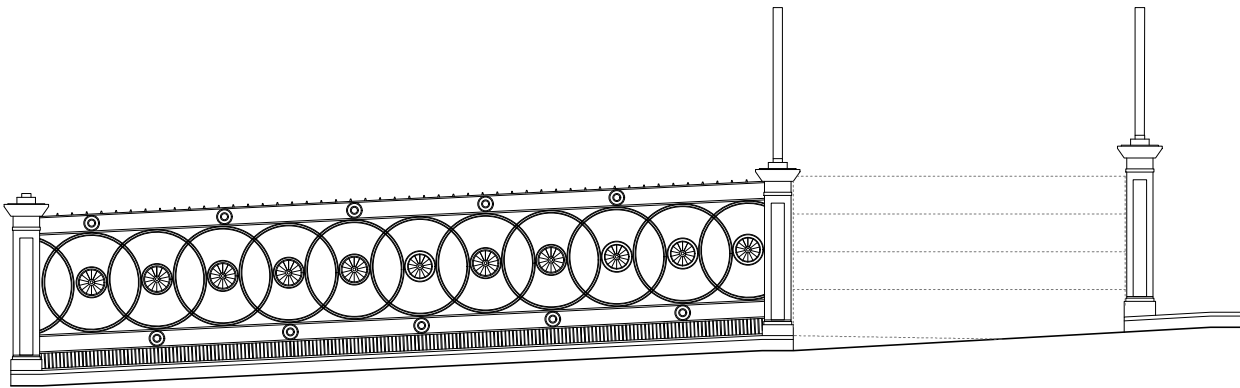

EXISTING ENTRANCE SECTION
23 Athole Gardens

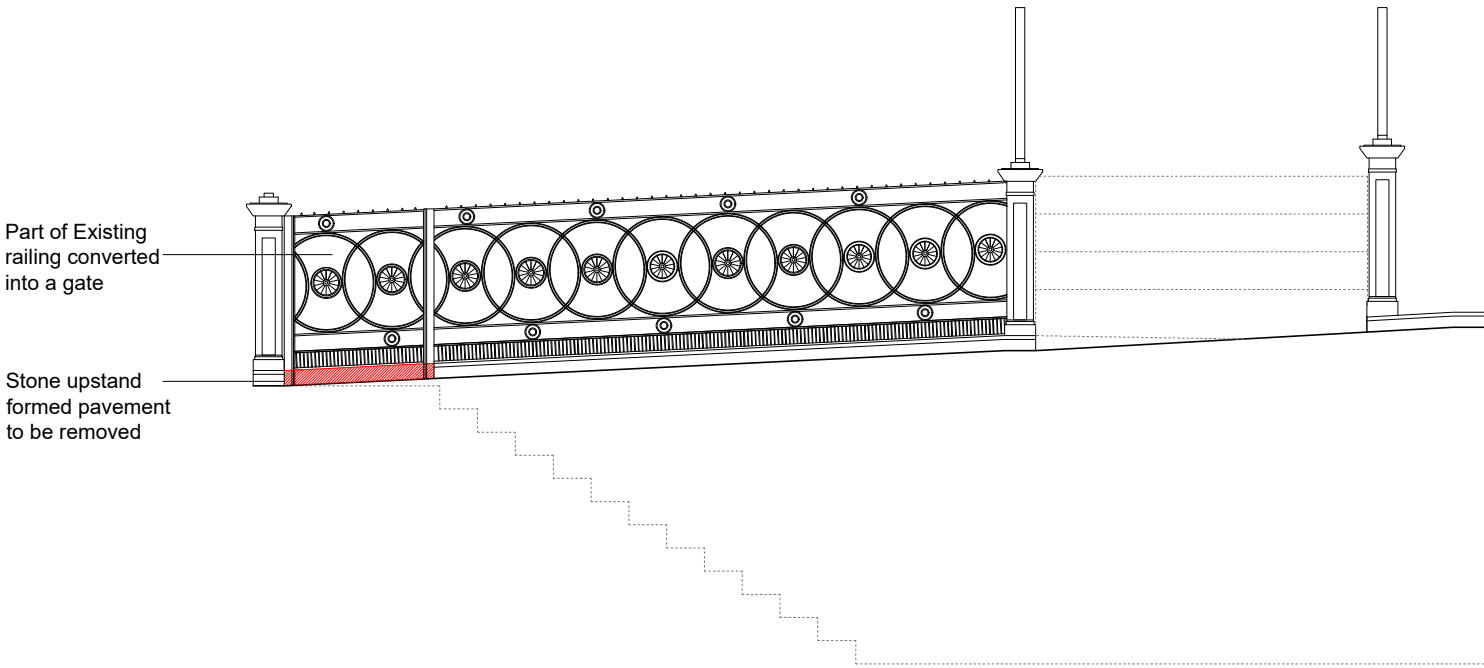

PROPOSED ENTRANCE SECTION
23 Athole Gardens



Gate to broadly match 35 Athole Gardens.

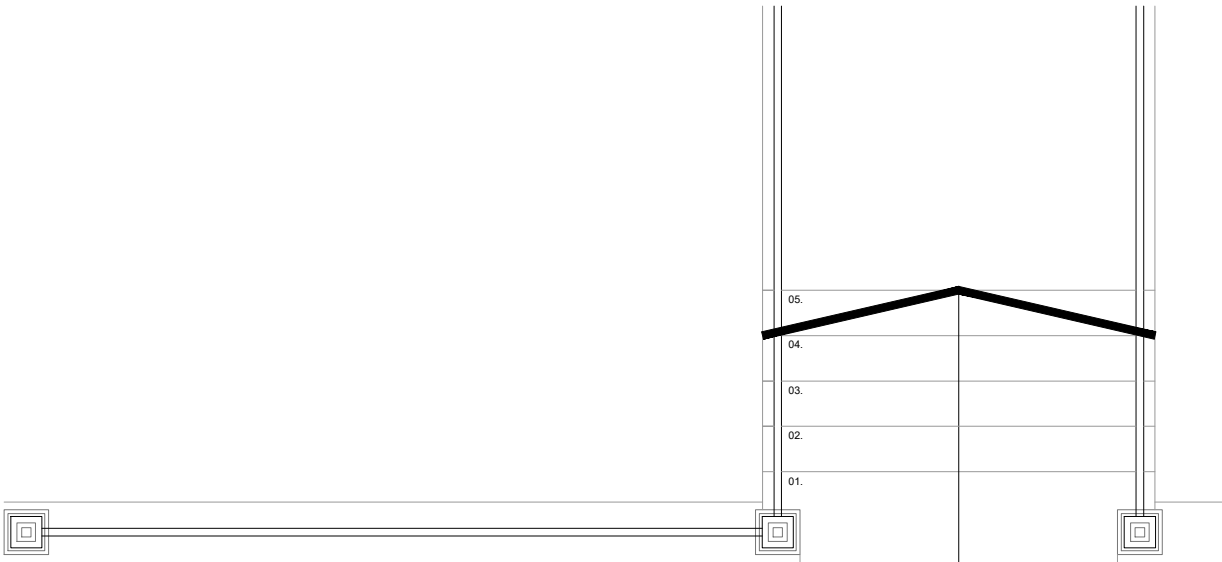

EXISTING ENTRANCE PLAN
23 Athole Gardens

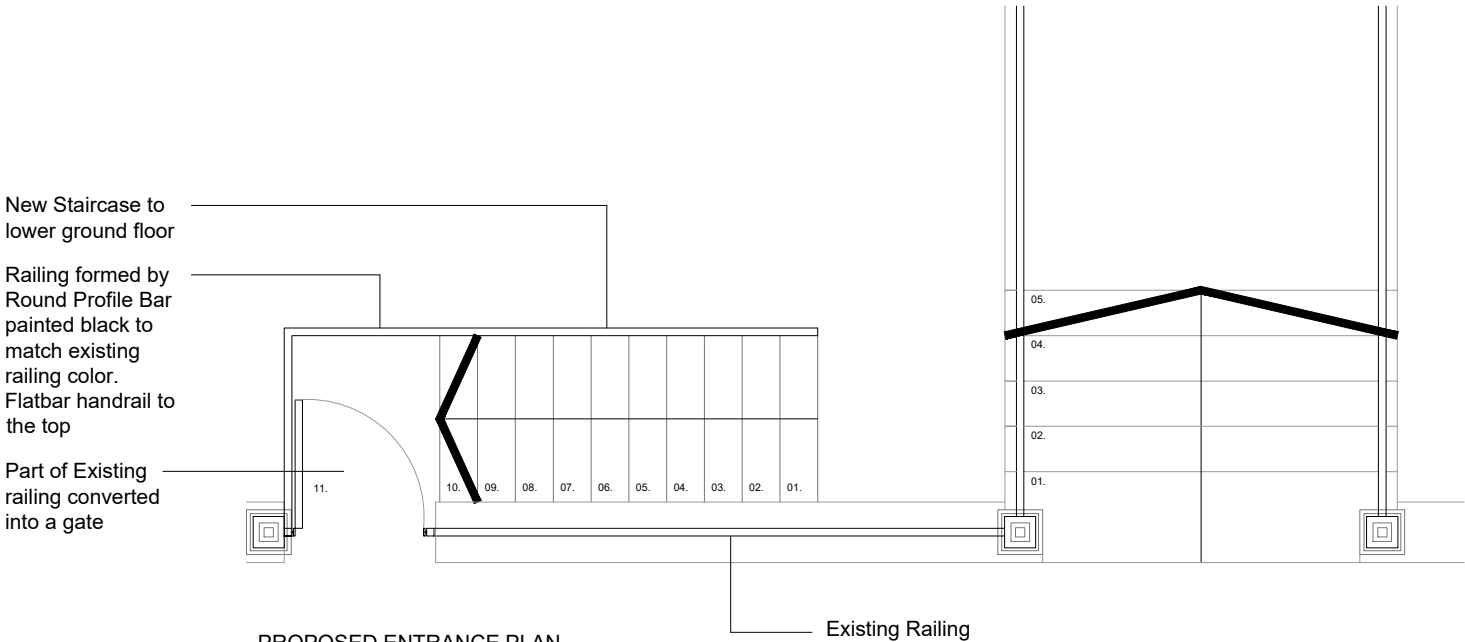

PROPOSED ENTRANCE PLAN
23 Athole Gardens

Revision A (August 22) Planning Issue

0 0.5 1 2m Scale

STATUS - PLANNING

McGinlay Bell

McGinlay Bell Ltd
Central Chambers, Suite 231
93 Hope Street, Glasgow, G2 6LD
Tel: 0141 202 0687

2019_008

23 Athole Gardens /
Neil & Pippa Watson
Railing and Gate

Scale / Format Date Drawing Number
1:50 @ A2 August, 2022 C[90]001