

BLOCK PLAN
1:200

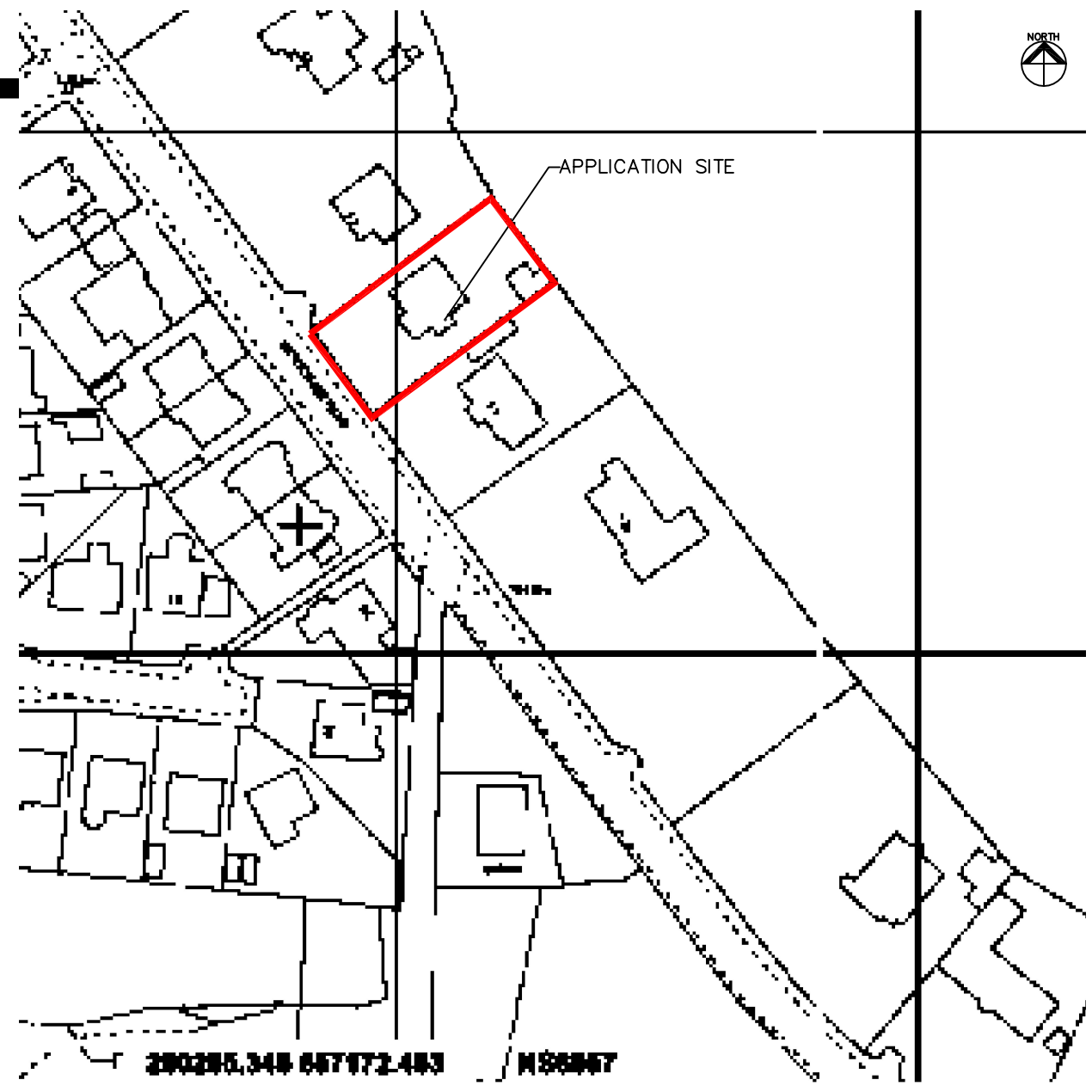

LOCATION PLAN
1:1250

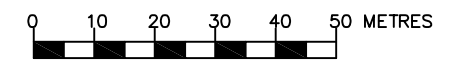

PRYCE

ARCHITECTURAL & CONSTRUCTION
CONSULTANTS,
DESIGN & BUILD

Telephone/Fax - 01563 540806
Mobile - 0779 324 8896
e-mail - pryceac@btinternet.com

Applicant
Mr & Mrs T. Pendlebury
15 Kittochside Road,
Carmunnock, Glasgow,
G76 9AT

Proposed Development
Alterations & Extension to
15 Kittochside Road,
Carmunnock, Glasgow,
G76 9AT

Date
April 2022

Scale
1:200
1:1250

Drawing
Block & Location
Plans as Proposed

Drawing No.
PENDLEBURY3.W6