

All walls forming stairs are dense blockwork with precast concrete steps forming access to all level with 1200mm width and handrail full height and 2000mm headroom clearance

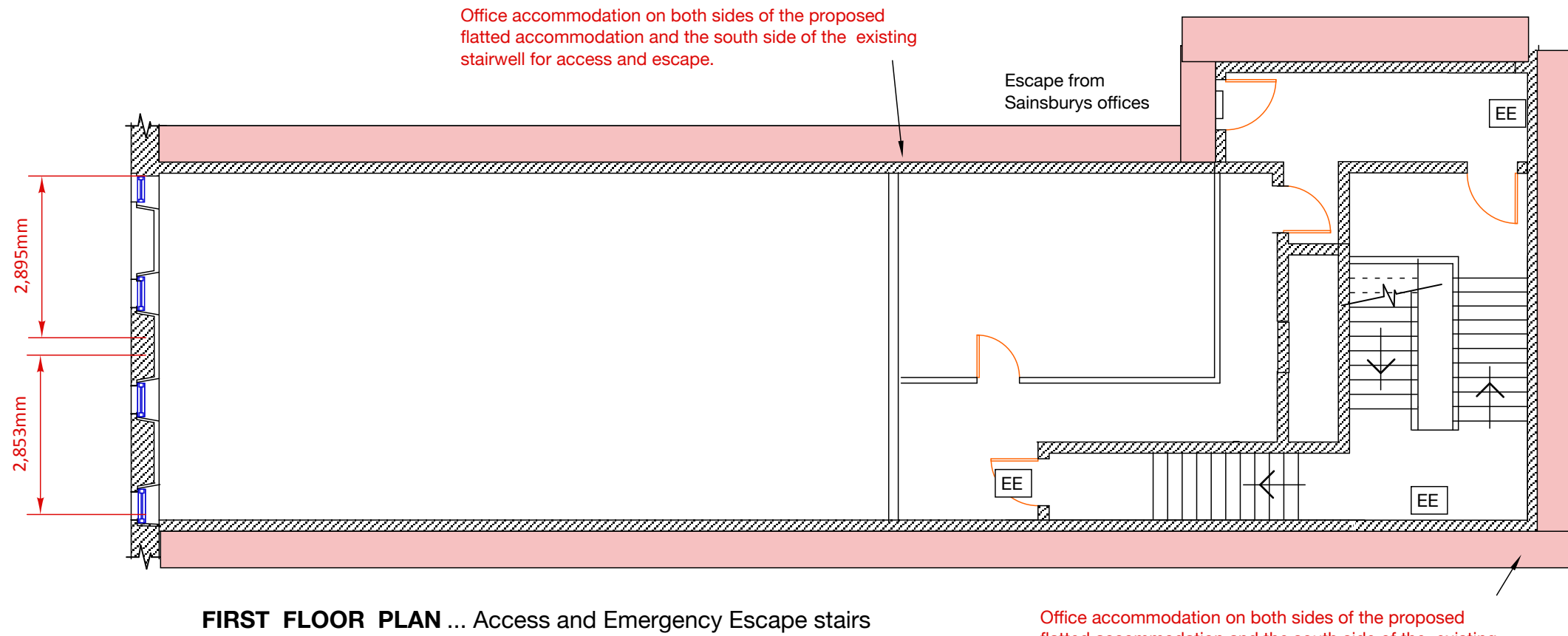

Office accommodation on both sides of the proposed flatted accommodation and the south side of the existing stairwell for access and escape.

Scale:- 1 : 100



Client	Woodside PO & Convenience Store Ltd	Address	14 Stockwell Street, Glasgow
Project	C0U conversion to studio apartments	Dwg	A1514.22.06
Title	FF/SF Plans ... Fire Escape	Date	22.06.22
		Scale	1:100

KEITH EDWARDS ARCHITECT

2 CALEDON STREET, GLASGOW

G12 9DX tel : 0141 341 0694