

ARGYLL STREET

STOCKWELL STREET

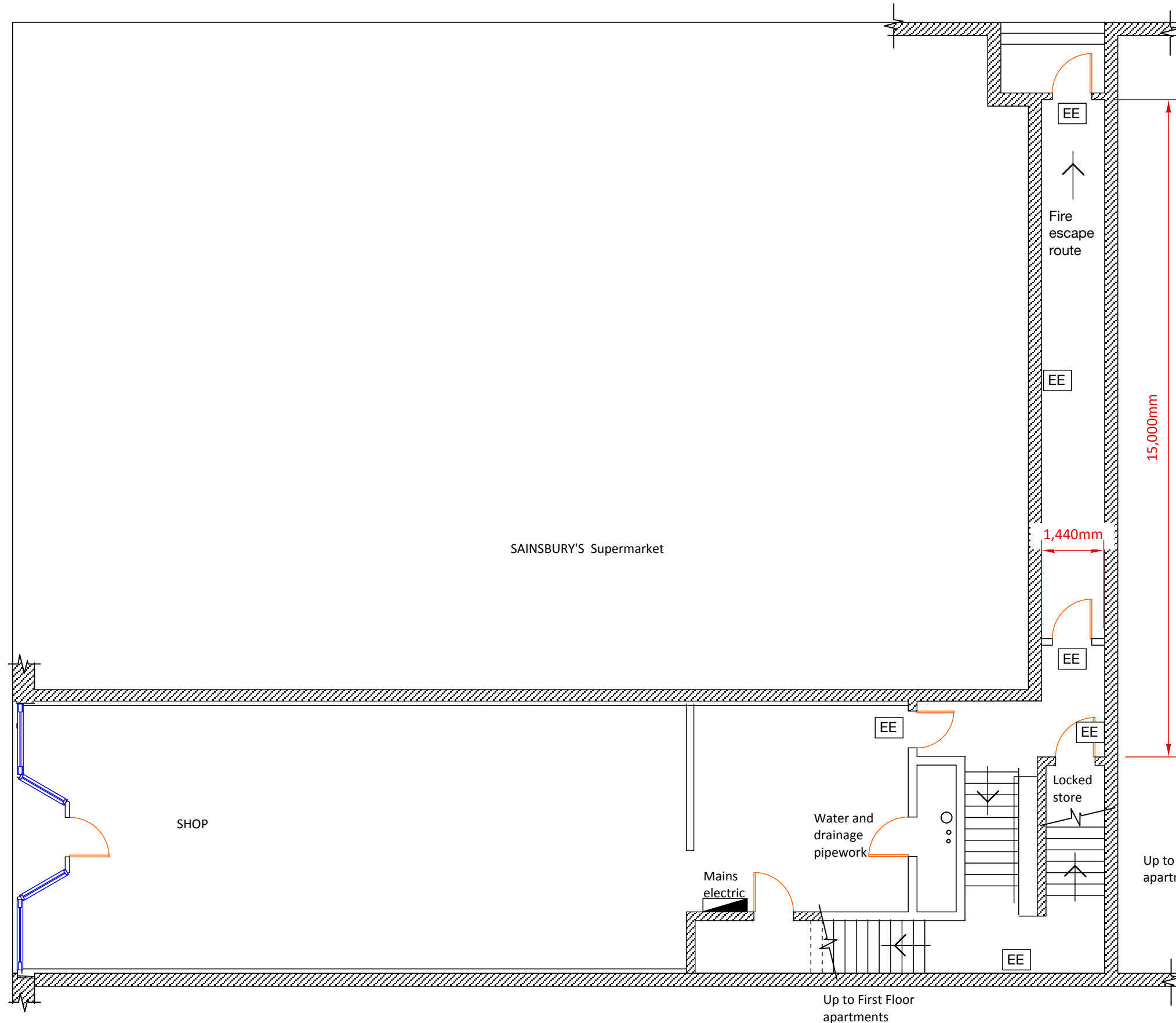

Main access and Emergency Escape route for the shops at ground floor and the upper floor accommodation.

15,000mm

1,440mm

GROUND FLOOR PLAN...

Scale:- 1 : 50



Client	Woodside PO & Convenience Store Ltd	Address	14 Stockwell Street, Glasgow
Project	COU conversion to studio apartments	Dwg	A1514.22.05
Title	Fire Escape Plan ... existing	Date	21.06.22
		Scale	1:100

KEITH EDWARDS ARCHITECT

2 CALEDON STREET, GLASGOW
G12 9DX tel : 0141 341 0694