

SECOND FLOOR PLAN ... Access and Emergency Escape stairs

All walls forming stairs are dense blockwork with precast concrete steps forming access to all level with 1200mm width and handrail full height and 2000mm headroom clearance

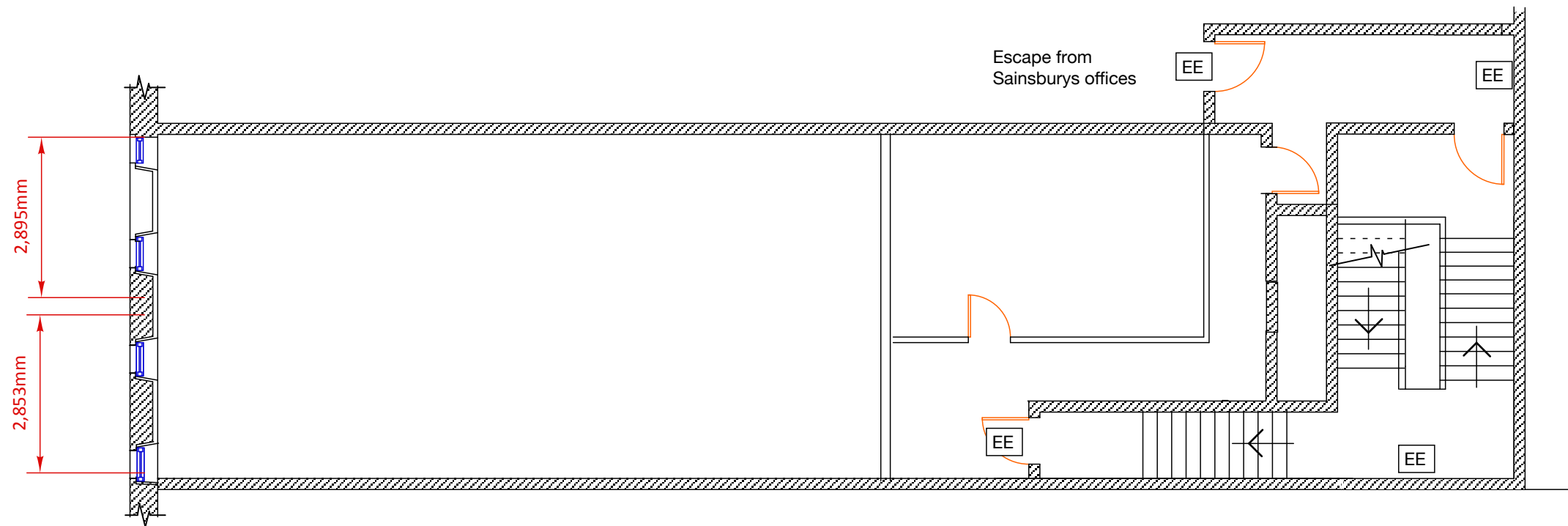

FIRST FLOOR PLAN ... Access and Emergency Escape stairs

Scale:- 1 : 100



Client	Woodside PO & Convenience Store Ltd	Address	14 Stockwell Street, Glasgow
Project	C0U conversion to studio apartments	Dwg	A1514.22.06
Title	FF/SF Plans ... Fire Escape	Date	22.06.22
		Scale	1:100

KEITH EDWARDS ARCHITECT

2 CALEDON STREET, GLASGOW

G12 9DX tel : 0141 341 0694