

APPENDIX A

C3577/100/N	ROAD LAYOUT PLAN
C3577/101/E	ROAD LONGITUDINAL SECTIONS
C3577/102/L	EXTENT OF ADOPTION
C3577/103/U	DRAINAGE LAYOUT PLAN
C3577/104/J	ROAD CONTOURS
C3577/105/F	REFUSE VEHICLE SWEPT PATH
C3577/106/H	PUMPING STATION TANKER SWEPT PATH
C3577/107/J	KERBING LAYOUT PLAN
C3577/108/A	PRE-DEVELOPMENT OVERLAND FLOW ROUTE
C3577/109/F	POST DEVELOPMENT FLOW ROUTE
C3577/110/E	ROAD CONSTRUCTION DETAILS
C3577/111/B	PROPOSED SERVICES ROUTES LAYOUT
DEV-THE-ZZ-ZZ-DR-A-90006/P03	PROPOSED SITE LAYOUT

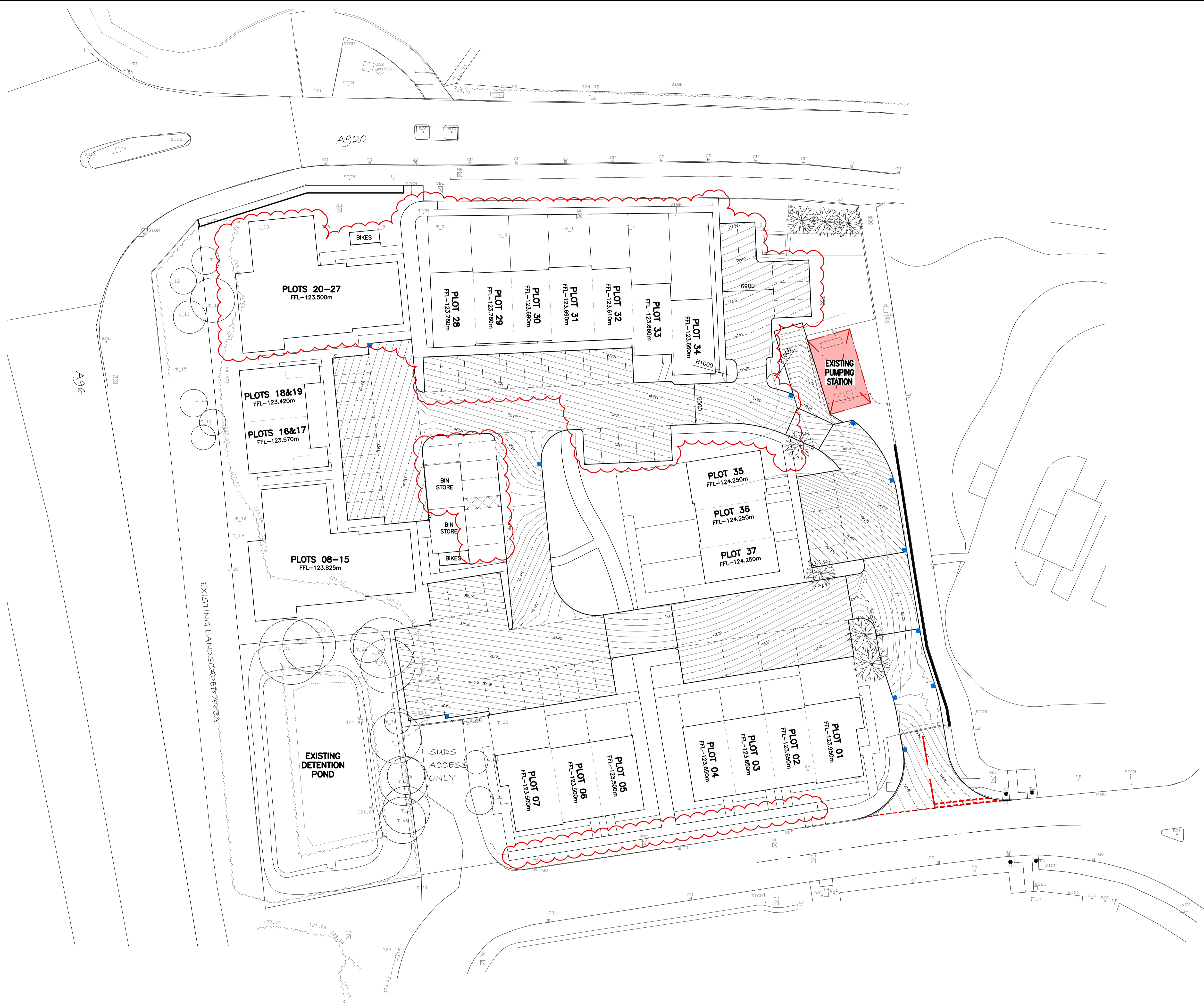

NOTE.
TOPOGRAPHICAL SURVEY BASED ON GRANITE CITY SURVEY
PROJECT 'GCS 5725' DATED 27/03/2019.

NOTE.
RESIDENTIAL HOUSING LAYOUT BASED ON NORR
ARCHITECTS DRAWING 'DEV-THE-ZZ-ZZ-DR-A-90006 -
Proposed Site Layout' DATED 01/08/2022.

NOT FOR CONSTRUCTION

GENERAL NOTES:-
THE CONTRACTOR MUST CONSULT THE CIVIL/STRUCTURAL DESIGN ENGINEER IMMEDIATELY IF:
a) GROUND CONDITIONS VARY ON SITE.
b) EXISTING BUILDINGS VARY ON SITE.
c) DIMENSIONS OR LEVELS ARE CHANGED BY ANYONE ON SITE.
d) COMPLETE OR PARTIALLY COMPLETE STRUCTURES ARE TO BE SUBJECT TO CONSTRUCTION LOADING OR AFFECTED BY TEMPORARY WORKS.
DO NOT SCALE - IF IN DOUBT, ASK.
LARGE SCALE DETAILS TAKE PRECEDENCE OVER SMALL SCALE DETAILS.
ALL MATERIALS ARE TO BE USED STRICTLY IN ACCORDANCE WITH MANUFACTURERS INSTRUCTIONS.
THE CONTRACTOR WILL BE RESPONSIBLE FOR ALL COSTS INVOLVED IN CHANGES OR MODIFICATIONS REQUESTED AND APPROVED, TO SUIT HIS PREFERRED WORK METHOD.
ALL NECESSARY METHOD STATEMENTS MUST BE PROVIDED PRIOR TO COMMENCEMENT OF ASSOCIATED SITE OPERATIONS.
THIS DRAWING SHOULD ONLY BE USED FOR CONSTRUCTION PURPOSES ONLY WHEN THE ISSUE STATUS IS 'FOR CONSTRUCTION'.
ALL DIMENSIONS ARE IN MILLIMETERS UNLESS OTHERWISE STATED.
ALL LEVELS ARE IN METERS UNLESS OTHERWISE STATED.

© THE COPYRIGHT OF THIS DRAWING SUBSISTS WITH RAMSAY & CHALMERS

Rev.	By	App.	Description	Date
J	NJH	MJD	UPDATED TO LATEST ARCHITECTS LAYOUT.	01/08/22
H	JCB	MJD	REVISED TO LATEST LAYOUT. ISSUED FOR CONSTRUCTION.	20/01/22
G	JCB	MJD	LINEAR DRAINAGE CHANNELS REMOVED.	20/08/21
F	MJD		DESIGN REVISED TO REFLECT VALUE ENGINEERING.	25/11/19
E	MJD		INFORMATION REVISED TO LATEST ARCHITECTS LAYOUT.	01/08/19
D	MSB		FFL'S UPDATED.	24/06/19
C	MSB		GENERAL UPDATE.	20/06/19
B	MSB		GENERAL UPDATE.	24/04/19
A	MSB		INITIAL ISSUE.	08/04/19

Project
**PROPOSED RESIDENTIAL DEVELOPMENT
AT DEVERON ROAD, HUNTLY,
ABERDEENSHIRE.**

Drawing Title
ROAD CONTOURS.

Architect
T.H.E.
Job No. **C3577** Drawing No. **104** Revision **J** Scale 1:250-A1 1:500-A3 Issue Status **FOR PLANNING**

Ramsay & Chalmers
Consulting Structural & Civil Engineers
Chattan News Offices
18 Chattan Place
ABERDEEN AB10 6RD
Tel. (01224) 560 700
Fax. (01224) 560 701
Email: info@ramsaychalmers.co.uk
Website: www.ramsaychalmers.co.uk

ROAD CONTOURS (1:250)

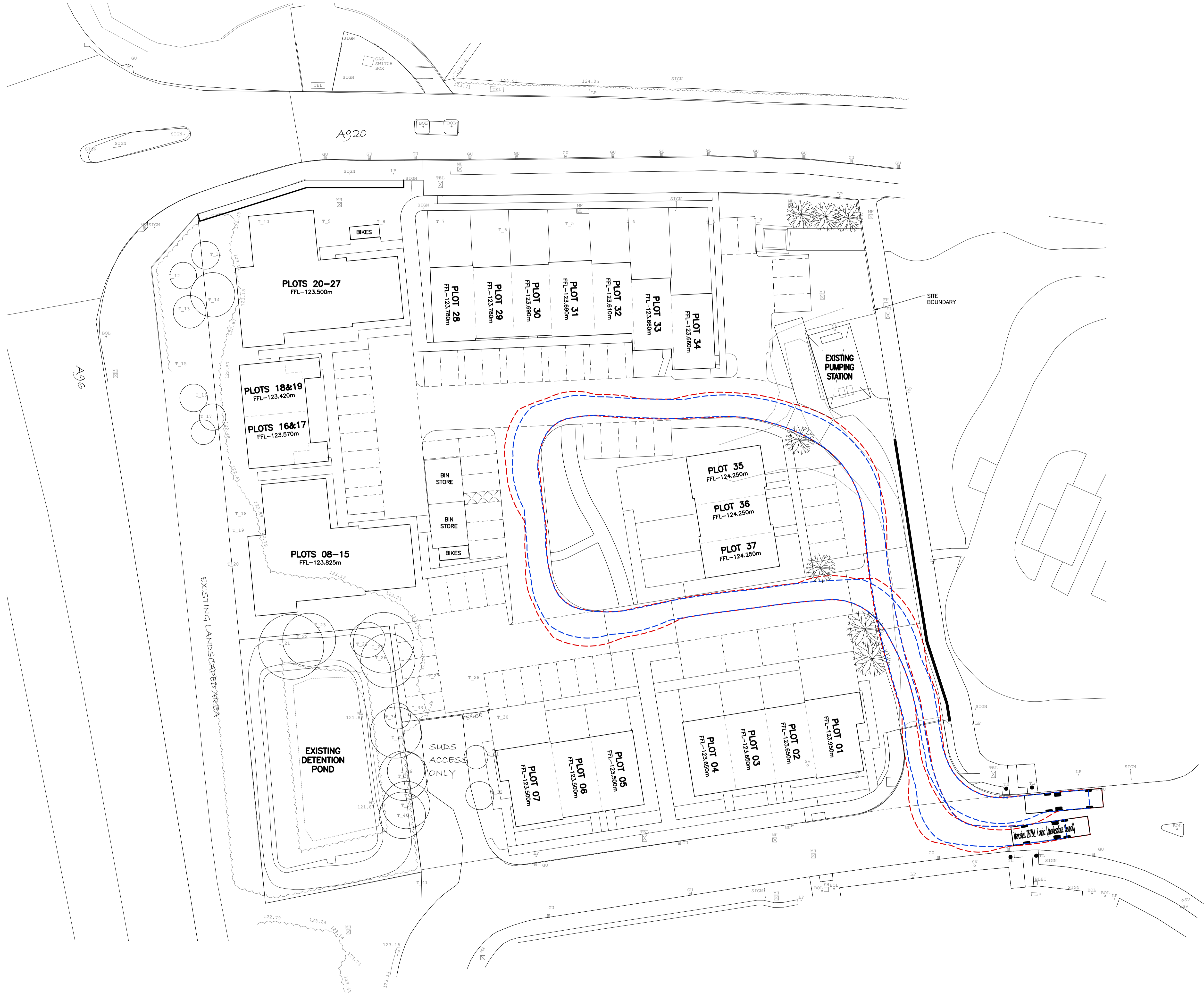

MERCEDES ECONIC 2629LL	
OVERALL LENGTH	10.564m
OVERALL WIDTH	2.524m
OVERALL BODY HEIGHT	3.749m
MINIMUM BODY GROUND CLEARANCE	0.302m
TRACK WIDTH	2.490m
LOCK TO LOCK TIME	4.00 SEC
WALL TO WALL TURNING RADIUS	9.500m
AUTOTRACK LOCATION	

NOTE.
TOPOGRAPHICAL SURVEY BASED ON GRANITE CITY SURVEY PROJECT 'GCS 5725' DATED 27/03/2019.

NOTE.
RESIDENTIAL HOUSING LAYOUT BASED ON NORR ARCHITECTS DRAWING 'DEV-THE-ZZ-ZZ-DR-A-90006 - Proposed Site Layout' DATED 01/08/2022.

NOT FOR CONSTRUCTION

GENERAL NOTES:-
THE CONTRACTOR MUST CONSULT THE CIVIL/STRUCTURAL DESIGN ENGINEER IMMEDIATELY IF:
a) GROUND CONDITIONS VARY ON SITE.
b) EXISTING BUILDINGS VARY ON SITE.
c) DIMENSIONS OR LEVELS SHOWN ARE CHANGED BY ANYONE ON SITE.
d) COMPLETE OR PARTIALLY COMPLETE STRUCTURES ARE TO BE SUBJECT TO CONSTRUCTION LOADING OR AFFECTED BY TEMPORARY WORKS.
DO NOT SCALE - IF IN DOUBT, ASK.
LARGE SCALE DETAILS TAKE PRECEDENCE OVER SMALL SCALE DETAILS.
ALL MATERIALS ARE TO BE USED STRICTLY IN ACCORDANCE WITH MANUFACTURERS INSTRUCTIONS.
THE CONTRACTOR WILL BE RESPONSIBLE FOR ALL COSTS INVOLVED IN CHANGES OR MODIFICATIONS REQUESTED AND APPROVED, TO SUIT HIS PREFERRED WORK METHOD.
ALL NECESSARY METHOD STATEMENTS MUST BE PROVIDED PRIOR TO COMMENCEMENT OF ASSOCIATED SITE OPERATIONS.
THIS DRAWING SHOULD ONLY BE USED FOR CONSTRUCTION PURPOSES ONLY WHEN THE ISSUE STATUS IS 'FOR CONSTRUCTION'.
ALL DIMENSIONS ARE IN MILLIMETERS UNLESS OTHERWISE STATED.
ALL LEVELS ARE IN METERS UNLESS OTHERWISE STATED.

© THE COPYRIGHT OF THIS DRAWING SUBSISTS WITH RAMSAY & CHALMERS

Rev.	By	App.	Description	Date
F	NHJ	MJD	UPDATED TO LATEST LAYOUT	01/08/22
E	MJD	-	DESIGN REVISED TO REFLECT VALUE ENGINEERING.	25/11/19
D	MJD	-	INFORMATION REVISED TO LATEST ARCHITECTS LAYOUT.	01/08/19
C	CBW	DM	GENERAL UPDATE.	25/06/19
B	MSB	-	GENERAL UPDATE.	24/04/19
A	MSB	-	INITIAL ISSUE.	09/04/19

Project
PROPOSED RESIDENTIAL DEVELOPMENT AT DEVERON ROAD, HUNTLY, ABERDEENSHIRE.

Drawing Title
REFUSE VEHICLE SWEEP PATH.

Architect
T.H.E.

Job No.	Drawing No.	Revision	Scale	Issue Status
C3577	105	F	1:250-A1 1:500-A3	FOR PLANNING

Ramsay & Chalmers
Consulting Structural & Civil Engineers
Chattan News Offices
18 Chattan Place
ABERDEEN AB10 6RD
Tel. (01224) 560 700
Fax. (01224) 560 701
Email: info@ramsaychalmers.co.uk
Website: www.ramsaychalmers.co.uk

REFUSE VEHICLE SWEEP PATH (1:250)

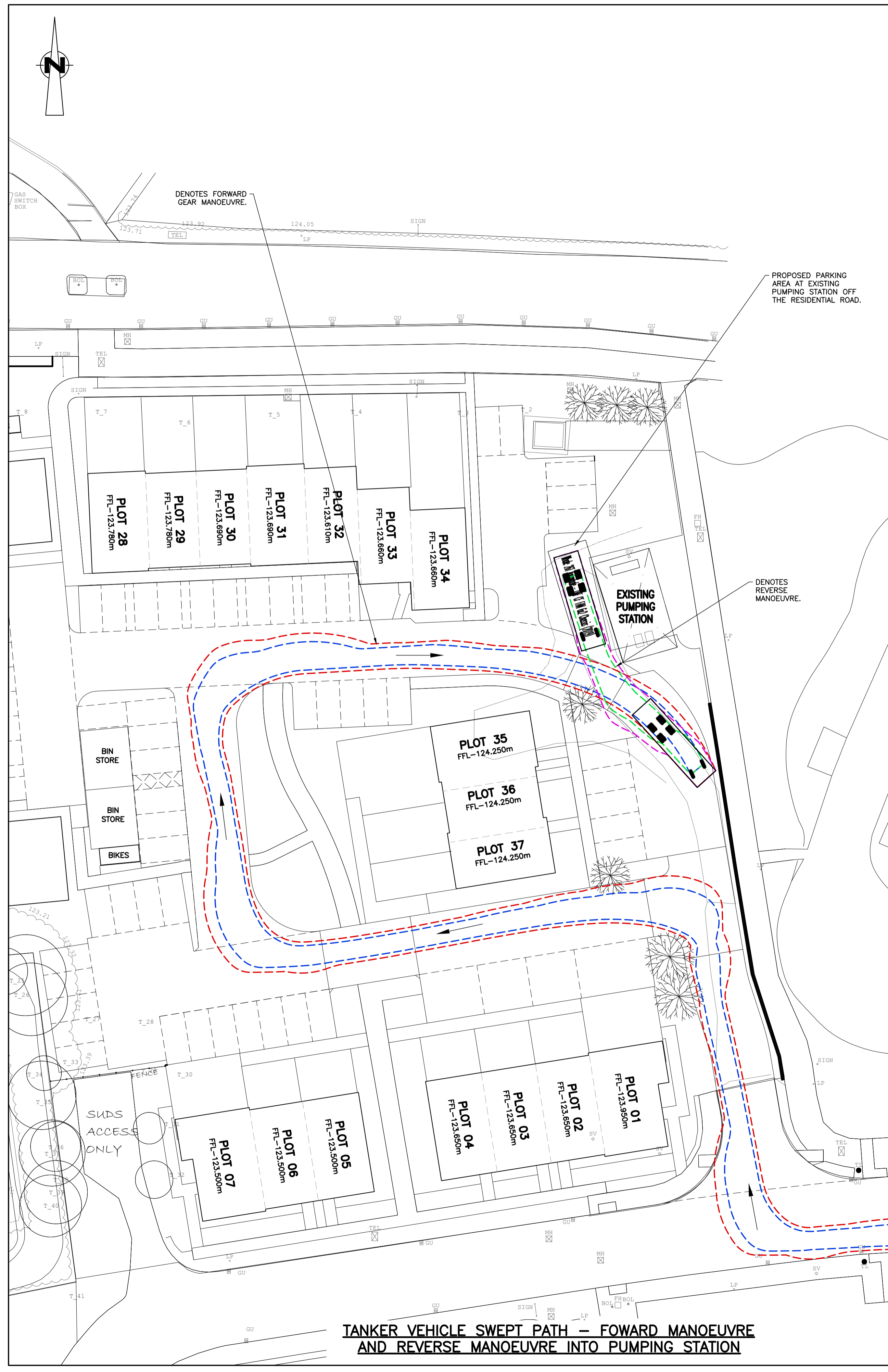

TANKER VEHICLE SWEEP PATH – FOWARD MANOEUVRE AND REVERSE MANOEUVRE INTO PUMPING STATION

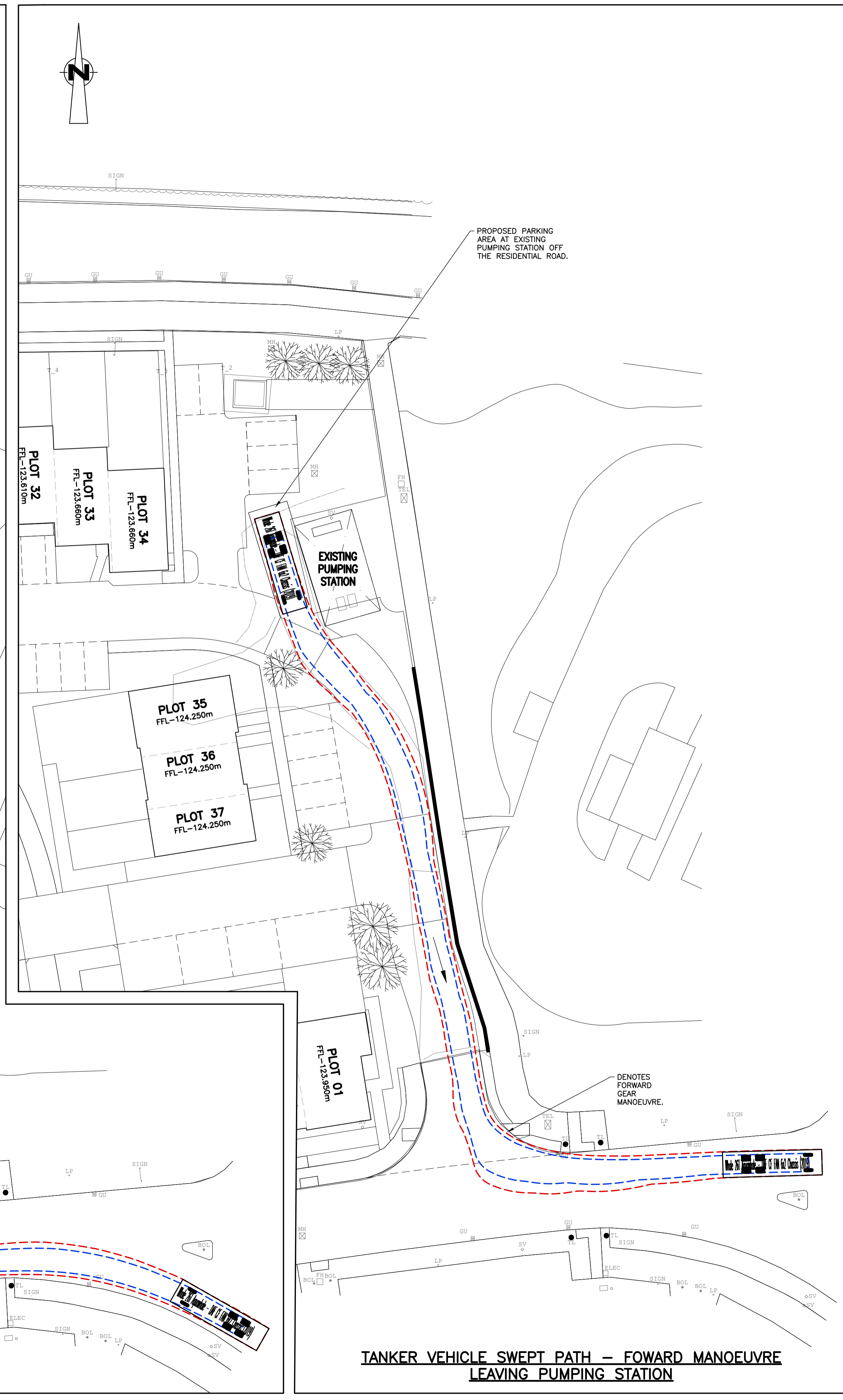

TANKER VEHICLE SWEEP PATH – FOWARD MANOEUVRE LEAVING PUMPING STATION

WHALE 26T AQUAWHALE (SCOTTISH WATER TANKER)

OVERALL LENGTH	9.9000m
OVERALL WIDTH	2.540m
OVERALL BODY HEIGHT	3.946m
MINIMUM BODY GROUND CLEARANCE	0.430m
TRACK WIDTH	1.820m
LOCK TO LOCK TIME	4.00 SEC
WALL TO WALL TURNING RADIUS	8.745m
AUTOTRACK LOCATION	

NOTE.
TOPOGRAPHICAL SURVEY BASED ON GRANITE CITY SURVEY PROJECT 'GCS 5725' DATED 27/03/2019.

NOTE.
RESIDENTIAL HOUSING LAYOUT BASED ON NORR ARCHITECTS DRAWING 'DEV-THE-ZZ-ZZ-DR-A-90006 - Proposed Site Layout' DATED 01/08/2022.

NOT FOR CONSTRUCTION

GENERAL NOTES:-
THE CONTRACTOR MUST CONSULT THE CIVIL/STRUCTURAL DESIGN ENGINEER IMMEDIATELY IF:
a) GROUND CONDITIONS VARY ON SITE.
b) EXISTING BUILDINGS VARY ON SITE.
c) DIMENSIONS OR LEVELS SHOWN ARE CHANGED BY ANYONE ON SITE.
d) COMPLETE OR PARTIALLY COMPLETE STRUCTURES ARE TO BE SUBJECT TO CONSTRUCTION LOADING OR AFFECTED BY TEMPORARY WORKS.
DO NOT SCALE - IF IN DOUBT, ASK.
LARGE SCALE DETAILS TAKE PRECEDENCE OVER SMALL SCALE DETAILS.
ALL MATERIALS ARE TO BE USED STRICTLY IN ACCORDANCE WITH MANUFACTURERS INSTRUCTIONS.
THE CONTRACTOR WILL BE RESPONSIBLE FOR ALL COSTS INVOLVED IN CHANGES OR MODIFICATIONS REQUESTED AND APPROVED, TO SUIT HIS PREFERRED WORK METHOD.
ALL NECESSARY METHOD STATEMENTS MUST BE PROVIDED PRIOR TO COMMENCEMENT OF ASSOCIATED SITE OPERATIONS.
THIS DRAWING SHOULD ONLY BE USED FOR CONSTRUCTION PURPOSES ONLY WHEN THE ISSUE STATUS IS 'FOR CONSTRUCTION'.
ALL DIMENSIONS ARE IN MILLIMETERS UNLESS OTHERWISE STATED.
ALL LEVELS ARE IN METERS UNLESS OTHERWISE STATED.

© THE COPYRIGHT OF THIS DRAWING SUBSISTS WITH RAMSAY & CHALMERS

Rev.	By	App.	Description	Date
H	NJH	MJD	UPDATED TO ARCHITECTS LAYOUT.	01/08/22
G	LD	MJD	REVISED SWEEP PATH MANOEUVRES. ISSUED FOR TECHNICAL APPROVAL.	16/12/19
F	MJD		DESIGN REVISED TO REFLECT VALUE ENGINEERING.	25/11/19
E	MJD		ISSUED FOR TECHNICAL APPROVAL.	12/08/19
D	MJD		INFORMATION REVISED TO LATEST ARCHITECTS LAYOUT.	01/08/19
C	CBW	DM	GENERAL UPDATE.	25/06/19
B	MSB		GENERAL UPDATE.	24/04/19
A	MSB		INITIAL ISSUE.	17/04/19

Project
PROPOSED RESIDENTIAL DEVELOPMENT AT DEVERON ROAD, HUNTLY, ABERDEENSHIRE.

Drawing Title
PUMPING STATION TANKER VEHICLE SWEEP PATH.

Architect
T.H.E.

Job No.	Drawing No.	Revision	Scale	Issue Status
C3577	106	H	1:250-A1 1:500-A3	FOR PLANNING

Ramsay & Chalmers
Consulting Structural & Civil Engineers
Chattan News Offices
18 Chattan Place
ABERDEEN AB10 6RD
Tel. (01224) 560 700
Fax. (01224) 560 701
Email: info@ramsaychalmers.co.uk
Website: www.ramsaychalmers.co.uk



KERBING LEGEND:-

	DENOTES EXTENT OF PROPOSED PRIVATE 255x125 CS1 FLUSH KERB.
	DENOTES EXTENT OF PROPOSED PRIVATE FLAT TOP KERB TYPE 2.
	DENOTES EXTENT OF PROPOSED PRIVATE DROP KERB.
	DENOTES EXTENT OF PROPOSED PRIVATE HALF BATTERED KERB.
	DENOTES EXTENT OF PROPOSED PRIVATE BULLNOSE EDGE KERB.
	DENOTES EXTENT OF PROPOSED PRIVATE DROPPER KERB.
	DENOTES EXTENT OF PROPOSED PRIVATE KASSEL KERBS.
	DENOTES EXTENT OF PROPOSED PRIVATE 150x125 CS2 FLUSH KERB.

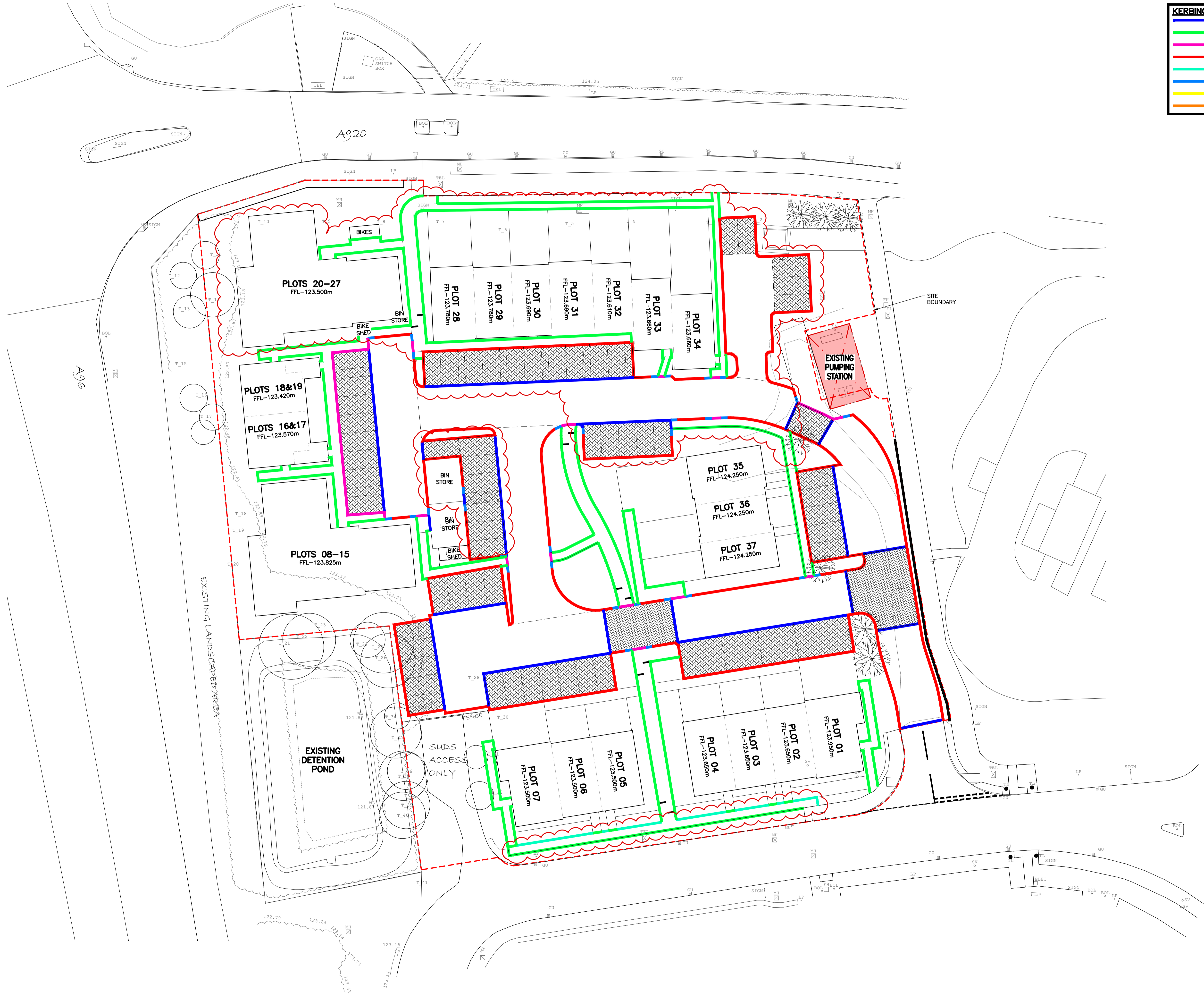

NOTE.
TOPOGRAPHICAL SURVEY BASED ON GRANITE CITY SURVEY
PROJECT 'GCS 5725' DATED 27/03/2019.

NOTE.
RESIDENTIAL HOUSING LAYOUT BASED ON NORR
ARCHITECTS DRAWING 'DEV-THE-ZZ-ZZ-DR-A-90006 -
Proposed Site Layout' DATED 01/08/2022.

NOT FOR CONSTRUCTION

GENERAL NOTES:-
THE CONTRACTOR MUST CONSULT THE CIVIL/STRUCTURAL DESIGN ENGINEER IMMEDIATELY IF:
a) GROUND CONDITIONS VARY ON SITE.
b) EXISTING BUILDINGS VARY ON SITE.
c) DIMENSIONS OR LEVELS SHOWN ARE CHANGED BY ANYONE ON SITE.
d) COMPLETE OR PARTIALLY COMPLETE STRUCTURES ARE TO BE SUBJECT TO CONSTRUCTION LOADING OR AFFECTED BY TEMPORARY WORKS.
DO NOT SCALE - IF IN DOUBT, ASK.
LARGE SCALE DETAILS TAKE PRECEDENCE OVER SMALL SCALE DETAILS.
ALL MATERIALS ARE TO BE USED STRICTLY IN ACCORDANCE WITH MANUFACTURERS INSTRUCTIONS.
THE CONTRACTOR WILL BE RESPONSIBLE FOR ALL COSTS INVOLVED IN CHANGES OR MODIFICATIONS REQUESTED AND APPROVED, TO SUIT HIS PREFERRED WORK METHOD.
ALL NECESSARY METHOD STATEMENTS MUST BE PROVIDED PRIOR TO COMMENCEMENT OF ASSOCIATED SITE OPERATIONS.
THIS DRAWING SHOULD ONLY BE USED FOR CONSTRUCTION PURPOSES ONLY WHEN THE ISSUE STATUS IS 'FOR CONSTRUCTION'.
ALL DIMENSIONS ARE IN MILLIMETERS UNLESS OTHERWISE STATED.
ALL LEVELS ARE IN METERS UNLESS OTHERWISE STATED.

© THE COPYRIGHT OF THIS DRAWING SUBSISTS WITH RAMSAY & CHALMERS

Rev.	By	App.	Description	Date
J	NJH	MJD	UPDATED TO ARCHITECTS LATEST LAYOUT.	01/08/22
H	JCB	MJD	REVISED TO LATEST LAYOUT. ISSUED FOR CONSTRUCTION.	20/01/22
G	JCB	MJD	ADOPTABLE ROADS AND KERBS CHANGED TO PRIVATE.	20/08/21
F	LD	MJD	UPDATED ROAD LAYOUT.	17/12/19
E	MJD	-	DESIGN REVISED TO REFLECT VALUE ENGINEERING.	25/11/19
D	MJD	-	INFORMATION REVISED TO LATEST ARCHITECTS LAYOUT.	01/08/19
C	MSB	-	FFL'S UPDATED.	24/06/19
B	MSB	-	GENERAL UPDATE.	20/06/19
A	MSB	-	INITIAL ISSUE.	23/04/19

Project
**PROPOSED RESIDENTIAL DEVELOPMENT
AT DEVERON ROAD, HUNTLY,
ABERDEENSHIRE.**

Drawing Title
KERBING LAYOUT PLAN.

Architect
T.H.E.

Job No.	Drawing No.	Revision	Scale	Issue Status
C3577	107	J	1:250-A1 1:500-A3	FOR PLANNING

Ramsay & Chalmers
Consulting Structural & Civil Engineers
Chattan News Offices
18 Chattan Place
ABERDEEN AB10 6RD
Tel. (01224) 560 700
Fax. (01224) 560 701
Email : info@ramsaychalmers.co.uk
Website : www.ramsaychalmers.co.uk

KERBING LAYOUT PLAN (1:250)



NOTE.
 TOPOGRAPHICAL SURVEY BASED ON GRANITE CITY SURVEY
 PROJECT 'GCS 5725' DATED 27/03/2019.

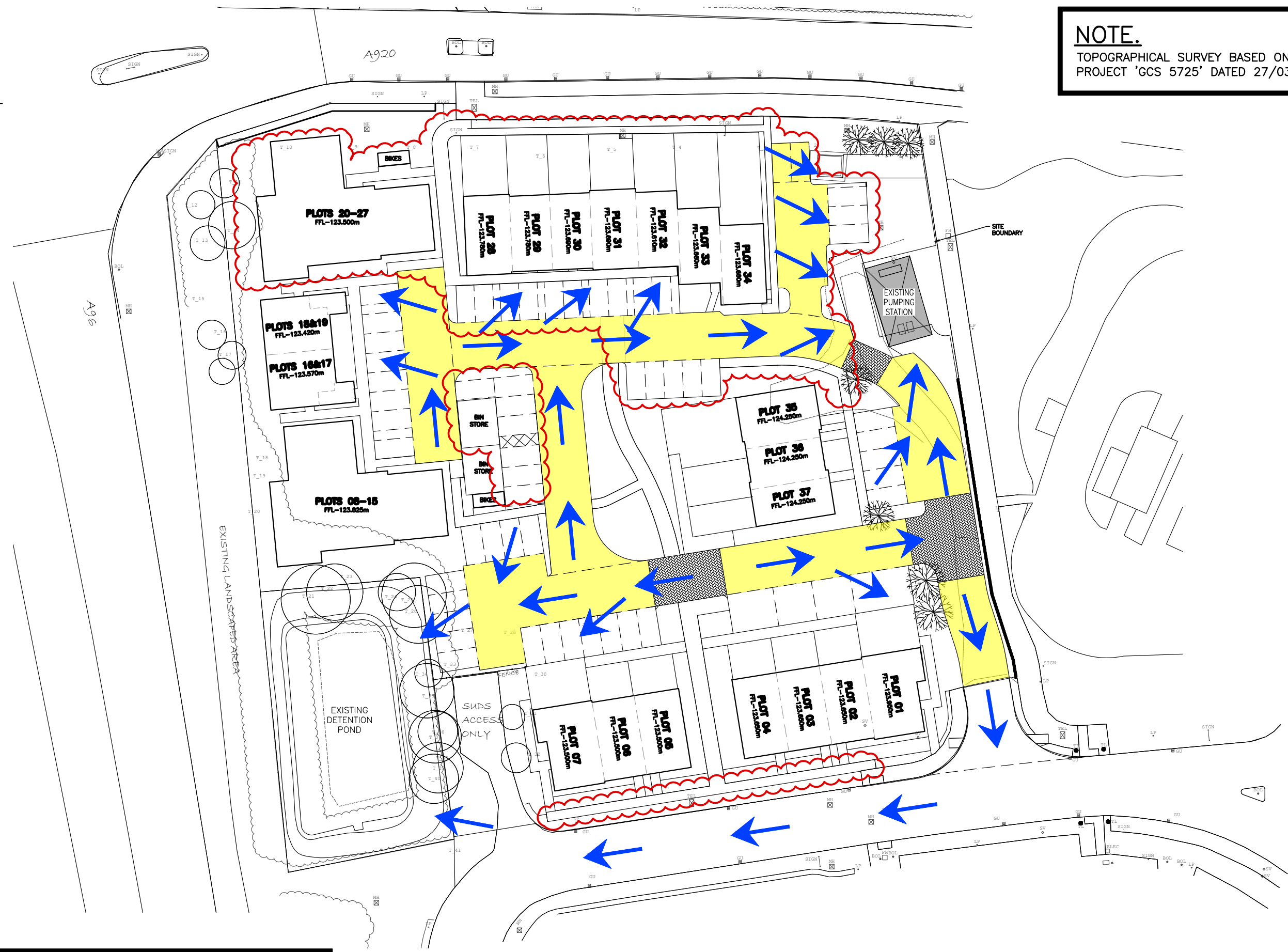

NOTE.
 RESIDENTIAL HOUSING LAYOUT BASED ON NORR
 ARCHITECTS DRAWING 'DEV-THE-ZZ-ZZ-DR-A-90006 -
 Proposed Site Layout' DATED 01/08/2022.

NOT FOR CONSTRUCTION

Ramsay & Chalmers
 Consulting Structural & Civil Engineers
 Chattan Mews Offices
 18 Chattan Place
 ABERDEEN AB10 6RD
 Email : info@ramsaychalmers.co.uk
 Website : www.ramsaychalmers.co.uk
 Tel. (01224) 560 700
 Fax. (01224) 560 701

Project
**PROPOSED RESIDENTIAL DEVELOPMENT
 AT DEVERON ROAD, HUNTLY,
 ABERDEENSHIRE.**
 Drawing Title
**PRE-DEVELOPMENT OVERLAND FLOW
 ROUTE.**

Rev.	By	App.	Description	Date
F	NHJ	MJD	UPDATED TO LATEST ARCHITECTS LAYOUT.	01/08/22
E	MJD	-	INFORMATION REVISED TO LATEST ARCHITECTS LAYOUT.	25/11/19
D	MJD	-	INFORMATION REVISED TO LATEST ARCHITECTS LAYOUT.	01/08/19
C	MSB	-	FFL'S UPDATED.	24/06/19
B	MSB	-	GENERAL UPDATE.	20/06/19

Architect T.H.E.	
Job No. C3577	Drawing No. 109
Revision F	Scale 1:500-A3
Issue Status: FOR PLANNING	

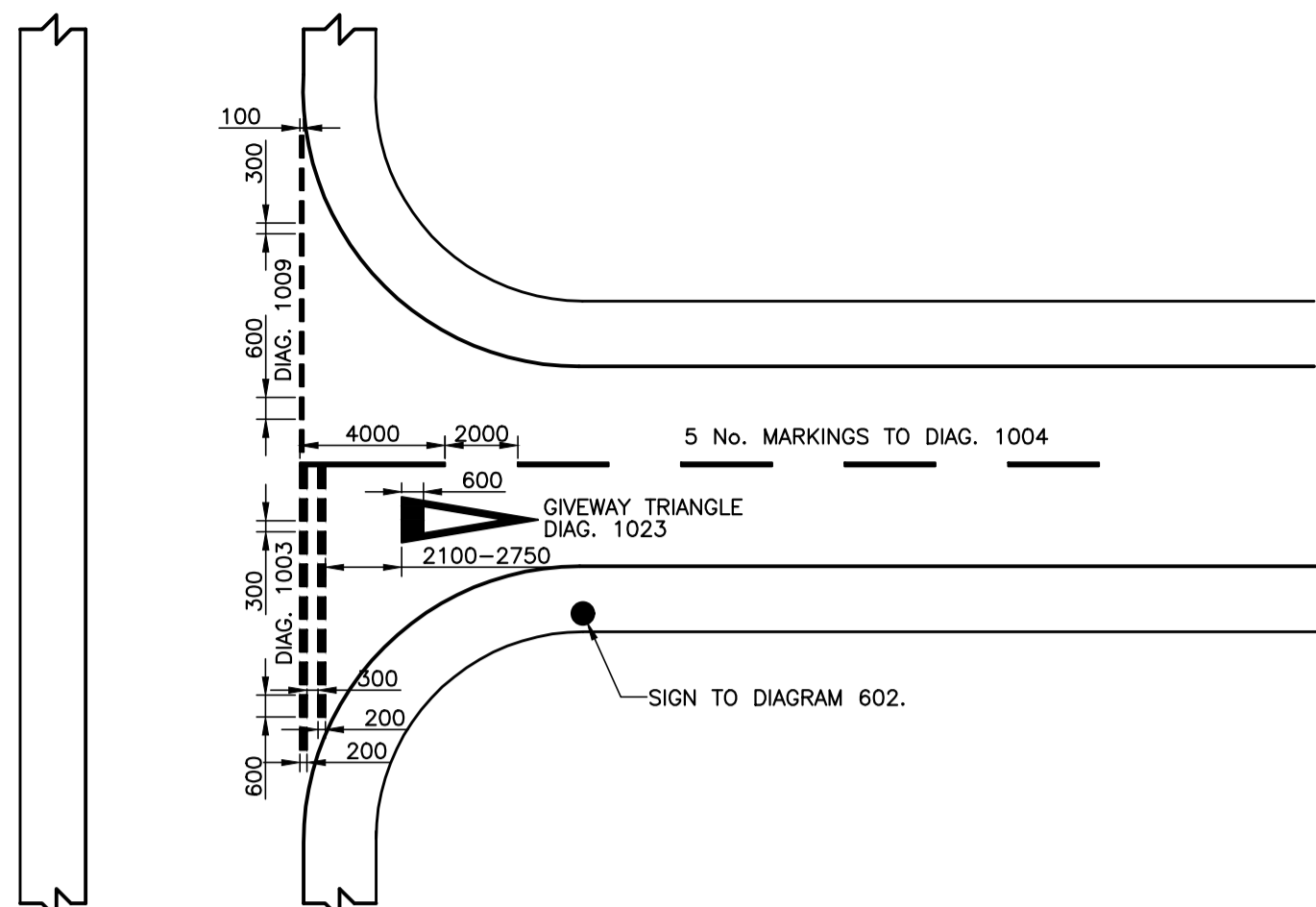

TYPICAL GIVE WAY ROAD MARKINGS AT JUNCTION - WITH GIVEWAY SIGN (30mph) (1:200)

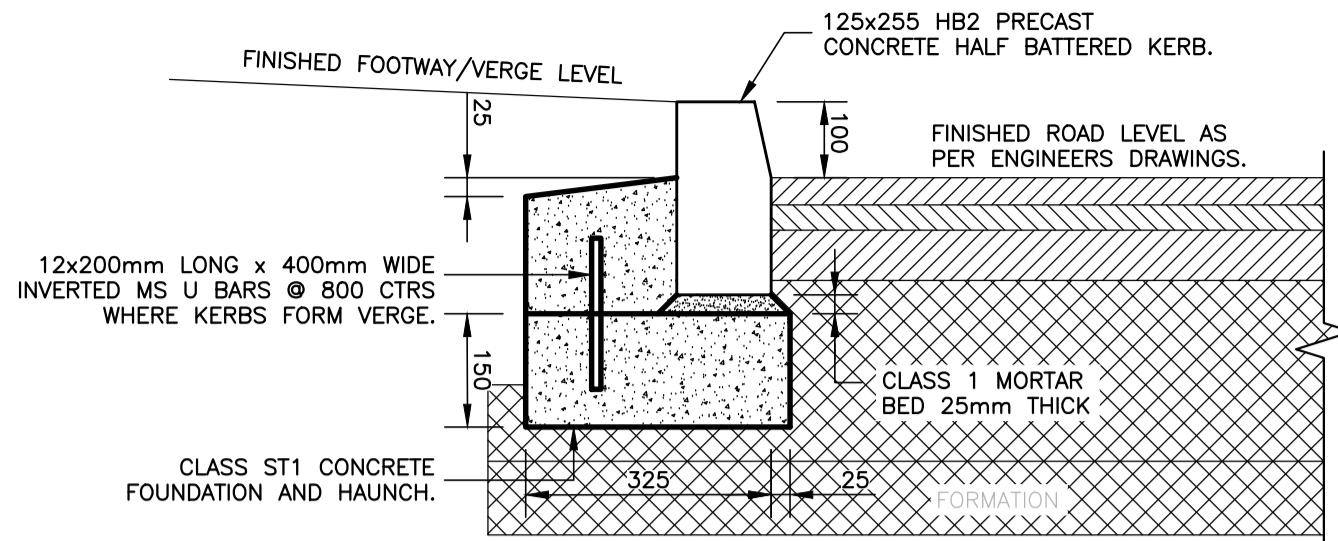

TYPICAL HALF BATTERED KERB (HB2) DETAIL (1:10)

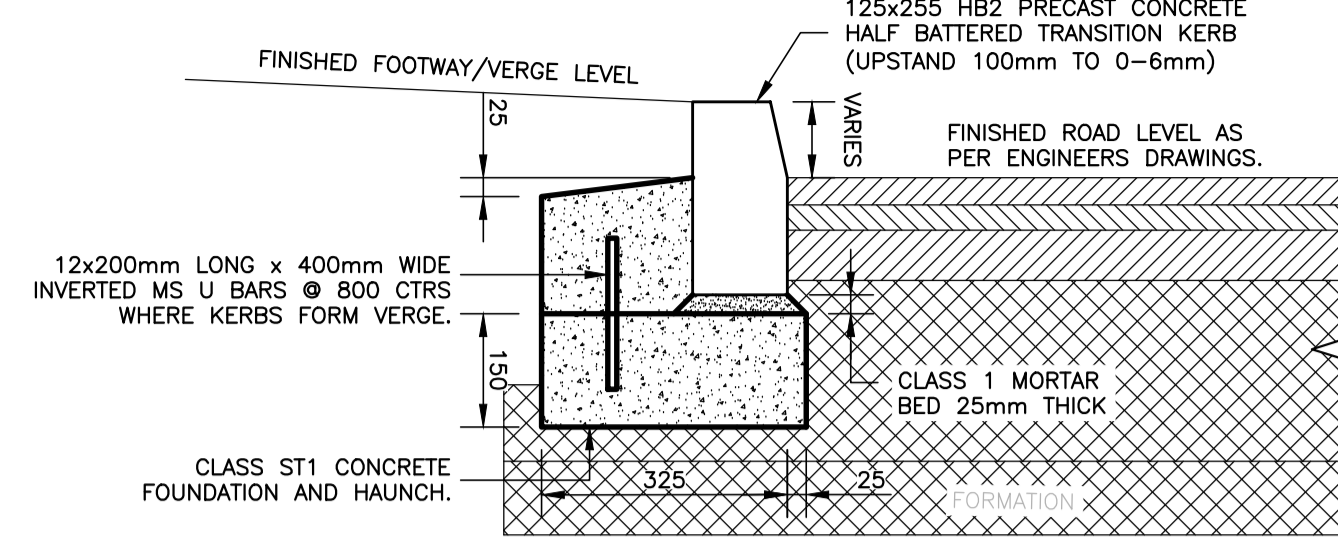

TYPICAL HALF BATTERED DROPPER KERB (DL1 & DR1) DETAIL (1:10)

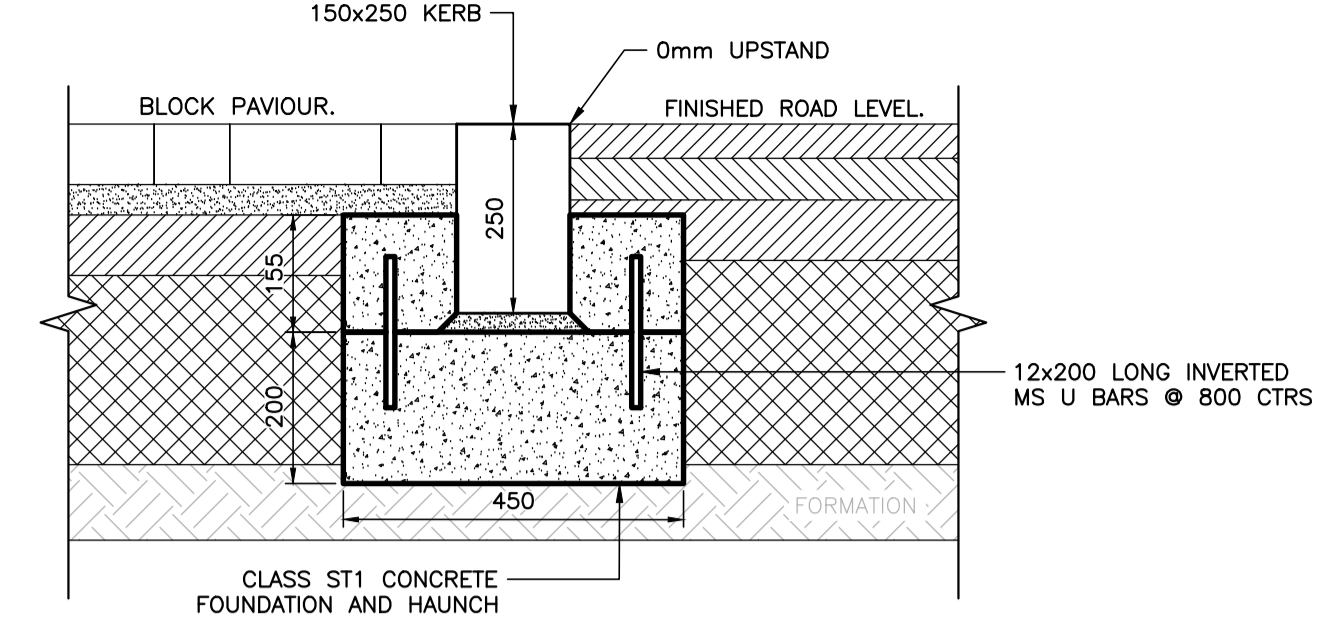

TYPICAL INTERMEDIATE RESTRAINT AT BLOCK PAVEMENTS (1:10)

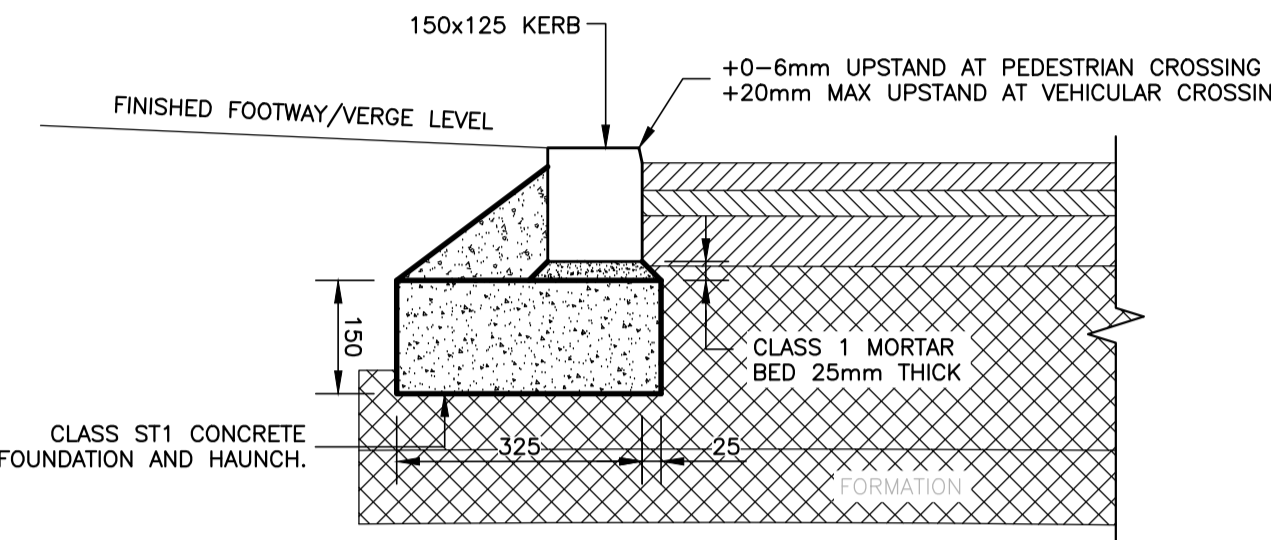

TYPICAL DROP KERB DETAIL (1:10)

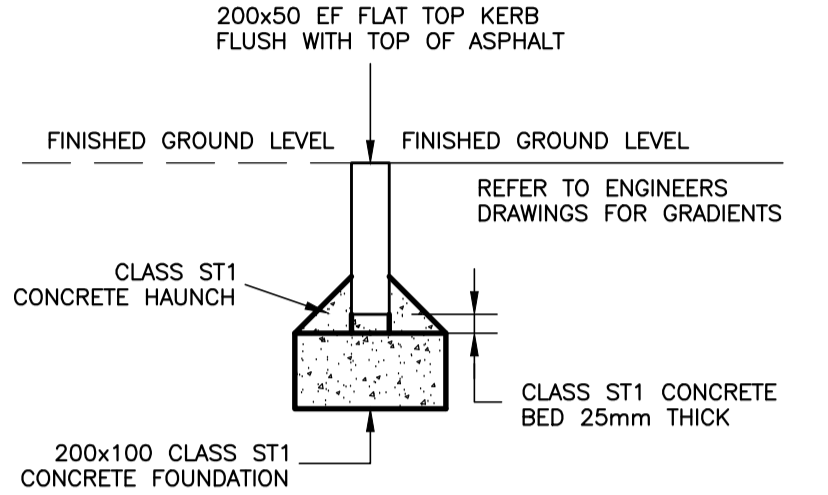

TYPICAL FLAT TOP EDGE KERB (EF) DETAIL (1:10)

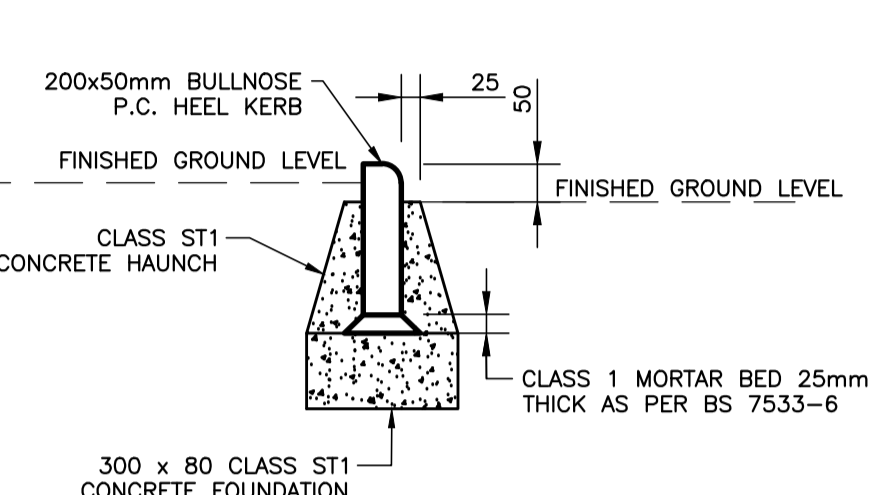

TYPICAL BULLNOSE EDGE KERB (EB) DETAIL (1:10)

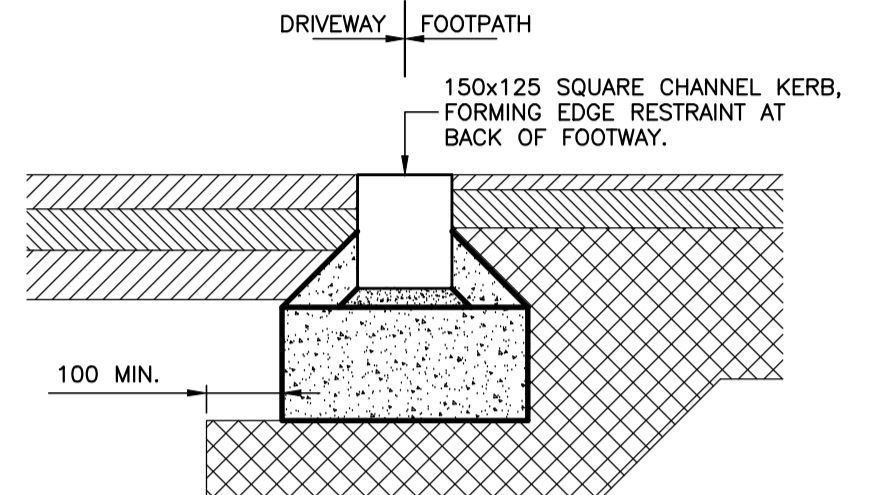

TYPICAL SQUARE CHANNEL DETAIL (1:10)

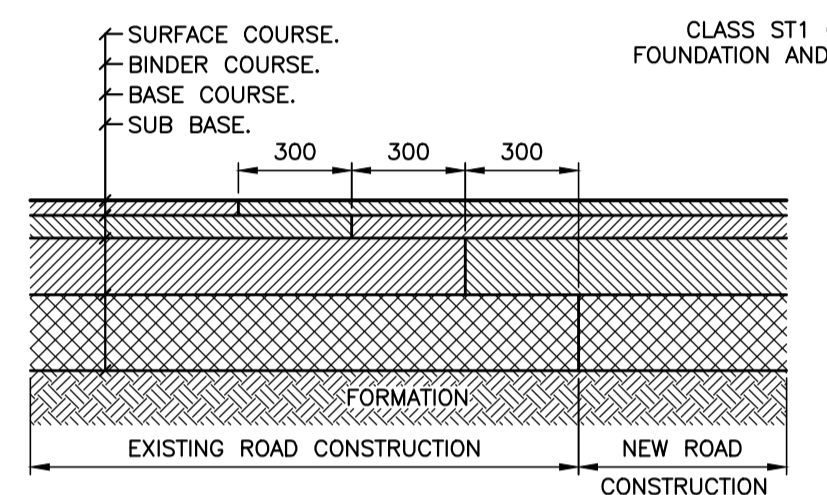
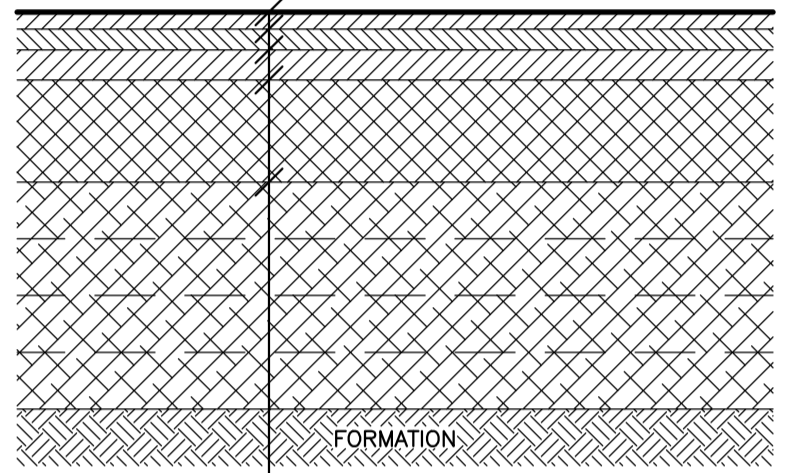

OLD/NEW CONSTRUCTION DETAIL (1:20)

NOTE:- MATERIAL TO A DEPTH OF 450mm WILL BE NON FROST SUSCEPTIBLE.

SURFACE COURSE:- 45mm HRA 30/14F SURF 40/60 DES (REFER TO ABERDEENSHIRE COUNCIL GUIDELINES)

BINDER COURSE:- 55mm AC 20 HDM BIN DES 40/60 (BS EN 13108-1)

BASE:- 80mm AC 32 DENSE BASE 100/150 (BS EN 13108-1)

SUB BASE:- 270mm MINIMUM SUB-BASE (CLAUSE 803).

CAPPING:- 600mm MINIMUM TYPE 6F2 GRANULAR MATERIAL IN MAX. 150mm LAYERS (CLAUSE 613).

ABERDEENSHIRE COUNCIL - HOUSING ROAD SPECIFICATION (1:20)

SUBGRADE CBR	CAPPING LAYER
5% AND MORE	-
4%	-
3%	150mm
2%	225mm
1%	350mm

80mm THICK MARSHALLS TEGULA BLOCK PAVING - 240 GAUGE.

30mm THICK SAND BEDDING LAYING COURSE.

130mm THICK DBM TO CLAUSE 929 WITH PUNCTURE HOLES FOR DRAINAGE.

250mm THICK TYPE 1 SUB-BASE TO CLAUSE 802.

CAPPING LAYER - SEE TABLE 1.

MARSHALLS M15 GEOGRID REQUIRED FOR CBR OF 3% OR LESS.

NOTE:- MATERIAL TO A DEPTH OF 450mm WILL BE NON FROST SUSCEPTIBLE.

TYPICAL SECTION THROUGH ROAD BLOCK PAVED AREAS (1:20)

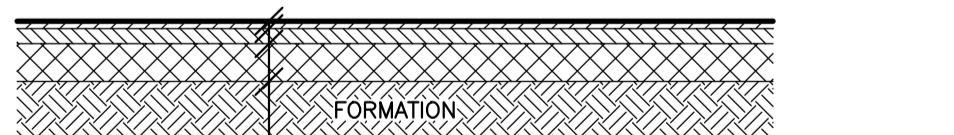

SURFACE COURSE:- 20mm AC 6 DENSE SURF 100/150 (BS EN 13108-1)

BINDER COURSE:- 40mm (50mm AT DRIVEWAYS) AC 14 OPEN SURF 160/220 (BS EN 13108-1)

OR

40mm (50mm AT DRIVEWAYS) AC CLOSE SURF 160/220 (BS EN 13108-1)

SUB BASE:- 100mm GRANULAR SUB-BASE TYPE 1 (CLAUSE 803). INCREASE TO 200mm AT DRIVEWAYS WHERE CBR IS GREATER THAN 2%. 225mm SHALL BE USED WHERE CBR IS LESS THAN 2% AND IT MAY BE NECESSARY TO STABILISE SUBGRADE OR REPLACE WITH GRANULAR CAPPING.

ABERDEENSHIRE COUNCIL - FOOTPATH SPECIFICATION (1:20)

NOTE:- IN SITUATIONS WHERE THE FOOTPATH IS BOUNDED BY OPEN AREAS ON ITS APPROACH TO THE ROAD, CONSIDERATION SHOULD BE GIVEN TO ADDITIONAL MEANS OF RESTRAINT SUCH AS SUITABLY PLACED PRICKLY SHRUBS OR SUITABLY POSITIONED LENGTHS OF GUARD RAIL TO CHANNEL PEDESTRIANS THROUGH THE BAFFLE BARRIERS.

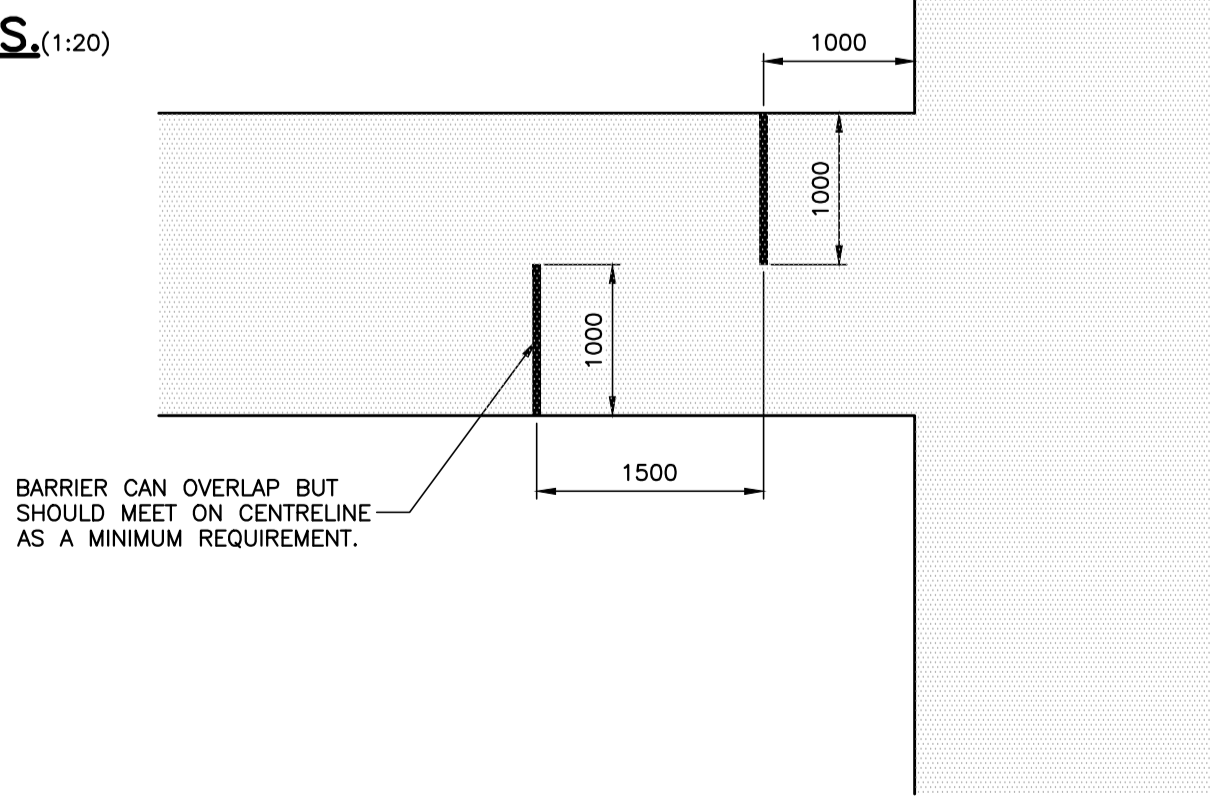

TYPICAL BAFFLE BARRIER LAYOUT (1:50)

100mm DEEP (HOUSING ROAD) CAPTIVE SIDE-HINGED NON-ROCK DUCTILE IRON GRATING AND FRAME. (MESH TYPE TO BE PROVIDED IN AREAS OF BLOCK PAVING).

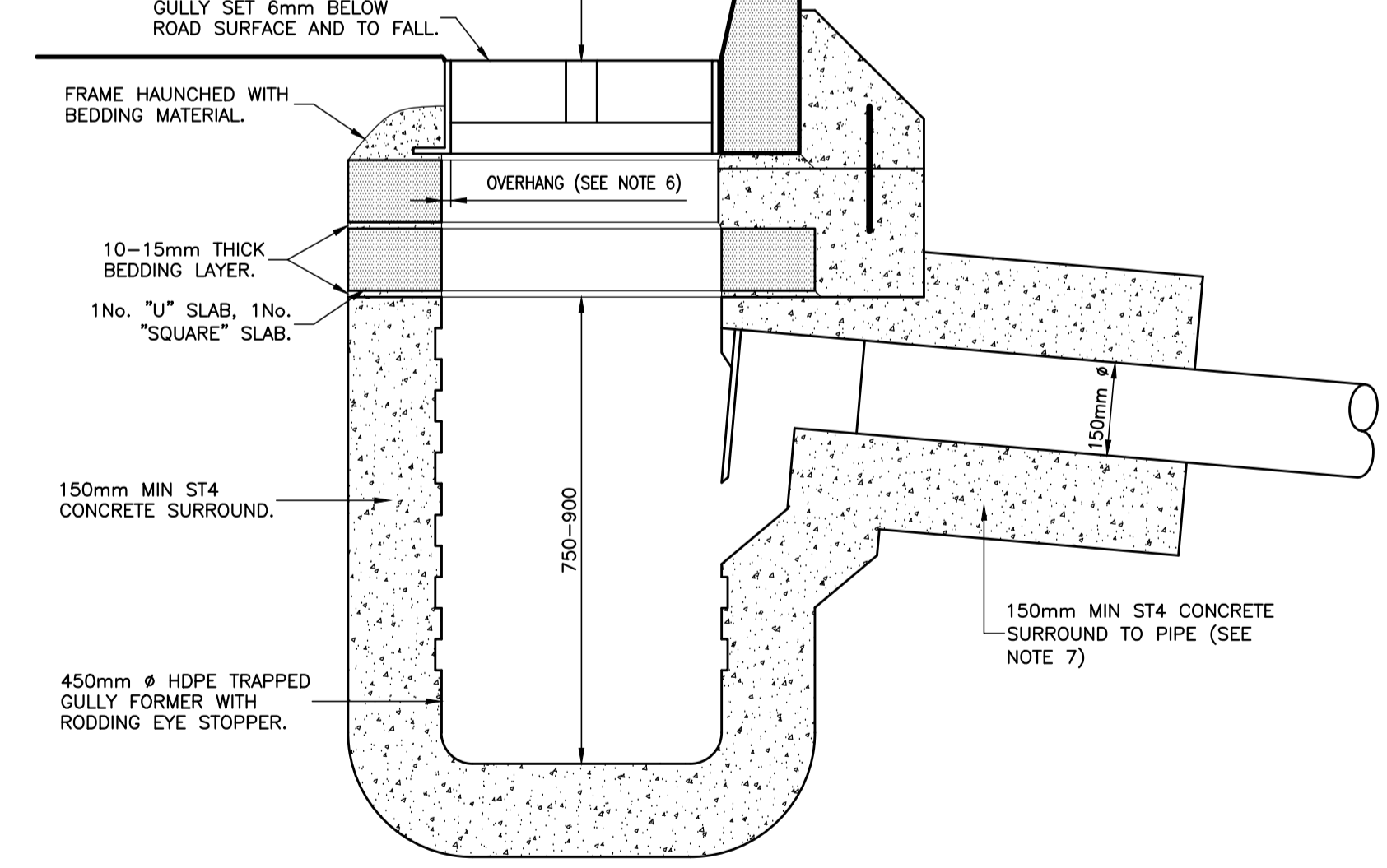

STREET GULLY DETAIL (1:10)

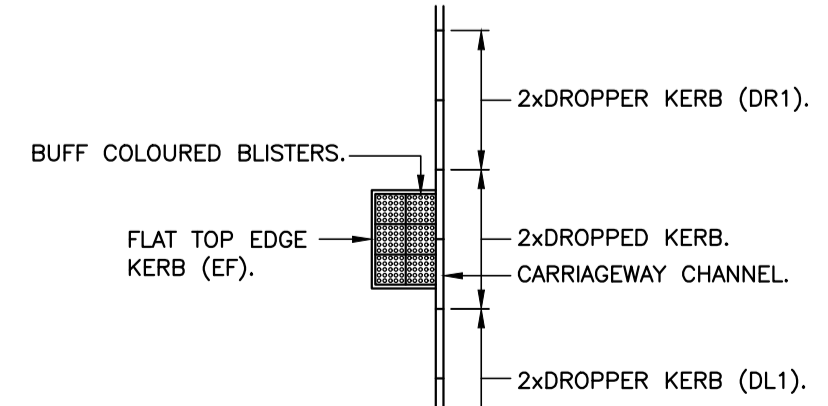

TYPICAL UNCONTROLLED PEDESTRIAN CROSSING REMOTE FROM JUNCTION (1:100)

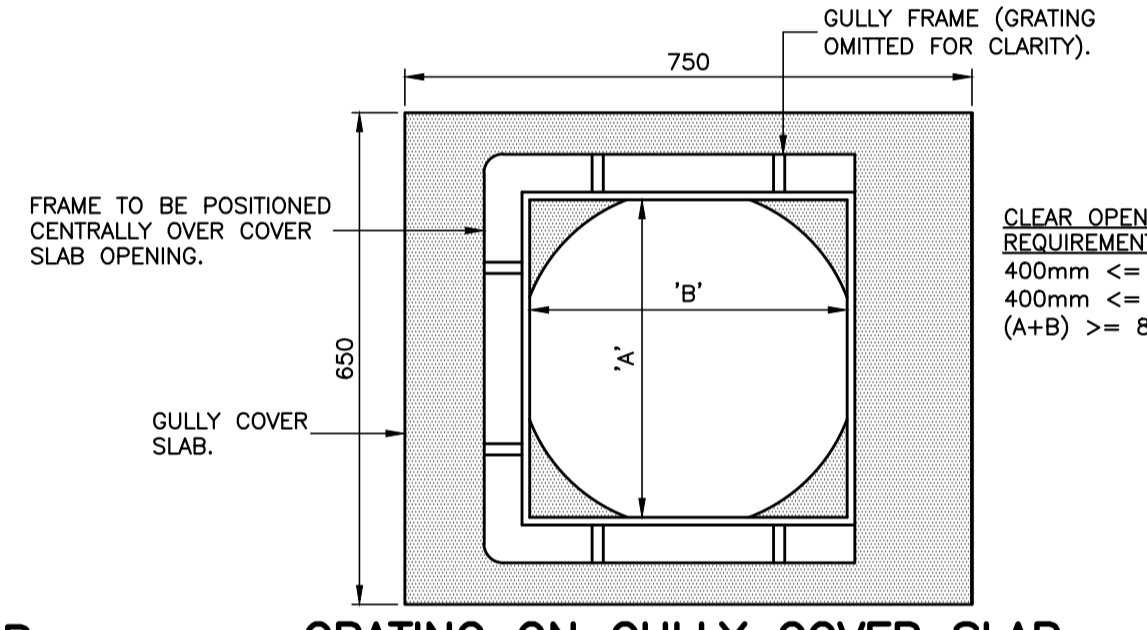

GRATING ON GULLY COVER SLAB (1:10)

GULLY NOTES:-

- ALL DIMENSIONS IN MILLIMETRES.
- GRATING AND FRAME TO BE AT LEAST CLASS D400 IN ACCORDANCE WITH BS EN 124 AND BE MARKED WITH KITEMARK. GRATING SHALL MEET REQUIREMENTS FOR TYPE R CLASSIFICATION IN ACCORDANCE WITH HA 102/00. HINGE MUST BE LOCATED ON SIDE NEAREST TO APPROACHING TRAFFIC.
- GULLY COVER SLABS TO BE 100mm THICK AND COMPLY WITH BS 5911/6.
- GULLY FORMER TO HAVE CURRENT HAPAS CERTIFICATION.
- CONCRETE SURROUND TO GULLIES SHALL FILL THE WHOLE VOID BETWEEN THE GULLY POT AND THE FACE OF THE EXCAVATION. THE CONCRETE SHALL BE COMPACTED BY A VIBRATING POKER TO REMOVE VOIDS.
- THE CONCRETE GULLY SLAB SHALL NOT OVERHANG THE INNER RIM OF THE GULLY POT BY MORE THAN 30mm AT ANY POINT.
- CONCRETE SURROUND TO OUTLET PIPE TO CONTINUE TO A DEPTH OF COVER OF AT LEAST 900mm BELOW EARTHWORKS OUTLINE.
- BEDDING MATERIALS SHALL COMPLY WITH THE REQUIREMENTS OF HA 104/09 AND SHALL BE LAID STRICTLY IN ACCORDANCE WITH THE MANUFACTURERS' RECOMMENDATIONS.
- ACCURATE SETTING OUT FOR POSITION, DEPTH AND CROSSFALL WILL BE NECESSARY TO COMPLY WITH THIS DETAIL. PACKING MATERIALS SHALL NOT BE PERMITTED IN NEW GULLY INSTALLATIONS.
- THE CONTRACTOR/DEVELOPER SHALL PROVIDE A PUMP OR GULLY EMPTIER VEHICLE AND OPERATOR(S) TO ENABLE A COMPLETE INTERNAL INSPECTION OF THE GULLY AT THE END OF THE MAINTENANCE PERIOD AT A TIME AND DATE AGREED WITH THE ENGINEER'S REPRESENTATIVE. COSTS SHALL BE BOURNE BY THE CONTRACTOR/DEVELOPER.

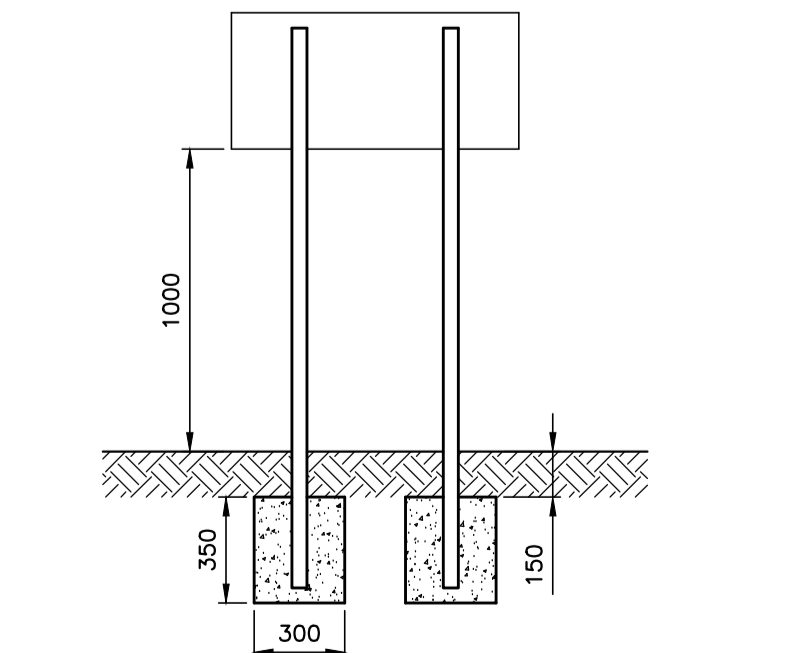

STREET NAMEPLATE ERECTION DETAIL (1:25)

NOT FOR CONSTRUCTION

GENERAL NOTES:-

THE CONTRACTOR MUST CONSULT THE CIVIL/STRUCTURAL DESIGN ENGINEER IMMEDIATELY IF:

- GROUND CONDITIONS VARY ON SITE.
- EXISTING BUILDINGS VARY ON SITE.
- DIMENSIONS OR LEVELS SHOWN ARE CHANGED BY ANYONE ON SITE.
- COMPLETE OR PARTIALLY COMPLETE STRUCTURES ARE TO BE SUBJECT TO CONSTRUCTION LOADING OR AFFECTED BY TEMPORARY WORKS.

DO NOT SCALE - IF IN DOUBT, ASK.

LARGE SCALE DETAILS TAKE PRECEDENCE OVER SMALL SCALE DETAILS.

ALL MATERIALS ARE TO BE USED STRICTLY IN ACCORDANCE WITH MANUFACTURERS INSTRUCTIONS.

THE CONTRACTOR WILL BE RESPONSIBLE FOR ALL COSTS INVOLVED IN CHANGES OR MODIFICATIONS REQUESTED AND APPROVED, TO SUIT HIS PREFERRED WORK METHOD.

ALL NECESSARY METHOD STATEMENTS MUST BE PROVIDED PRIOR TO COMMENCEMENT OF ASSOCIATED SITE OPERATIONS.

THIS DRAWING SHOULD ONLY BE USED FOR CONSTRUCTION PURPOSES ONLY WHEN THE ISSUE STATUS IS 'FOR CONSTRUCTION'.

ALL DIMENSIONS ARE IN MILLIMETRES UNLESS OTHERWISE STATED.

ALL LEVELS ARE IN METERS UNLESS OTHERWISE STATED.

© THE COPYRIGHT OF THIS DRAWING SUBSISTS WITH RAMSAY & CHALMERS

Rev.	By	App.	Description	Date
E	MJD		ROAD BLOCK PAVING DETAIL REINSTATED.	01/08/22
D	JCB		MJD ISSUED FOR CONSTRUCTION.	20/01/22
C	JCB		MJD BLOCK PAVING DETAIL SUPERSEDED.	15/12/21
B	JCB		MJD KERBING DETAILS UPDATED.	20/08/21
A	MSB		INITIAL ISSUE.	14/06/19

PROPOSED RESIDENTIAL DEVELOPMENT AT DEVERON ROAD, HUNTLY, ABERDEENSHIRE.

Ramsay & Chalmers
Consulting Structural & Civil Engineers

Chatan Mews Offices
18 Chatan Place
ABERDEEN AB10 6RD
Tel: (01224) 560 700
Fax: (01224) 560 701
Email: info@ramsaychalmers.co.uk
Website: www.ramsaychalmers.co.uk

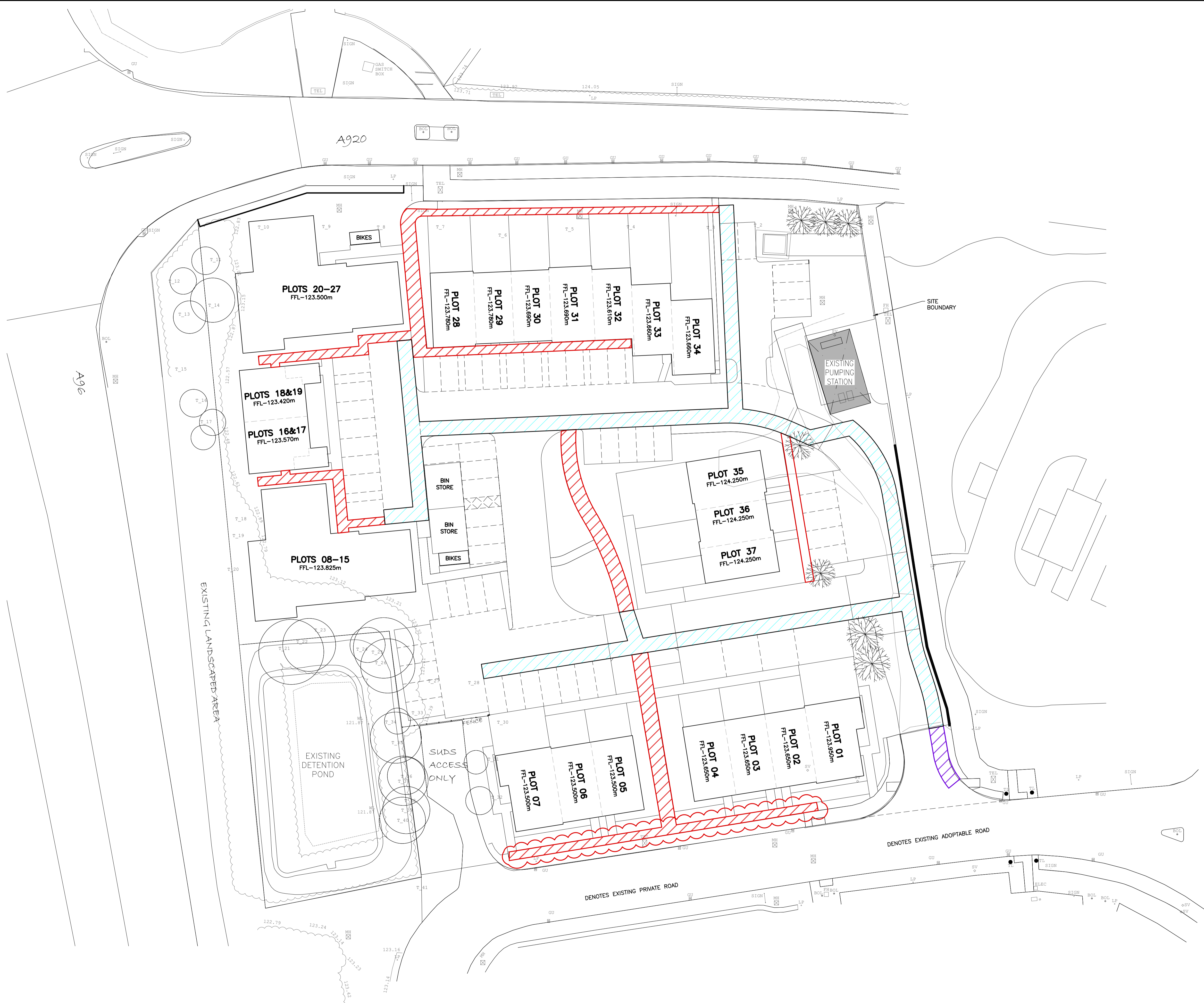

LEGEND.

	DENOTES SERVICE STRIP UNDER STANDARD ADOPTABLE ROADS.
	DENOTES SERVICE STRIP UNDER PRIVATE FOOTPATHS.
	DENOTES SERVICE STRIP UNDER PRIVATE ROADS.

NOTE.
TOPOGRAPHICAL SURVEY BASED ON GRANITE CITY SURVEY PROJECT 'GCS 5725' DATED 27/03/2019.

NOTE.
RESIDENTIAL HOUSING LAYOUT BASED ON NORR ARCHITECTS DRAWING 'DEV-THE-ZZ-ZZ-DR-A-90006 - Proposed Site Layout' DATED 01/08/2022.

NOT FOR CONSTRUCTION

GENERAL NOTES:-
THE CONTRACTOR MUST CONSULT THE CIVIL/STRUCTURAL DESIGN ENGINEER IMMEDIATELY IF:
a) GROUND CONDITIONS VARY ON SITE.
b) EXISTING BUILDINGS VARY ON SITE.
c) DIMENSIONS OR LEVELS SHOWN ARE CHANGED BY ANYONE ON SITE.
d) COMPLETE OR PARTIALLY COMPLETE STRUCTURES ARE TO BE SUBJECT TO CONSTRUCTION LOADING OR AFFECTED BY TEMPORARY WORKS.
DO NOT SCALE - IF IN DOUBT, ASK.
LARGE SCALE DETAILS TAKE PRECEDENCE OVER SMALL SCALE DETAILS.
ALL MATERIALS ARE TO BE USED STRICTLY IN ACCORDANCE WITH MANUFACTURERS INSTRUCTIONS.
THE CONTRACTOR WILL BE RESPONSIBLE FOR ALL COSTS INVOLVED IN CHANGES OR MODIFICATIONS REQUESTED AND APPROVED, TO SUIT HIS PREFERRED WORK METHOD.
ALL NECESSARY METHOD STATEMENTS MUST BE PROVIDED PRIOR TO COMMENCEMENT OF ASSOCIATED SITE OPERATIONS.
THIS DRAWING SHOULD ONLY BE USED FOR CONSTRUCTION PURPOSES ONLY WHEN THE ISSUE STATUS IS 'FOR CONSTRUCTION'.
ALL DIMENSIONS ARE IN MILLIMETERS UNLESS OTHERWISE STATED.
ALL LEVELS ARE IN METERS UNLESS OTHERWISE STATED.

© THE COPYRIGHT OF THIS DRAWING SUBSISTS WITH RAMSAY & CHALMERS

B	NJH	MJD	DRAWING REINTRODUCED AS SERVICES LAYOUT.	03/08/22
A	MSR		INITIAL ISSUE.	14/06/19
Rev.	By	App.	Description	Date

Project
PROPOSED RESIDENTIAL DEVELOPMENT AT DEVERON ROAD, HUNTLY, ABERDEENSHIRE.

Drawing Title
PROPOSED SERVICE ROUTES LAYOUT

Architect
T.H.E.

Job No.	Drawing No.	Revision	Scale	Issue Status
C3577	111	B	1:250-A1 1:500-A3	FOR PLANNING

Ramsay & Chalmers
Consulting Structural & Civil Engineers
Chattan Mews Offices
18 Chattan Place
ABERDEEN AB10 6RD
Tel. (01224) 560 700
Fax. (01224) 560 701
Email: info@ramsaychalmers.co.uk
Website: www.ramsaychalmers.co.uk

SERVICE ROUTES. (1:250)

