

Left side Elevation

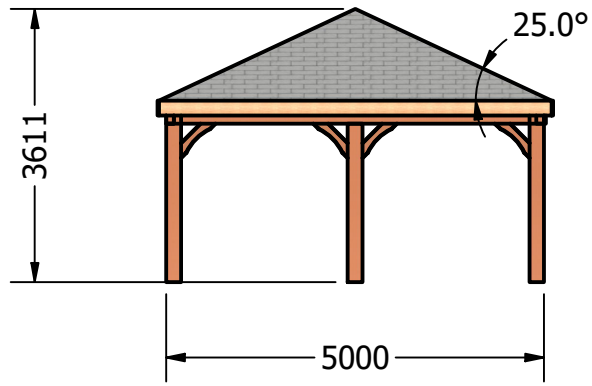

Front Elevation

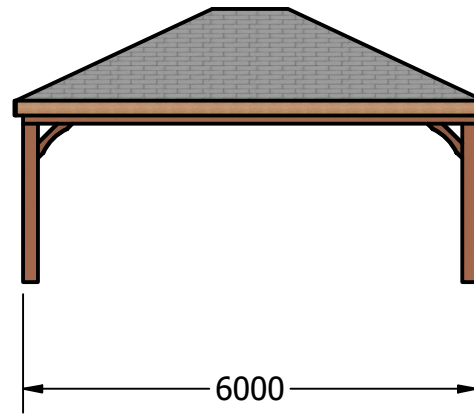

Right side Elevation

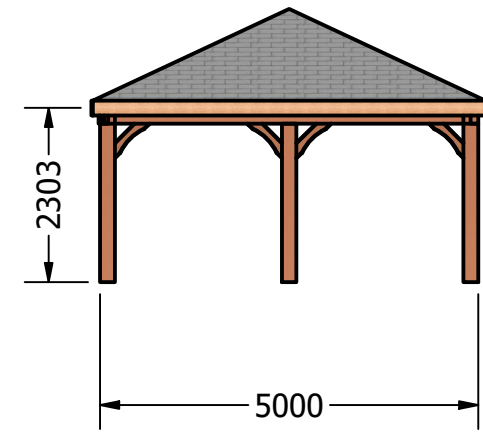

Roof Line

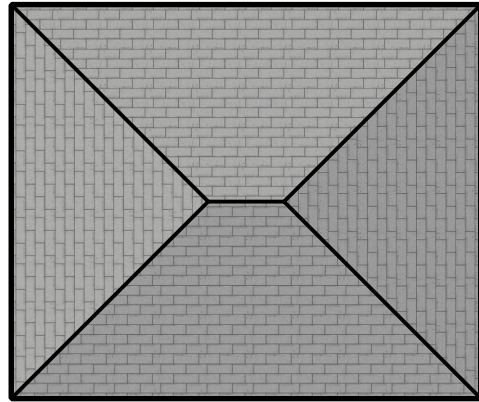

Rear Elevation

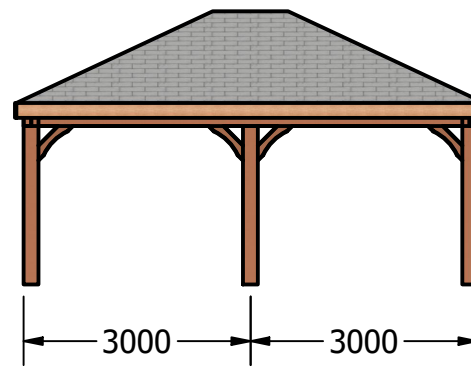

Floor Plan

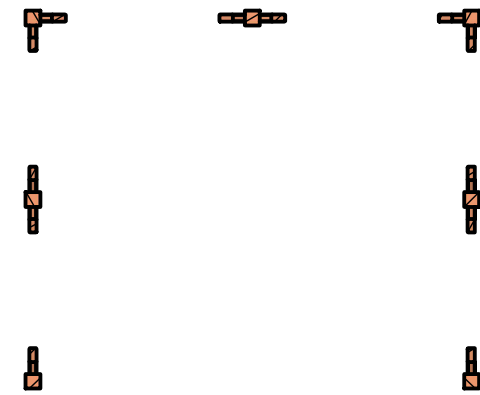

Framing: 7no. EX200mm x 200mm Oak Posts supporting a EX200mm x 100mm Oak Beam to three sides.

Knee braces as required to openings on three sides

At front clear span opening using a 203mm x 103mm UB - this is then clad to the front side with timber to match the rest of the frame

Roof Structure: Hipped Style: Hand cut roof using EX150mm x 50mm rafters, EX200mm x 50mm hip and ridge beams and EX150mm x 50mm ceiling ties

Roof Line: Softwood Timber Fascia, soffit and Barge boards fitted as required.

Black UPVC Guttering fitted to both sides complete with down pipes

Roofing works:

Description: Board roof with EX16mm x 125mm tongue and groove boarding

Finish roof with heavy duty 3 TAB Shingles - Colour TBC

DRAWN Kamil.Brzeski	11/07/2022
CHECKED	
QA	
MFG	
APPROVED	

SCOTT TIMBER BUILDINGS		
TITLE		
SIZE A3	DWG NO Mr Matthews - Proposed Elevations	REV
SCALE 1 / 100	SHEET 1 OF 1	